

11975 GLOBE STREET  
LIVONIA, MICHIGAN

INDUSTRIAL FOR SALE  
10,956 Square Feet Available



**SIGNATURE  
ASSOCIATES**  
KNOW SIGNATURE | KNOW RESULTS

**HEAVY POWER WAREHOUSE**



## PROPERTY FEATURES

- 10,956 square feet available
- 1,776 square feet of office
- 16' clear height
- (2) 12' x 14' grade level doors
- (2) 3-ton cranes
- 2300 amps, 600 volts, 3-phase power
- Fenced parking lot
- New Duro-Last roof in 2021 with 20-year warranty
- Sale Price: \$1,100,000 (\$100.40/sq. ft.)

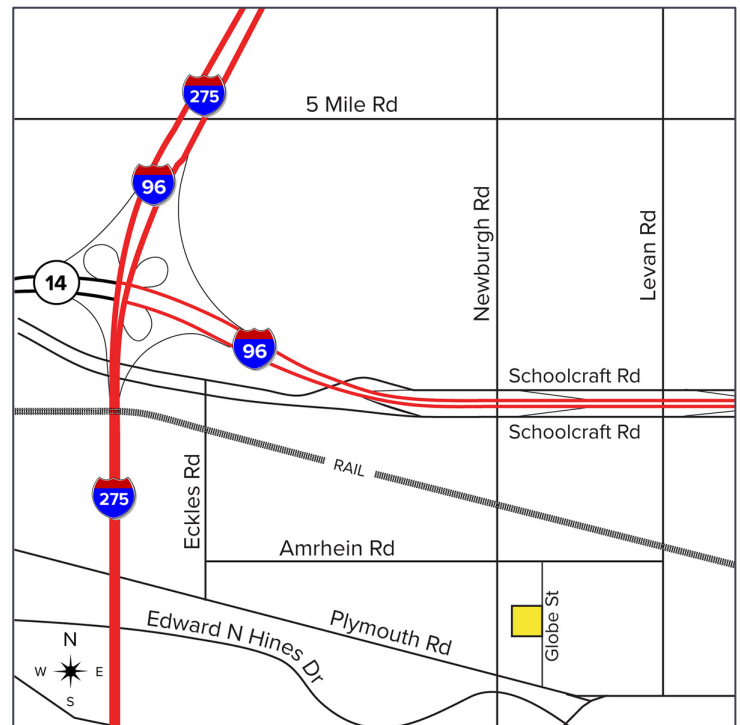

For more information, please contact:

**ALEX TIMMIS**  
(248) 359 0623  
atimmis@signatureassociates.com

**CHRISTOPHER CALVANO**  
(248) 359 0610  
ccalvano@signatureassociates.com

**SIGNATURE ASSOCIATES**  
One Towne Square, Suite 1200  
Southfield, MI 48076  
www.signatureassociates.com

# 11975 Globe Street – Livonia, Michigan

Industrial For Sale

10,956  
Square Feet  
AVAILABLE

## Site Plan

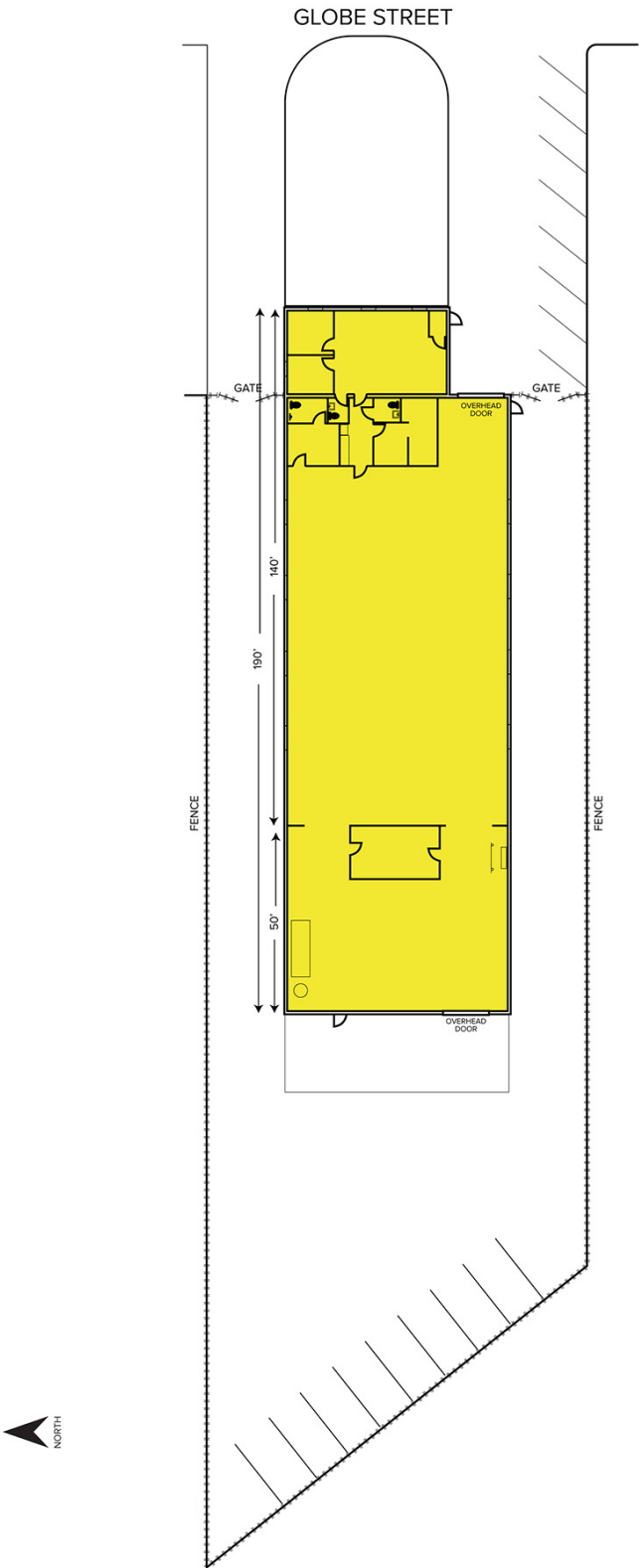

For more information, please contact:

**ALEX TIMMIS**  
(248) 359 0623  
atimmis@signatureassociates.com

**CHRISTOPHER CALVANO**  
(248) 359 0610  
ccalvano@signatureassociates.com

**SIGNATURE ASSOCIATES**  
One Towne Square, Suite 1200  
Southfield, MI 48076  
www.signatureassociates.com

Information is subject to verification and no liability for errors or omissions is assumed. Price is subject to change and listing withdrawal.

# 11975 Globe Street – Livonia, Michigan

Industrial For Sale

10,956  
Square Feet  
AVAILABLE

Aerial



For more information, please contact:

**ALEX TIMMIS**  
(248) 359 0623  
atimmis@signatureassociates.com

**CHRISTOPHER CALVANO**  
(248) 359 0610  
ccalvano@signatureassociates.com

**SIGNATURE ASSOCIATES**  
One Towne Square, Suite 1200  
Southfield, MI 48076  
www.signatureassociates.com