

50' TRANSPORTATION EASEMENT

320'±

AVAILABLE AREA = 2.0± ACRES

230'±

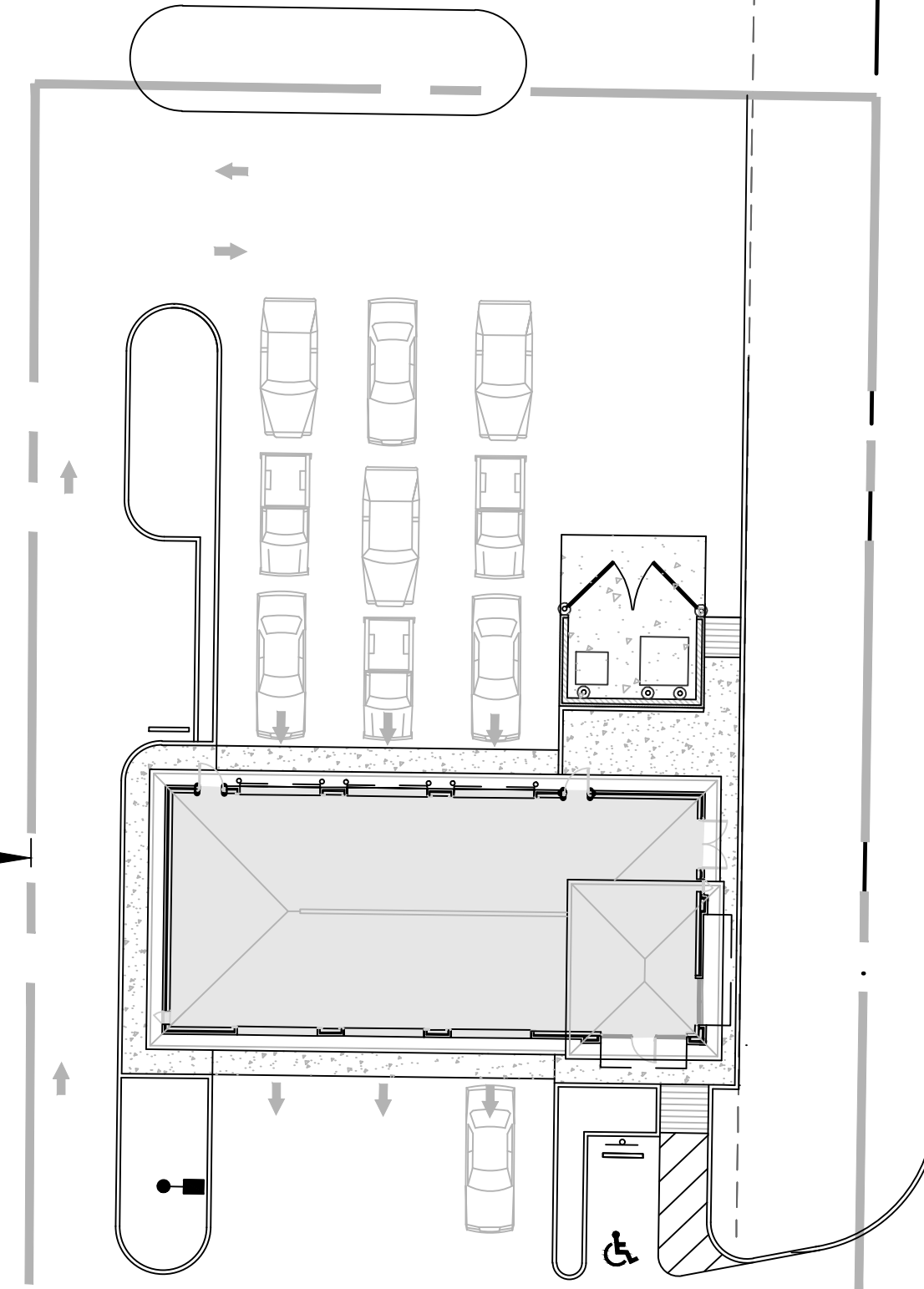
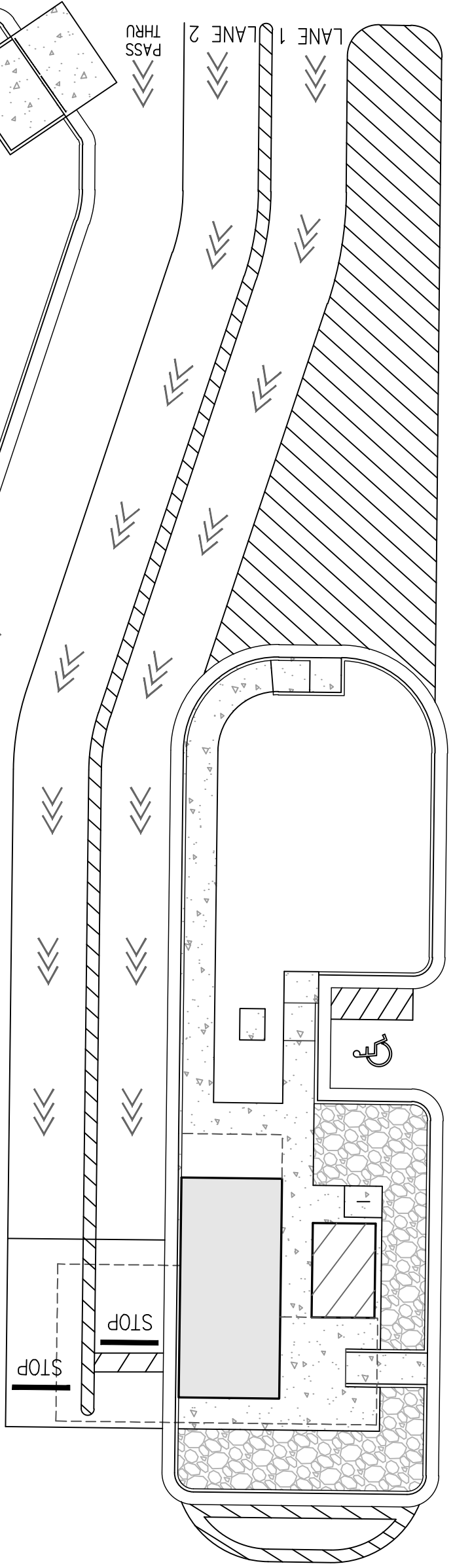

NORTH ROAN STREET

PROJECT ENGINEER



CONTACT: STEPHEN ELLIS, P.E.

PROJECT

**CONCEPT PLAN**  
**1906 NORTH ROAN STREET**  
JOHNSON CITY, TENNESSEE

DWG. TITLE

**PRELIMINARY LAYOUT**

REV DATE

- -  
- -  
- -

DATE:  
12/7/23

SCALE: 1"=20'

DWG. NO.

**C1 OF 1**