



FOR LEASE

663 S. State College Blvd., Unit 61
Fullerton, CA

615 SF Industrial Unit

SITE HIGHLIGHTS:

- 24 Hour Access
- Drive Around Building
- 53' Truck Access
- Excellent Access to 55, 57, & 91 Freeways
- Various Sizes Available: 600 SF to 2,000 SF
- Onsite Management
- Security Cameras on All Access Points
- Some Offices have HVAC



FOR FURTHER DETAILS:

JOHN PAK
john@tricoREALTY.com
License #01483069

This information has been furnished from sources which we deem reliable; however, we do not guarantee its accuracy and assume no liability. Do not rely on any of the information contained herein without verifying it yourself directly with the listing broker or owner.

Trico Realty, Inc.
License #00342120

3100-A Pullman Street
Costa Mesa, CA 92626

714-751-4420
TricoRealty.com



FOR LEASE

663 S. State College Blvd., Unit 61
Fullerton, CA

615 SF Industrial Unit

Unit Features

Power: 100A | 120/208

Clearance Height: 16'

Ground Level Doors: One 10'x10'

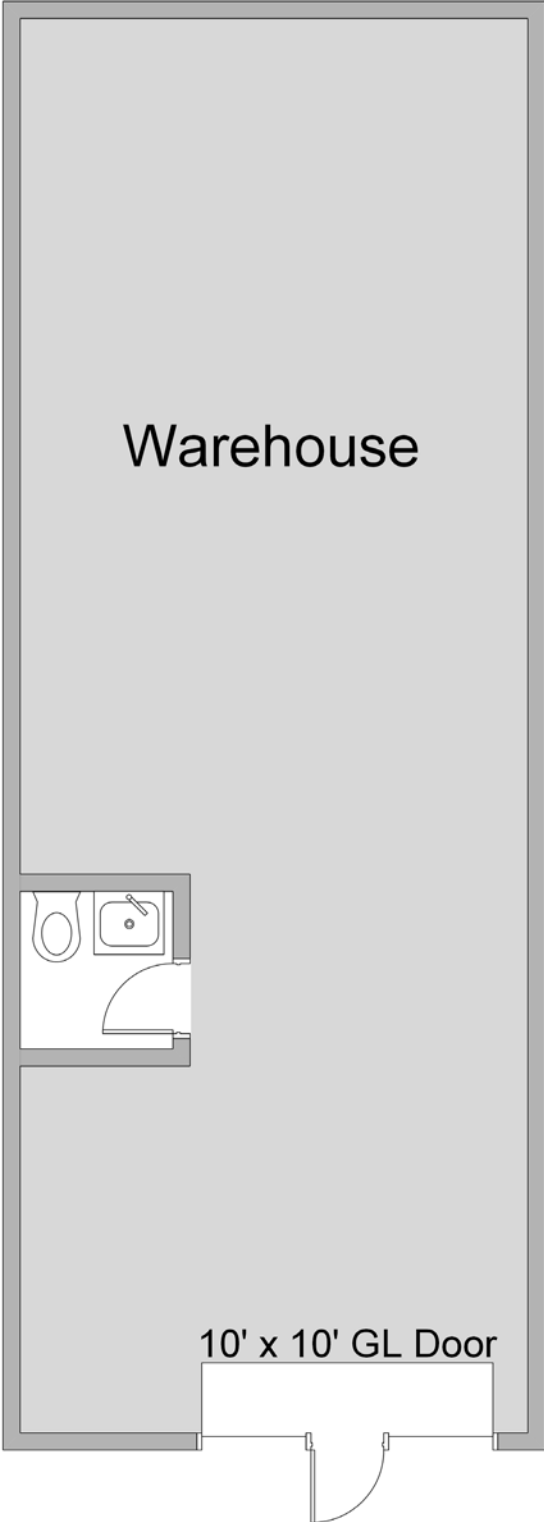
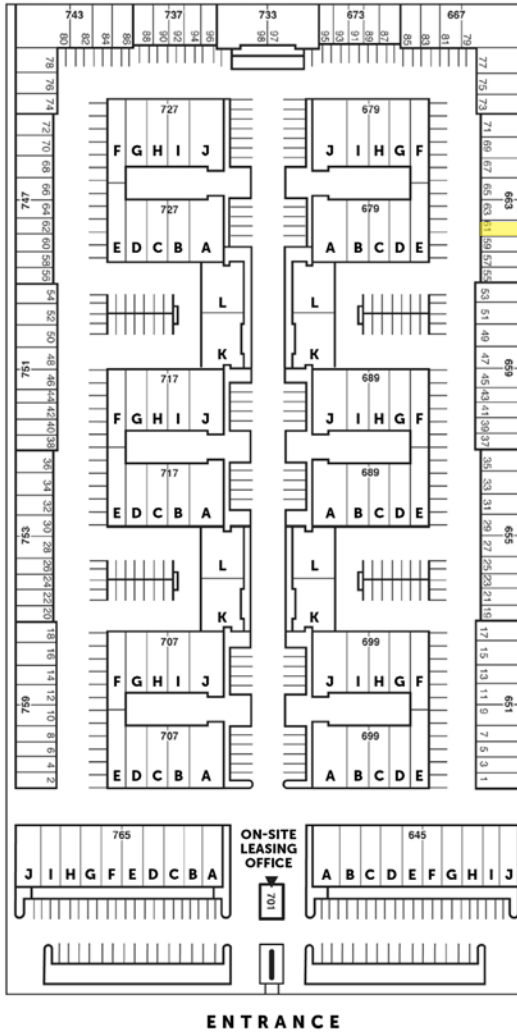

*Floorplans Not to Scale

JOHN PAK
john@tricoREALTY.com
License #01483069

714-751-4420
TricoREALTY.com
License #00342120