

OFFICE SPACE FOR LEASE

3021 Lorna Road ♦ Hoover, AL ♦ 35216 ♦ Jefferson County



Suite Sizes Available From 668—5,658 sf

Rates start at \$16.50/sf

Full Service

Mark Dinan, MBA, CCIM

(o) 205-980-3434

(c) 205-243-3434

markdinan@bellsouth.net

MARK DINAN
Commercial & Investment Real Estate



*All Information furnished regarding property sale, rental, or financing is from sources deemed reliable, but is not guaranteed.

PROPERTY DETAILS

3021 Lorna Road ♦ Hoover, AL ♦ 35216 ♦ Jefferson County

- ♦ Convenient Location less than 1.4 mile from I-65.
- ♦ Easy access.
- ♦ Attractive glass building.
- ♦ Excellent level parking.
- ♦ Signage Available.
- ♦ Lease rates start at \$16.50/sq. ft.
- ♦ Full Service, no hassle leases include power, water and janitorial services.
- ♦ Attentive local owners and management team.
- ♦ Near great restaurants and shopping.
- ♦ No occupational tax.
- ♦ Excellent Value.
- ♦ Flexible Terms.
- ♦ Owner will build to suit your needs.
- ♦ Call or email for availability and pricing.



Mark Dinan, MBA, CCIM

(o) 205-980-3434

(c) 205-243-3434

markdinan@bellsouth.net

MARK DINAN
Commercial & Investment Real Estate



*All Information furnished regarding property sale, rental, or financing is from sources deemed reliable, but is not guaranteed.

AVAILABLE SUITES

3021 Lorna Road ♦ Hoover, AL ♦ 35216 ♦ Jefferson County

Suite	Square Feet	Floor
110	2443	1
206	1179	2
209	668	2
301	5658	3
303	867	3
307	1,674	3

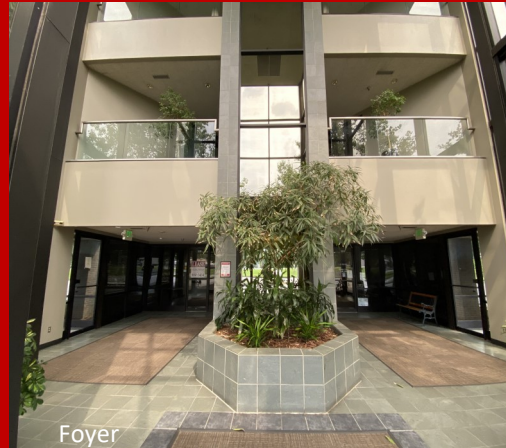

Mark Dinan, MBA, CCIM

(o) 205-980-3434

(c) 205-243-3434

markdinan@bellsouth.net

MARK DINAN
Commercial & Investment Real Estate

MEMBER: LoopNet CoStar™

CCIM Experts in Commercial Investment Real Estate

International Council of Shopping Centers

CREXi

*All Information furnished regarding property sale, rental, or financing is from sources deemed reliable, but is not guaranteed.

SUITE 110 FLOOR PLAN

3021 Lorna Road ♦ Hoover, AL ♦ 35216 ♦ Jefferson County

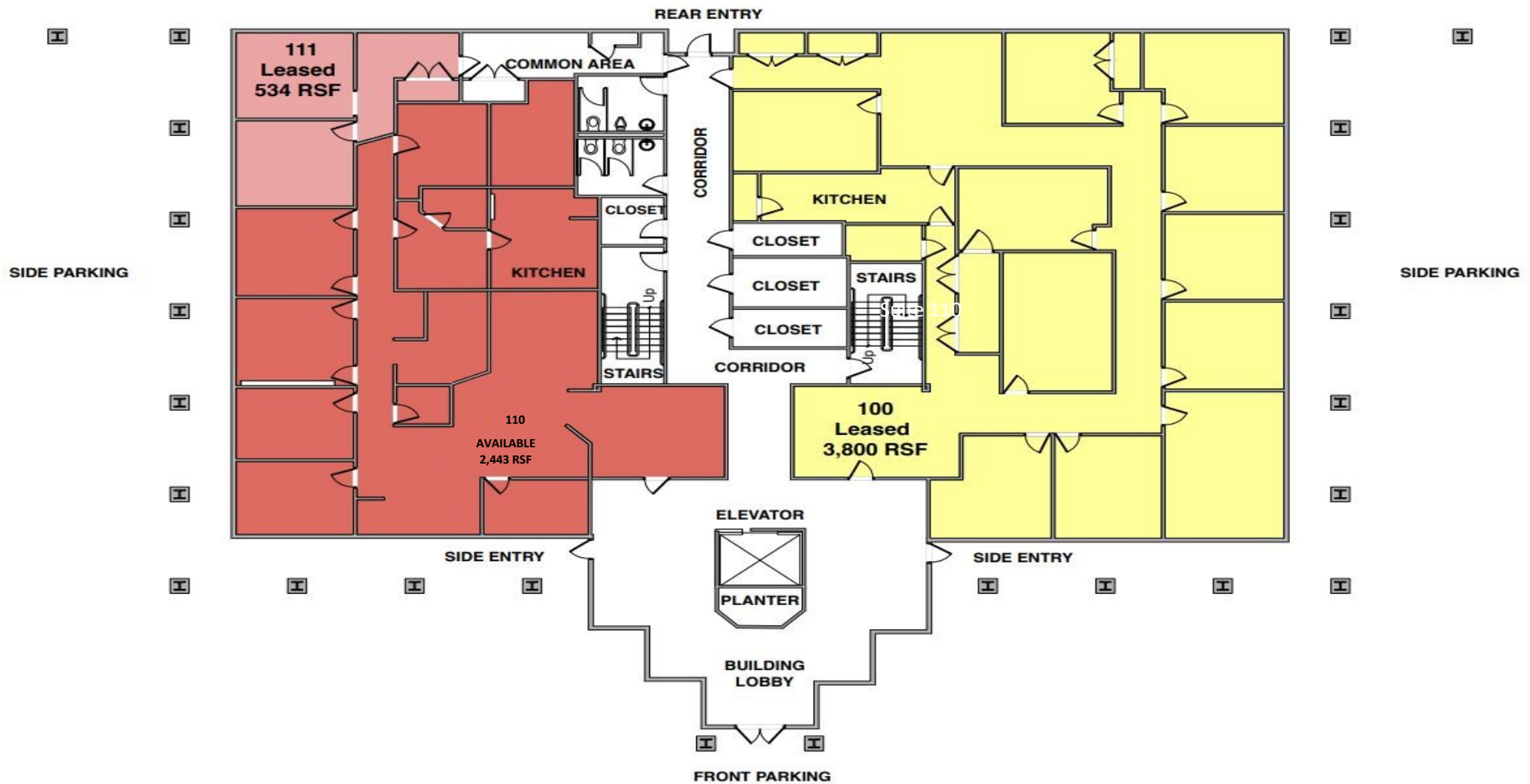

100 SUITES PHOTOS

3021 Lorna Road ♦ Hoover, AL ♦ 35216 ♦ Jefferson County



Suite 110



Suite 110



Suite 110



Suite 110

200 SUITES FLOOR PLAN

3021 Lorna Road ♦ Hoover, AL ♦ 35216 ♦ Jefferson County

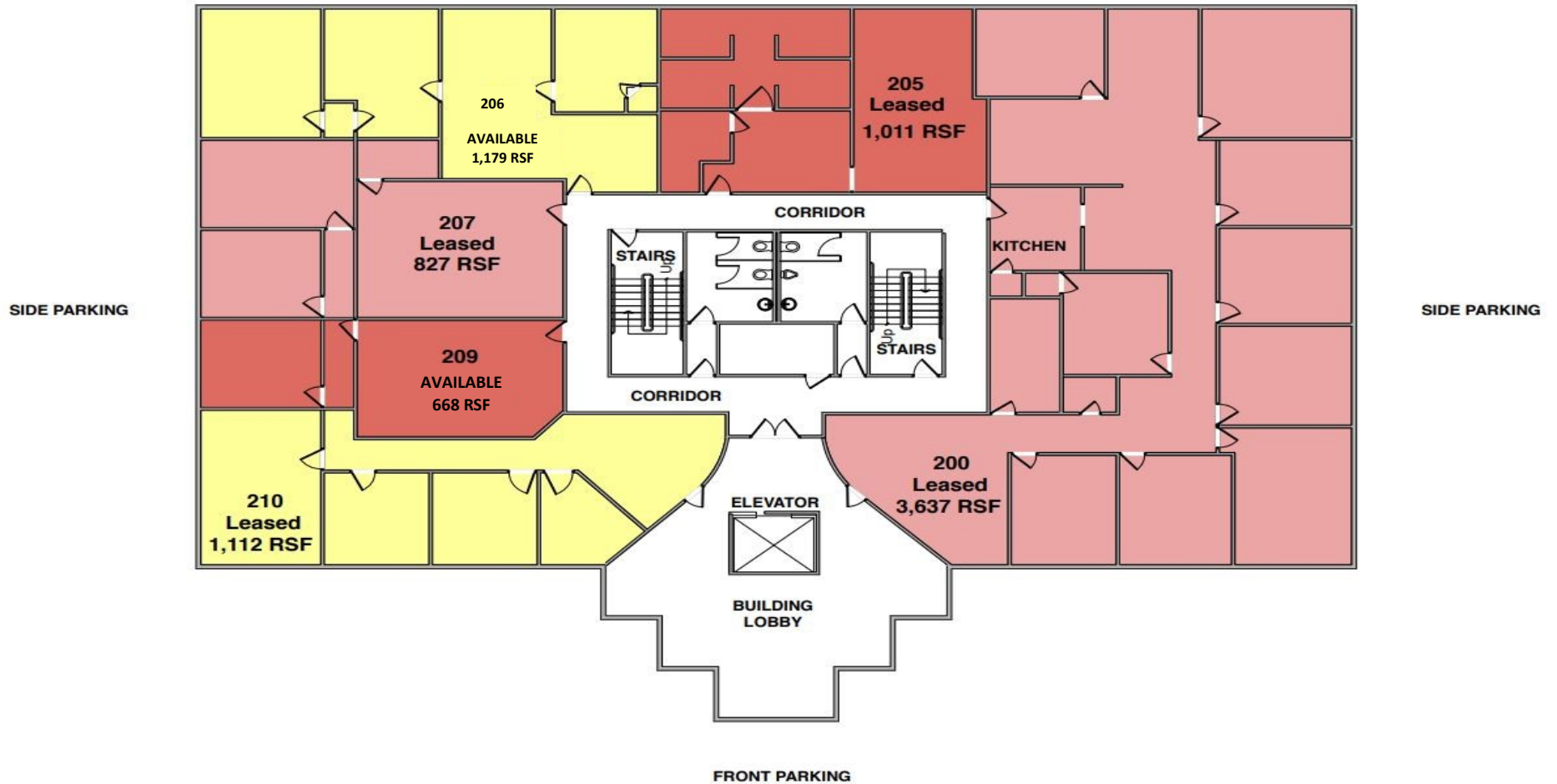

200 SUITES PHOTOS

3021 Lorna Road ♦ Hoover, AL ♦ 35216 ♦ Jefferson County



Suite 206



Suite 206



Suite 206



Suite 206

300 SUITES FLOOR PLAN

3021 Lorna Road ♦ Hoover, AL ♦ 35216 ♦ Jefferson County

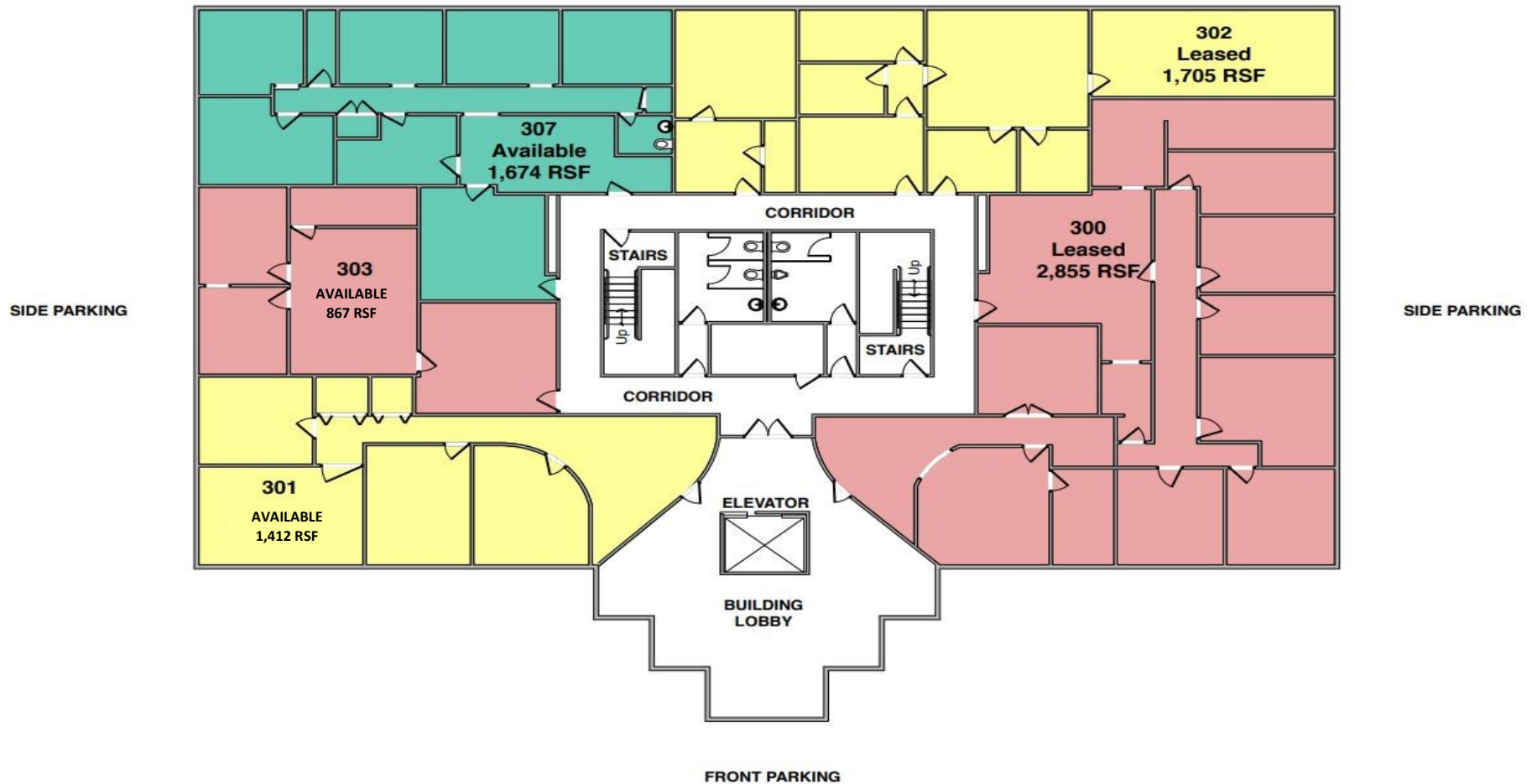

300 SUITES PHOTOS

3021 Lorna Road ♦ Hoover, AL ♦ 35216 ♦ Jefferson County



Suite 301



Suite 301



Suite 301



Suite 301

LOCATION MAP

3021 Lorna Road ♦ Hoover, AL ♦ 35216 ♦ Jefferson County

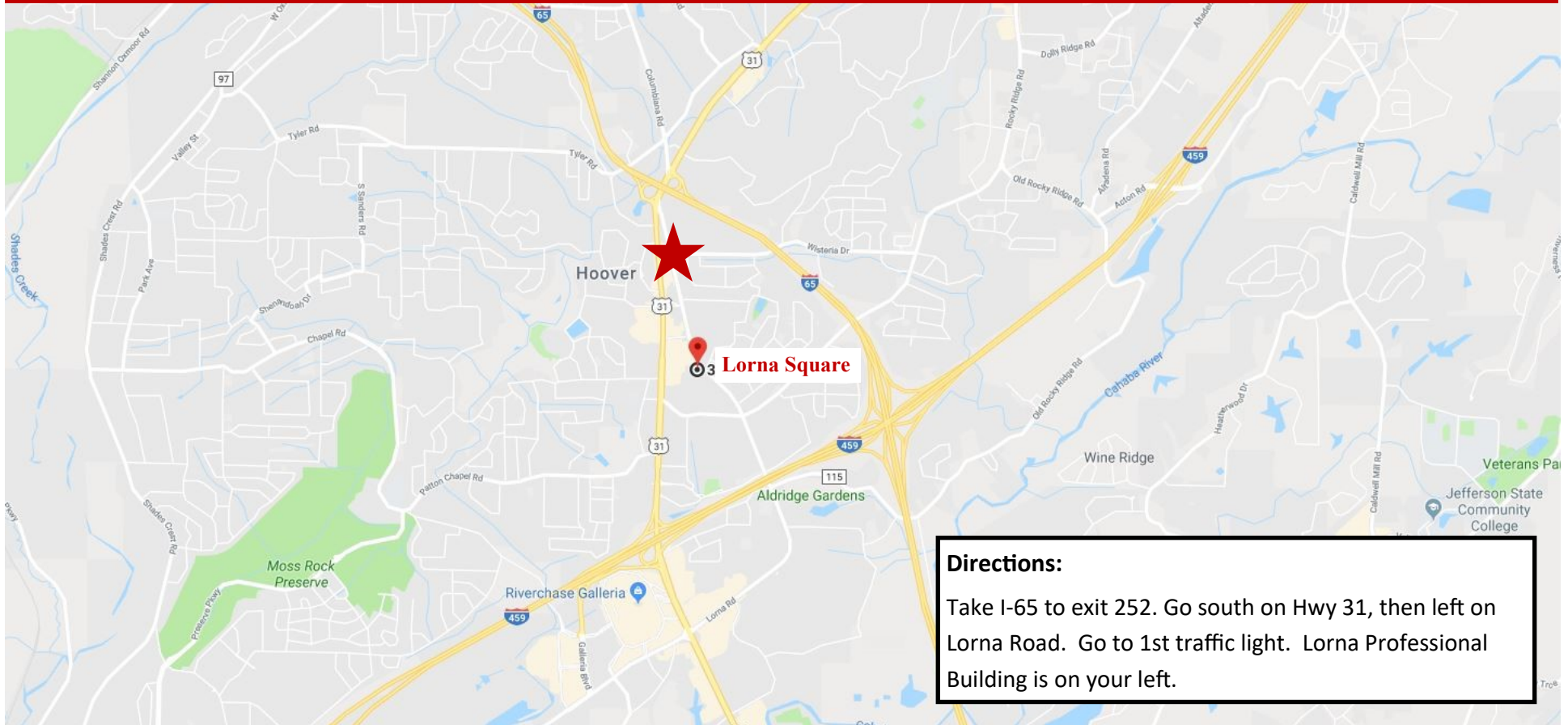

Mark Dinan, MBA, CCIM

(c) 205-980-3434

(c) 205-243-3434

markdinan@bellsouth.net

MARK DINAN
Commercial & Investment Real Estate



*All Information furnished regarding property sale, rental, or financing is from sources deemed reliable, but is not guaranteed.

AERIAL MAP

3021 Lorna Road ♦ Hoover, AL ♦ 35216 ♦ Jefferson County

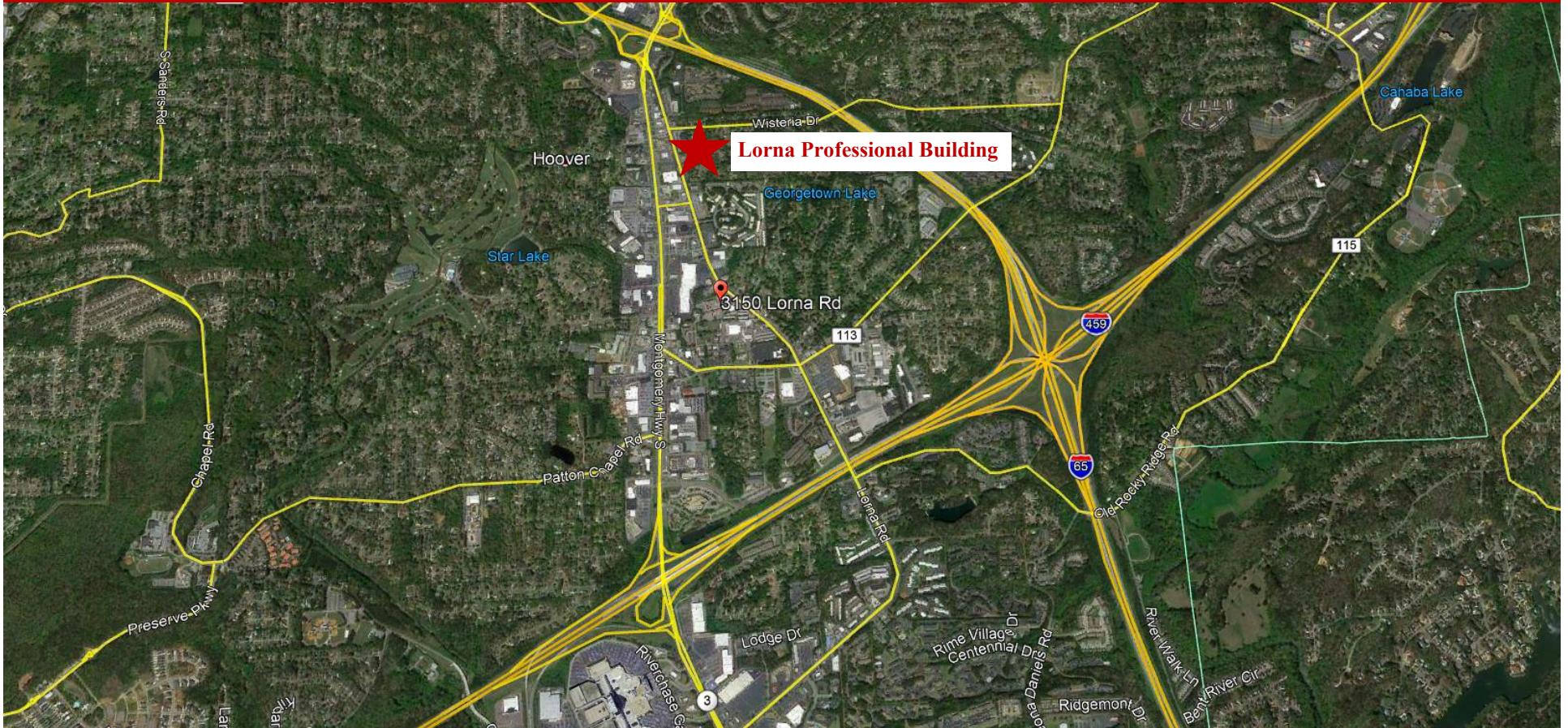

Mark Dinan, MBA, CCIM

(o) 205-980-3434

(c) 205-243-3434

markdinan@bellsouth.net

MARK DINAN
Commercial & Investment Real Estate



*All Information furnished regarding property sale, rental, or financing is from sources deemed reliable, but is not guaranteed.

TRAFFIC MAP

3021 Lorna Road ♦ Hoover, AL ♦ 35216 ♦ Jefferson County

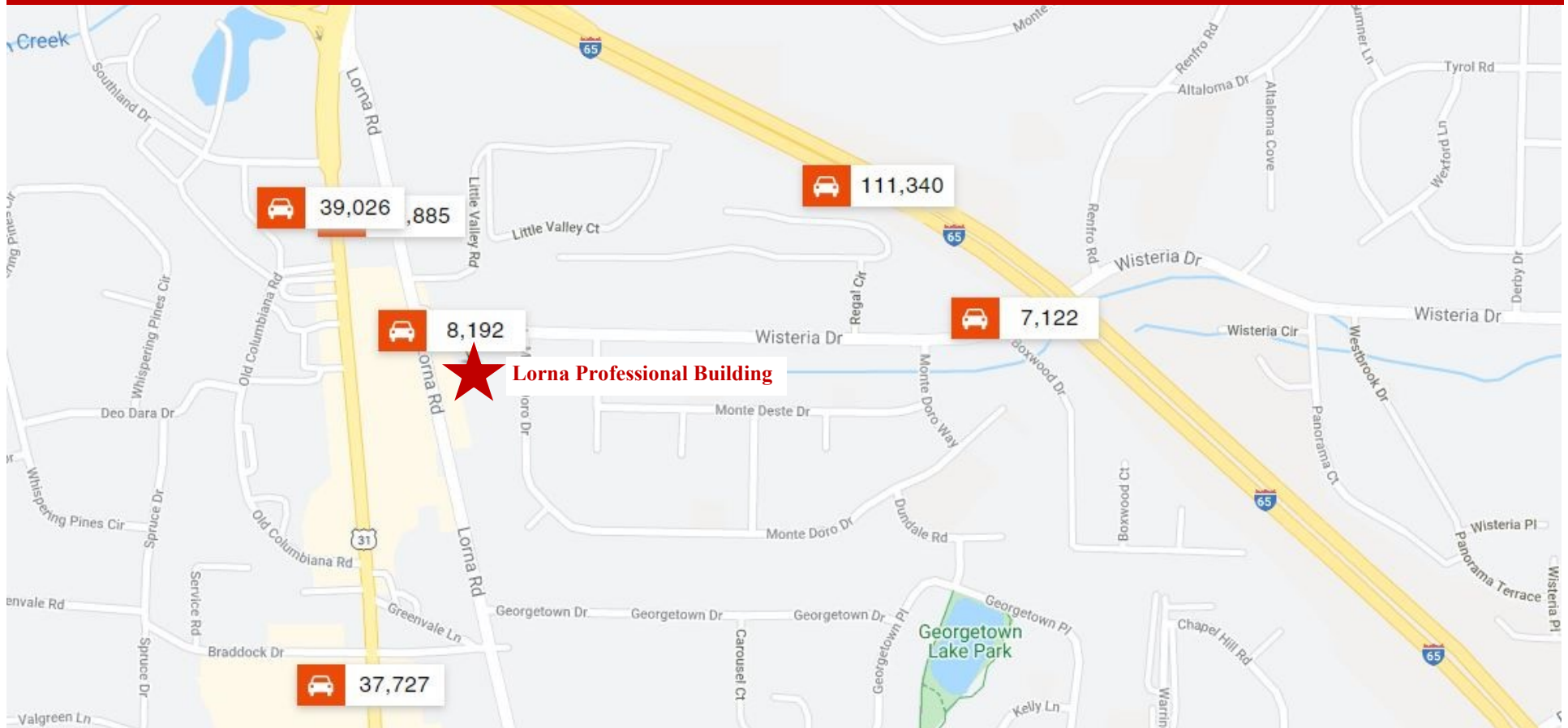

Mark Dinan, MBA, CCIM

(o) 205-980-3434

(c) 205-243-3434

markdinan@bellsouth.net

MARK DINAN
Commercial & Investment Real Estate



*All Information furnished regarding property sale, rental, or financing is from sources deemed reliable, but is not guaranteed.

DEMOGRAPHICS

3021 Lorna Road ♦ Hoover, AL ♦ 35216 ♦ Jefferson County

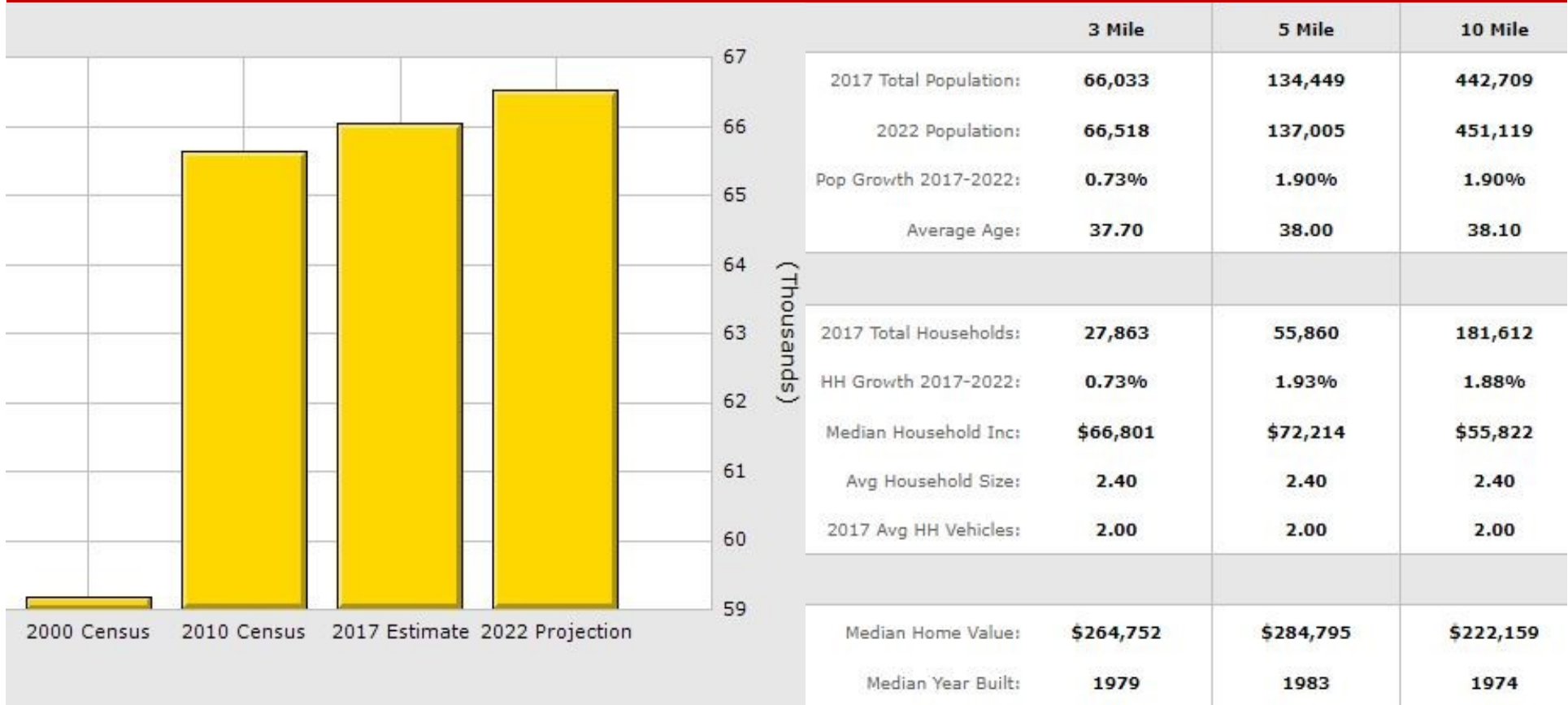

Mark Dinan, MBA, CCIM

(o) 205-980-3434

(c) 205-243-3434

markdinan@bellsouth.net

MARK DINAN
Commercial & Investment Real Estate

MEMBER: LoopNet CoStar™

CCIM Experts in Commercial Investment Real Estate

International Council of Shopping Centers

CREXi REALTOR

*All Information furnished regarding property sale, rental, or financing is from sources deemed reliable, but is not guaranteed.