



VIEW INSIDE

**1600-1634
E Grand Blvd**

Mt Elliott St

E Grand Blvd



1600-1634 E. GRAND BLVD DETROIT, MICHIGAN

For more information, contact:

PETER VANDERKAAY

(248) 359 3837

pvanderkaay@signatureassociates.com

PAUL SAAD

(248) 359 0652

psaad@signatureassociates.com



**SIGNATURE
ASSOCIATES**
KNOW SIGNATURE | KNOW RESULTS

PROPERTY OVERVIEW

FOR SALE //

2-BUILDING PROPERTY
TOTALING 184,738 SQ. FT.

AVAILABILITY FOR LEASE

| SUITE | SQ. FT. |
|--------------------|---------|
| 102 | 4,855 |
| 104 | 2,184 |
| xx | 1,149 |
| 201 | 5,000 |
| 209-217-230 | 5,020 |
| 221-229 | 1,529 |
| 301 | 971 |
| 303 | 1,218 |
| 304 | 1,006 |
| 305 | 1,897 |
| 4 TH FL | 18,000 |

1600 E. GRAND BLVD – OFFICE

- 971-18,000 office square feet available for lease
- 80,479 total building square feet available for sale
- 4-story office building
- Turn-key office space
- 4th floor is available with great views
- Elevator access with additional full freight elevator
- Potential to add roof deck space
- Available warehouse units: 102, 104, and 105

1634 E. GRAND BLVD – WAREHOUSE/INDUSTRIAL

- 104,259 total building square feet available for sale
- Secure gated parking
- Space includes grade level doors and truckwells



IMMEDIATE ACCESS
TO I-94 & JUST EAST
OF I-75

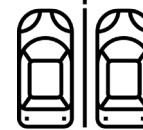

SECURED
GATED
PARKING



CLOSE TO NEW FCA
PLANT, DAKKOTA
INTEGRATED SYSTEMS
AND GM DETROIT-
HAMTRAMCK
ASSEMBLY PLANT

ENTIRE SITE FOR SALE // 1600-1634 E. GRAND BLVD



**1600-1634
E Grand Blvd**

Mt Elliott St

E Grand Blvd



NORTH

OFFICE // 1600 E. GRAND BLVD



- 971-18,000 office square feet
- 80,479 total building square feet
- 4-story office building
- Turn-key office space
- Full 4th floor is available with great views
- Elevator access with additional full freight elevator
- Potential to add roof deck space

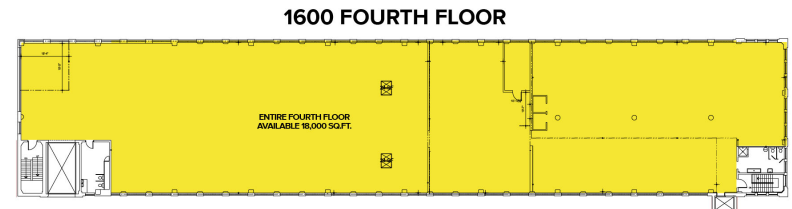
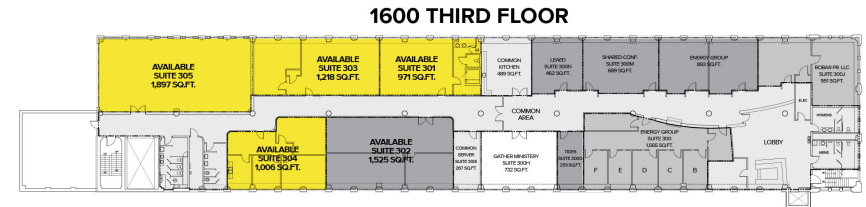
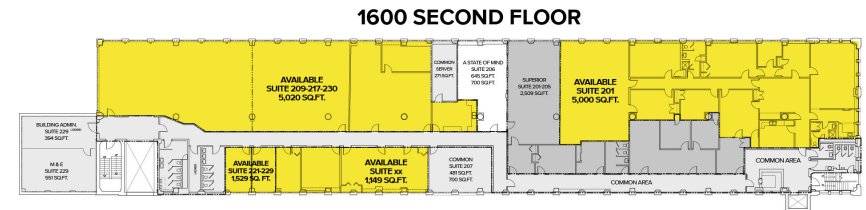
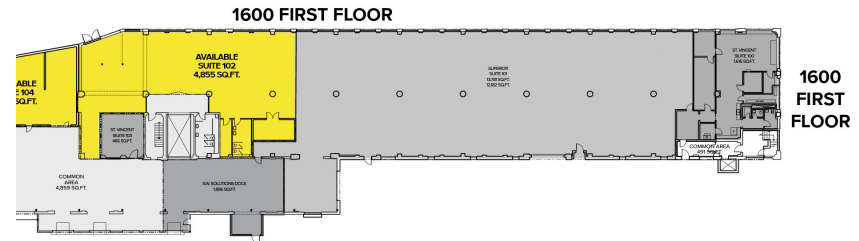



FOURTH FLOOR // 18,000 SQ. FT. AVAILABLE





LOBBY AREA ON THIRD FLOOR



COMMON KITCHEN AREA

CLOSE TO LARGE MANUFACTURERS

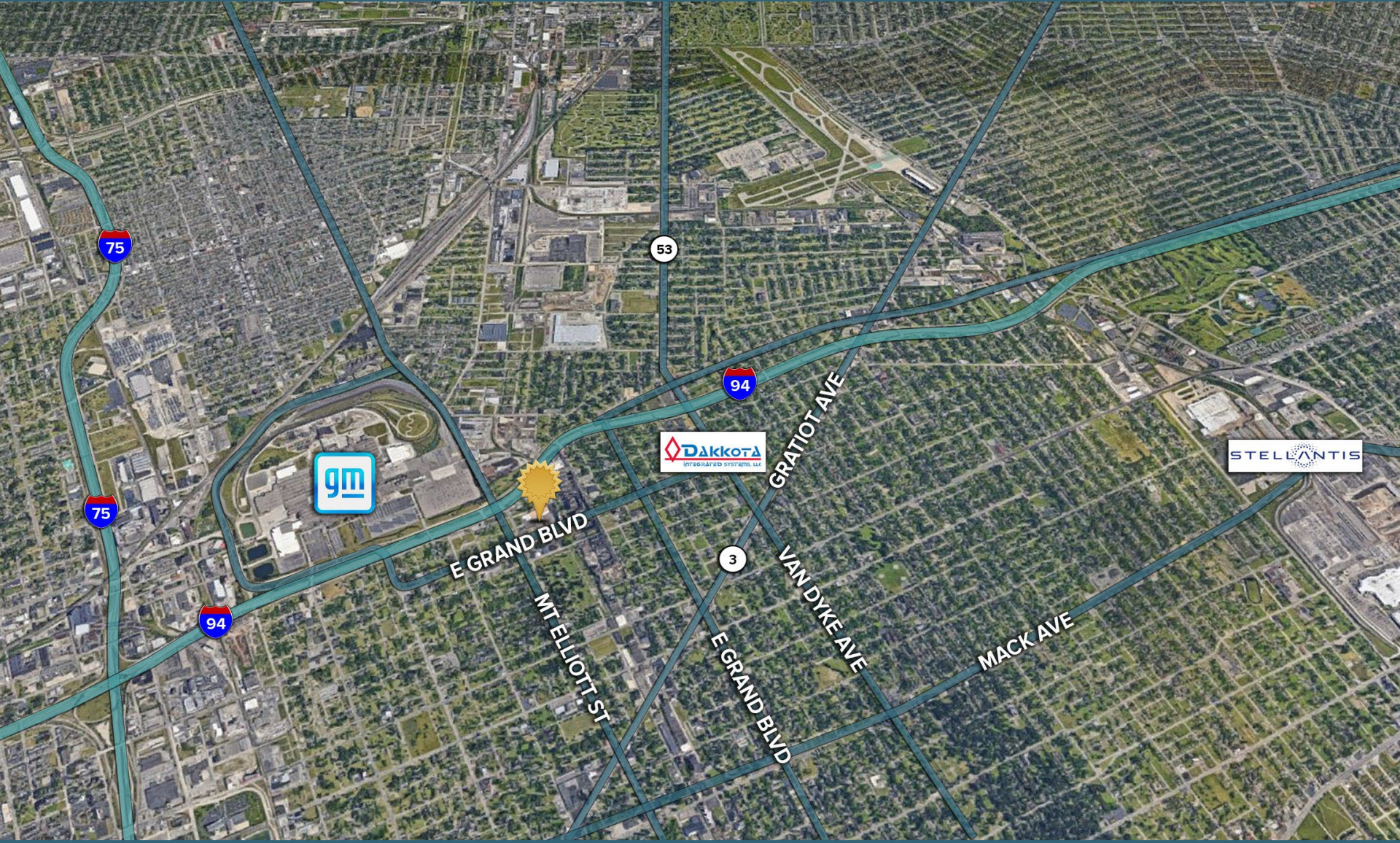

For more information, contact:

PETER VANDERKAAY

(248) 359 3837

pvanderkaay@signatureassociates.com

PAUL SAAD

(248) 359 0652

psaad@signatureassociates.com

SIGNATURE ASSOCIATES

One Towne Square, Suite 1200

Southfield, Michigan 48076

(248) 948 9000

www.signatureassociates.com



**SIGNATURE
ASSOCIATES**

KNOW SIGNATURE | KNOW RESULTS