

185 Bedford Avenue

Williamsburg, Brooklyn, NY

Location:

SE Corner of Bedford Avenue & North 7th Street

Ground Level:

1,950 SF

Lower Level:

1,200 SF

Frontage:

90 FT Wraparound Frontage

30 FT on Bedford Ave / 60 FT on North 7th Street

Ceiling Height:

12 FT on Ground Floor

8 FT on Lower Level

Rent:

Upon Request

Highlights:

- Positioned as the busiest corner intersection with an L-train entrance directly in front of the space
- 90 FT wrap-around frontage creates great exposure
- ADA compliant access and bathroom
- Ridership of 9,892,516 annually at Bedford Ave L Subway stop
- Williamsburg has a strong retail shopping, eateries, nightlife, office and residential market, and tourists



NEIGHBORING TENANTS:



BIRKENSTOCK®

LE LABO®

EVERLANE



lululemon

WARBY
PARKER

Contact Olmsted Leasing Team



Harrison Balisky
516-672-4493
hb@olmstedre.com

Brad Krosser
862-368-7271
bk@olmstedre.com



185 Bedford Avenue

Williamsburg, Brooklyn, NY

Floor Plan

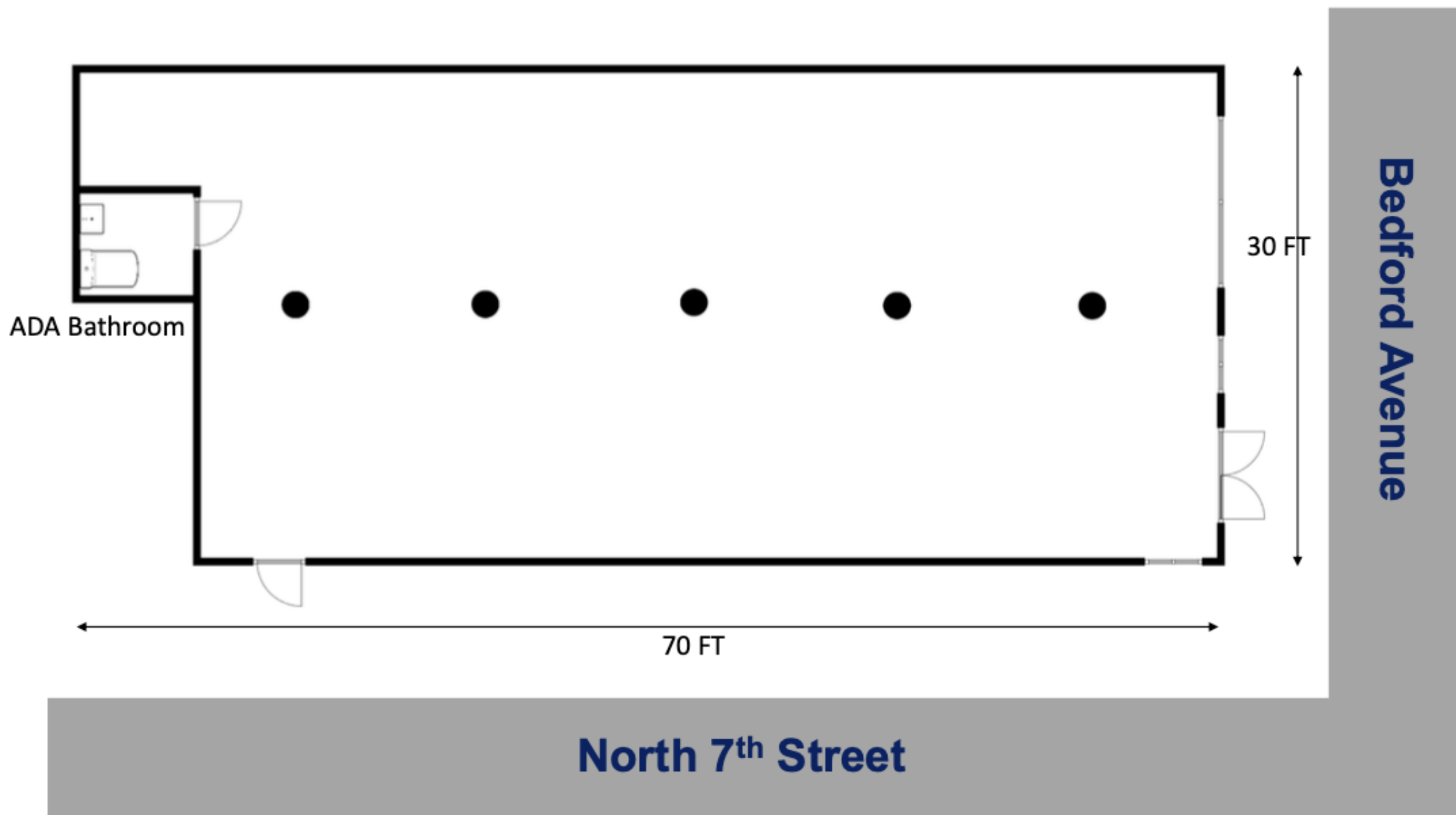



185 Bedford Avenue

Williamsburg, Brooklyn, NY

Photos



All information is from sources deemed reliable. No representation is made and we do not guarantee the accuracy of any information provided. All information must be independently verified. The value of any real estate investment is dependent on a variety of factors and should be evaluated carefully by prospective purchasers/ or tenants.



185 Bedford Avenue

Williamsburg, Brooklyn, NY

Retail Map

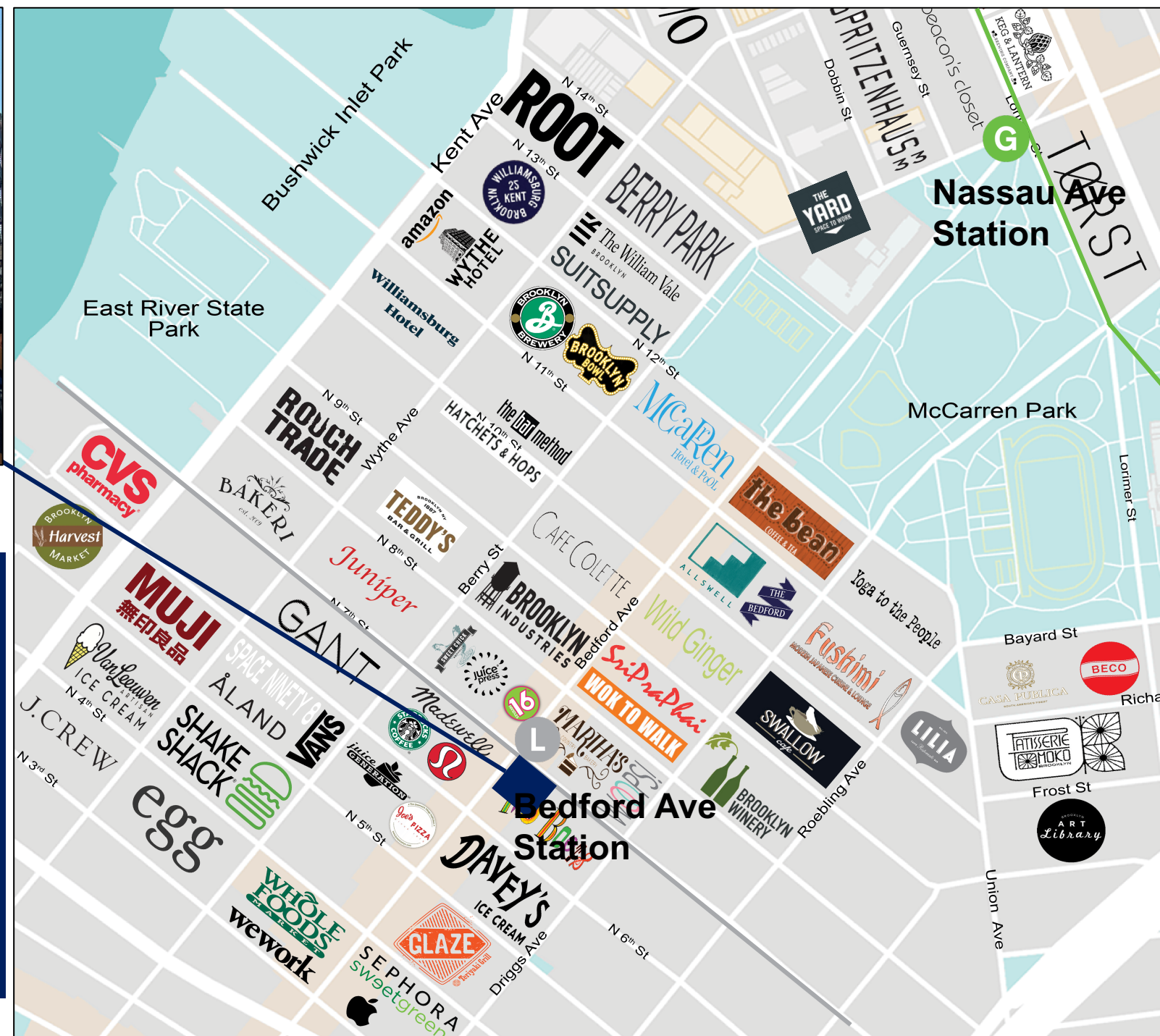

Annual Subway Ridership

L train **Bedford Avenue** station is directly outside with 9,892,516 annual ridership

G train is 0.6 miles away at **Nassau Avenue** station with 2,880,235 annual ridership