

One of a Kind Creative Campus |  
For Sublease

---

**CBRE**

# 5350 Biloxi Ave

North Hollywood, CA 91601

[\*\*View Virtual Tour\*\*](#)





5350 Biloxi Ave  
North Hollywood, CA 91601



## Sublease Details

- + **Address:** 5350 Biloxi Ave, North Hollywood, CA 91601
- + **Premises:** 59,664 RSF
- + **Sublease Term:** April 30, 2025 (Longer term available on direct deal)
- + **Sublease Rate:** Negotiable
- + **Parking:** 125 Gated stalls
- + **Available:** March 1, 2023

[View Virtual Tour](#)

## Campus Highlights

- + High end 3 building gated creative campus
- + Excellent credit Sublessor
- + Campus features
  - + Creative office space
  - + High ceiling studio space
  - + R&D flex space
  - + Machine shop
  - + Rear storage facility
- + Existing infrastructure to accommodate automotive design
- + Several kitchens
- + Multiple conference rooms
- + Ample outdoor space and courtyard



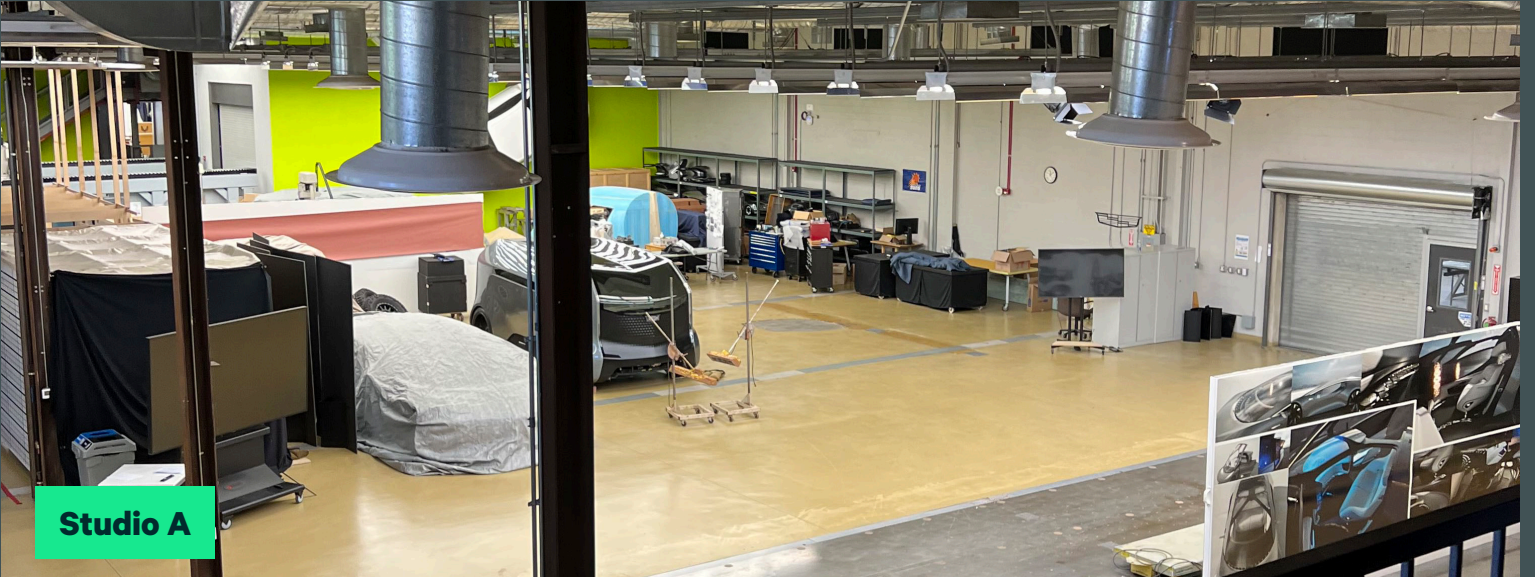
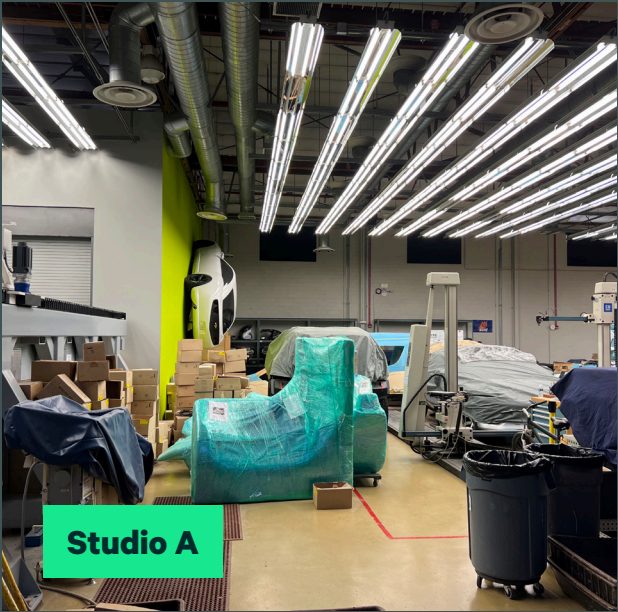
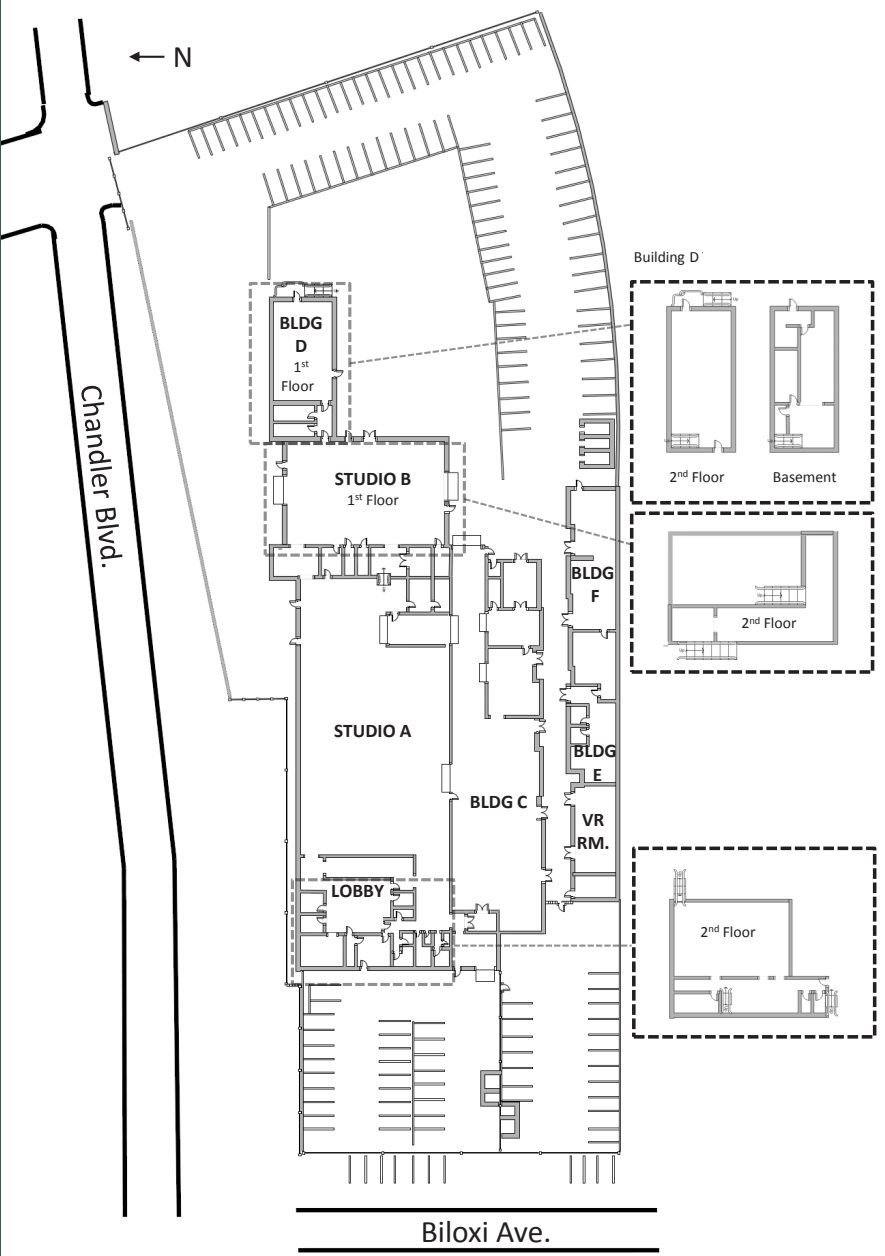



**Outdoor pathway between Building C & E**



**VR Room**



**Studio B**



**Studio B**

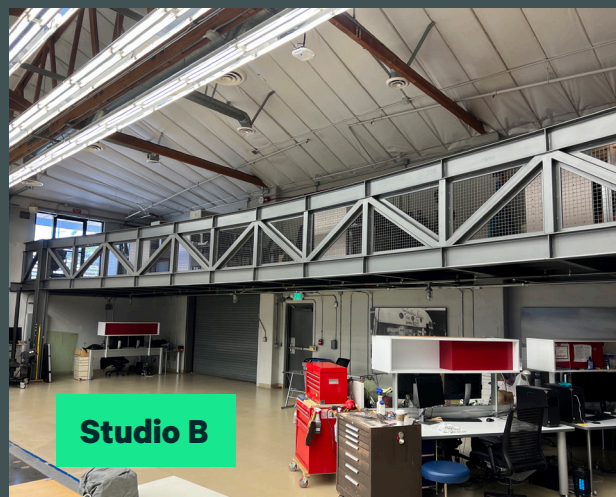

**[View Virtual Tour](#)**

## Contact Us

**Scott Steuber**

Senior Vice President  
+1 213 613 3016  
scott.steuber@cbre.com  
Lic. 01427534

**Jacob Bobek**

Executive Vice President  
+1 213 613 3181  
jacob.bobek@cbre.com  
Lic. 01361177

**Quinn Edwards**

Associate  
+1 213 613 3229  
quinn.edwards@cbre.com  
Lic. 02058634

**Jonathan Dezzutti**

Senior Transaction Manager  
+1 213 613 3538  
jonathan.dezzutti@cbre.com  
Lic. 02107488

© 2022 CBRE, Inc. All rights reserved. This information has been obtained from sources believed reliable, but has not been verified for accuracy or completeness. You should conduct a careful, independent investigation of the property and verify all information. Any reliance on this information is solely at your own risk. CBRE and the CBRE logo are service marks of CBRE, Inc. All other marks displayed on this document are the property of their respective owners, and the use of such logos does not imply any affiliation with or endorsement of CBRE. Photos herein are the property of their respective owners. Use of these images without the express written consent of the owner is prohibited.