

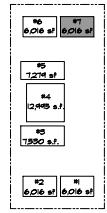

- WALL LEGEND**
- NEW HALL TO 6" ABOVE CEILING
 - NEW STOREFRONT
- GENERAL WALL NOTE:**
- INTERIOR WALLS TO 6" ABOVE CEILING ARE TO BE 1200 STD FRAMED @ 16" O.C. WITH 1 LAYER OF 5' GYPKRD BOARD ON EACH SIDE. STYRENE BEANED TO EXCEED TO 4" ABOVE CEILING. DOORS & PARTIAL AND SOUND ISOLATION TO 2' SIDE OF WALL. ON EACH SIDE, TO BE SOURCE OF AIR OVER TOP OF WALL. WALL TO BE TYPICAL BRICK AND PAINTED. WALL TO RECEIVE LEVEL 4 FROM PER AN ORIGINAL PLAN.
 - FOR STRUCTURAL STABILITY SECURE WALL TO STRUCTURE ABOVE AT A MAXIMUM OF 4'-0" O.C.
- BLOCKING NOTE:**
- FOR ALL UPDOWN ELEVATORS IN HALL BLOCKING IS TO BE PROVIDED AT ALL JAMBS AND HEADS.
- GENERAL FRAMING NOTE:**
- GO TO NOTE THAT DIMENSIONING IS FROM OUTSIDE OF FRAMING TO OUTSIDE OF FRAMING.
- DRINKING FOUNTAIN NOTE:**
- IN LIEU OF PROVIDING A DRINKING FOUNTAIN BOTTLED WATER SHALL BE PROVIDED.

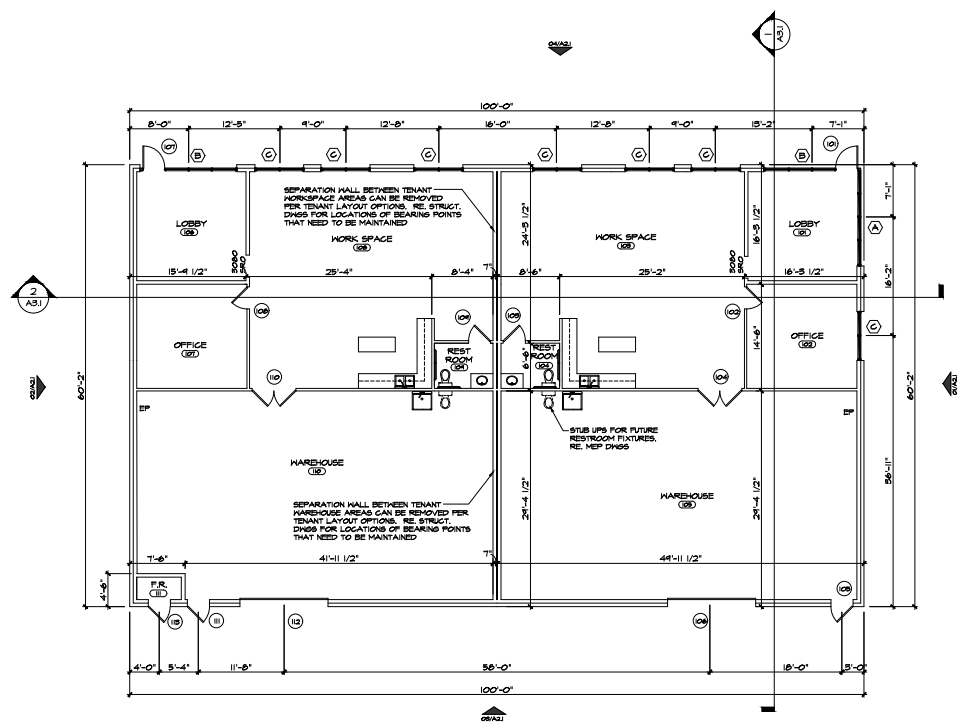

SITE KEY PLAN



01 - FLOOR PLAN

SCALE: 1/8" = 1'-0"

