

MODERN INDUSTRIAL BUILDING FOR LEASE

PACIFIC INDUSTRIAL PARK - INDIO, CA

RENT
\$6,570.00/MO
\$.95/SF
Modified Gross



42925 MADIO STREET, BUILDING 7, INDIO, CA

APPROX. 6,918 WITH 861 SF NICELY FINISHED OFFICES

- ◆ Concrete Tilt-Up Construction
- ◆ Appealing Architecture & Design
- ◆ Low Cost IID Power
- ◆ Ample Parking
- ◆ Secured Yard Area
- ◆ Fully Sprinklered & Skylights
- ◆ 18' Clear Warehouse Height
- ◆ 400 AMP, 120/208 Volt, 3-Phase Electrical
- ◆ Built in 2009
- ◆ (2) 14' Roll-Up Doors
- ◆ APN: 606-092-025

Central Valley Location - Easy Access to I-10 via Jefferson Street



COMMERCIAL REAL ESTATE SERVICES

BARNEY UPTON, SIOR
bupton@leedesert.com
760.346.2577
LIC #00404021

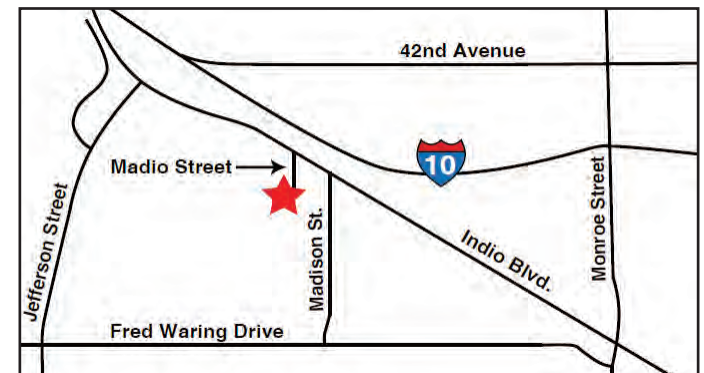

All information furnished regarding property for sale, rental or financing is from sources deemed reliable, but no warranty or representation is made to the accuracy thereof and same is submitted to errors, omissions, change of price, rental or other conditions prior to sale, lease or financing or withdrawal without notice. No liability of any kind is to be imposed on the broker herein.

MODERN INDUSTRIAL BUILDING FOR LEASE

42925 MADIO STREET, BUILDING 7, INDIO, CA

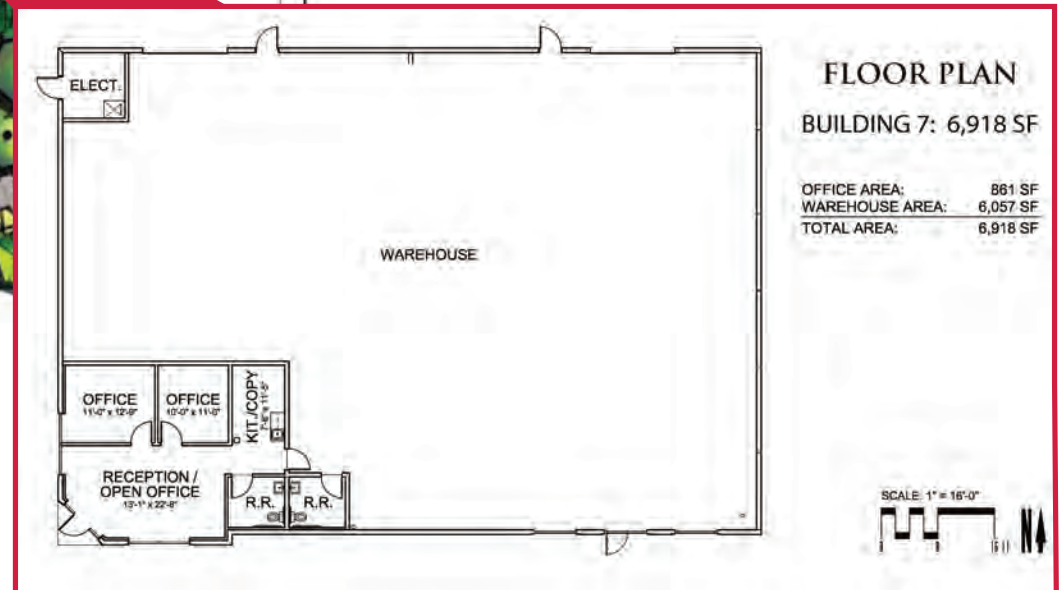

LEE & ASSOCIATES
COMMERCIAL REAL ESTATE SERVICES

BARNEY UPTON, SIOR
bupton@leedesert.com
760.346.2577
LIC #00404021

All information furnished regarding property for sale, rental or financing is from sources deemed reliable, but no warranty or representation is made to the accuracy thereof and same is submitted to errors, omissions, change of price, rental or other conditions prior to sale, lease or financing or withdrawal without notice. No liability of any kind is to be imposed on the broker herein.