

# FOR LEASE

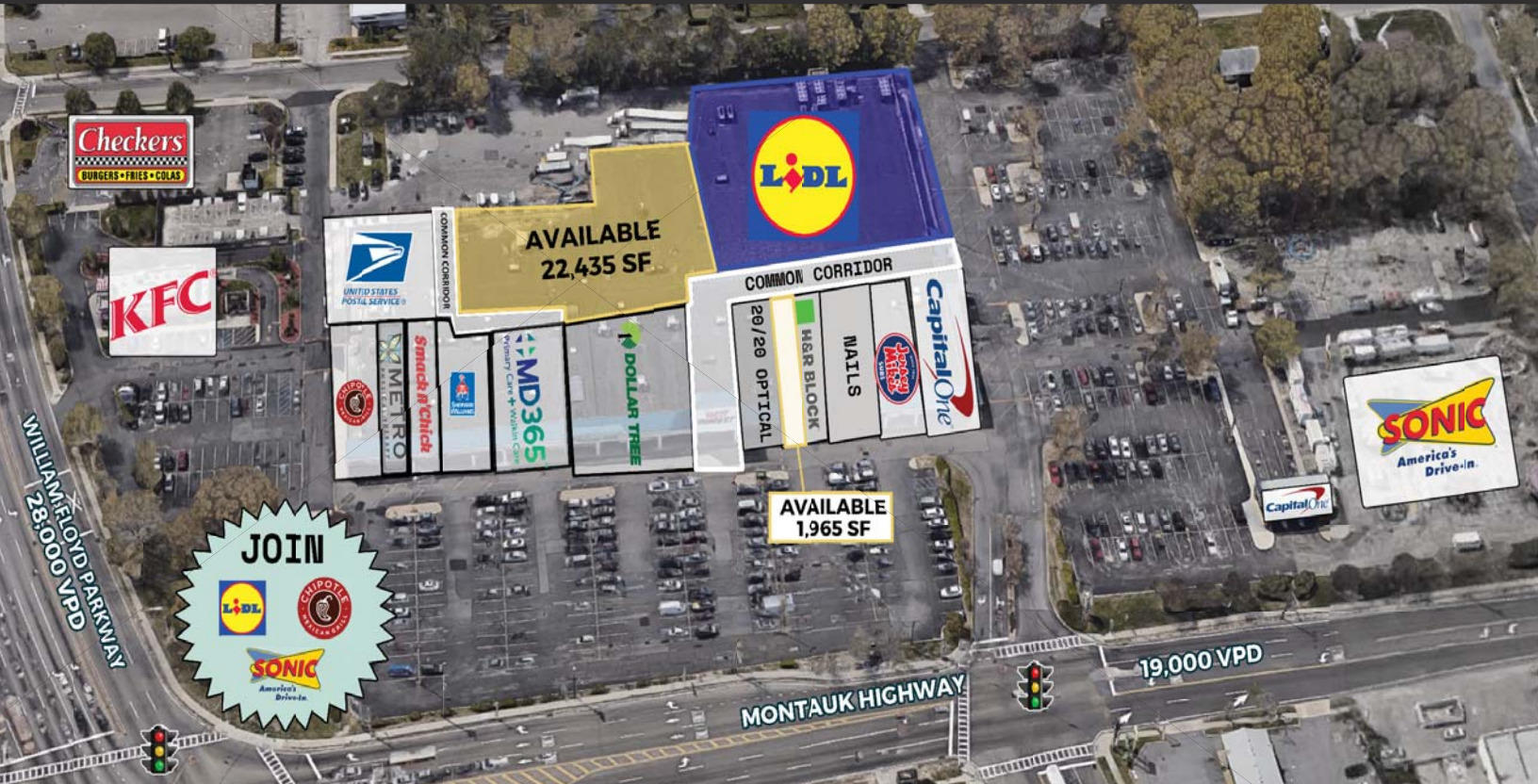

800 Montauk Highway  
Shirley, NY

Available for Lease: 1,965 SF & 22,435 SF

# FOR LEASE

800 Montauk Highway  
Shirley, NY



## JOIN LIDL | CHIPOTLE AND SONIC AT CROSSROADS TO SHIRLEY | FOR LEASE

**ADDRESS:** 800 Montauk Highway

**SPACE AVAILABLE:**  
1,965 SF and 22,435 SF

**ASKING RENT:** Upon Request

### CO-TENANTS:

LIDL, Sonic, Capital One Bank,  
Sherwin-Williams Paint Store, MD  
365, Jersey Mike's Subs, Chipotle,  
Dollar Tree, Metro Physical Therapy,  
H & R Block

Demographics	1 mile	3 miles	5 miles
Population	18,347	107,085	349,977
Median HHI	\$163,408	\$131,201	\$105,866
Daytime Population	7,016	40,238	149,659

- Grocery anchored shopping center
- Shirley's main intersection
- Four-way intersection with traffic light and incredible vehicular traffic
- Call for other potential availabilities

# FOR LEASE

800 Montauk Highway  
Shirley, NY

## 1,965 SF SPACE SITE PLAN

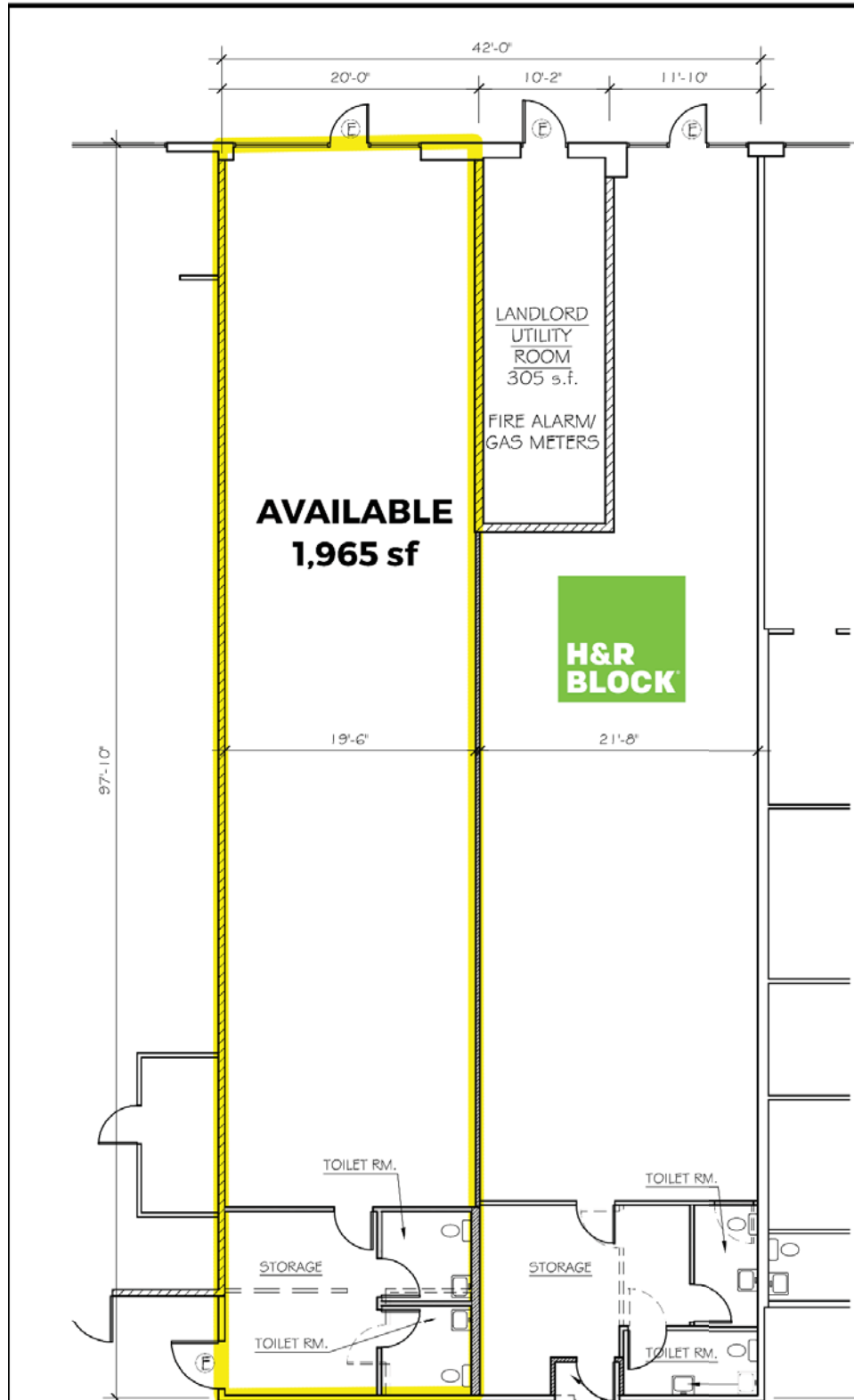

# FOR LEASE

800 Montauk Highway  
Shirley, NY

22,435 SF SPACE SITE PLAN

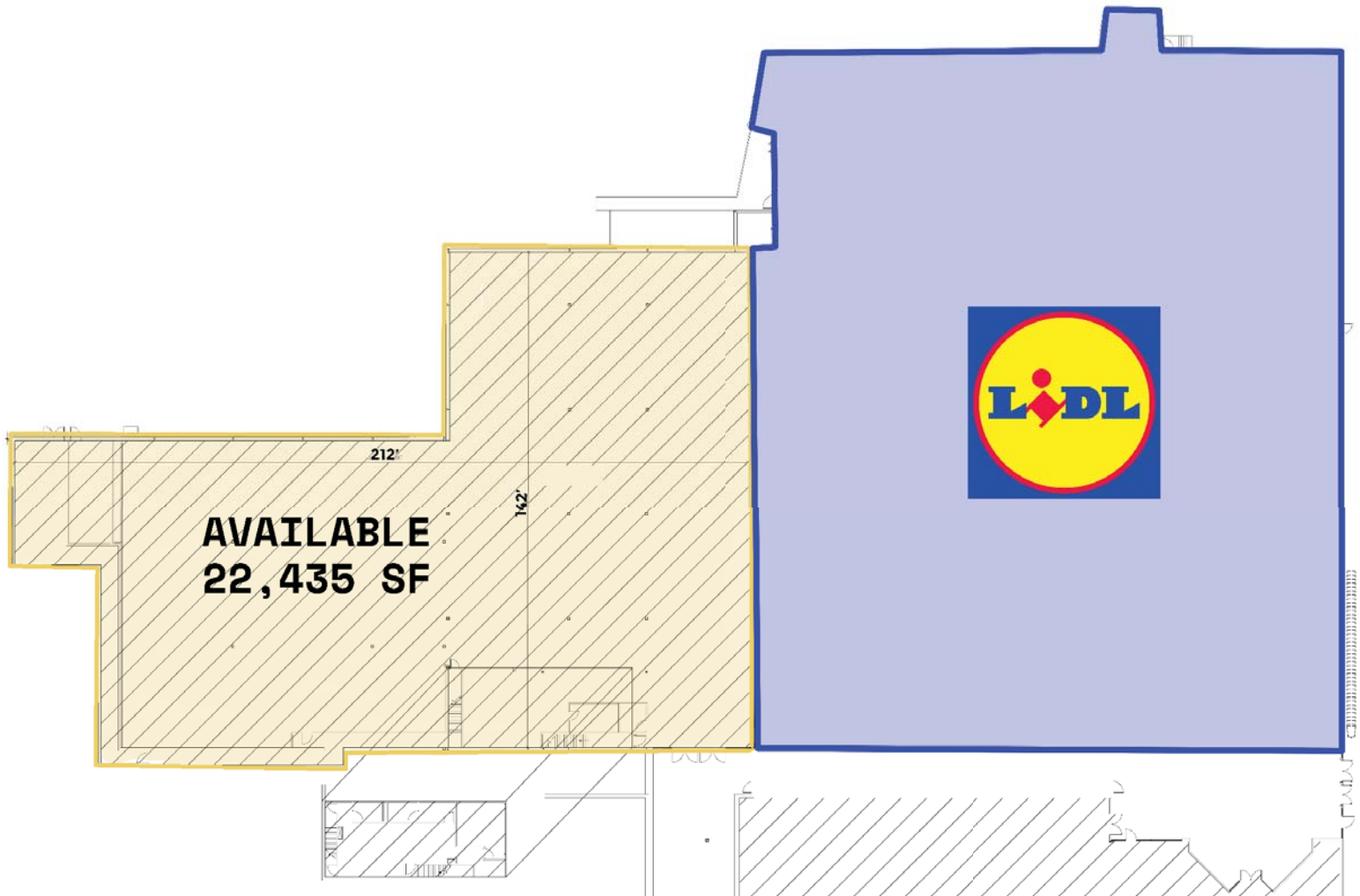

# FOR LEASE

800 Montauk Highway  
Shirley, NY

## FULL SITE PLAN

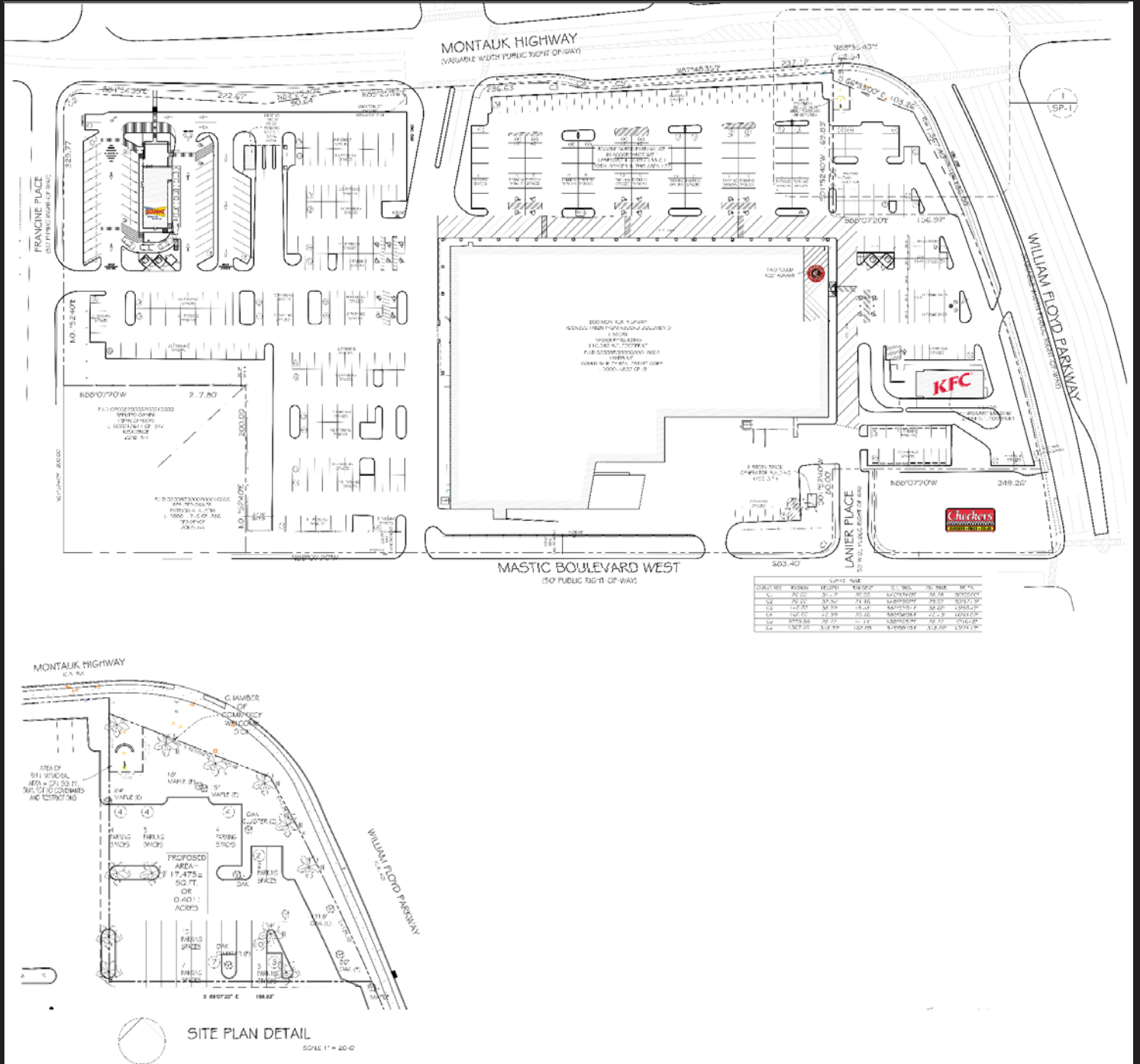

# FOR LEASE

800 Montauk Highway  
Shirley, NY

## PROPERTY PHOTOS



SABRE

Stu Fagen  
fagen@sabre.life | T 516 874 8070 x 1503

sabre.life

# FOR LEASE

800 Montauk Highway  
Shirley, NY

WELCOME TO SHIRLEY



Home of the Wertheim  
National Wildlife Refuge



Mastic- Shirley Train Station  
605+ ridership

SABRE

Stu Fagen  
fagen@sabre.life | T 516 874 8070 x 1503

sabre.life

# FOR LEASE

800 Montauk Highway  
Shirley, NY

## AREA GENERATORS

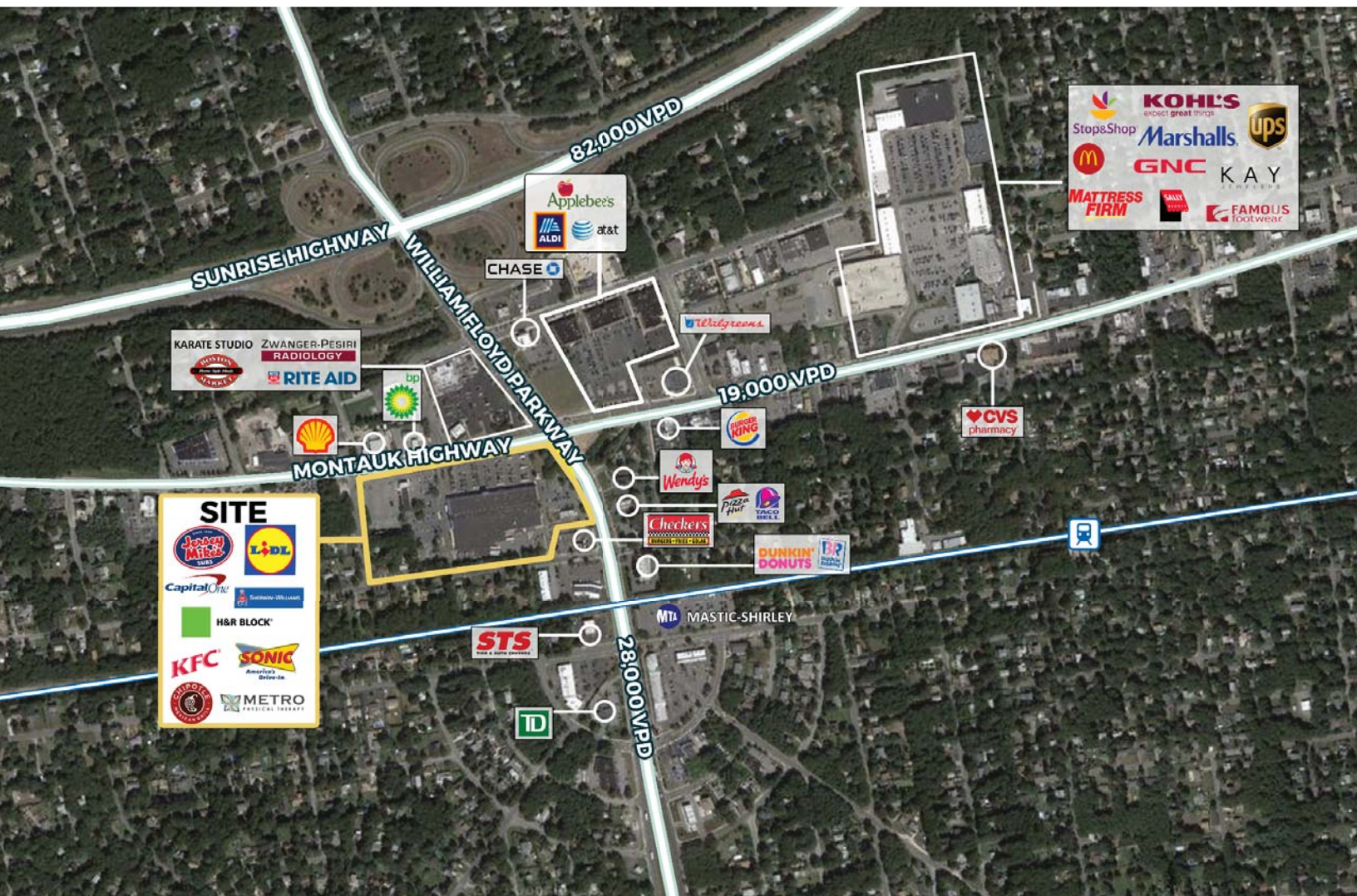

**SABRE**

Stu Fagen  
fagen@sabre.life | T 516 874 8070 x 1503

SABRE Real Estate Group, LLC | 500 Old Country Road Garden City NY 11530  
life

sabre.

© SABRE Real Estate Group, LLC. This information has been obtained from sources believed reliable. We have not verified it and make no guarantee, warranty or representation about it. Any projections, opinions, assumptions or estimates used are for example only and do not represent the current or future performance of the property. You and your advisors should conduct a careful, independent investigation of the property to determine to your satisfaction the suitability of the property for your needs.