

Elevated office in RiNo

REV  
360



# Built for Business

Smart design, premium amenities and best-in-class building features. Rev360 is brand new construction located on Brighton Boulevard, RiNo's core business district.



**170,000 SF**



**37,500 SF floor plates**



**Building signage opportunities**



**Balconies on every floor**



**LEED Certified**



**3.5/1,000 SF parking**



**Built amenity package**





Signage  
opportunities on  
building's interior  
and interior



3.5:1,000  
parking ratio



Balconies  
on every floor

150k  
sf office  
(floors 2-5)



20k  
sf retail



\$26M  
streetscape  
improvements  
completed in 2018

Rev360 - At a glance

RiNo  
at your  
doorstep



## Flexible Floor Plates

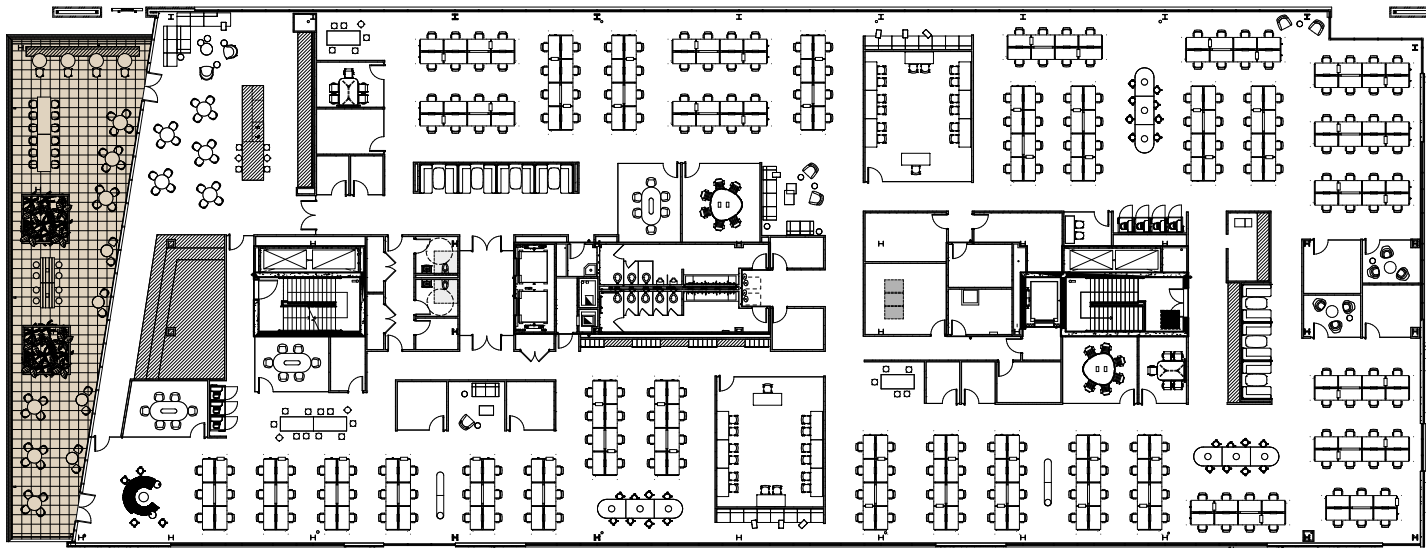

37,500 SF typical floor plate |  $\pm$ 372 people | 101 SF/person





Make  
your  
mark  
on Brighton  
Boulevard



## Abundant Amenities Easy Access

Direct access to I-70, commuter rail and downtown Denver puts the entire city within reach.

**3 blocks**  
38th & Blake  
commuter  
rail station

**5 minutes**  
Union Station  
(1 stop away)

**33 minutes**  
DEN Airport  
via RTD A Line

**3 minutes**  
I-70 via  
38th Street or  
Brighton Blvd



## Denver's Innovation Corridor

6<sup>th</sup>

Ranked city for high tech startup

35

Median resident age

9<sup>th</sup>

Ranked city for young professionals

150+

Bars and restaurants

330+

Nearby hotel rooms

9k+

Multifamily units in RiNo





# REV 360

**Elevated office in RiNo**

3600 Brighton Blvd | Denver

[rev360rino.com](http://rev360rino.com)

Although information has been obtained from sources deemed reliable, neither Owner nor JLL makes any guarantees, warranties or representations, express or implied, as to the completeness or accuracy as to the information contained herein. Any projections, opinions, assumptions or estimates used are for example only. There may be differences between projected and actual results, and those differences may be material. The Property may be withdrawn without notice. Neither Owner nor JLL accepts any liability for any loss or damage suffered by any party resulting from reliance on this information. If the recipient of this information has signed a confidentiality agreement regarding this matter, this information is subject to the terms of that agreement. ©2026. Jones Lang LaSalle IP, Inc. All rights reserved.

Perform  
Properties

**JAMES ROUPP**  
+1 303 217 7947  
[james.roupp@jll.com](mailto:james.roupp@jll.com)

**BILLY WOODWARD**  
+1 303 990 1625  
[billy.woodward@jll.com](mailto:billy.woodward@jll.com)

**LILY ARMSTRONG**  
+1 415 342 6217  
[lily.armstrong@jll.com](mailto:lily.armstrong@jll.com)

