

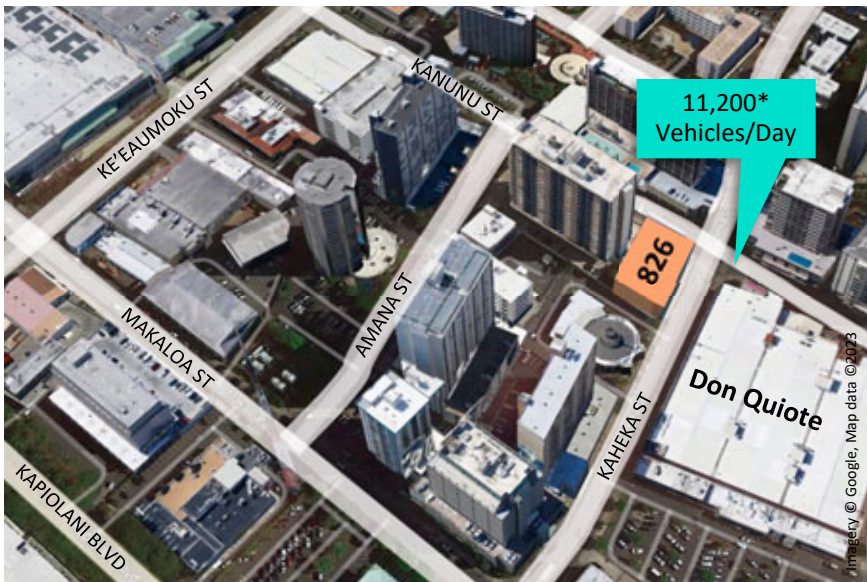

Google Earth©2023



Unit #304 - 448 SF  
2 Partioned Spaces



11,200\*  
Vehicles/Day

# FOR LEASE: RETAIL/OFFICE

## 448 SF—1,500 SF AVAILABLE

826 KAHEKA ST, HONOLULU HI 96814



1,500 SF

**Walk Score**

**WALK 98** **TRANSIT 75** **BIKE 94**

Source: ©2023 Walk Score

826 Kaheka Street is conveniently located in the Ala Moana—Kakaako neighborhood. Close to major retailers: Ala Moana Shopping Center, Walmart, Sam’s Club and Don Quijote. Highly visible with heavy foot and vehicular traffic.

Floor/Unit	RSF	GROSS RATE	DESCRIPTION
1st	1,500	\$3.95/SF/MO	Ground floor, open layout with private restroom. Electricity separately metered.
#304	448	\$2.95/SF/MO	Third Floor Office Space, Parking on property is included for monthly fee.

Posted 07/15/2024. The information has been obtained from sources believed reliable. While we do not doubt its accuracy, we have not verified it and make no guarantee, warranty or representation about it.

**Hawaii Commercial Real Estate**  
hawaiiCRE.com

**SUMMER MERIT (S), RS-83889**  
Leasing/Sales/Property Management  
808-375-9531 | summer@hawaiiCRE.com

\*Source ©2022 Kalibrate Technologies (Q3 2022)



FOR LEASE: RETAIL/OFFICE

# 826 KAHEKA FLOOR PLAN

GROUND FLOOR SPACE

M  
A  
K  
A  
L  
O  
A  
  
S  
T  
R  
E  
E  
T

K  
A  
N  
U  
N  
U  
  
S  
T  
R  
E  
E  
T

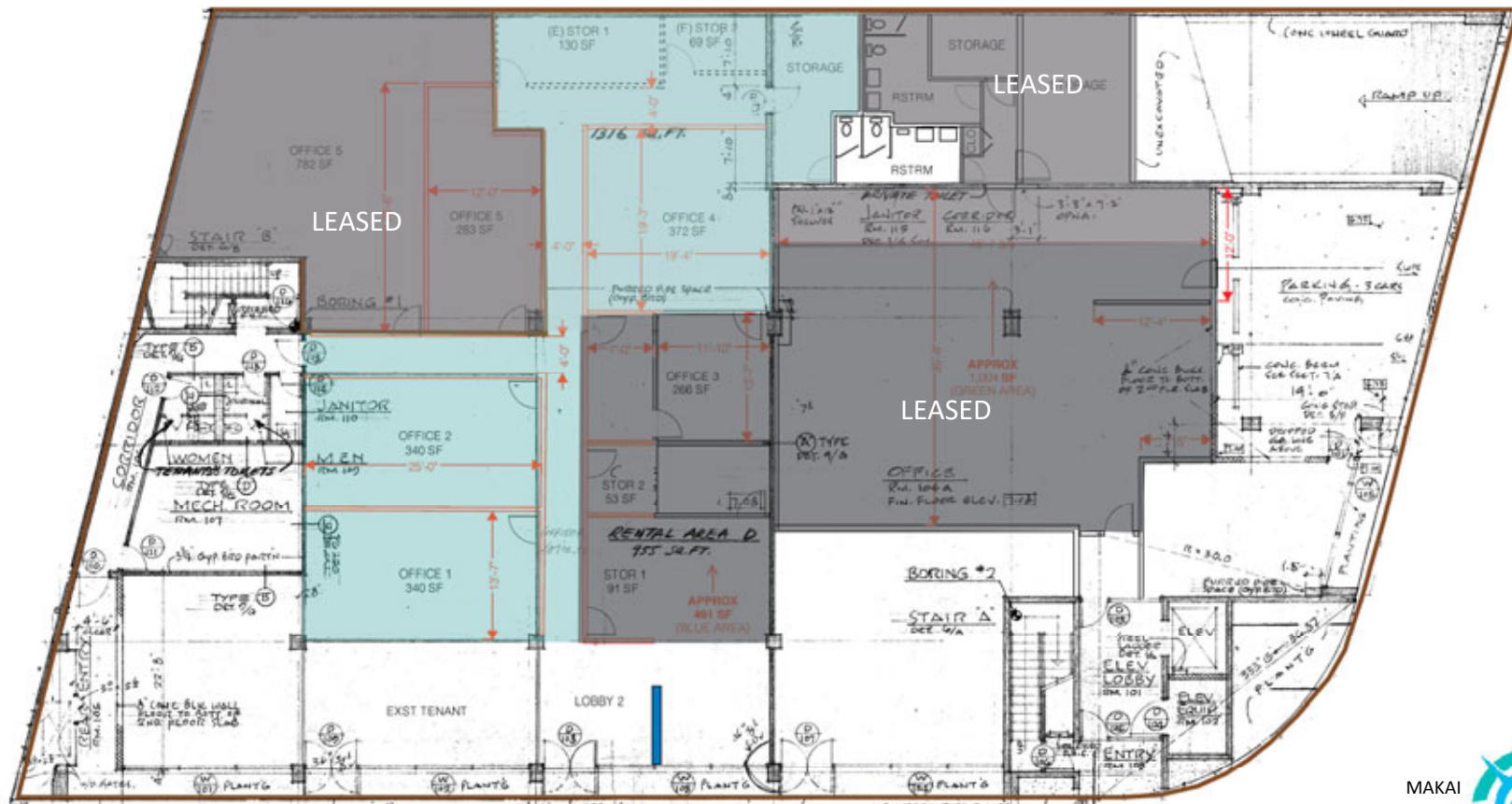

KAHEKA STREET

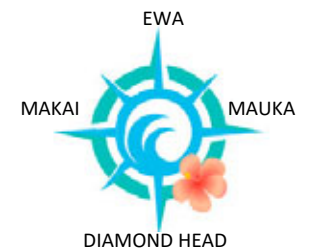

**SUMMER MERIT (S), RS-83889**, Leasing/Sales/Property Management

808-375-9531 | [summer@hawaiiCRE.com](mailto:summer@hawaiiCRE.com) | [www.hawaiiCRE.com](http://www.hawaiiCRE.com)

Posted 07/15/2024. The information has been obtained from sources believed reliable. While we do not doubt its accuracy, we have not verified it and make no guarantee, warranty or representation about it.