

Medical Office | For Sale

CBRE

137 Commerce Park Dr.

Westerville, OH 43082

Molly Leach

Senior Vice President
molly.leach@cbre.com
+1 614 332 4795

Sarah LaHue

Associate
sarah.lahue@cbre.com
+1 614 273 5714

±7,378 SF Available for Sale in Westerville, OH.



- + Investment/Owner User Opportunity
- + Asking Price: \$1,495,000
- + Layout and zoning suitable for healthcare providers and general office
- + Current annual net operating income from tenants: \$53,137.63
- + Well-maintained building with ample parking
- + Excellent signage opportunities
- + Easy access to Polaris and SR-3

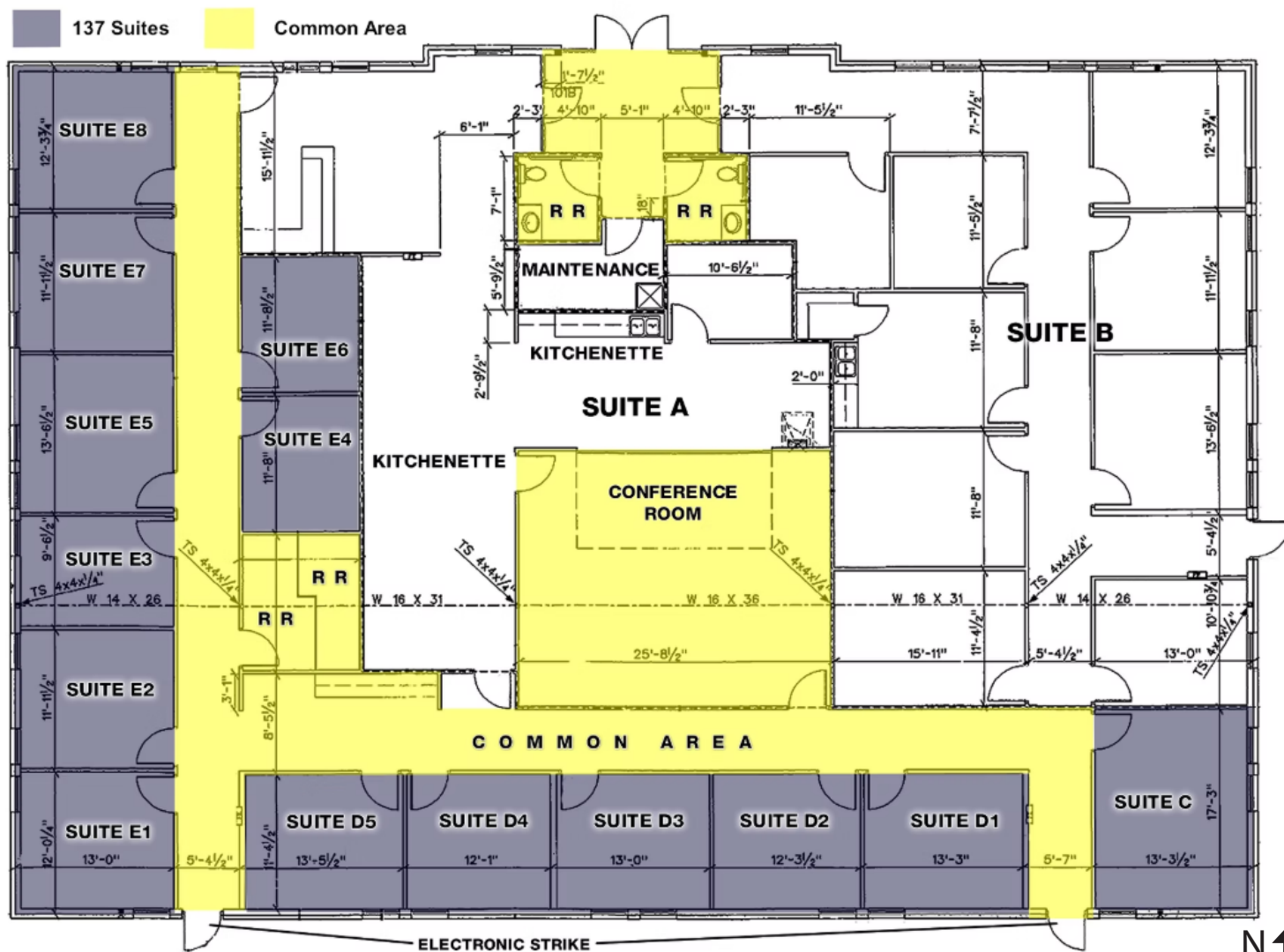

137 Commerce Park Drive
Westerville, OH 43082

For Sale



137 Commerce Park Drive
Westerville, OH 43082

For Sale

Prime Location

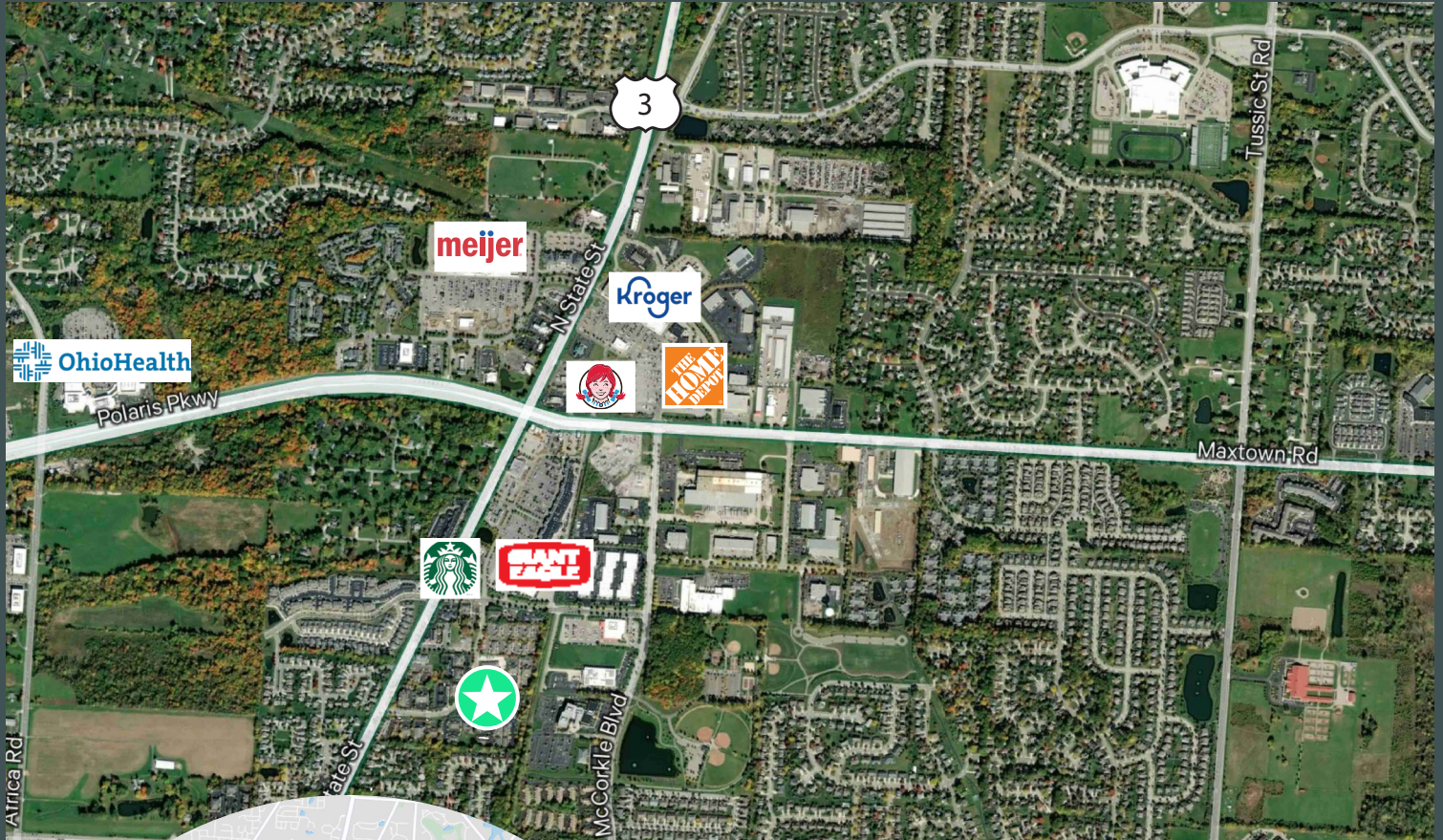

± 1.2 Miles
to Uptown Westerville

± 2.9 Miles
to I-71

± 5.3 Miles
to I-70/I-270 Split

137 Commerce Park Drive
Westerville, OH 43082

For Sale

Demographics

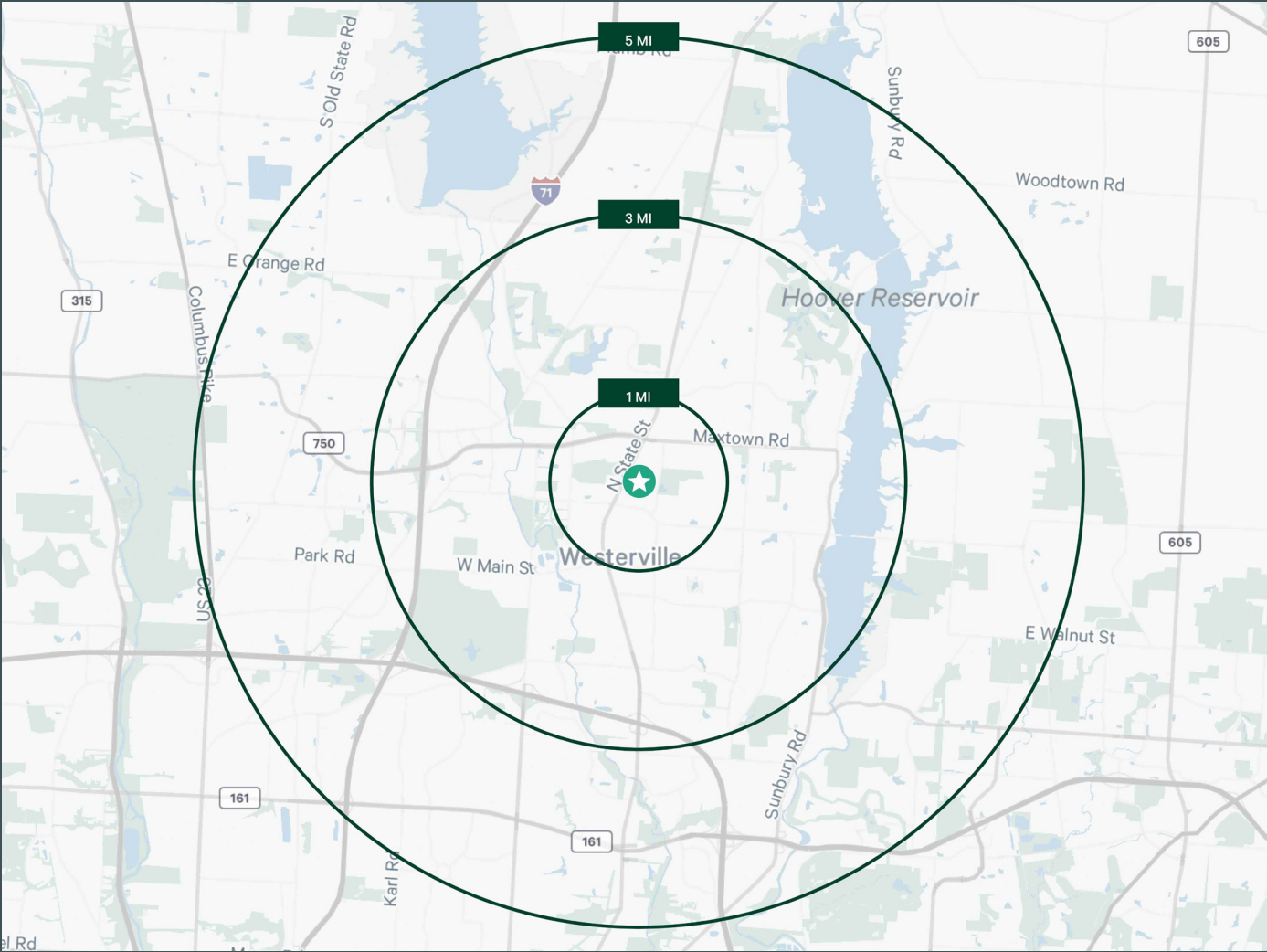

	Within a 1 Mile Radius	Within a 3 Mile Radius	Within a 5 Mile Radius
2024 Population - Current Year Estimate	8,640	68,846	164,707
2024 Average Household Income	\$130,927	\$158,647	\$127,970
Average Household Growth Rate	0.86%	1.18%	1.53%
2024 Median Age	43.9	41.3	37.6

137 Commerce Park Drive
Westerville, OH 43082

For Sale



Contact Us:

Molly Leach

Senior Vice President
molly.leach@cbre.com
+1 614 332 4795

Sarah LaHue

Associate
sarah.lahue@cbre.com
+1 614 273 5714

© 2025 CBRE, Inc. All rights reserved. This information has been obtained from sources believed reliable, but has not been verified for accuracy or completeness. You should conduct a careful, independent investigation of the property and verify all information. Any reliance on this information is solely at your own risk. CBRE and the CBRE logo are service marks of CBRE, Inc. All other marks displayed on this document are the property of their respective owners, and the use of such logos does not imply any affiliation with or endorsement of CBRE. Photos herein are the property of their respective owners. Use of these images without the express written consent of the owner is prohibited.

CBRE