

# 1101 17TH STREET, NW

DISTRICT OF COLUMBIA



## LOCATION

District of Columbia  
1101 17th Street, NW  
Washington, DC 20037

## SPACE AVAILABLE

1,682 sq. ft.

## PROPERTY OVERVIEW

1101 17th Street, seated in the heart of a vital and pulsating neighborhood, epitomizes Washington DC's professional community. The building is located just a few steps away from Connecticut Avenue, at the intersection of 17th and L Streets, and just one block from the Farragut North and Farragut West Metro stations. 1101 17th Street is surrounded by world-class restaurants, shops, and services.

## CURRENT RETAILERS

Barcode, City Place Cafe, Peet's Coffee & Tea

## DEMOGRAPHICS

RADIUS	HH INCOME	POPULATION
0.5 mile:	\$93,391	13,609
1 mile:	\$99,607	69,714
3 miles:	\$94,855	370,246

## TRAFFIC COUNT

24,292 Riders per day at Farragut North Metro Station

## CONTACT

Bob Schwenger | 301.657.7331  
[bschwenger@jbgsmith.com](mailto:bschwenger@jbgsmith.com)

Ben Brehne | 240.333.7713  
[bbrehne@jbgsmith.com](mailto:bbrehne@jbgsmith.com)

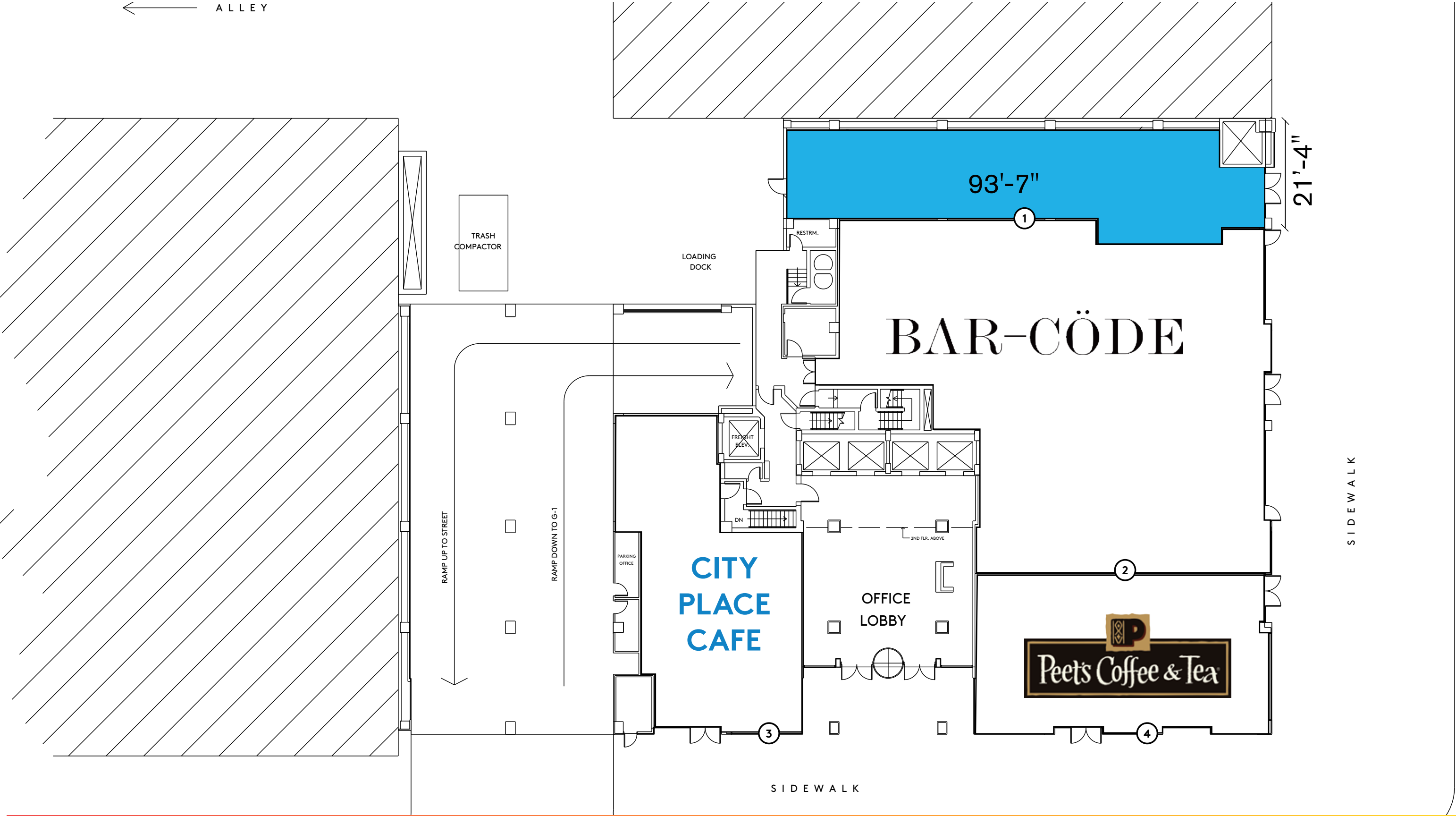

SHOPPING CENTER RETAILERS

1	Available	1,682 SF	3	City Place Cafe	1,676 SF
2	Barcode	4,562 SF	4	Peet's Coffee & Tea	1,833 SF



# 1101 17TH STREET, NW / AERIAL





