

FOR LEASE

1,502 SF - 15,855 SF

Attractive & Affordable Office Suites

1645 NE Forbes Rd., Bend, OR 97701



EXCELLENT VISIBILITY ALONG HIGHWAY 20



COMPASS
COMMERCIAL

REAL ESTATE
SERVICES

Graham Dent, SIOR

600 SW Columbia St., Ste. 6100 | Bend, OR 97702

541.639.6515 | www.CompassCommercial.com



SUMMIT WEST

Teri West

920 NW Bond St., Suite 200 | Bend, OR 97703

541.420.6567

FOR LEASE

\$1.65-\$1.75/SF/MO. NNN

Attractive & Affordable Office Suites in Bend

PROPERTY DETAILS

Suite 100: 15,855 SF - \$1.65/SF/Mo.

Suite 106: 1,502 SF - \$1.75/SF/Mo.

Suite 107: 3,193 SF - \$1.65/SF/Mo.

CAMs: Est. at \$0.85/SF/Mo.
**Utilities included*

Bldg. Size: 30,544 SF

Lot Size: 2.12 Acres

Year Built: 1983 (Renovated in 2017)

Zoning: Commercial General (CG)

Parking: 4.1/1,000 SF

HIGHLIGHTS

- **Suite 100:** Space includes 24 private offices, four large conference or training rooms, reception area, four restrooms including showers, print/copy room, breakroom and large open area
- **Suites 106 & 107:** Newly constructed spaces each including multiple private offices, conference room, small break area and shared restrooms
- Recently remodeled office suites with lots of natural light
- Centrally located in Bend along Hwy 20
- Excellent onsite parking
- Close to restaurants and shopping
- Located across from Pilot Butte State Park



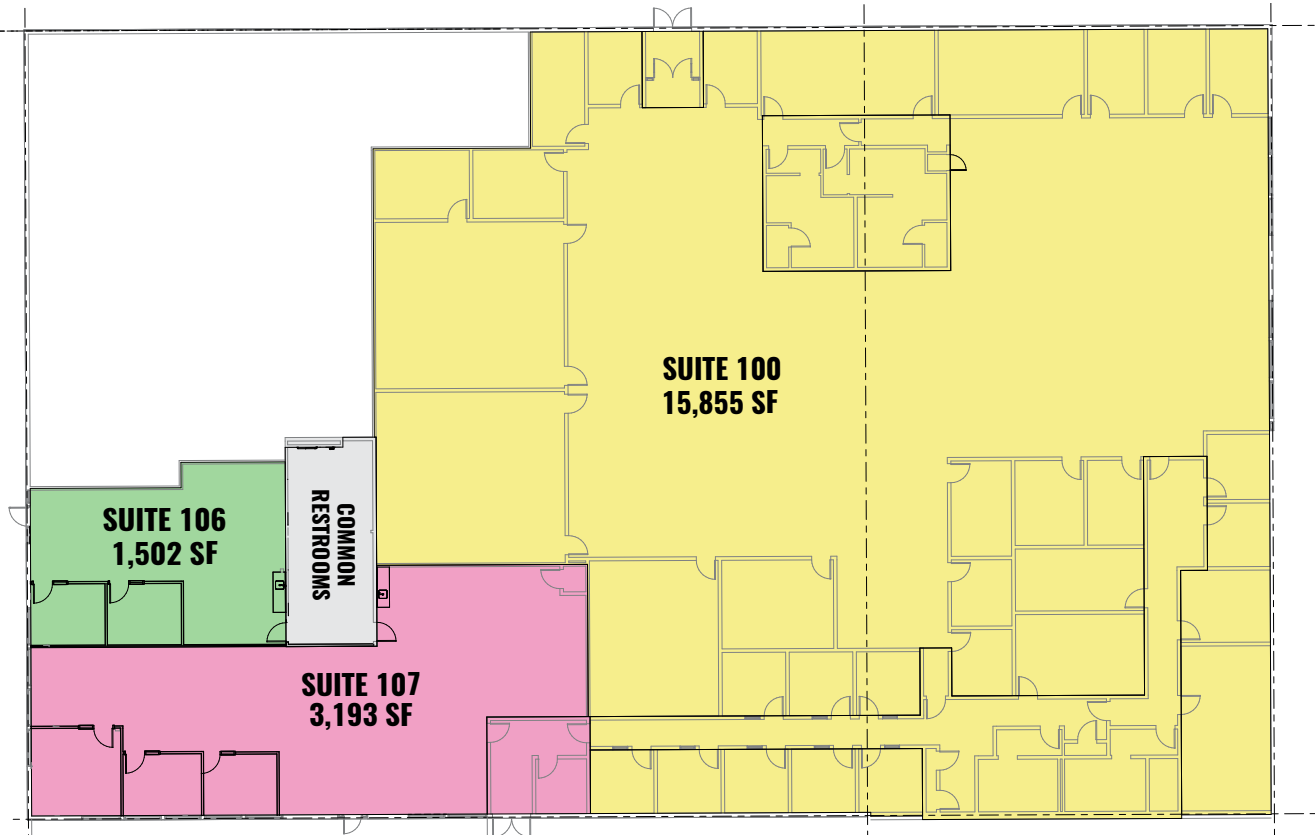

*Conceptual floor plan for suites 106 & 107



FOR LEASE

1645 NE Forbes Rd., Bend, OR 97701

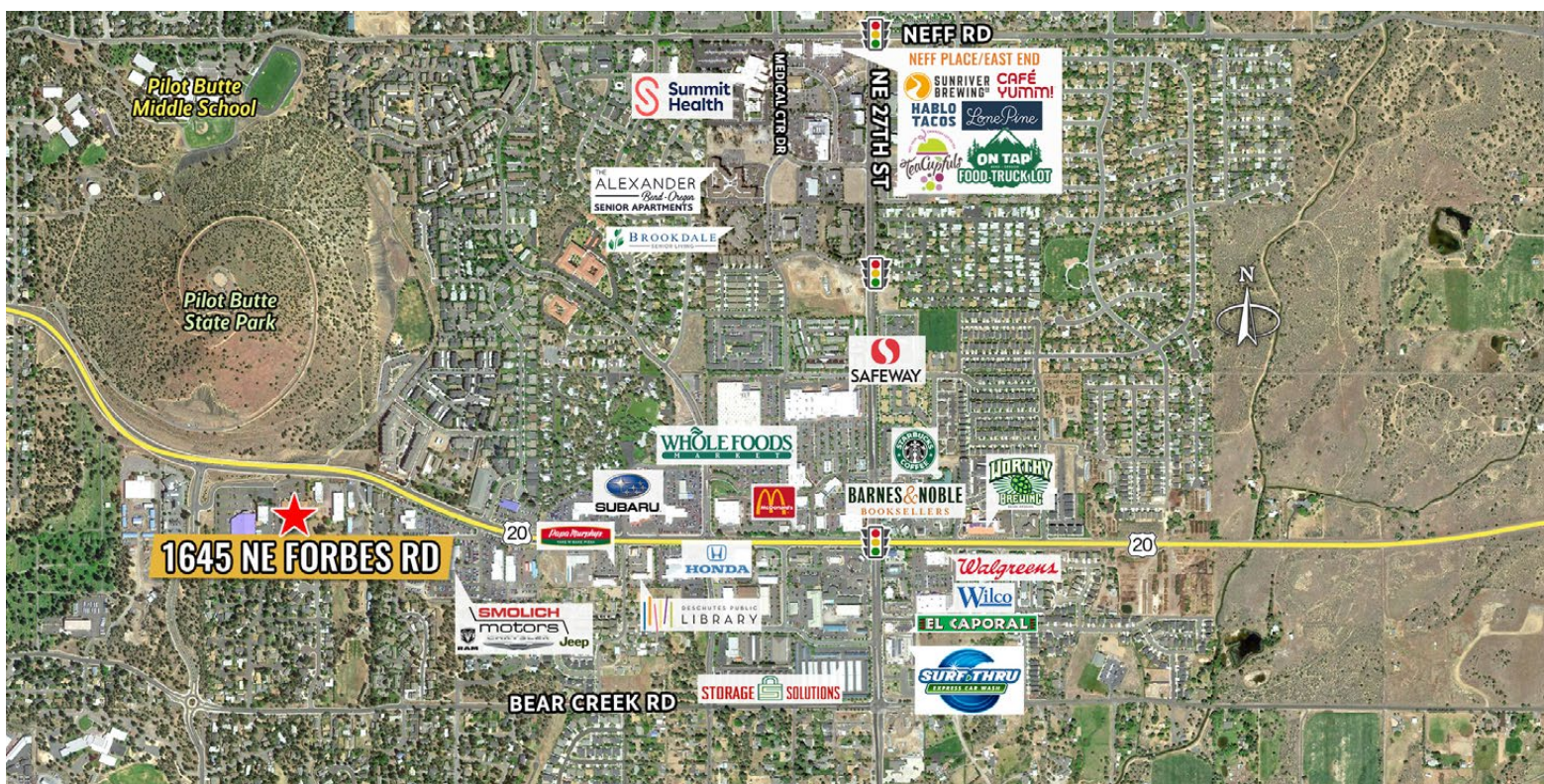

Brokers are licensed in the state of Oregon. This information has been furnished from sources we deem reliable, but for which we assume no liability. This is an exclusive listing. The information contained herein is given in confidence with the understanding that all negotiations pertaining to this property be handled through Compass Commercial Real Estate Services. All measurements are approximate.



Graham Dent, SIOR
Partner, Broker
Cell 541.639.6515
gdent@compasscommercial.com

COMPASS
COMMERCIAL
REAL ESTATE
SERVICES



Teri West
Broker
Cell 541.420.6567
summitwestpm@gmail.com

SUMMIT WEST