



COMMERCIAL.

**WAREHOUSE SPACE
AVAILABLE FOR SALE**

HIGHLIGHTS

- Asking Price: \$2,750,000.00
- Building \$/per SQ FT: \$55.16
- Property Type: Warehouse
- SQFT: 49,852
- SQFT Lot: 70,567
- Acres: 1.620
- Land use: Industrial, Office
- Parcel #: 032-102-002-000
- Listing ID: SN18160625
- Zoning: M-Industrial
- County: Glenn
- Utilities: City Services
- Clear span: 120 feet
- Suitable for: Warehouse/ Distribution,
Warehouse/ Office



**250 WALSH AVENUE
HAMILTON CITY, CA 95951**

www.selectcommercialgroup.com



**SELECT
COMMERCIAL
GROUP**

The award-winning Select Group of Real Estate Companies include the prestigious brands of Century 21, Coldwell Banker, and the Select Commercial Group. Providing exceptional customer service at the local, regional, national, and international level, our experienced commercial real estate agents are here to discuss your real estate growth



COMMERCIAL.

250 WALSH AVE

C E N T U R Y 2 1
T U R T U R T U R T U
Y 2 1 Y 2 1 Y 2 1 Y
C E N C E N C E N C E
T U T U T U T U T U
Y 2 1 Y 2 1 Y 2 1 Y
C E N C E N C E N C E
T U R T U R T U
V 3 1 V 3 1 V 3 1 V

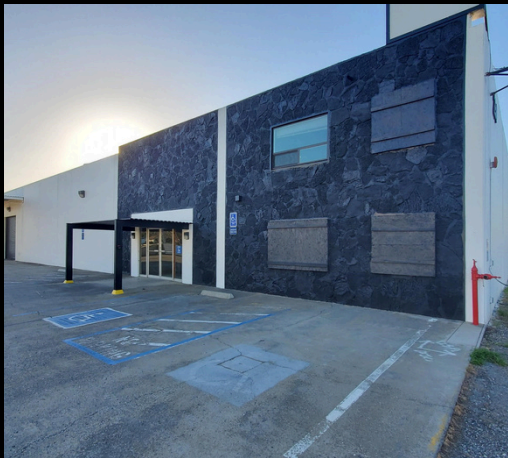

Commercial building zoned M-industrial in Hamilton City, Ca. Situated on 1.62 acres and located just three blocks off Hwy 32. Southern Pacific railroad spur line runs along the back length of property.

www.selectcommercialgroup.com



**SELECT
COMMERCIAL
GROUP**

The award-winning Select Group of Real Estate Companies include the prestigious brands of Century 21, Coldwell Banker, and the Select Commercial Group. Providing exceptional customer service at the local, regional, national, and international level, our experienced commercial real estate agents are here to discuss your real estate growth



COMMERCIAL.

250 WALSH AVE

C E N C E N C E N C E N C E
T U R T U R T U R T U R T U
Y 2 1 Y 2 1 Y 2 1 Y 2
C E N C E N C E N C E N C
T U R T U R T U R T U R T U
Y 2 1 Y 2 1 Y 2 1 Y 2
C E N C E N C E N C E N C
V S I V S I V S I V S I V



A unique opportunity for industrial warehousing located on rail in the heart of the North states nut producing area. Up to 49,852 SF available. Current negotiations are in place with the Railroad for line improvements. Ten roll up doors. See floor plans for roll up door dimensions and location. The property has three phase, 400 amp power service. Unit A is currently on a mo/mo lease.

www.selectcommercialgroup.com



**SELECT
COMMERCIAL
GROUP**

The award-winning Select Group of Real Estate Companies include the prestigious brands of Century 21, Coldwell Banker, and the Select Commercial Group. Providing exceptional customer service at the local, regional, national, and international level, our experienced commercial real estate agents are here to discuss your real estate growth

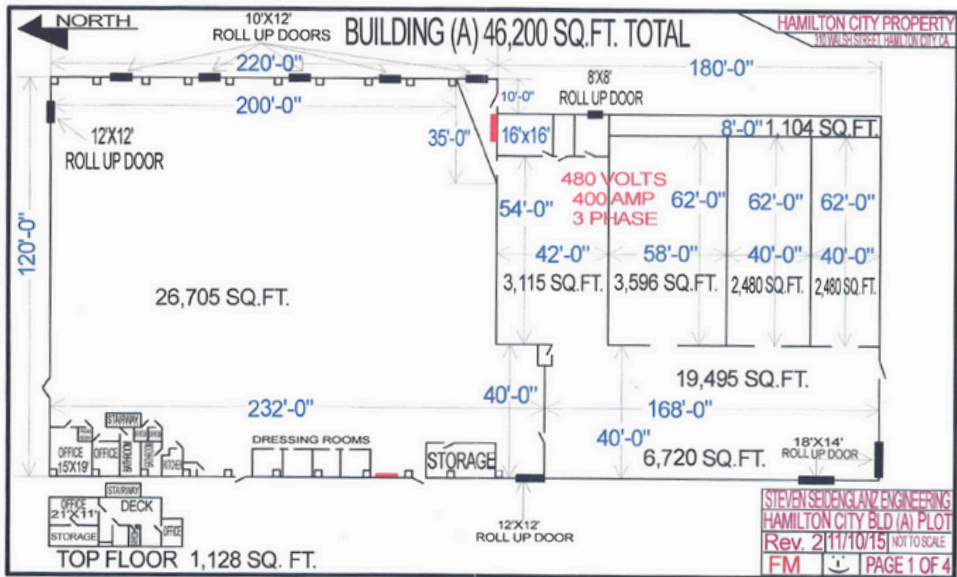



COMMERCIAL.

PHOTOS

C E N C E N C E N C U
T U R T U R T U R T U
Y 2 1 Y 2 1 Y 2 1 Y
C E N C E N C E N C U
T U R T U R T U R T U
Y 2 1 Y 2 1 Y 2 1 Y
C E N C E N C E N C U
T U R T U R T U R T U
Y 2 1 Y 2 1 Y 2 1 Y



www.selectcommercialgroup.com



**SELECT
COMMERCIAL
GROUP**

The award-winning Select Group of Real Estate Companies include the prestigious brands of Century 21, Coldwell Banker, and the Select Commercial Group. Providing exceptional customer service at the local, regional, national, and international level, our experienced commercial real estate agents are here to discuss your real estate growth

21

COMMERCIAL.

PHOTOS

C E N C E N C E N C E N C E N C E
T U R T U R T U R T U R T U R T U
Y 2 1 Y 2 1 Y 2 1 Y 2 1 Y 2
C E N C E N C E N C E N C E N C E
T U R T U R T U R T U R T U R T U
Y 2 1 Y 2 1 Y 2 1 Y 2 1 Y 2
C E N C E N C E N C E N C E N C E
T U R T U R T U R T U R T U R T U
Y 2 1 Y 2 1 Y 2 1 Y 2 1 Y 2



www.selectcommercialgroup.com



**SELECT
COMMERCIAL
GROUP**

The award-winning Select Group of Real Estate Companies include the prestigious brands of Century 21, Coldwell Banker, and the Select Commercial Group. Providing exceptional customer service at the local, regional, national, and international level, our experienced commercial real estate agents are here to discuss your real estate growth

21

COMMERCIAL.

FOR MORE INFORMATION,
CONTACT US:



Frank Ross

DRE # 01014400

530-624-6375

Frank@norcalemail.com

1101 El Monte Ave Chico CA 95928



Jen Spaletta

DRE # 02060245

530-567-8182

Jen.Spaletta@c21selectgroup.com

1101 El Monte Ave Chico CA 95928

www.selectcommercialgroup.com



SELECT
COMMERCIAL
GROUP

The award-winning Select Group of Real Estate Companies include the prestigious brands of Century 21, Coldwell Banker, and the Select Commercial Group. Providing exceptional customer service at the local, regional, national, and international level, our experienced commercial real estate agents are here to discuss your real estate growth