



751 Garden Commerce Pkwy, Winter Garden, FL 34787

For Lease

Demographic

3 Mile Radius
Population: 59k
Median Income: \$85k

Highlights

- Built in 2023
- Available Immediately
- 8,545 SF can be subdivided into smaller units
- 2 Overhead doors
- Oversized parking lot
- Garden Commerce to be connected to W Colonial in the near future
- Rate: Contact Listing Agent

Jay Stewart, Realtor ®
(407) 913-2677
JayStewart.RE@gmail.com

Conceptual Plan

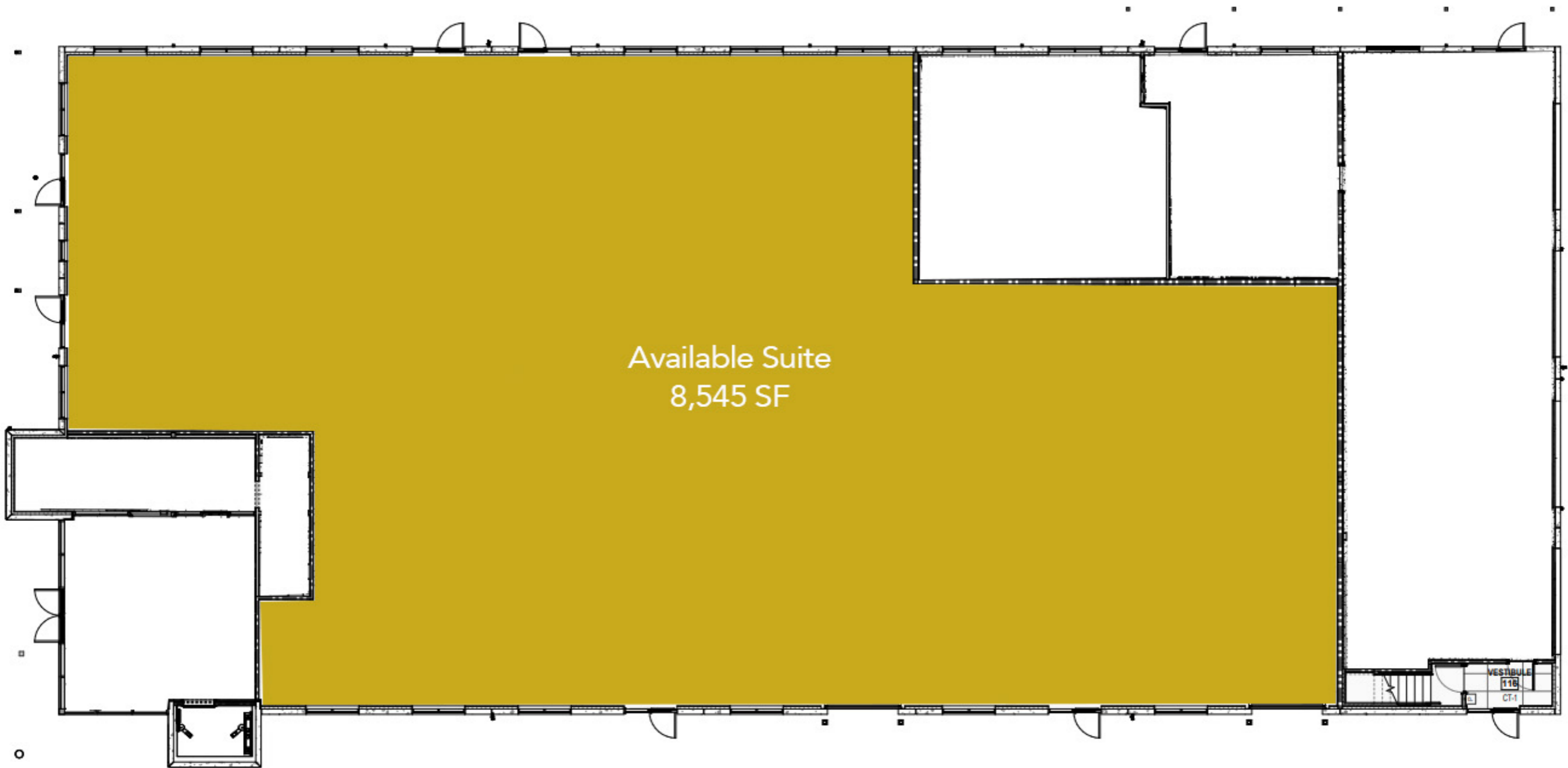

Mike Stewart (407) 766-9826



Jay Stewart (407) 913-2677

Demographics



Population

1 MI 3MI 5 MI
7K 59K 142K

Median income

1 MI 3 MI 5 MI
\$61K \$85K \$90K

SOURCE: U.S. Census Bureau, 2022 American Community Survey, Tables B01001, B01002, B01003, and B19013.

Mike Stewart (407) 766-9826



Jay Stewart (407) 913-2677