

B. W. ADAMS SURVEY, ABSTRACT NUMBER 101 HARRIS COUNTY TEXAS

SOUTHWEST CROSSING SECTION SIX
HARRIS COUNTY TEXAS

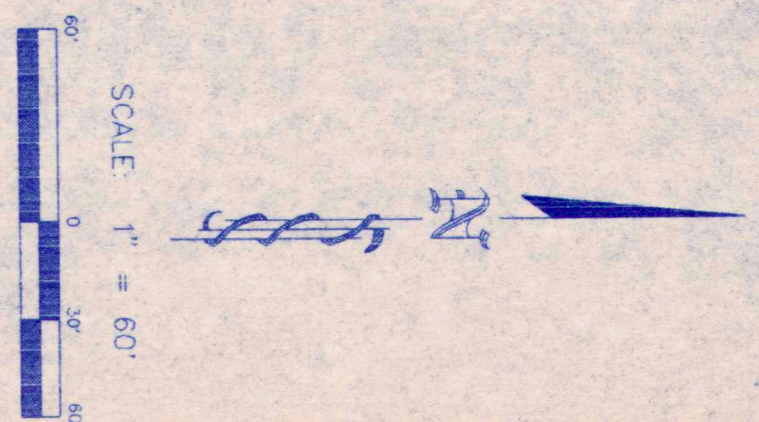

3,000 ACRES
130,681 SQ. FEET
WOODED NO IMPROVEMENTS

HILLCROFT AVENUE
100.0 R.O.W. (Divided-Concrete)
Vol. 7542, Pg. 466 H.C.D.R.

DUNLAP DRIVE
60.0 R.O.W. (Concrete)

POINT OF BEGINNING FOR THE 3,000 ACRE TRACT

DESCRIPTION OF A 3,000 ACRE LAND BEING PART OF UNRESTRICTED RESERVE "B", BLOCK 2 OF SOUTHWEST CROSSING SECTION SIX IN THE CITY OF HOUSTON, HARRIS COUNTY, TEXAS

All that tract or parcel containing 3,000 acres (130,681 square feet) of land situated in the C.W. Adams Survey, Abstract No. 101, Harris County, Texas, Section Six, as reflected on the map or plat thereof recorded in Volume 317, Page 67 of the Map Records of Harris County, Texas (Tract 10) which was conveyed to Arthur S. Friedman, Trustee of the Adams Survey, by deed recorded in Volume 1988, Page 475 and 479 of the Harris County Deed Records as shown on said plat of Southwest Crossing Section Six and being the most southerly, quarter corner thereof.

THENCE South 63 degrees 41 minutes 45 seconds West, with the northerly right-of-way line of said Hillcroft Avenue, a distance of 655.21 feet to a 1/2 inch iron rod set for the southwest corner of a Hillcroft Substation, commonly known as Blue Ridge Substation, shown on Acreage on plot of Southwest Crossing Section Six, for the southwest corner thereof.

THENCE South 63 degrees 41 minutes 45 seconds West, with the northerly right-of-way line of said Hillcroft Avenue, a distance of 655.21 feet to a 1/2 inch iron rod set for the southwest corner of a Hillcroft Substation, commonly known as Blue Ridge Substation, shown on Acreage on plot of Southwest Crossing Section Six, for the southwest corner thereof.

THENCE North 26 degrees 18 minutes 15 seconds West, with the northerly right-of-way line of said Hillcroft Avenue, a distance of 655.21 feet to a 1/2 inch iron rod set for the southwest corner of a Hillcroft Substation, commonly known as Blue Ridge Substation, shown on Acreage on plot of Southwest Crossing Section Six, for the southwest corner thereof.

THENCE North 63 degrees 41 minutes 45 seconds East, a distance of 258.18 feet to a 1/2 inch iron rod set for an angle point thereof.

THENCE North 06 degrees 55 minutes 05 seconds East, a distance of 258.61 feet to a 1/2 inch iron rod set in the southwest right-of-way line of Dunlap Drive, based on a 1/2 inch iron rod set in the southwest right-of-way line of Dunlap Drive, based on the north-south line of Hillcroft Avenue, a distance of 14.14 feet to the **POINT OF BEGINNING** and containing 3,000 acres (130,681 square feet) of land.

TITLE INFORMATION
CHARTER TITLE COMPANY
5102 SMO FELPE
HOUSTON, TEXAS 77287
(713) 871-9700

ESGROW OFFICER: FRANCIS C. STOLLE
G.F. NO.: 99172600 DATED: MARCH 10, 1999
RECORD TITLE: ARTHUR S. FRIEDMAN, TRUSTEE
PROPOSED INSURED: ROCKA HIRSHOUT AND LINDA M. HIRSHOUT

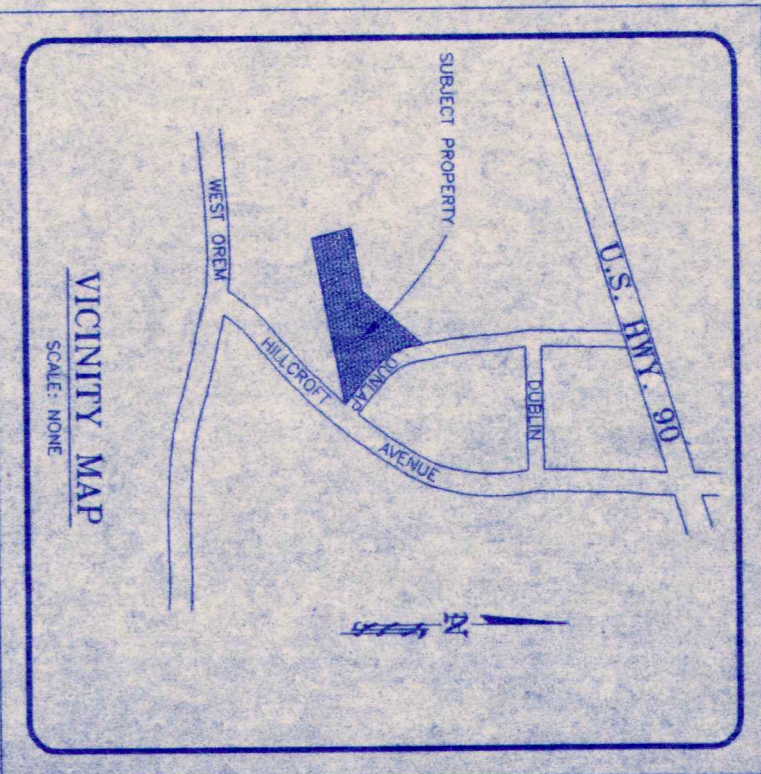

NOTES:

1. This survey was performed with the benefit of a title commitment from Insurance Corporation (C.F. No. 9917040) effective date March 10, 1999. No search of the public records has been made by this surveyor.
2. Boundaries reflected herein are referenced to Southwest Crossing Section Six, recorded in Volume 317, Page 67 of the H.C.M.R.
3. Surveyor did not locate underground utilities or improvements except as shown.
4. This property is subject to City of Houston Ordinance No. 65-1878 dated October 1, 1965, which provides for the assessment of flood insurance taxes on property in flood hazard areas. Said ordinance provides for the assessment of flood insurance taxes on property in flood hazard areas. Said ordinance provides for the assessment of flood insurance taxes on property in flood hazard areas.
5. Description of new data accompanies this plat.
6. Property subject to restrictions recorded in Volume 317, Page 67 H.C.M.R.

FLOOD PLAIN CERTIFICATION

This tract of land lies partially within Zone "X" (Unshaded) and Zone "Y" (Shaded) as designated on an Acre Determination to be issued by the Flood Insurance Administration. The flood insurance rate for Zone "X" is 1.00 and for Zone "Y" is 1.25. The flood insurance rate for Zone "X" is 1.00 and for Zone "Y" is 1.25. The flood insurance rate for Zone "X" is 1.00 and for Zone "Y" is 1.25.

SURVEYORS CERTIFICATION

I hereby certify that this survey was made on the ground, March 10, 1999, and that the facts reported of the line of the survey and that this survey substantially complies with the current Texas Surveyors Act, Chapter 81, Sections 81.001 and 81.002, and the rules and regulations of the State Board of Surveyors.

MICHAEL S. MARTINEZ
Registered Professional Land Surveyor No. 4516
3-50-99

Mike Martinez & Associates, Inc.
1137 Gardendale Drive
Houston, Texas 77018
Phone: (713) 869-1122
Fax: (713) 869-3190

LAND TITLE SURVEY			
BLOCK	014	SECTION	WEST
RANGE	1-3	SURVEY	ADAMS
TRACT	101	SECTION	WEST
PLAT	1-3	SECTION	WEST