

FOR SALE/LEASE

55

MORLEY STREET

HAMILTON, ON

Rare Freestanding Building In Core Location!

For More Information Contact Us:

Industrial

JONATHAN LEARY*

Executive Vice President
905 315 3695

jonathan.leary@cbre.com

MAX LEWIS

Sales Representative
905 315 3692

max.lewis@cbre.com

Capital Markets

JORDAN LUNAN*

Vice President
416 798 6270

Jordan.Lunan@cbre.com

BRETT THORNE

Sales Representative
416 798 6297

Brett.Thorne@cbre.com

Property Details

SALE PRICE	\$2,799,000
LEASE PRICE	\$14.00 net per Sq. Ft.
TOTAL SIZE	9,540 Sq. Ft. (+ additional +/- 800 SF of enclosed storage space)
OFFICE	2,340 Sq. Ft.
WAREHOUSE	7,200 Sq. Ft.
CLEAR HEIGHT	14'
SHIPPING	2 Drive in doors
PROPERTY TAXES	\$7,069.10 (2024)
CRANE	1 ton jib crane

Property Highlights

- Rare opportunity to acquire a well maintained freestanding industrial building in a core Hamilton location
- Excellent access to the QEW and Red Hill Valley Parkway
- Well appointed office space with ample private offices, plus a small basement area (not included in square footage) for additional storage
- Owner is also open to a short-term lease – contact listing team for details



Aerial Plan



Additional +/- 800 sq.
ft. of storage space
serviced by 3 roll up
doors (not included in
total square footage)

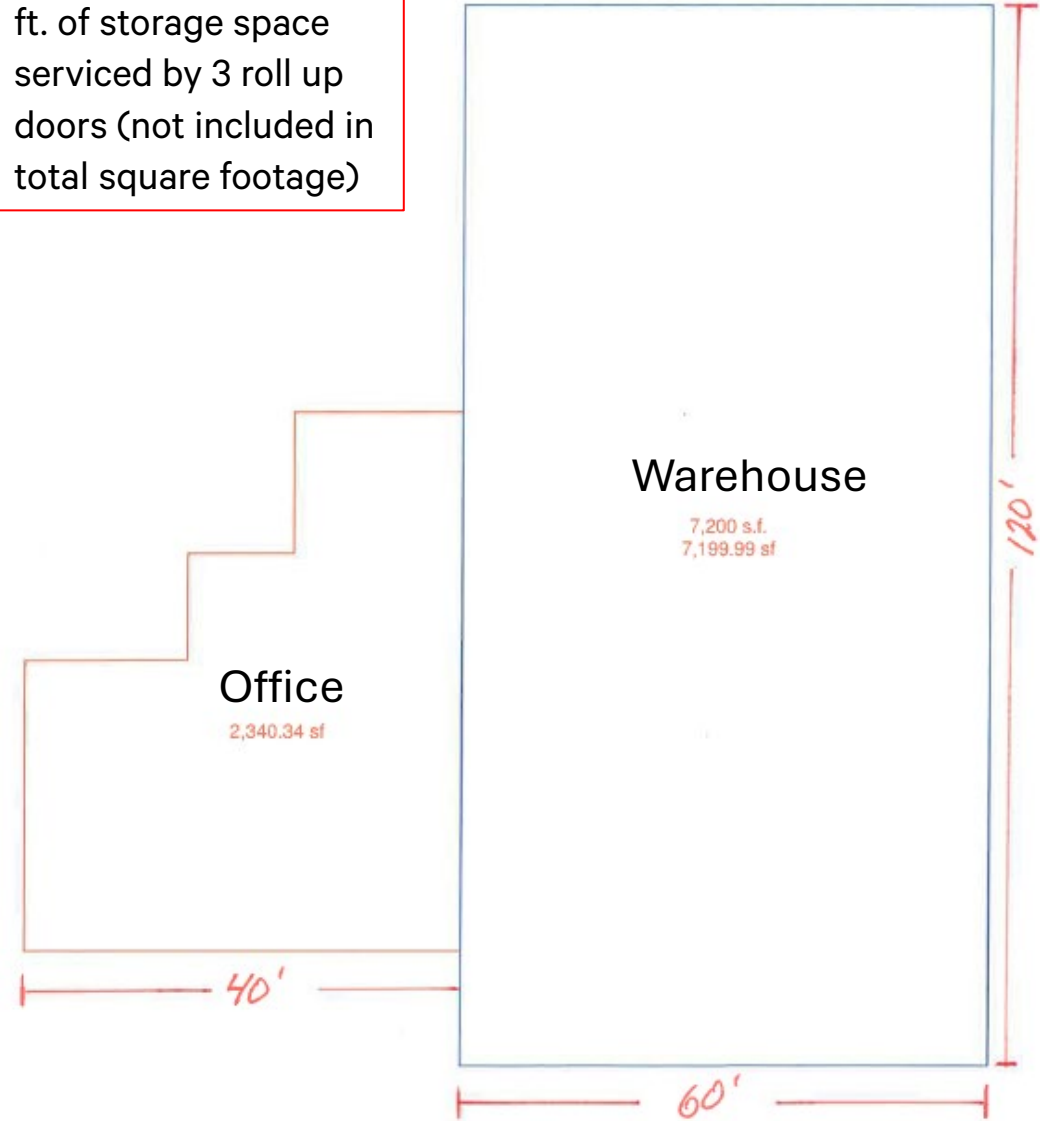

ROOMS AND DIMENSIONS:

- ESTIMATING/PROJECT MANAGEMENT (13x8)
- ESTIMATING/PROJECT MANAGEMENT (10x7)
- ESTIMATING/PROJECT MANAGEMENT (15x9)
- BUSINESS DEVELOPMENT (12x10)
- COMMERCIAL MANAGER (10x7)
- RECEPTION
- KITCHEN (11x11)
- WASHROOM (7x9)
- WASHROOM (7x9)
- TRAINING & DEVELOPMENT
- BOARDROOM (6x22)
- WASHROOM
- WASHROOM
- CONTROLLER (7x11)
- PROJECT MANAGEMENT (7x11)
- AP / AR (11x21)
- CLOSET
- PROJECT MANAGEMENT (51x21)
- INDUSTRIAL PM (81x21)
- VICE PRESIDENT (161x91)
- SAFETY EQUIPMENT
- FLEET & FACILITIES MANAGER & EQUIPMENT COORDINATOR (11x12)
- EXIT (12x12)
- EXIT (12x12)
- EXIT (12x12)
- ROLL UP DOOR (12x12)
- SHOP AREA
- PROJECT STORAGE
- TOOL ROOM
- PAINT STORAGE
- FILE ROOM
- EXTERIOR STORAGE

Other Features:

- North Arrow (N)
- Brighton Avenue
- Morley Street
- Muster Point
- Roll Up Doors
- Exits
- Shop Area

Property Photos



Property Photos



FOR SALE/LEASE

55
MORLEY STREET
HAMILTON, ON

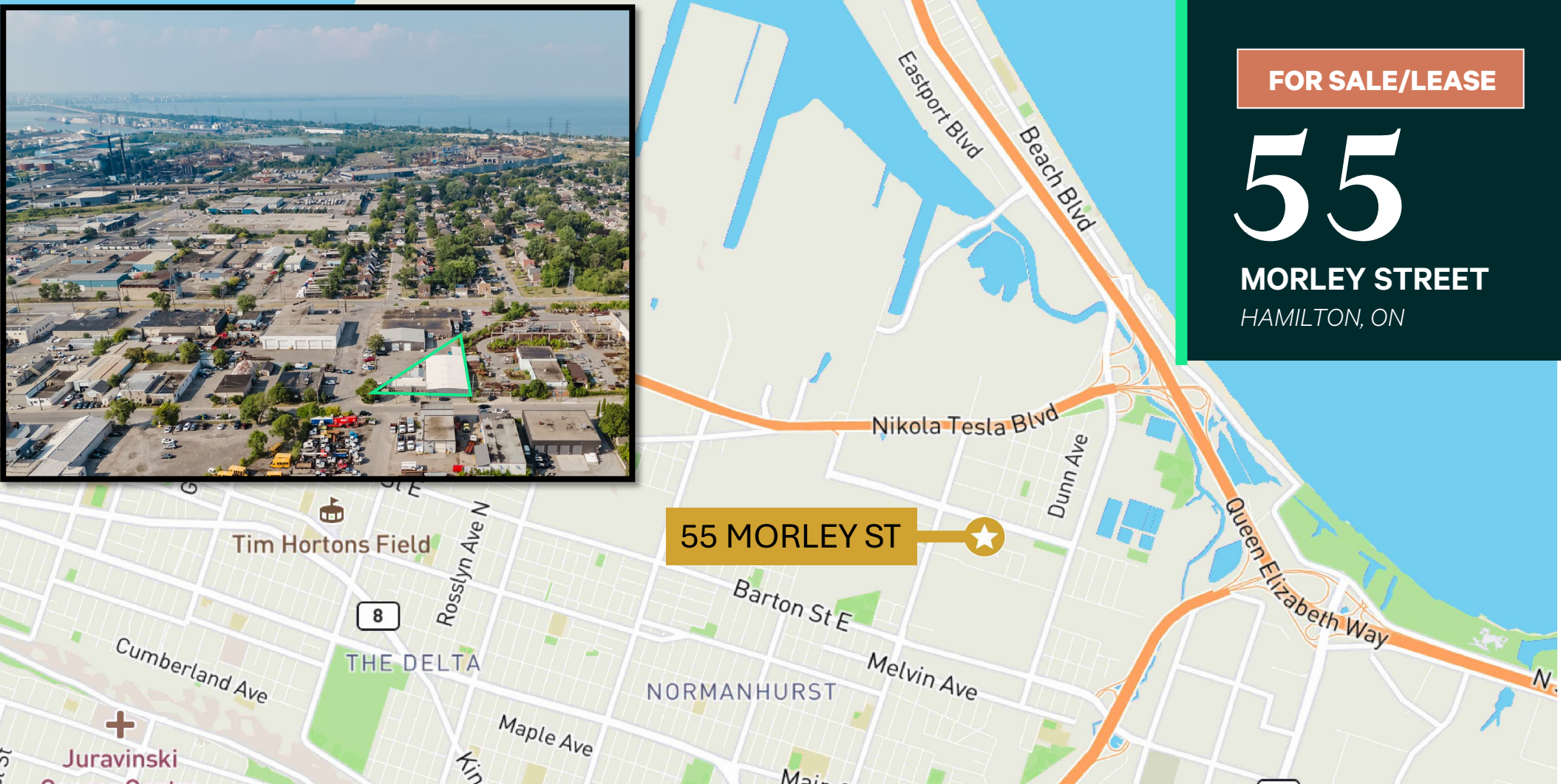
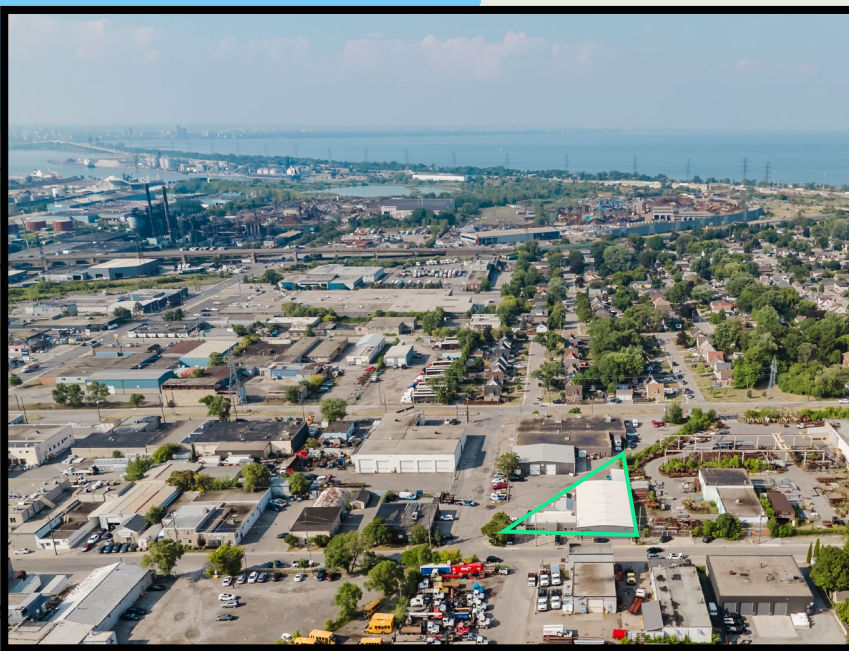

For More Information Contact Us:

CBRE

Industrial

JONATHAN LEARY*

Executive Vice President

905 315 3695

Jonathan.Leary@cbre.com

MAX LEWIS

Sales Representative

905 315 3692

Max.Lewis@cbre.com

Capital Markets

JORDAN LUNAN*

Vice President

416 798 6270

Jordan.Lunan@cbre.com

BRETT THORNE

Sales Representative

416 798 6297

Brett.Thorne@cbre.com

CBRE Limited, Real Estate Brokerage | 1235 North Service Road West, Suite 101 | Oakville, ON | L6M 2W2

This disclaimer shall apply to CBRE Limited, Real Estate Brokerage, and to all other divisions of the Corporation; to include all employees and independent contractors ("CBRE"). The information set out herein, including, without limitation, any projections, images, opinions, assumptions and estimates obtained from third parties (the "Information") has not been verified by CBRE, and CBRE does not represent, warrant or guarantee the accuracy, correctness and completeness of the Information. CBRE does not accept or assume any responsibility or liability, direct or consequential, for the Information or the recipient's reliance upon the Information. The recipient of the Information should take such steps as the recipient may deem necessary to verify the Information prior to placing any reliance upon the Information. The Information may change and any property described in the Information may be withdrawn from the market at any time without notice or obligation to the recipient from CBRE. CBRE and the CBRE logo are the service marks of CBRE Limited and/or its affiliated or related companies in other countries. All other marks displayed on this document are the property of their respective owners. All Rights Reserved. Mapping Sources: Canadian Mapping Services canadamapping@cbre.com; DMTI Spatial, EnviroNics Analytics, Microsoft Bing, Google Earth