

HORAN

INDUSTRIAL CENTER



±26,847 SF Available for Sublease



**100%
CLIMATE
CONTROLLED**



**HEAVY
POWER**



**SUBLEASE
THROUGH
7/31/2027**

915 Horan Drive // Fenton, MO 63026

Jones Lang LaSalle Americas, Inc., a licensed real estate broker in 48 states



PROPERTY HIGHLIGHTS

BUILDING SIZE: ±51,145 SF

AVAILABLE SF: ±26,847 SF

OFFICE AREA: ±7,258 SF

CLEAR HEIGHT: 17' clear

CLIMATE CONTROL: 100%

FIRE PROTECTION: Wet sprinklered

ELECTRIC SERVICE: Heavy power

WAREHOUSE LIGHTING: T5 fluorescent

LOADING: 6 dock doors

BUILDING TYPE: Masonry, rear-loaded

LOCATION: Immediate access to I-44

SUBLEASE EXPIRATION: July 31, 2027

SUBLEASE RATE: \$7.50/SF, NNN



ACCESS



FLOOR PLAN

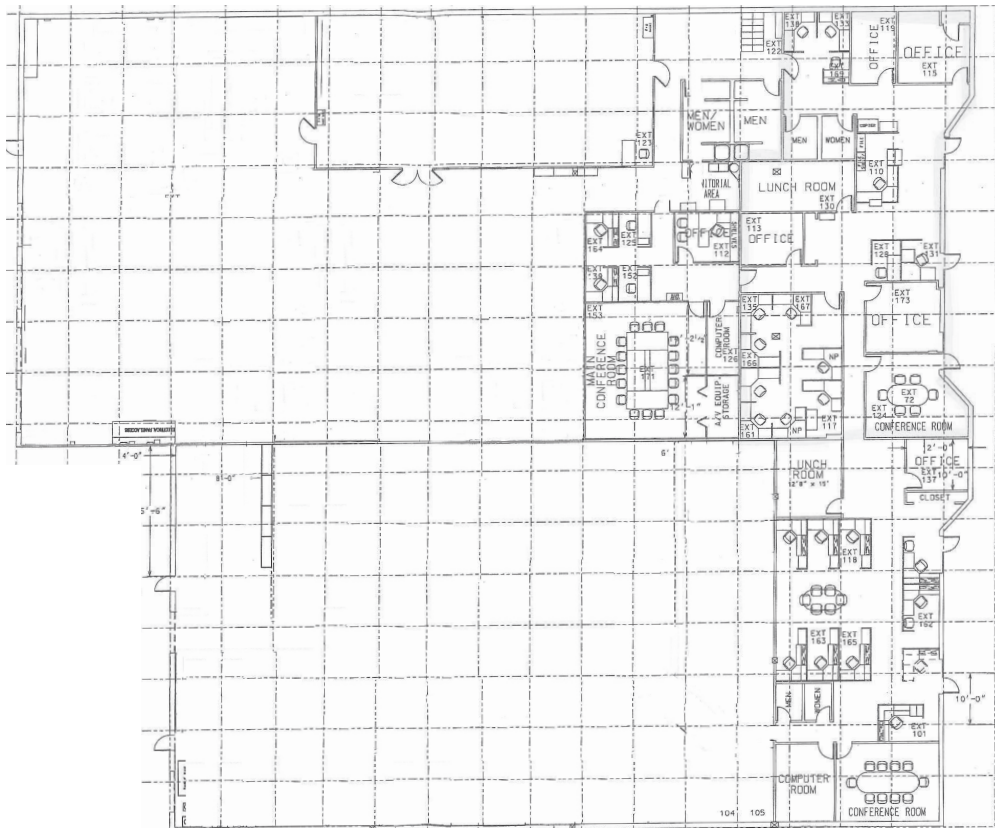

LOCATION

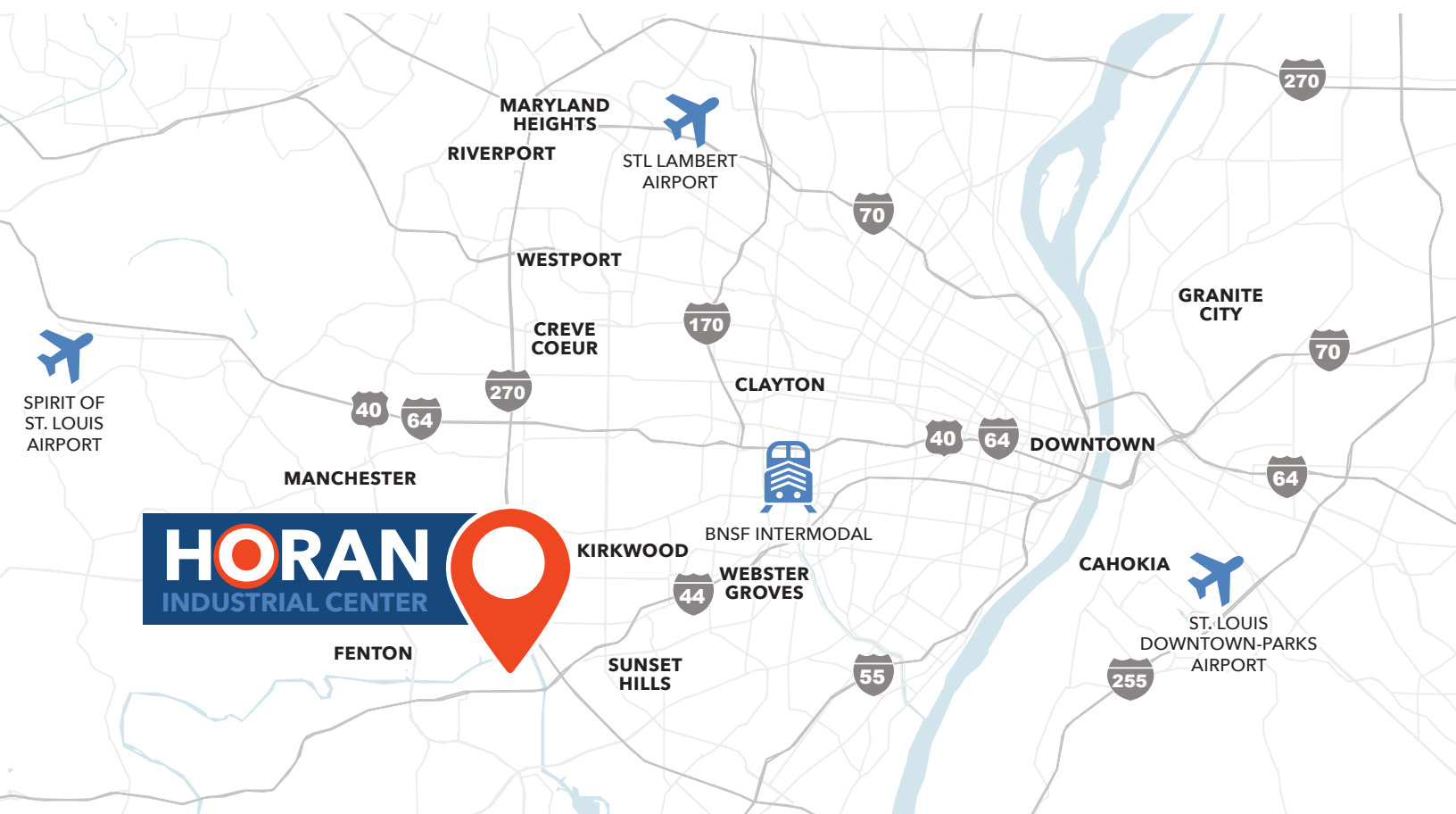

HORAN

INDUSTRIAL CENTER

915 Horan Drive // Fenton, MO 63026

CONTACT

Elise Bozzi

Vice President

+1 314 338 2083

elise.bozzi@jll.com

jll.com/st-louis

+1 314 338 2080

David Branding

Senior Managing Director

+1 314 338 2084

david.branding@jll.com



Jones Lang LaSalle Americas, Inc., a licensed real estate broker in 48 states | **DISCLAIMER** Although information has been obtained from sources deemed reliable, neither Owner nor JLL makes any guarantees, warranties or representations, express or implied, as to the completeness or accuracy as to the information contained herein. Any projections, opinions, assumptions or estimates used are for example only. There may be differences between projected and actual results, and those differences may be material. The Property may be withdrawn without notice. Neither Owner nor JLL accepts any liability for any loss or damage suffered by any party resulting from reliance on this information. If the recipient of this information has signed a confidentiality agreement regarding this matter, this information is subject to the terms of that agreement. ©2025. Jones Lang LaSalle IP, Inc. All rights reserved.