



AVAILABLE FOR GROUND LEASE:  $\pm 0.54$  ACRES

1315-21 NARANCA AVENUE, EL CAJON, CA 92021

TANNER IFRID

Associate | Lic. #02234587

619.871.0633 | [tifrid@voitco.com](mailto:tifrid@voitco.com)

MAX STONE, CCIM

Vice President | Lic. #01921490

619.246.3889 | [mstone@voitco.com](mailto:mstone@voitco.com)

**Voit**

REAL ESTATE SERVICES



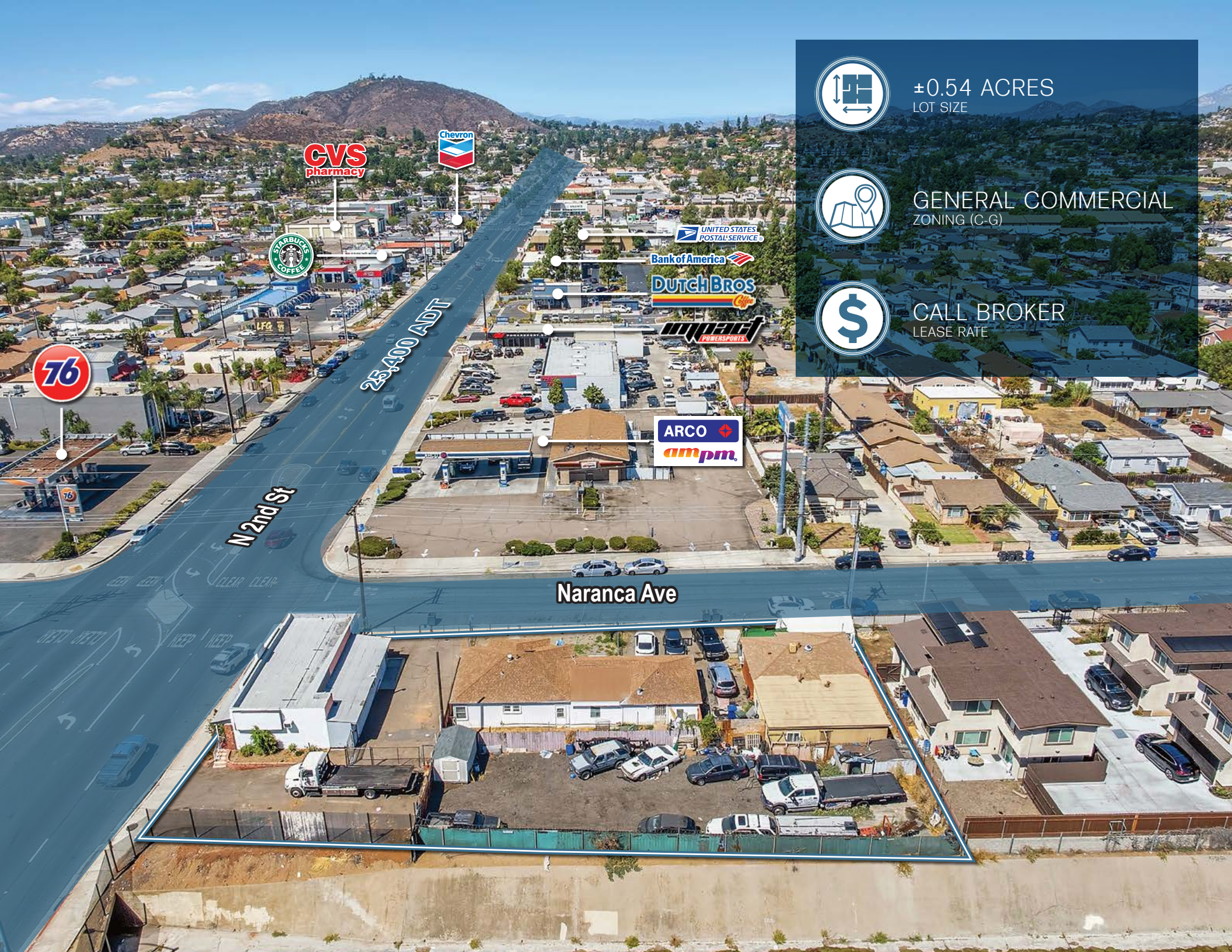

±0.54 ACRES  
LOT SIZE



GENERAL COMMERCIAL  
ZONING (C-G)



CALL BROKER  
LEASE RATE



25,400 ADT

N 2nd St

Naranca Ave







## DEMOGRAPHICS

	1 MILE	3 MILE	5 MILE
2024 Population	33,906	145,567	281,765
2029 Population Projection	33,451	143,779	278,269
2024 Households	11,003	48,355	97,285
2029 Household Projection	10,829	47,663	95,878
Median Home Value	\$508,858	\$633,431	\$687,598
Median Year Built	1973	1974	1975

## TRAFFIC COUNTS

20,691 CPD  
I-8 +  
2nd Street

71,018 CPD  
I-8 +  
East Main Street

38,963 CPD  
2nd Street +  
Madison Ave

26,526 CPD  
2nd Street +  
Marline Avenue

37,415 CPD  
2nd Street +  
Oakdale Avenue

71,018 CPD  
I-8 +  
East Main Street



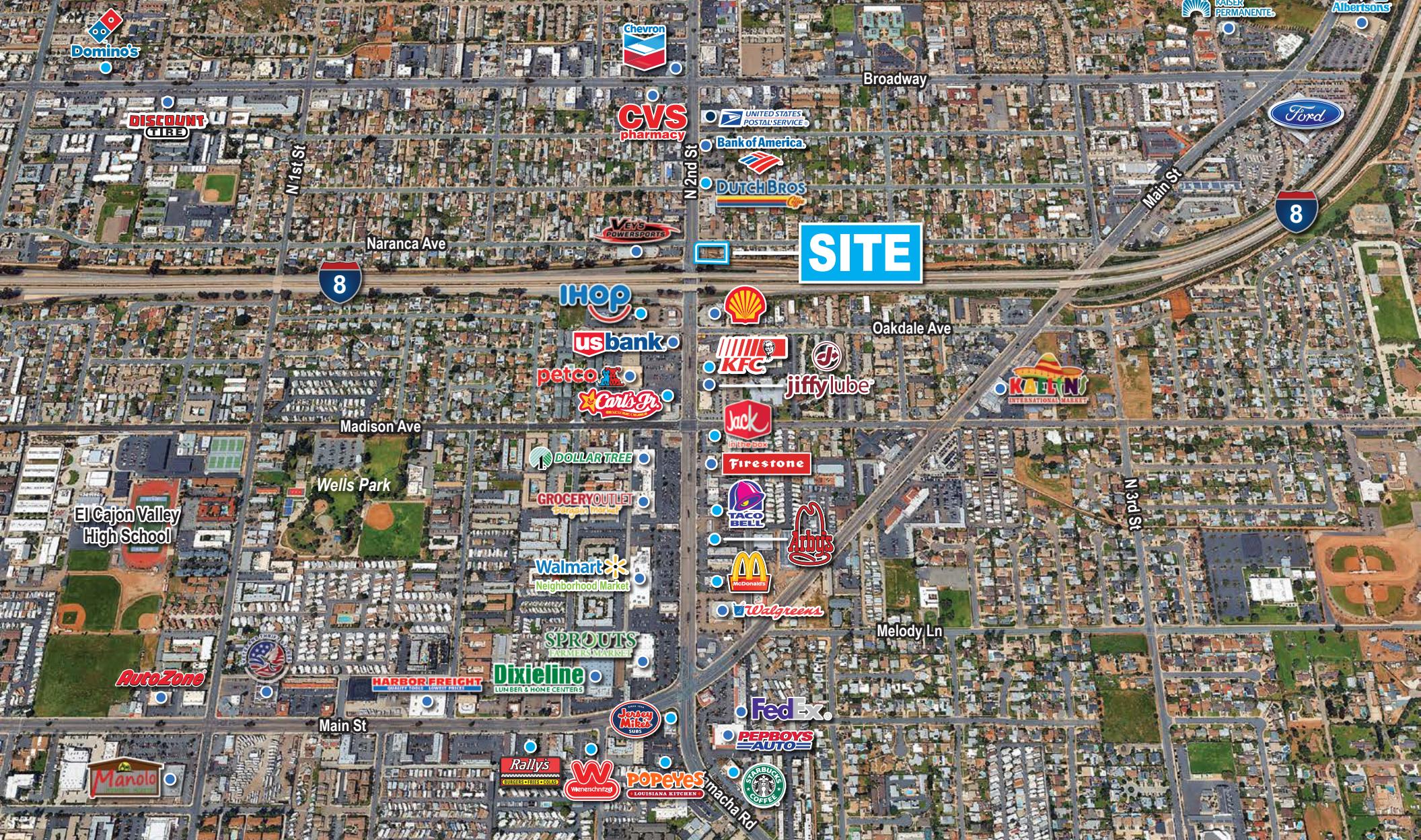

TANNER IFRID

Associate | Lic. #02234587

619.871.0633 | [tifrid@voitco.com](mailto:tifrid@voitco.com)

MAX STONE, CCIM

Vice President | Lic. #01921490

619.246.3889 | [mstone@voitco.com](mailto:mstone@voitco.com)

4180 La Jolla Village Drive, Suite 100, La Jolla, CA 92037 | 858.453.0505 | 858.408.3976 F | Lic #01991785 | [www.voitco.com](http://www.voitco.com)

Licensed as Real Estate Salespersons by the DRE. The information contained herein has been obtained from sources we deem reliable. While we have no reason to doubt its accuracy, we do not guarantee it. ©2024 Voit Real Estate Services, Inc. All Rights Reserved.

**Voit**

REAL ESTATE SERVICES