

# Grow Your Wellness Brand in Southampton, PA

***Join a culture of fitness, wellness, and success!***

Just 20 miles from downtown Philly and conveniently located near major highways and public transportation, Southampton offers easy access to metropolitan conveniences and big city amenities while maintaining its small-town charm. Quickly becoming a hub for fitness, entertainment and wellness, destinations like Altitude Trampoline Park, Mad Golfer Golf Club, Southampton Spa, TNT Amusements, Kidology, and Arena STEM Pennsylvania are making Southampton an increasingly attractive destination to live, visit, and grow a business.

## 1020 Industrial Blvd. Suite 200 Offers:

- 4,549 sf ground floor with Industrial Blvd. frontage
- Two large open-concept rooms with 12 ft ceilings
- Close to 2nd St. Pike / Street Rd / PA Turnpike
- Ample parking to accommodate members & staff
- Zoned LI (Light industrial)
- Term: 5 +years
- Lease rate: \$13,00/st NNN

## Perfect For:

- ✓ Boutique Fitness Studios: Yoga, Pilates, Spin, HIIT
- ✓ Martial Arts, Boxing, or Dance Academies
- ✓ Wellness: Physical Therapy, Nutrition Counseling
- ✓ Golf/Mini-golf, Laser Tag, Rock Climbing, Kids Play
- ✓ Other Recreational, Entertainment or Training Concepts

## Why Southampton?

Southampton is on the rise with ongoing revitalization efforts that are enhancing public spaces, accommodating residential growth, and strengthening the infrastructure. These forward-looking developments, paired with a strong sense of community and strategic location, are creating a vibrant, connected, and business-friendly environment—an excellent place to position your business for long-term success.

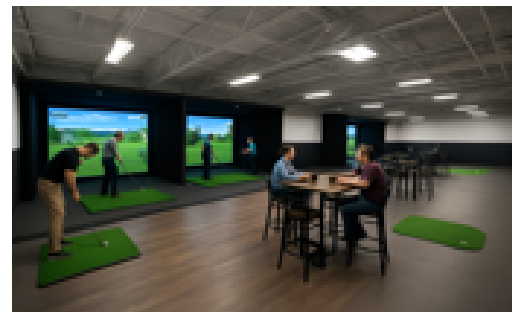

**Interested? Let's Talk.**

**Molly Whitley**

Beamed Properties

834 Pennsylvania Blvd., Suite 101

Feasterville, PA 19053

[mwhitley@beamedproperties.com](mailto:mwhitley@beamedproperties.com)