



# FLEX/WAREHOUSE SPACE

2001-2003 GREENSPRING DRIVE | TIMONIUM, MARYLAND 21093

FOR  
**SALE/  
LEASE**

6,182 SF ± **TOTAL AVAILABLE**



**MACKENZIE**

COMMERCIAL REAL ESTATE SERVICES, LLC



# PROPERTY OVERVIEW

## HIGHLIGHTS:

- 6,182 SF  $\pm$  flex/warehouse space available  
(Can be demised to 2,395 SF  $\pm$  / 3,787 SF  $\pm$ )
- Newly renovated warehouse & showroom (2024)
- Pylon and facade signage available
- Visibility on Greenspring Drive with mix of retail, office, flex and warehouse users
- Partially conditioned warehouse space  
(ability to become fully conditioned)
- Just off of York Road corridor and its many amenities
- Excellent access to I-83, I-695

AVAILABLE:	2,395-6,182 SF $\pm$
LOT SIZE:	1.0 ACRE $\pm$
CLEAR HEIGHT	16' $\pm$ (WAREHOUSE)
LOADING:	2 DOCK DOORS (POTENTIAL TO ADD 1 MORE)
ZONING:	ML 1M (MANUFACTURING, LIGHT) [INDUSTRIAL, MAJOR DISTRICT]
RENTAL RATE:	\$14.35 PSF, NNN
SALE PRICE:	NEGOTIABLE

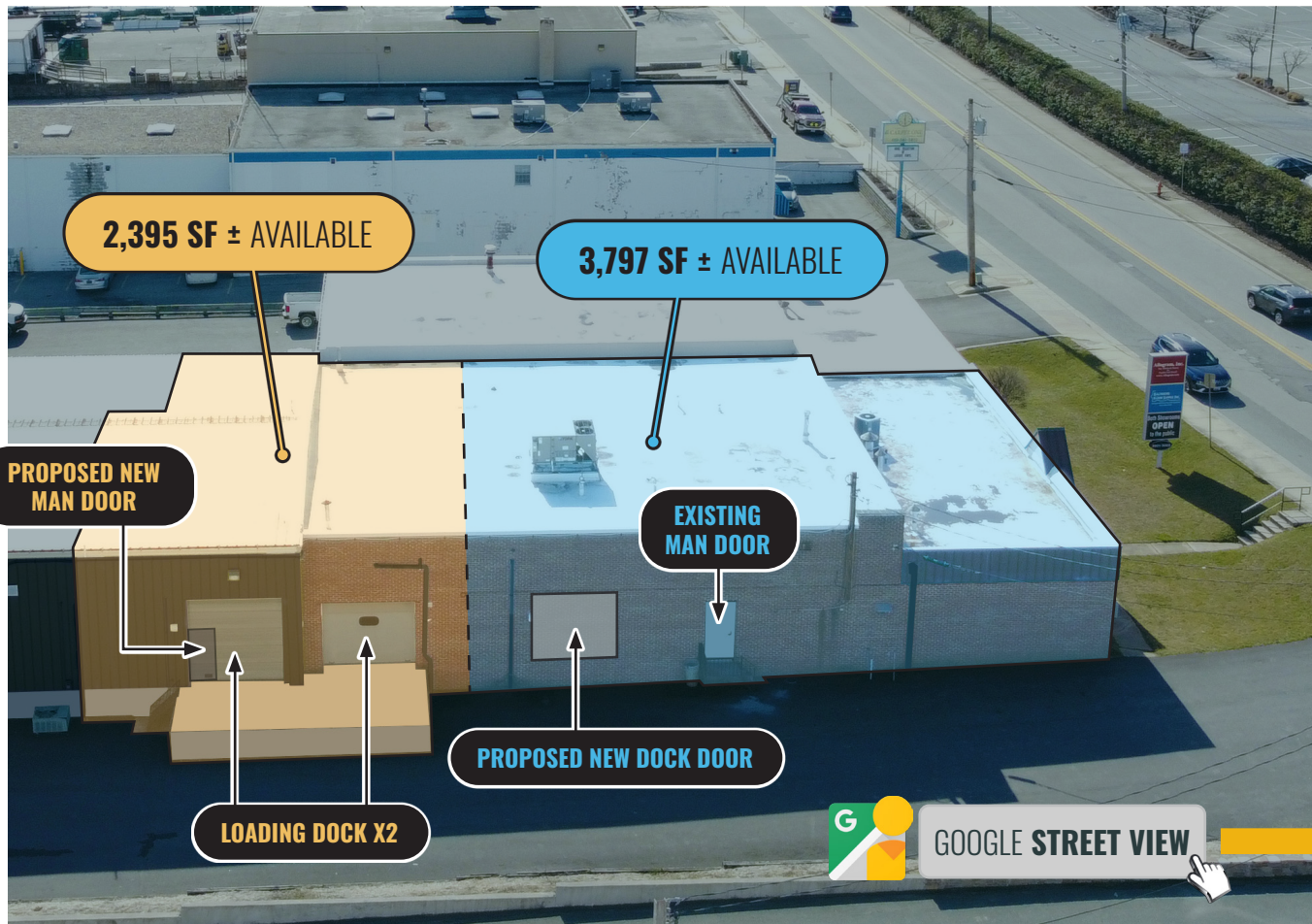



# AERIAL

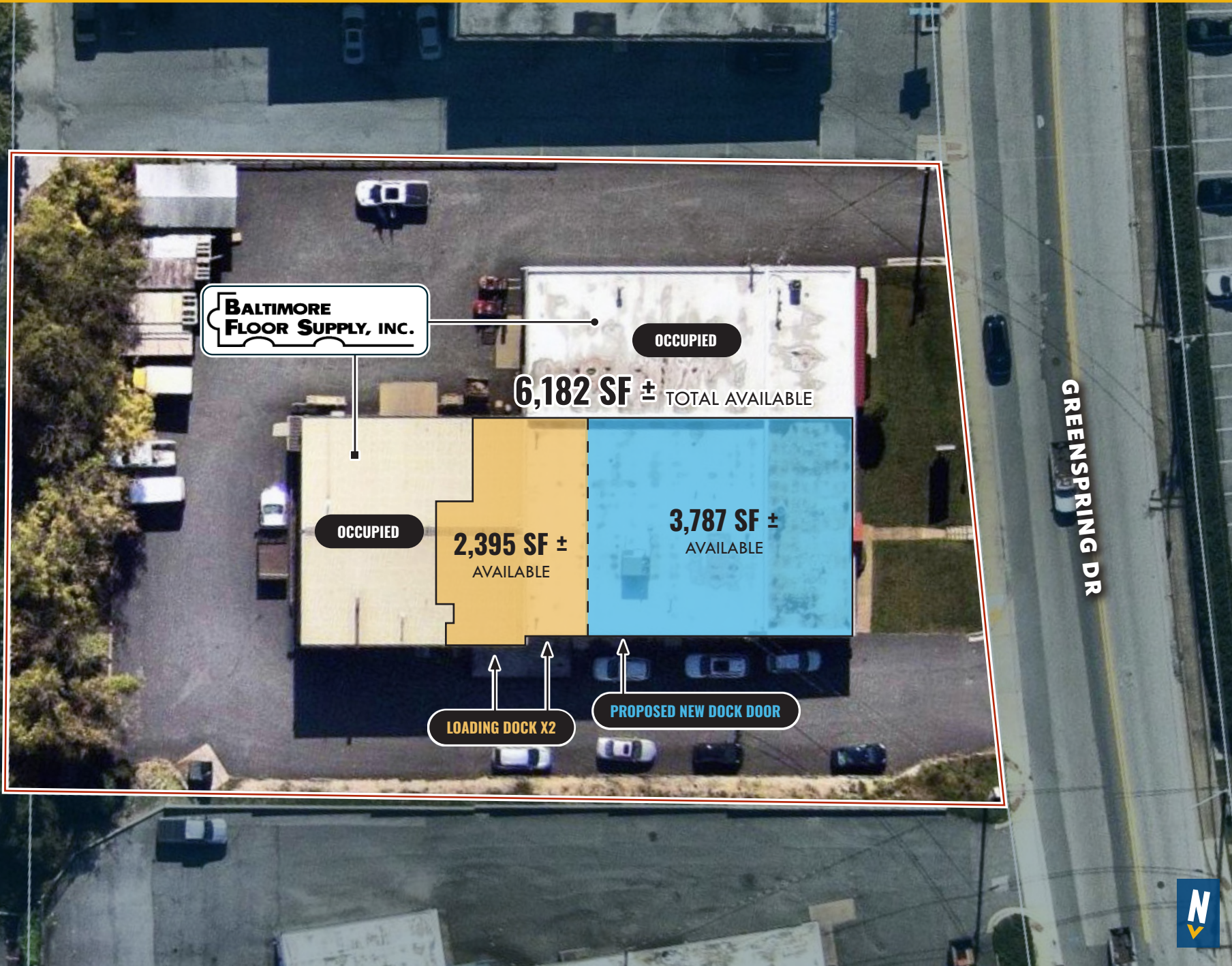



# FLOOR PLAN: **POTENTIAL DEMISING OPTIONS**

**6,182 SF ±**  
TOTAL AVAILABLE

PROPOSED NEW  
DOCK DOOR

— PROPOSED NEW MAN DOOR

**3,787 SF ±**  
AVAILABLE

**2,395 SF ±**  
AVAILABLE

**GREENSPRING DR**

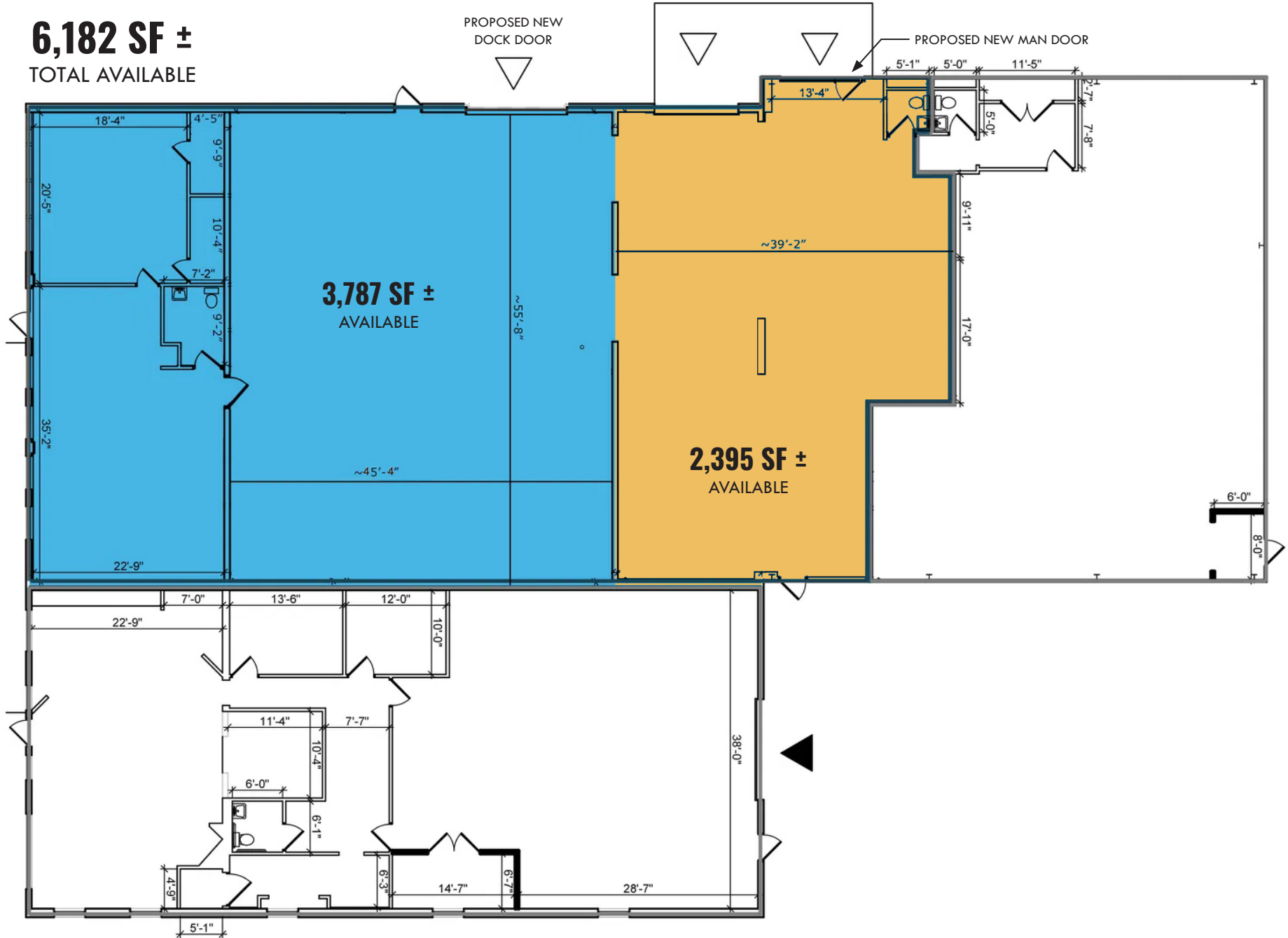



# LOCAL BIRDSEYE



83

Self  
StorageOne  
BALTIMORE  
BALTIMORE

PRO GRASS  
LAWN & ORNAMENTAL CARE

CHASON  
SERVICE ENGINEER

Communications  
Electronic

Tires Auto

NORTHEASTERN  
SUPPLY

PRICELESS  
CARPET ONE FLOOR  
SHORE

SITE

GREENSPRING DR

83

LOYOLA  
UNIVERSITY MARYLAND

McArdle  
& Walsh, Inc.





# TRADE AREA

## DRIVING DISTANCE TO:

**45** 0.5 MILES  
1 MIN. DRIVE

**83** 0.6 MILES  
2 MIN. DRIVE

**695** 1.9 MILES  
3 MIN. DRIVE

**PORT OF BALTIMORE**  
1706  
Helen Delich Bentley  
20.5 MILES  
23 MIN. DRIVE  
(SEAGIRT MARINE TERMINAL)

**BWI**  
BALTIMORE/WASHINGTON  
INTERNATIONAL  
THURGOOD MARSHALL AIRPORT  
24.7 MILES  
25 MIN. DRIVE

**BALTIMORE, MD** 13.4 MILES  
15 MIN.

**WASHINGTON, DC** 53.6 MILES  
1 HR. 7 MIN.

**PHILADELPHIA, PA** 104.0 MILES  
1 HR. 40 MIN.

**RICHMOND, VA** 171.0 MILES  
2 HRS. 40 MIN.





# FOR MORE INFO **CONTACT:**



## **NICK MAGGIO**

REAL ESTATE ADVISOR

**410.494.4880**

**NMAGGIO@mackenziecommercial.com**



## **PATRICK J. SMITH**

REAL ESTATE ADVISOR

**847.346.2701**

**PJSMITH@mackenziecommercial.com**



## **MIKE RUOCCO**

SENIOR VICE PRESIDENT & PRINCIPAL

**410.494.4868**

**MRUOCCO@mackenziecommercial.com**



VISIT **PROPERTY PAGE** FOR MORE INFORMATION.

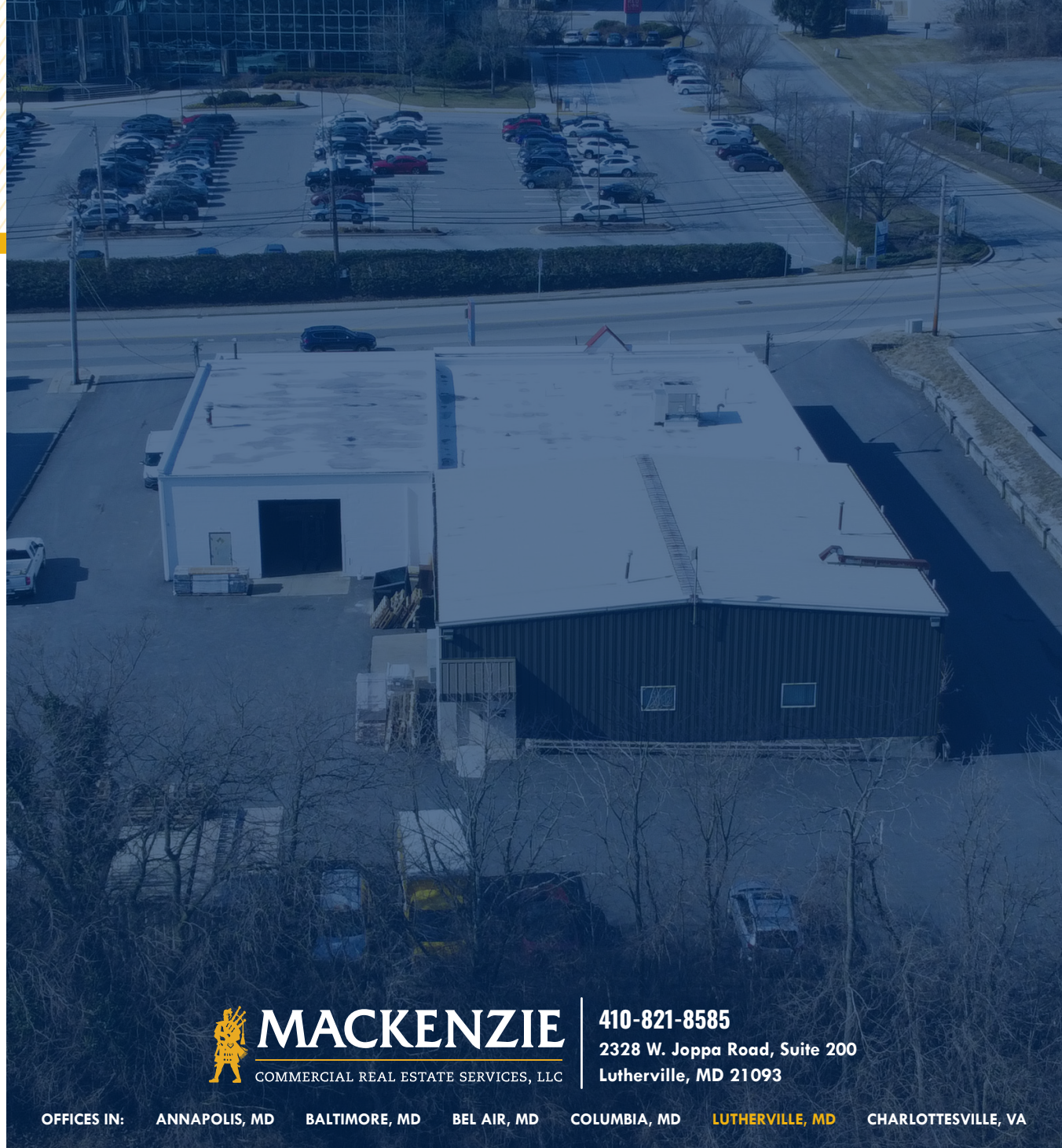

# **MACKENZIE**

COMMERCIAL REAL ESTATE SERVICES, LLC

**410-821-8585**

**2328 W. Joppa Road, Suite 200  
Lutherville, MD 21093**

OFFICES IN: ANNAPOLIS, MD BALTIMORE, MD BEL AIR, MD COLUMBIA, MD **LUTHERVILLE, MD** CHARLOTTESVILLE, VA

**[www.MACKENZIECOMMERCIAL.com](http://www.MACKENZIECOMMERCIAL.com)**

No warranty or representation, expressed or implied, is made as to the accuracy of the information contained herein, and same is submitted subject to errors, omissions, change of price, rental or other conditions, withdrawal without notice, and to any specific listing conditions imposed by our principals.