

Land For Sale

# Canyon Court Commercial

HWY 147 Spanish Fork Parkway  
Spanish Fork, UT

## Property Information

- Close proximity to Maple Mountain High School (1/3 of a mile)
- High growth area
- Grocery store parcel (Lot 6) under contract
- 5 Drive thru lots available (pads 1 - 5)
- 6 Available For Sale
  - Pad 1: 0.74 Acres - \$35/SF
  - Pad 2: 0.78 Acres - \$35/SF
  - Pad 3: 1.23 Acres - \$40/SF
  - Pad 4: 1.07 Acres - \$35/SF
  - Pad 5: 1.54 Acres - \$35/SF
  - Pad 7: 1.74 Acres - \$22/SF

**Contact:**

**James Yeates**  
Vice President  
+1 801 995 0049  
james.yeates@colliers.com

**Justin Irvine**  
Vice President  
+1 801 400 4260  
justin.irvine@colliers.com

**Colliers**  
2100 Pleasant Grove Blvd., Suite 200  
Pleasant Grove, UT 84062  
Main: +1 801 947 8300  
colliers.com

# Conceptual Site Plan & Renderings

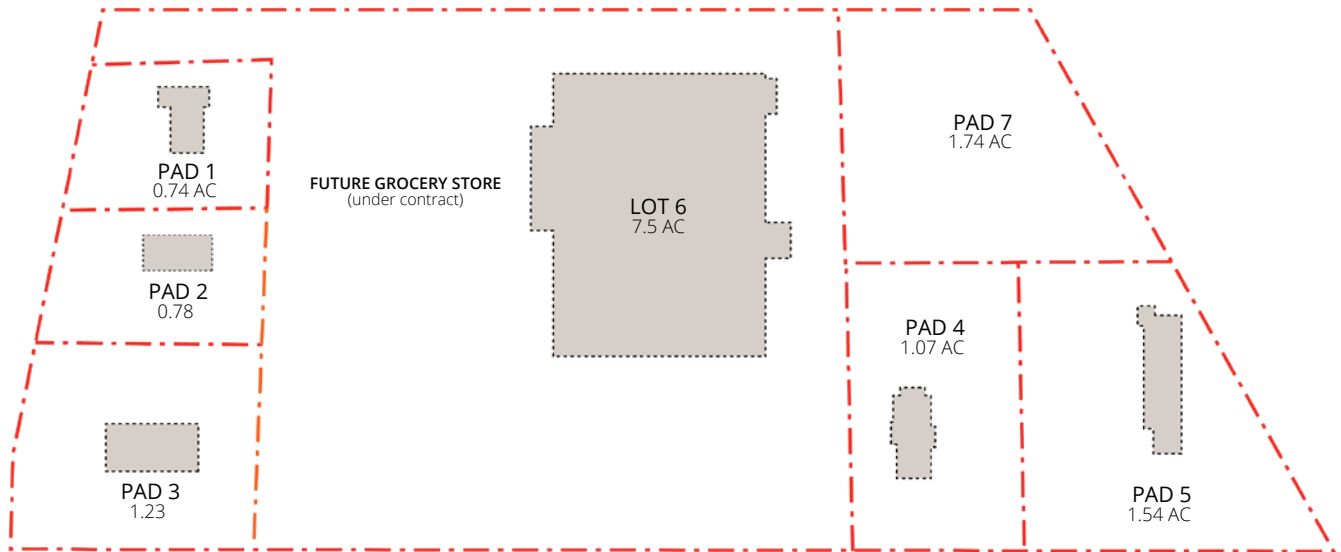





**Colliers**  
 2100 Pleasant Grove Blvd., Suite 200  
 Pleasant Grove, UT 84062  
 Main: +1 801 947 8300  
 colliers.com

**James Yeates**  
 Vice President  
 +1 801 995 0049  
 james.yeates@colliers.com

**Justin Irvine**  
 Vice President  
 +1 801 400 4260  
 justin.irvine@colliers.com

This document has been prepared by Colliers International for advertising and general information only. Colliers International makes no guarantees, representations or warranties of any kind, expressed or implied, regarding the information including, but not limited to, warranties of content, accuracy and reliability. Any interested party should undertake their own inquiries as to the accuracy of the information. Colliers International excludes unequivocally all inferred or implied terms, conditions and warranties arising out of this document and excludes all liability for loss and damages arising there from. This publication is the copyrighted property of Colliers International and/or its licensor(s). ©2024. All rights reserved.