



FOR LEASE

*±49,000 SF Commercial Building Available
in Yuma, Featuring Avenue B Frontage &
Monument Signage*

3052 S AVENUE B, YUMA, AZ 85364

±27,000 SF
SHOWROOM

±22,000 SF
WAREHOUSE



PROPERTY FEATURES

ADDRESS	3052 S Avenue B, Yuma, AZ 85364
BUILDING SIZE	±49,000 SF
OFFICE	±2,000 SF
SHOWROOM	±27,000 SF
WAREHOUSE	±22,000 SF
POWER	±1,200 Amps 120/208 (to be verified by Tenant)
DOUBLE TRUCK WELL	Yes
LOADING	(5) 20' x 20'
INSULATED	Yes
SPRINKLERS	Yes
HVAC	±50%
ZONED	B-2 (General Commercial)
CLEAR HEIGHT	±24' - 33'
CLEAR SPAN	Yes
PARKING RATIO	±1.65/1,000
APN	694-28-150
ASKING RATE	\$0.75/SF NNN

5/1/2026

DATE AVAILABLE

\$0.75/SF

ASKING RATE (NNN)

FLOOR PLAN

±49,000 SF
BUILDING SIZE

±27,000 SF
SHOWROOM

±22,000 SF
WAREHOUSE

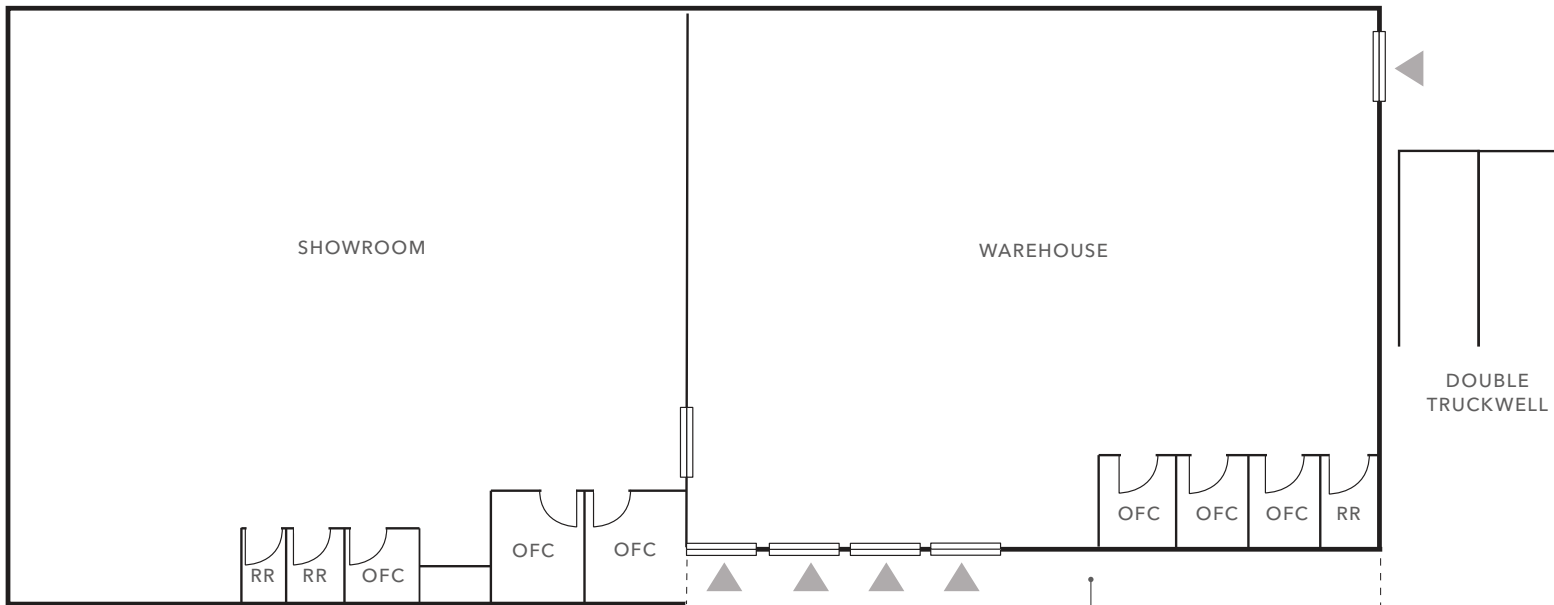

Floor Plan is Not to Scale

▲ Roll Up Door

CANOPY OVERHANG IS ±15'



3052 S AVENUE B

For more information on this property, please contact

KENT HANSON
602.622.8584
kent.hanson@kidder.com

KYLE HANSON
480.262.8985
kyle.hanson@kidder.com

DANA SUMMERS
602.513.5115
dana.summers@kidder.com

KIDDER.COM

This information supplied herein is from sources we deem reliable. It is provided without any representation, warranty, or guarantee, expressed or implied as to its accuracy. Prospective Buyer or Tenant should conduct an independent investigation and verification of all matters deemed to be material, including, but not limited to, statements of income and expenses. Consult your attorney, accountant, or other professional advisor.

