

# 981 Howell Mill *West Midtown*

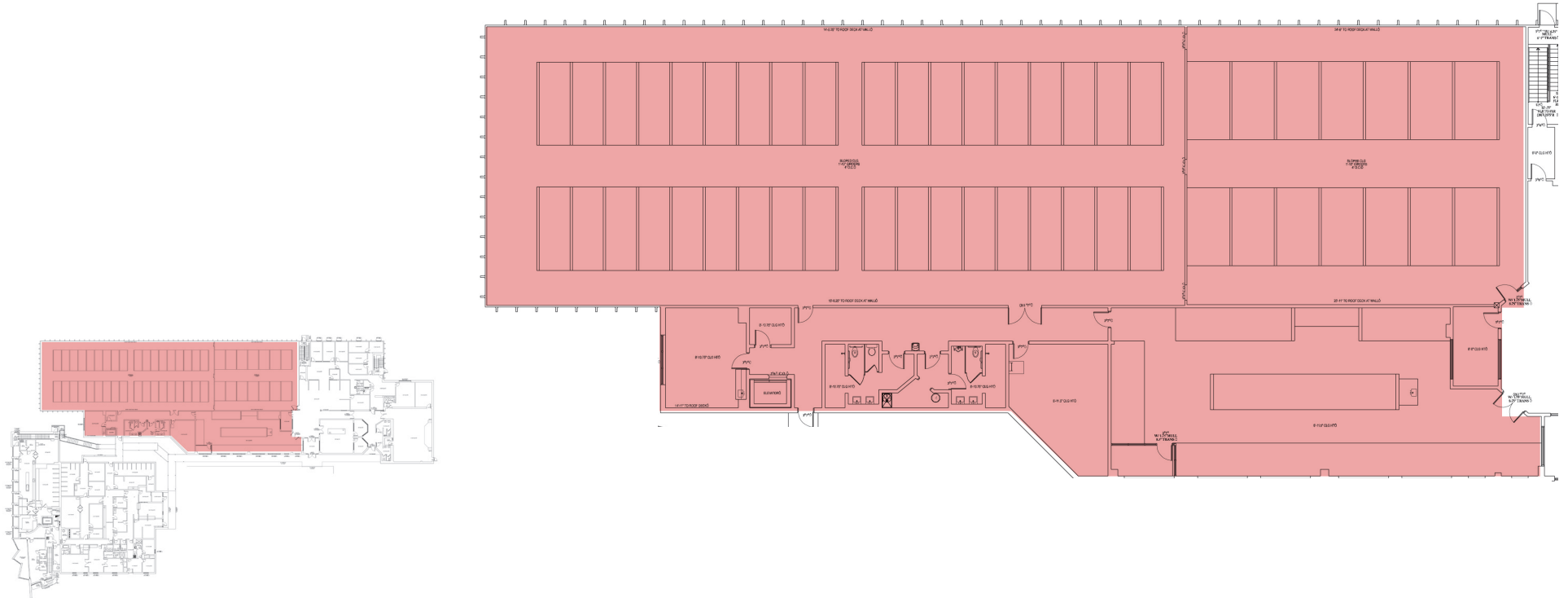

## Ground Floor

STE 200 | 16,745 SF±

**Matthew J. Levin, CCIM**

**SVN | Interstate Brokers**

3300 Holcomb Bridge Road, S-240 | Peachtree Corners, GA 30092

T. 770.209.1700 x1 | M. 678.467.9658 | [levinm@svn.com](mailto:levinm@svn.com) | [www.svn.com](http://www.svn.com)

