

RETAIL SPACE FOR LEASE



Papa Joe's Plaza 6900 N Rochester Rd, Rochester Hills, Michigan

- ***Move-In Ready Suite w/Equipment Included**
 - Suite 6838B: 3,464 SF Available
 - Salon Equipment to Remain
 - \$25.00 PSF + Util
- Ample Parking
- Active & Beautifully Landscaped Plaza
- Strong Demographics

DEMOGRAPHICS	
Category	2 Mile
Population	26,206
Households	11,291
Household Income	\$139,911



HAYMAN COMPANY
Real Estate Investment Services



29100 Northwestern Hwy, Suite 410
Southfield, MI 48034
248.879.7777
www.haymancompany.com

Lawrence Randazzo
248.879.4739
lrando@haymanco.com

SITE PLAN

6900 N Rochester Rd, Rochester Hills, Michigan

FIRST FLOOR

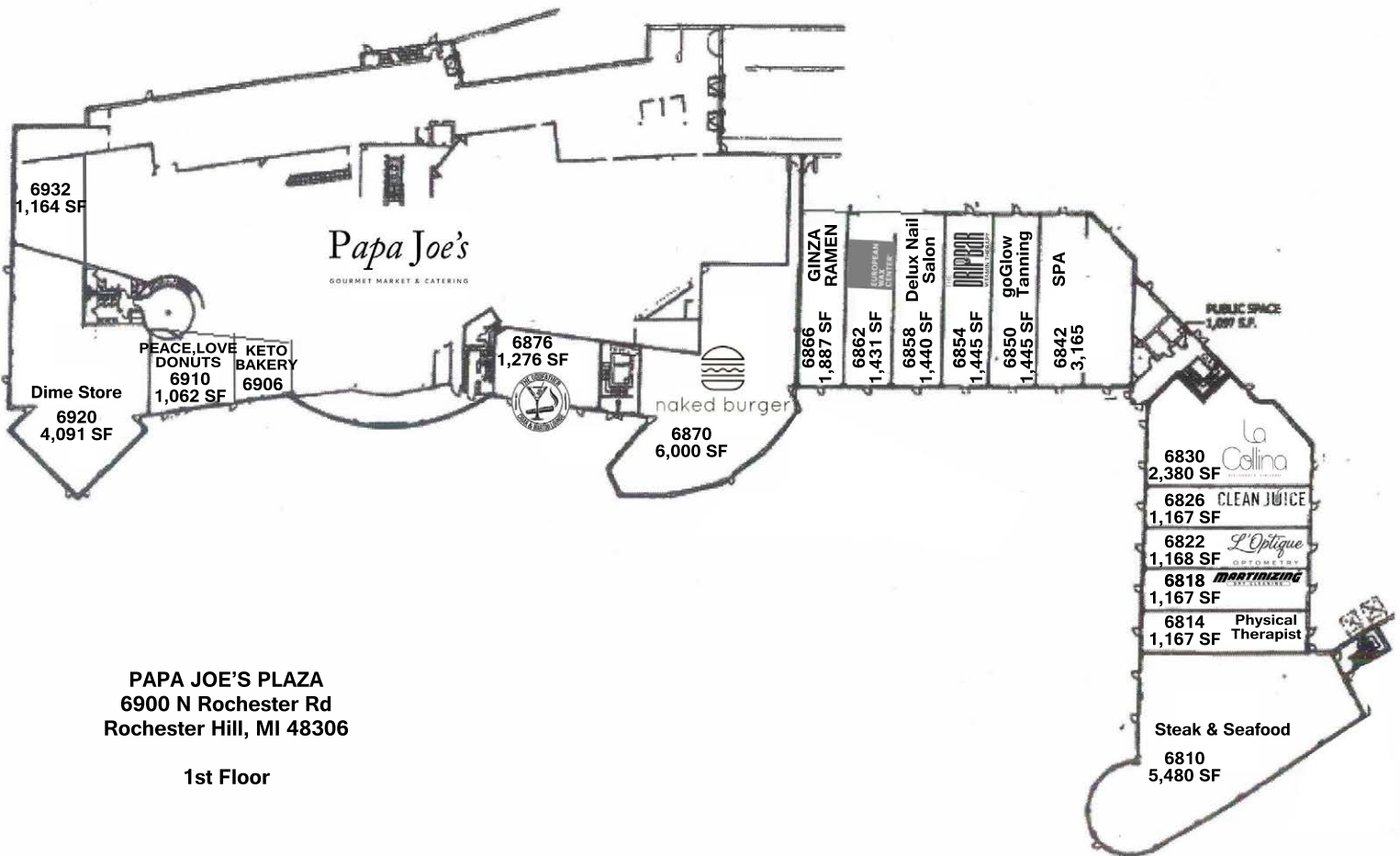

PAPA JOE'S PLAZA
6900 N Rochester Rd
Rochester Hill, MI 48306

1st Floor



SITE PLAN

6900 N Rochester Rd, Rochester Hills, Michigan

SECOND FLOOR

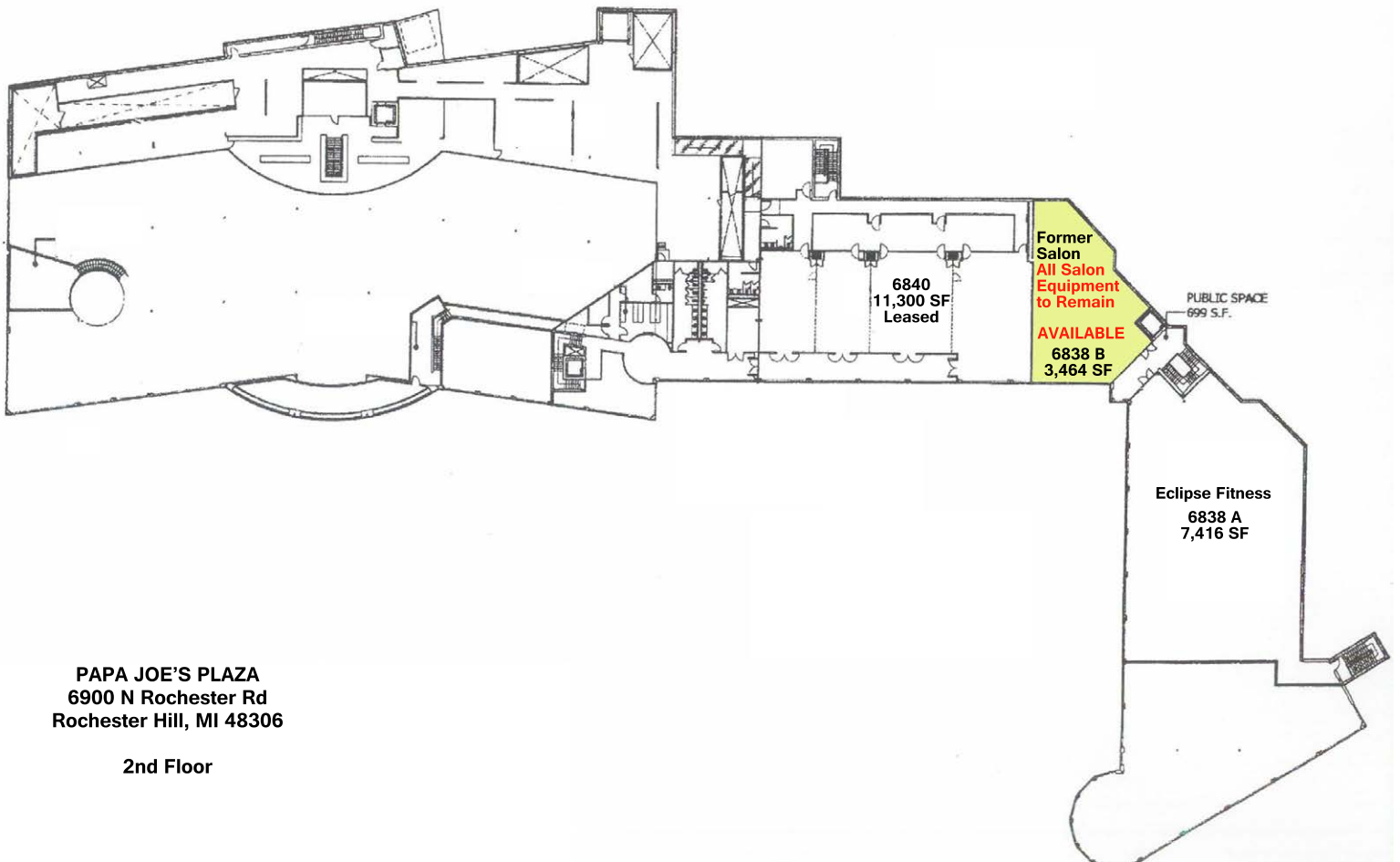

PAPA JOE'S PLAZA
6900 N Rochester Rd
Rochester Hill, MI 48306

2nd Floor

