

RETAIL PROPERTY | FOR LEASE

# LEBANON RETAIL SUITES

11-41 E Ash St, Lebanon, OR 97355



## OFFERING SUMMARY

Lease Rate:	\$1.15-1.25 SF/Mo/MG
Building Size:	6,000 SF
Available SF:	1,040-1,760 SF
Suite 11:	1,760 SF
Suite 21:	1,040 SF
Lot Size:	0.3 Acres
Zoning:	Commercial
Market:	Lebanon

## PROPERTY OVERVIEW

Retail suite available for lease in a well-located multi-tenant retail complex, located on a signalized corner of E Ash Street in Lebanon Oregon. The property offers strong visibility, consistent traffic exposure, and excellent signage opportunities, including prominent building signage on the endcap space and additional exposure via an on-site pylon sign.

Positioned at a signalized intersection, this location provides convenient ingress and egress from multiple directions. Ample onsite parking supports both customer convenience and employee needs. This is a straightforward central Lebanon leasing opportunity with visibility, access, and signage that meaningfully supports business operations.

## PROPERTY HIGHLIGHTS

- 1,040 - 1,760 SF Available
- Endcap and Inline Retail Suites
- Commercial Zoned Property
- Excellent Visibility on a Well Traveled Corridor
- Ample Onsite Private Parking
- Located on a Signaled Intersection



AJ NASH | PARTNER  
MANAGING PRINCIPAL BROKER  
503.559.9279  
AJ@TRADITIONREP.COM

PAULA MOSELEY  
COMMERCIAL BROKER  
503.910.3055  
PAULA@TRADITIONREP.COM

RICH KARLSON | PARTNER  
PRINCIPAL BROKER (OR) | BROKER (WA)  
503.804.4653  
RICH@TRADITIONREP.COM

RETAIL PROPERTY | FOR LEASE

# LEBANON RETAIL SUITES

11-41 E Ash St, Lebanon, OR 97355



## PROPERTY DESCRIPTION

### Two Spaces Available:

**Suite 11:** Endcap Space with 1,760 SF. Formerly occupied by Big Town Hero, this endcap unit offers excellent exposure with corner positioning ready for your design. Ideal for retail or quick-service, fast-casual, or similar food concepts seeking visibility and easy customer access.

**Suite 21:** Inline Retail Space with 1,040 SF. Adjacent to the endcap space, this inline suite is suitable for a variety of retail or service-oriented uses looking to capitalize on central location and established co-tenancy. Spaces may be combined for additional square footage needs.

The property is centrally located within Lebanon and positioned along a signalized intersection, providing strong daily traffic exposure and ease of ingress and egress. On-site parking is plentiful for both customers and employees. This is a solid, straightforward leasing opportunity in a central Lebanon location with visibility that actually matters.

## LOCATION DESCRIPTION

Situated at the intersection of E Ash Street and S Santiam Highway, this location offers strong visibility and consistent traffic exposure in one of Lebanon's well-traveled corridors. The corner setting allows for convenient access from multiple directions, complemented by onsite parking and proximity to surrounding businesses, making it a practical and highly visible location for retail or service users.



AJ NASH | PARTNER  
MANAGING PRINCIPAL BROKER  
503.559.9279  
AJ@TRADITIONREP.COM

PAULA MOSELEY  
COMMERCIAL BROKER  
503.910.3055  
PAULA@TRADITIONREP.COM

RICH KARLSON | PARTNER  
PRINCIPAL BROKER (OR) | BROKER (WA)  
503.804.4653  
RICH@TRADITIONREP.COM



RETAIL PROPERTY | FOR LEASE

# LEBANON RETAIL SUITE #11

11-41 E Ash St, Lebanon, OR 97355



**TRADITION**  
REAL ESTATE PARTNERS

AJ NASH | PARTNER  
MANAGING PRINCIPAL BROKER  
503.559.9279  
AJ@TRADITIONREP.COM

PAULA MOSELEY  
COMMERCIAL BROKER  
503.910.3055  
PAULA@TRADITIONREP.COM

RICH KARLSON | PARTNER  
PRINCIPAL BROKER (OR) | BROKER (WA)  
503.804.4653  
RICH@TRADITIONREP.COM

TRADITIONREP.COM

RETAIL PROPERTY | FOR LEASE

# LEBANON RETAIL SUITE #21

11-41 E Ash St, Lebanon, OR 97355



**TRADITION**  
REAL ESTATE PARTNERS

AJ NASH | PARTNER  
MANAGING PRINCIPAL BROKER  
503.559.9279  
AJ@TRADITIONREP.COM

PAULA MOSELEY  
COMMERCIAL BROKER  
503.910.3055  
PAULA@TRADITIONREP.COM

RICH KARLSON | PARTNER  
PRINCIPAL BROKER (OR) | BROKER (WA)  
503.804.4653  
RICH@TRADITIONREP.COM

TRADITIONREP.COM

RETAIL PROPERTY | FOR LEASE

# FLOOR PLANS

11-41 E Ash St, Lebanon, OR 97355

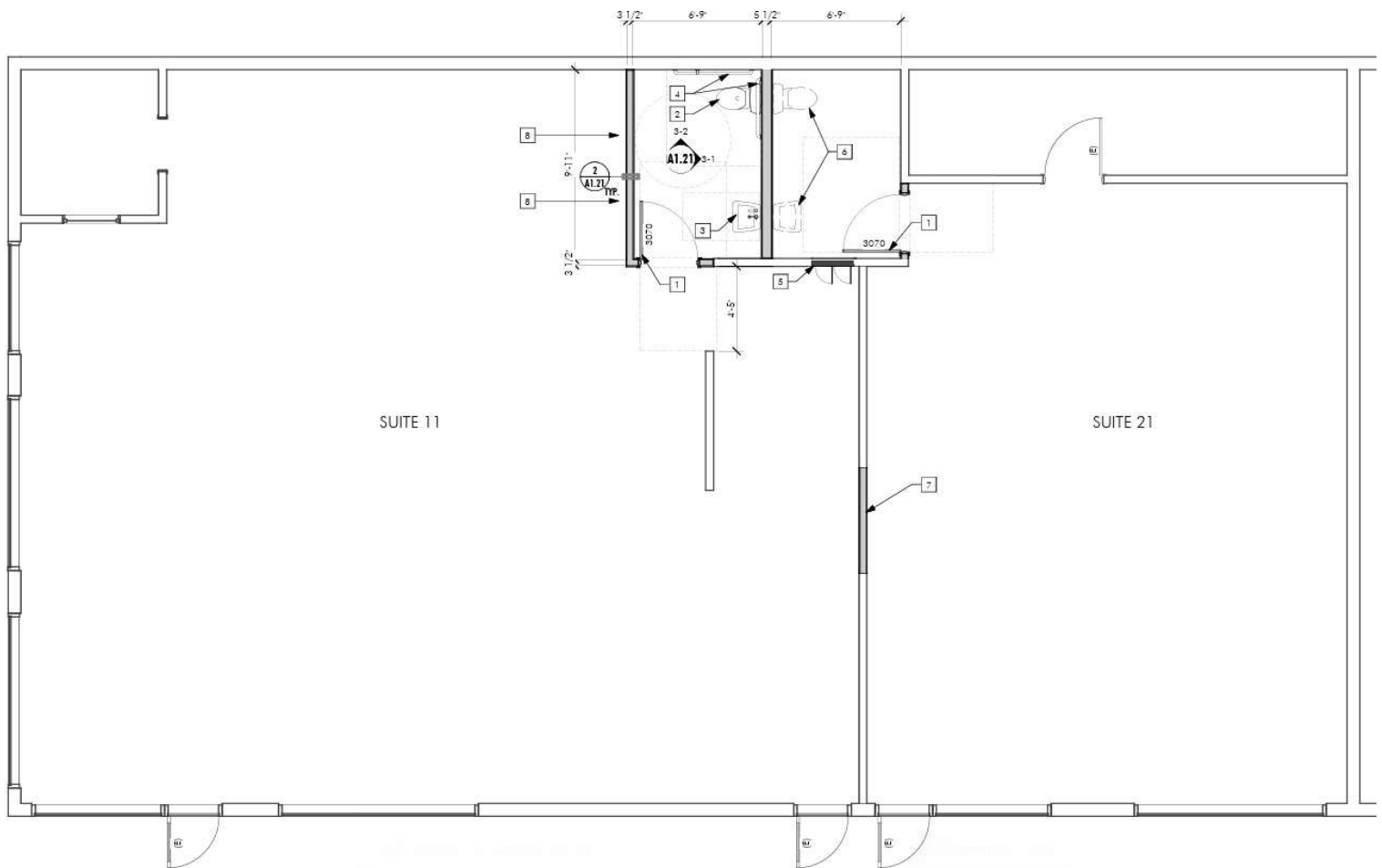

**TRADITION**  
REAL ESTATE PARTNERS

AJ NASH | PARTNER  
MANAGING PRINCIPAL BROKER  
503.559.9279  
AJ@TRADITIONREP.COM

PAULA MOSELEY  
COMMERCIAL BROKER  
503.910.3055  
PAULA@TRADITIONREP.COM

RICH KARLSON | PARTNER  
PRINCIPAL BROKER (OR) | BROKER (WA)  
503.804.4653  
RICH@TRADITIONREP.COM



RETAIL PROPERTY | FOR LEASE

# LOCATION MAP

11-41 E Ash St, Lebanon, OR 97355

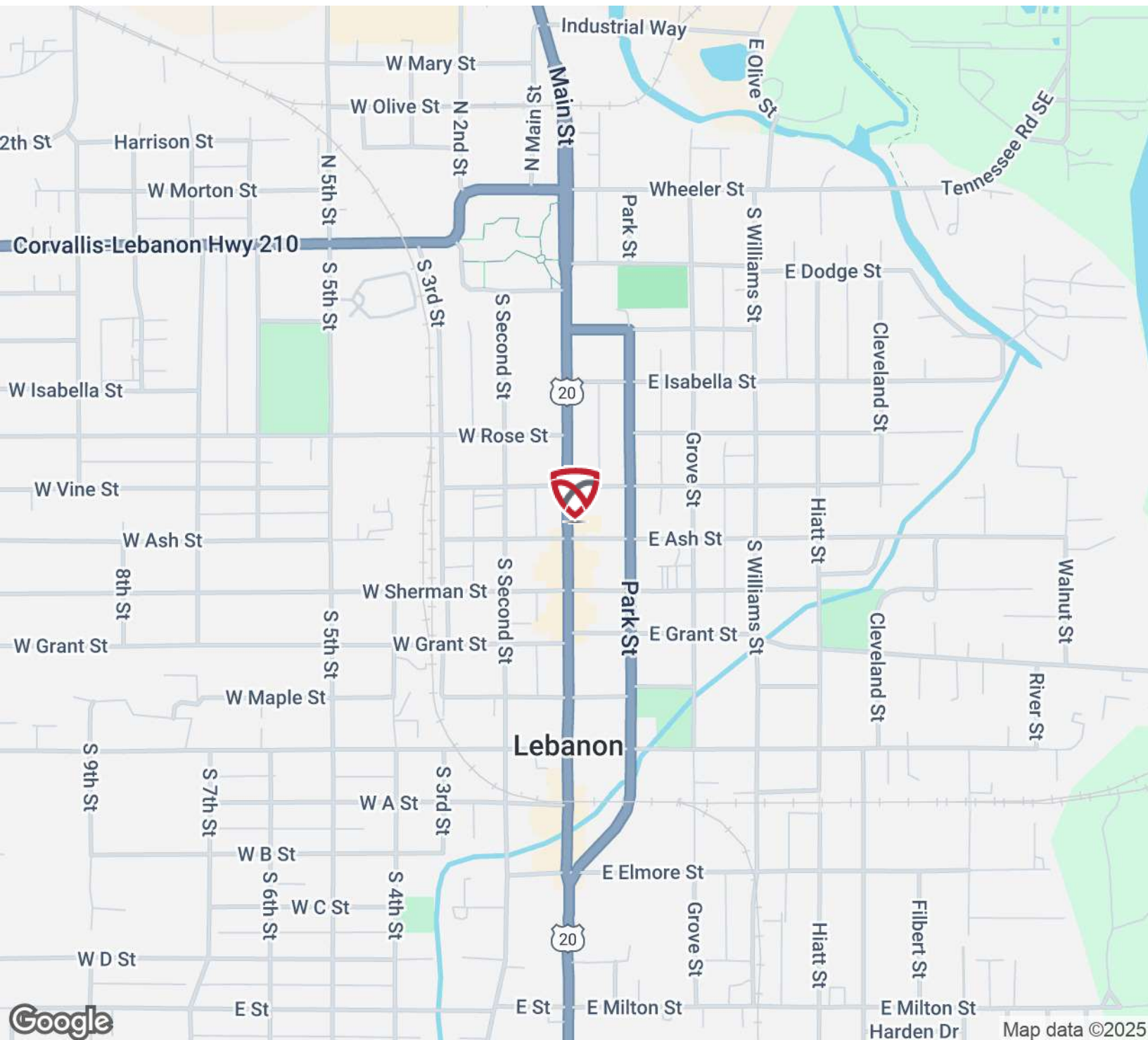

**TRADITION**  
REAL ESTATE PARTNERS

AJ NASH | PARTNER  
MANAGING PRINCIPAL BROKER  
503.559.9279  
AJ@TRADITIONREP.COM

PAULA MOSELEY  
COMMERCIAL BROKER  
503.910.3055  
PAULA@TRADITIONREP.COM

RICH KARLSON | PARTNER  
PRINCIPAL BROKER (OR) | BROKER (WA)  
503.804.4653  
RICH@TRADITIONREP.COM

TRADITIONREP.COM

RETAIL PROPERTY | FOR LEASE

# DEMOGRAPHICS

11-41 E Ash St, Lebanon, OR 97355

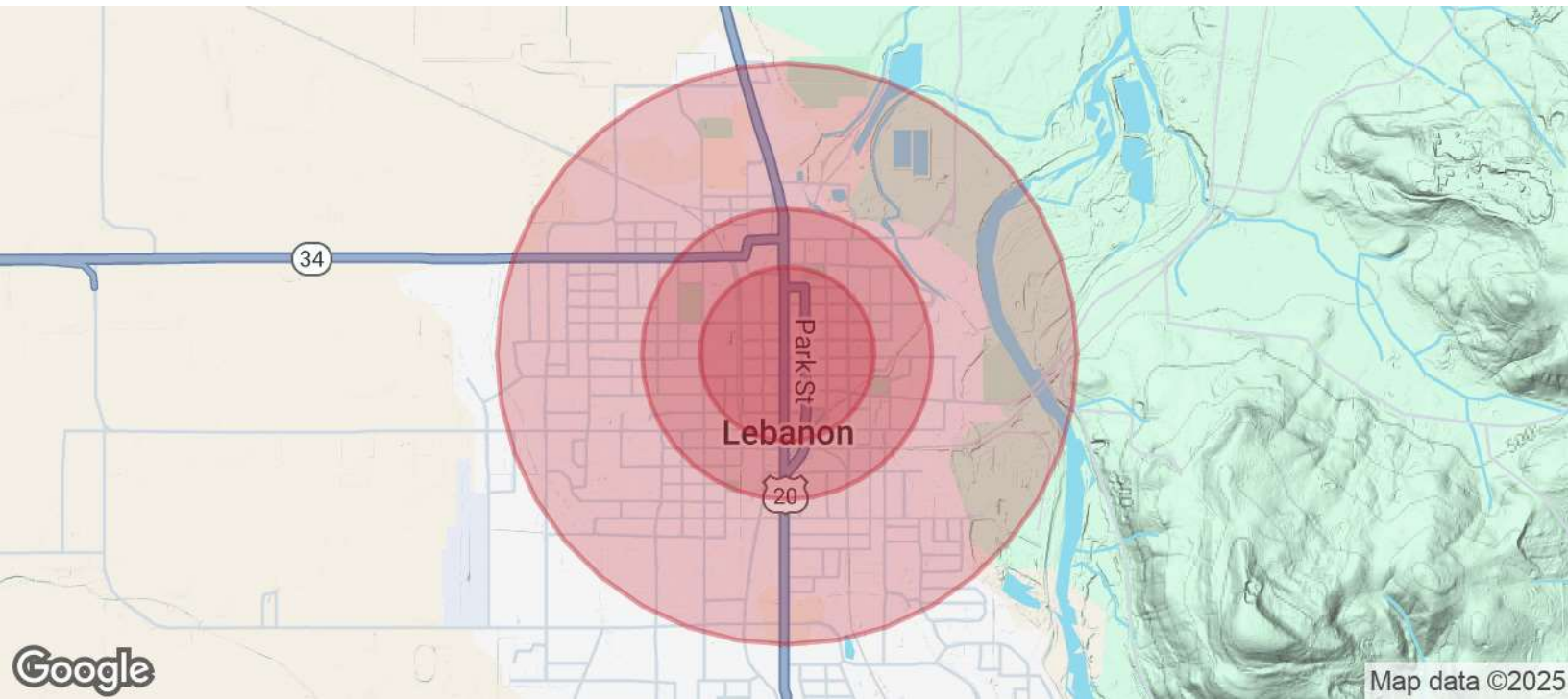

POPULATION	0.3 MILES	0.5 MILES	1 MILE
Total Population	807	3,651	11,239
Average Age	40	40	40
Average Age (Male)	38	39	38
Average Age (Female)	41	41	41

HOUSEHOLDS & INCOME	0.3 MILES	0.5 MILES	1 MILE
Total Households	327	1,455	4,378
# of Persons per HH	2.5	2.5	2.6
Average HH Income	\$66,965	\$69,810	\$73,922
Average House Value	\$362,909	\$372,146	\$343,557

Demographics data derived from AlphaMap



AJ NASH | PARTNER  
MANAGING PRINCIPAL BROKER  
503.559.9279  
AJ@TRADITIONREP.COM

PAULA MOSELEY  
COMMERCIAL BROKER  
503.910.3055  
PAULA@TRADITIONREP.COM

RICH KARLSON | PARTNER  
PRINCIPAL BROKER (OR) | BROKER (WA)  
503.804.4653  
RICH@TRADITIONREP.COM

RETAIL PROPERTY | FOR LEASE

# TRADITION REAL ESTATE PARTNERS

11-41 E Ash St, Lebanon, OR 97355



## AJ NASH

PRINCIPAL BROKER | PARTNER

[AJ@TraditionREP.com](mailto:AJ@TraditionREP.com)

503.559.9279

Managing Broker for the Nash Group with a primary focus on investment real estate and development.



## RICH KARLSON

PRINCIPAL BROKER | PARTNER

[Rich@TraditionREP.com](mailto:Rich@TraditionREP.com)

503.804.4653

Supports all Nash Group activities and Tradition's primary Commercial Broker in the Portland area.



## PAULA MOSELEY

COMMERCIAL BROKER

[Paula@TraditionREP.com](mailto:Paula@TraditionREP.com)

503.910.3055

Supports all Nash Group activities and is the primary Leasing Broker for the team.



## SUNNY TUCKER

CRE TRANSACTION MANAGER

[Sunny@TraditionREP.com](mailto:Sunny@TraditionREP.com)

503.508.9773

Transaction Manager of both lease and sale transactions.



## JANEL RODEN

CHIEF OPERATING OFFICER

[Janel@TraditionREP.com](mailto:Janel@TraditionREP.com)

O: 503.877.4653

Supports as an internal marketing expert and the primary contact for all accounting items.

# OUR COMMERCIAL REAL ESTATE TEAM



**TRADITION**  
REAL ESTATE PARTNERS



**TRADITION**  
REAL ESTATE PARTNERS

AJ NASH | PARTNER  
MANAGING PRINCIPAL BROKER  
503.559.9279  
[AJ@TRADITIONREP.COM](mailto:AJ@TRADITIONREP.COM)

PAULA MOSELEY  
COMMERCIAL BROKER  
503.910.3055  
[PAULA@TRADITIONREP.COM](mailto:PAULA@TRADITIONREP.COM)

RICH KARLSON | PARTNER  
PRINCIPAL BROKER (OR) | BROKER (WA)  
503.804.4653  
[RICH@TRADITIONREP.COM](mailto:RICH@TRADITIONREP.COM)

[TRADITIONREP.COM](http://TRADITIONREP.COM)



# OAR DISCLOSURE

11-41 E Ash St, Lebanon, OR 97355



*This pamphlet describes agency relationships and the duties and responsibilities of real estate licensees in Oregon. This pamphlet is informational only and neither the pamphlet nor its delivery to you may be construed to be evidence of intent to create an agency relationship.*

## Real Estate Agency Relationships

An "agency" relationship is a voluntary legal relationship in which a real estate licensee (the "agent") agrees to act on behalf of a buyer or a seller (the "client") in a real estate transaction.

Oregon law provides for three types of agency relationships between real estate agents and their clients:

**Seller's Agent** - Represents the seller only;

**Buyer's Agent** - Represents the buyer only;

**Disclosed Limited Agent** - Represents both the buyer and seller, or multiple buyers who want to purchase the same property. This can be done only with the written permission of both clients.

*The actual agency relationships between the seller, buyer and their agents in a real estate transaction must be acknowledged at the time an offer to purchase is made. Please read this pamphlet carefully before entering into an agency relationship with a real estate agent.*

## Duties and Responsibilities of an Agent Who Represents Only the Seller or Only the Buyer

Under a written listing agreement to sell property, an agent represents only the seller unless the seller agrees in writing to allow the agent to also represent the buyer. An agent who agrees to represent a buyer acts only as the buyer's agent unless the buyer agrees in writing to allow the agent to also represent the seller. An agent who represents only the seller or only the buyer owes the following affirmative duties to their client, other parties and their agents involved in a real estate transaction:

1. To exercise reasonable care and diligence;
2. To deal honestly and in good faith;
3. To present all written offers, notices and other communications in a timely manner whether or not the seller's property is subject to a contract for sale or the buyer is already a party to a contract to purchase;
4. To disclose material facts known by the agent and not apparent or readily ascertainable to a party;
5. To account in a timely manner for money and property received from or on behalf of the client;
6. To be loyal to their client by not taking action that is adverse or detrimental to the client's interest in a transaction;
7. To disclose in a timely manner to the client any conflict of interest, existing or contemplated;
8. To advise the client to seek expert advice on matters related to the transactions that are beyond the agent's expertise;
9. To maintain confidential information from or about the client except under subpoena or court order, even after termination of the agency relationship; and
10. When representing a seller, to make a continuous, good faith effort to find a buyer for the property, except that a seller's agent is not required to seek additional offers to purchase the property while the property is subject to a contract for sale. When representing a buyer, to make a continuous, good faith effort to find property for the buyer, except that a buyer's agent is not required to seek additional properties for the buyer while the buyer is subject to a contract for purchase or to show properties for which there is no written agreement to pay compensation to the buyer's agent.



**TRADITION**  
REAL ESTATE PARTNERS

AJ NASH | PARTNER  
MANAGING PRINCIPAL BROKER  
503.559.9279  
AJ@TRADITIONREP.COM

PAULA MOSELEY  
COMMERCIAL BROKER  
503.910.3055  
PAULA@TRADITIONREP.COM

RICH KARLSON | PARTNER  
PRINCIPAL BROKER (OR) | BROKER (WA)  
503.804.4653  
RICH@TRADITIONREP.COM

# OAR DISCLOSURE

11-41 E Ash St, Lebanon, OR 97355



None of these affirmative duties of an agent may be waived, except #10, which can only be waived by written agreement between client and agent.

Under Oregon law, a seller's agent may show properties owned by another seller to a prospective buyer and may list competing properties for sale without breaching any affirmative duty to the seller. Similarly, a buyer's agent may show properties in which the buyer is interested to other prospective buyers without breaching any affirmative duty to the buyer.

Unless agreed to in writing, an agent has no duty to investigate matters that are outside the scope of the agent's expertise.

## Duties and Responsibilities of an Agent Who Represents More than One Client in a Transaction

One agent may represent both the seller and the buyer in the same transaction, or multiple buyers who want to purchase the same property only under a written "Disclosed Limited Agency" agreement, signed by the seller, buyer(s) and their agent.

When different agents associated with the same real estate firm establish agency relationships with different parties to the same transaction, only the principal broker (the broker who supervises the other agents) will act as a Disclosed Limited Agent for both the buyer and seller. The other agents continue to represent only the party with whom the agent already has an established agency relationship unless all parties agree otherwise in writing. The supervising principal broker and the agents representing either the seller or the buyer have the following duties to their clients:

1. To disclose a conflict of interest in writing to all parties;
2. To take no action that is adverse or detrimental to either party's interest in the transaction; and
3. To obey the lawful instruction of both parties.

An agent acting under a Disclosed Limited Agency agreement has the same duties to the client as when representing only a seller or only a buyer, except that the agent may not, without written permission, disclose any of the following:

1. That the seller will accept a lower price or less favorable terms than the listing price or terms;
2. That the buyer will pay a greater price or more favorable terms than the offering price or terms; or
3. In transactions involving one-to-four residential units only, information regarding the real property transaction including, but not limited to, price, terms, financial qualifications or motivation to buy or sell.

No matter whom they represent, an agent **must** disclose information the agent knows or should know that failure to disclose would constitute fraudulent misrepresentation. Unless agreed to in writing, an agent acting under a Disclosed Limited Agency agreement has no duty to investigate matters that are outside the scope of the agent's expertise.

***You are encouraged to discuss the above information with the agent delivering this pamphlet to you. If you intend for that agent, or any other Oregon real estate agent, to represent you as a Seller's Agent, Buyer's Agent, or Disclosed Limited Agent, you should have a specific discussion with him/her about the nature and scope of the agency relationship. Whether you are a buyer or seller, you cannot make a licensee your agent without their knowledge and consent, and an agent cannot make you their client without your knowledge and consent.***



**TRADITION**  
REAL ESTATE PARTNERS

AJ NASH | PARTNER  
MANAGING PRINCIPAL BROKER  
503.559.9279  
AJ@TRADITIONREP.COM

PAULA MOSELEY  
COMMERCIAL BROKER  
503.910.3055  
PAULA@TRADITIONREP.COM

RICH KARLSON | PARTNER  
PRINCIPAL BROKER (OR) | BROKER (WA)  
503.804.4653  
RICH@TRADITIONREP.COM