

YOUR LOGO

AVAILABLE

±336,000 SF

RIVER EAST

600 Renaissance Center
Detroit, MI

ROBERT GAGNIUK

Leasing Manager

P 248.848.4093

E robert.gagniuk@freg.com

JORDAN FRIEDMAN

Managing Director

P 248.848.3521

E jordan.friedman@freg.com

JARED FRIEDMAN

Executive Managing Director

P 248.848.3511

E jared.friedman@freg.com

DAVID FRIEDMAN

President & CEO

P 248.848.3500

E david.friedman@freg.com

MEET OUR **TEAM**



ROBERT GAGNIUK

Leasing Manager

P 248.848.4093

E robert.gagniuk@freg.com



JORDAN FRIEDMAN

Managing Director

P 248.848.3521

E jordan.friedman@freg.com



JARED FRIEDMAN

Executive Managing Director

P 248.848.3511

E jared.friedman@freg.com



DAVID FRIEDMAN

President & CEO

P 248.848.3500

E david.friedman@freg.com

ABOUT

600 RIVER EAST

Highlights

- New Ownership and Management of one of Detroit's most iconic office buildings
- Corporate Signage Available at Top of Building, facing Jefferson as well as International Signage Opportunity facing the river/and Windsor, Canada.
- Lobby retail & medical spaces available
- Up to ±336,000 SF Class A Office Building, ±16,000 SF Floorplates, 21 Stories
- Situated on the Detroit Riverwalk in the heart of Detroit CBD
- Incredible 360-degree views of Downtown Detroit and the Detroit River
- On-site garage and surface parking available
- State-of-the-art security with 24-hour guard and badge access to floors

BUILDING INFORMATION

Type: Office | Medical | Retail

Year Built: 1981

Year Renovated: 2005

Stories: 21

SITE INFORMATION

Land Size: 1.25 Acres

Zoning: Planned Dev. District

Parking Spaces: 443

Parking Type: Structure & Surface

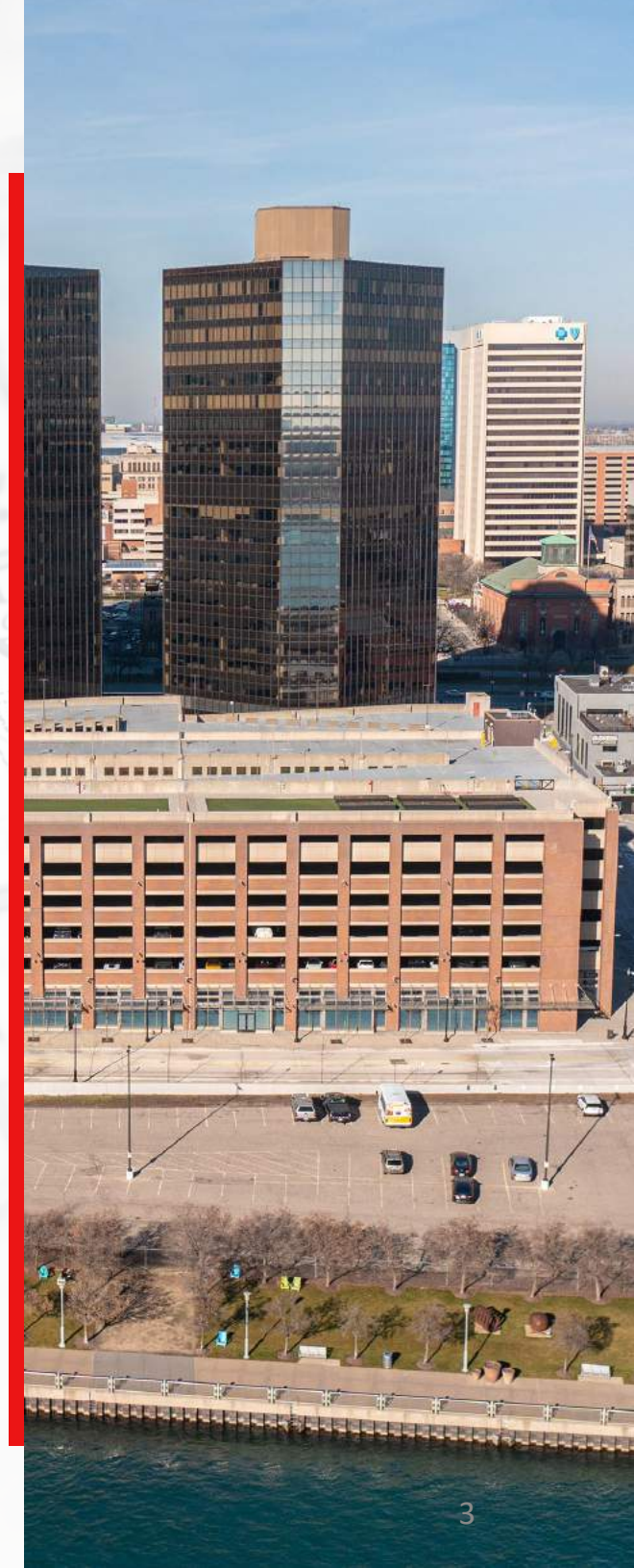

VIRTUAL WALKTHROUGH



See all that 600 River East has to offer in this short informational video.

INCREDIBLE
RIVERFRONT VIEWS



INCREDIBLE **SKYLINE VIEWS**

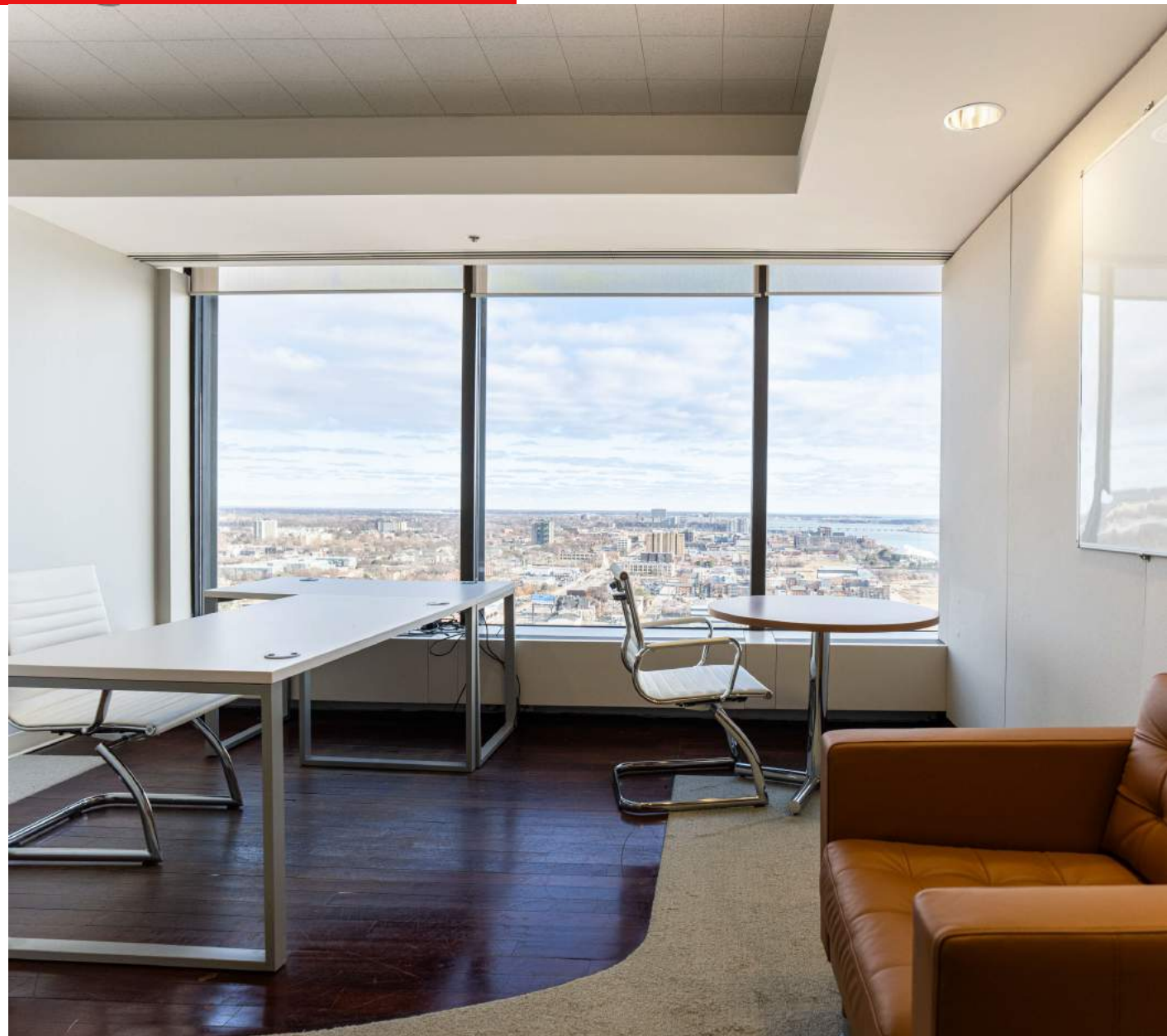

LEASING AVAILABILITY

Main Lobby – 32,484 SF Avail.

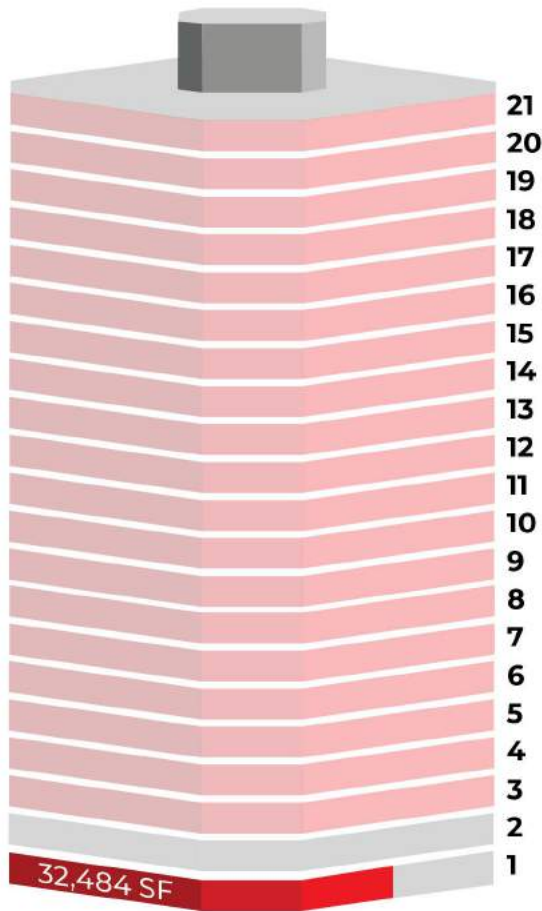

AVAILABLE **OCCUPIED**

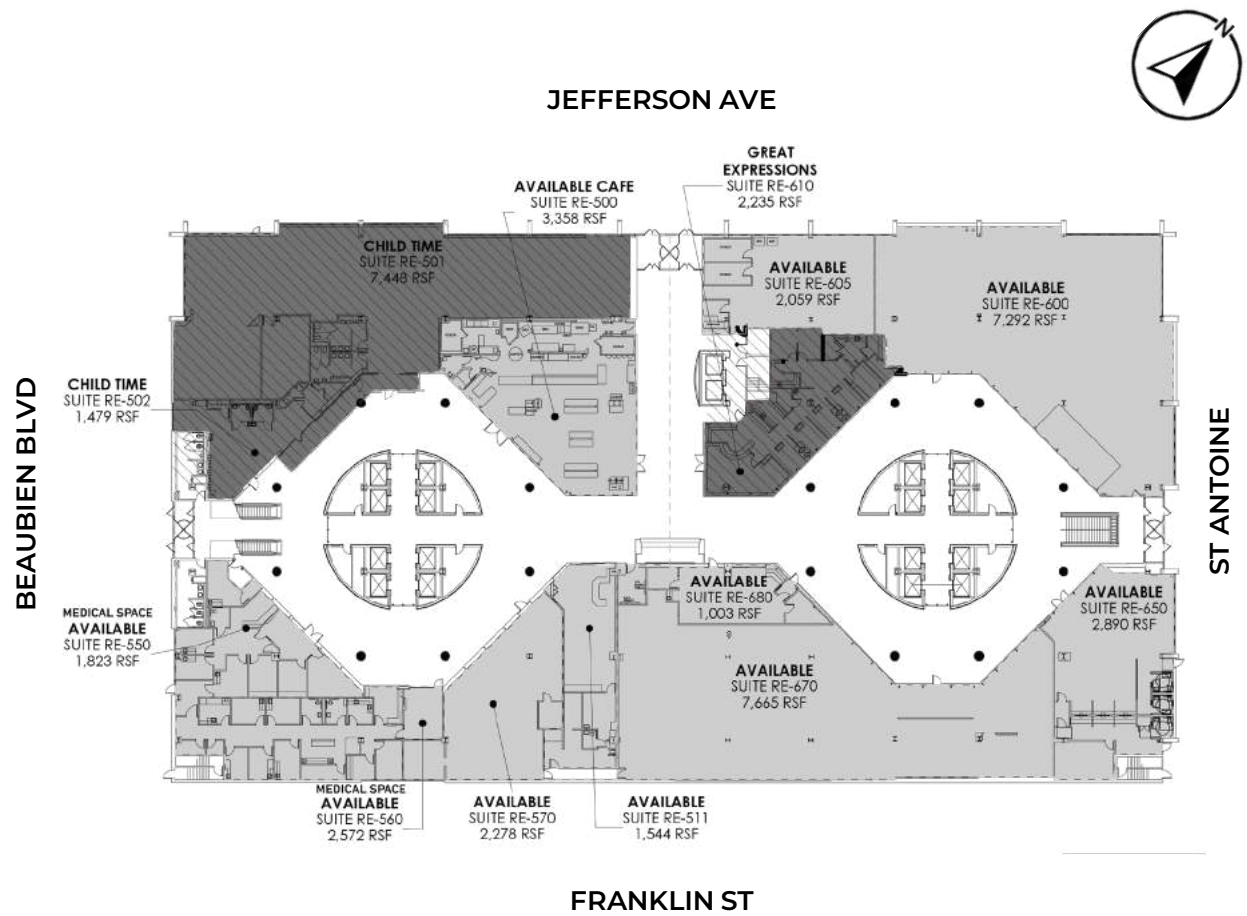

LEASING AVAILABILITY

SUITE 300 – 16,174 SF

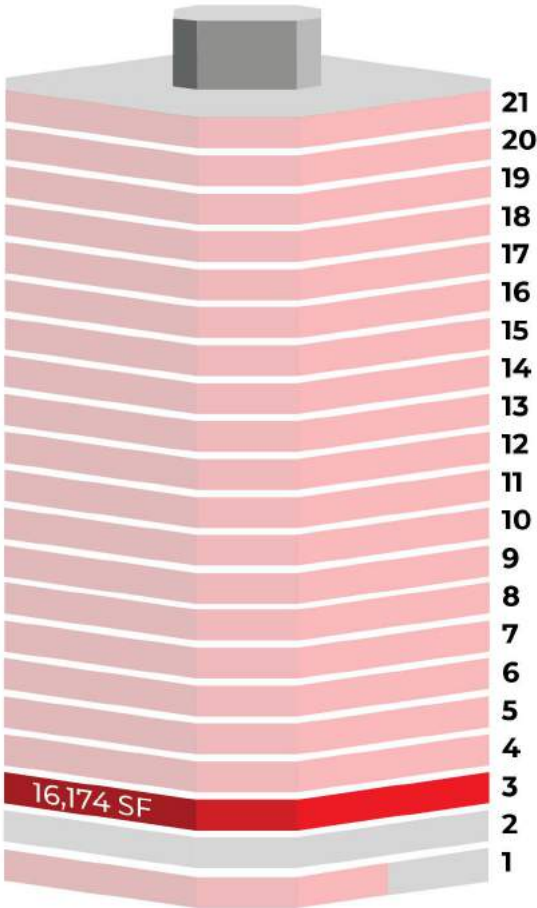

AVAILABLE **OCCUPIED**

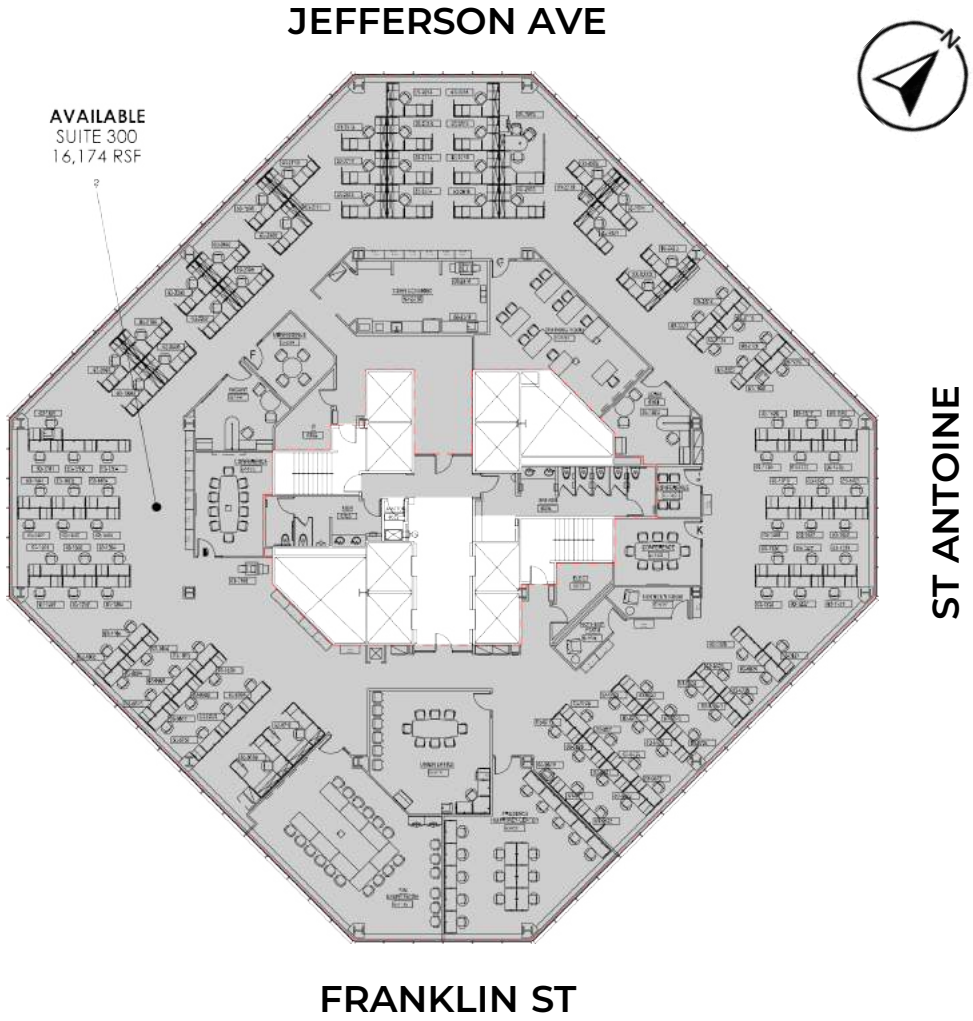

JEFFERSON AVE

ST ANTOINE

FRANKLIN ST

LEASING AVAILABILITY

SUITE 400 – 16,174 SF

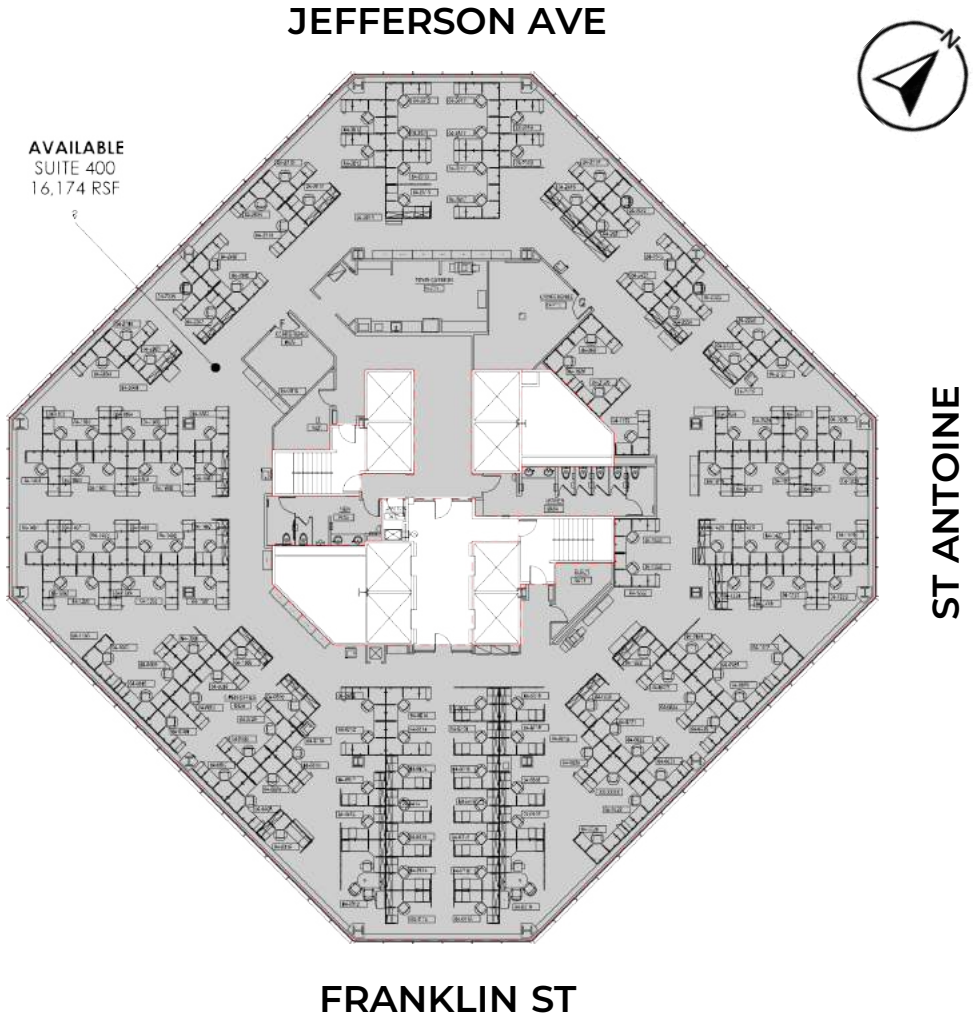
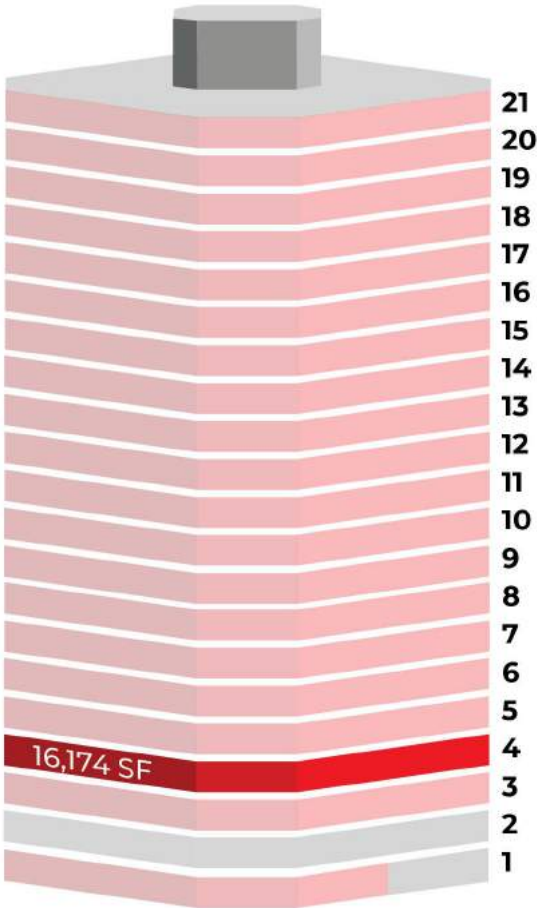

LEASING AVAILABILITY

SUITE 500 – 16,174 SF

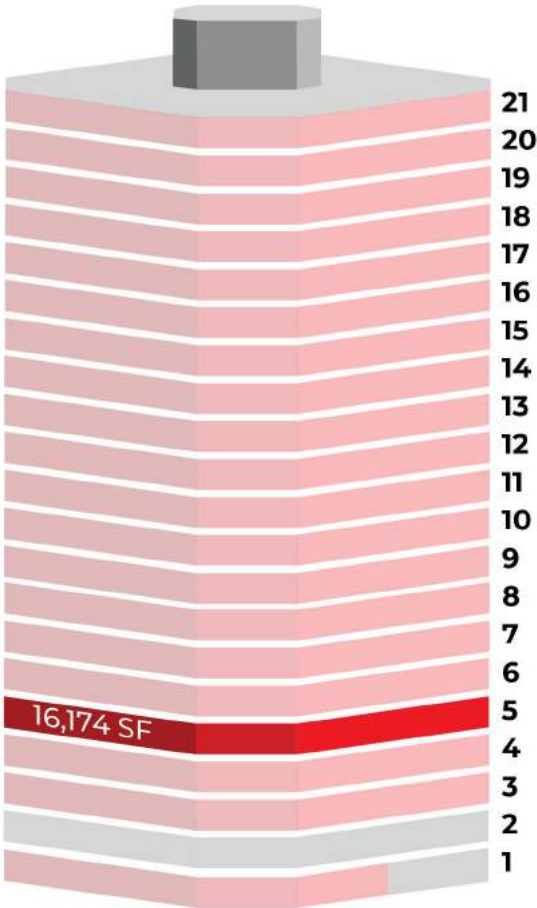

AVAILABLE OCCUPIED

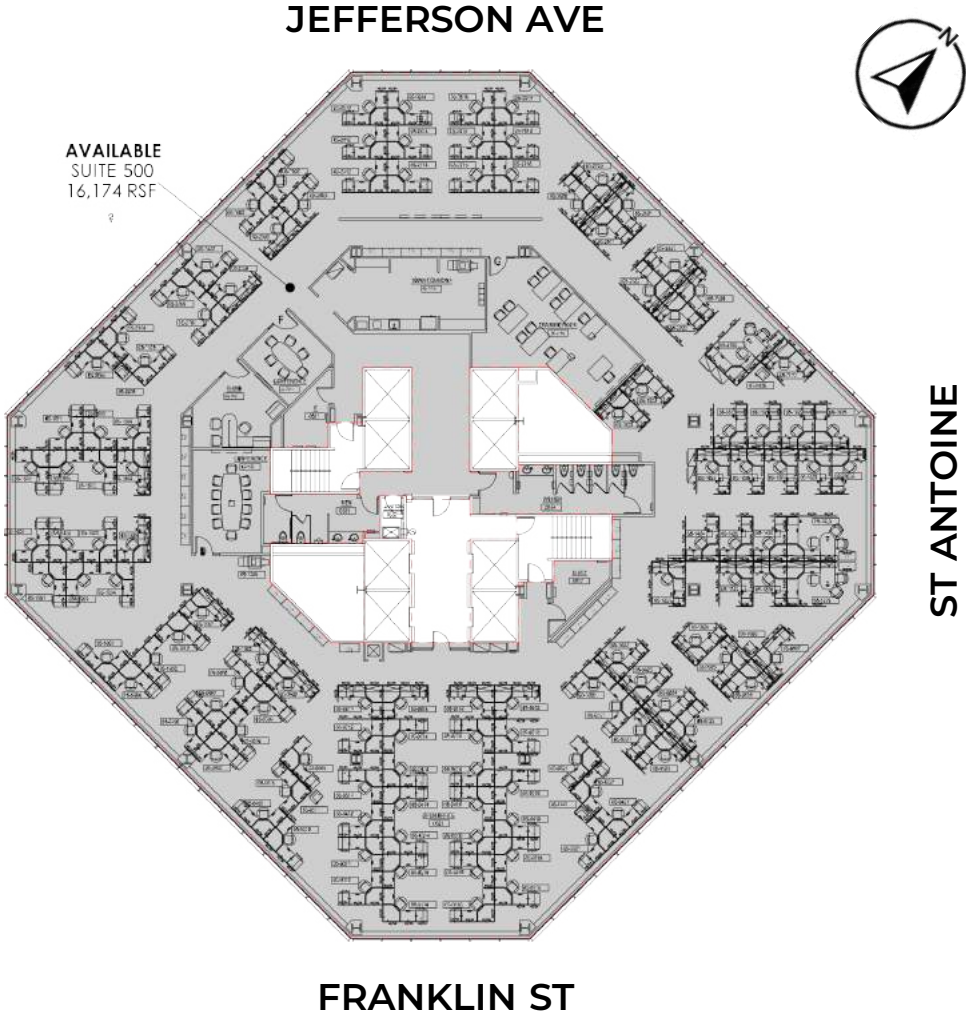

JEFFERSON AVE

ST ANTOINE

FRANKLIN ST

LEASING AVAILABILITY

SUITE 600 – 16,174 SF

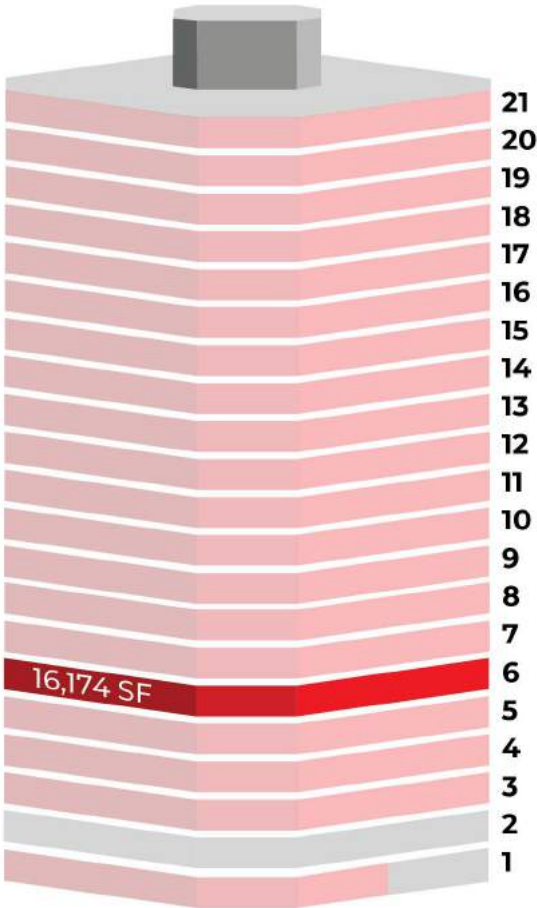

AVAILABLE **OCCUPIED**

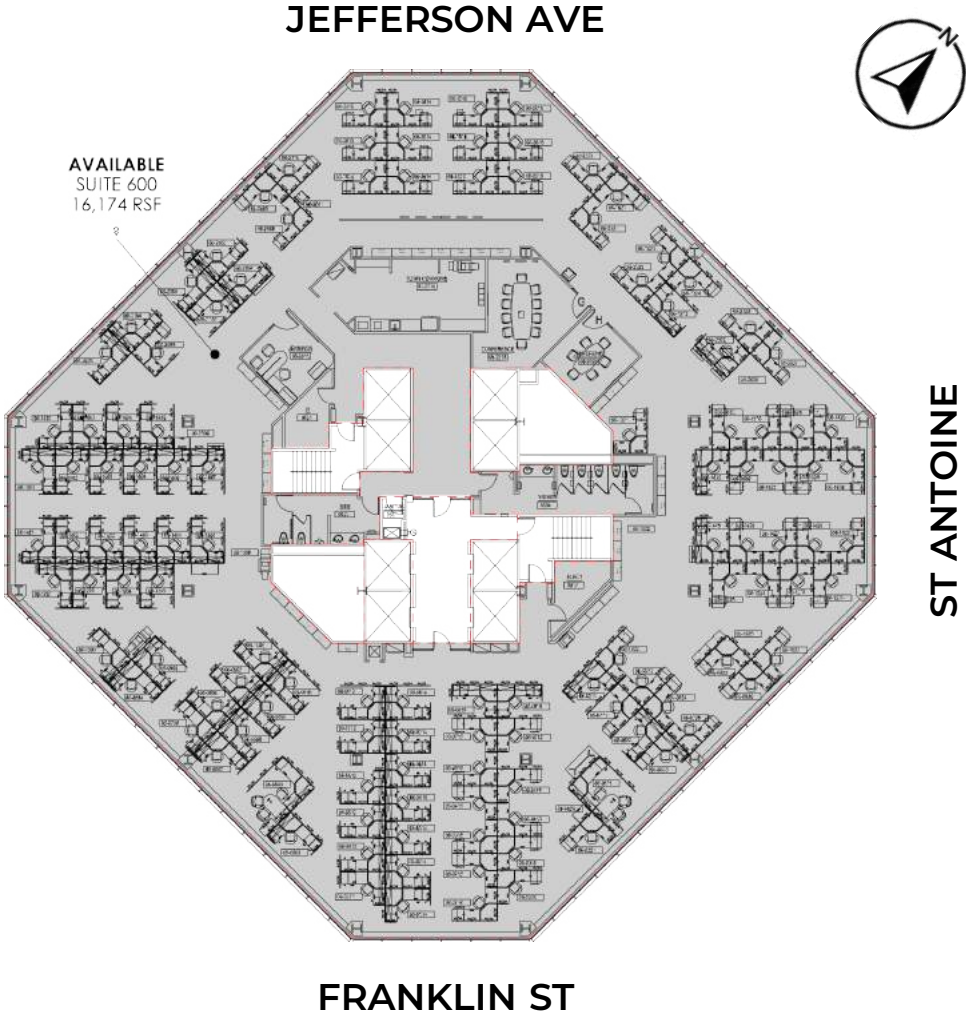

LEASING AVAILABILITY

SUITE 700 – 16,174 SF

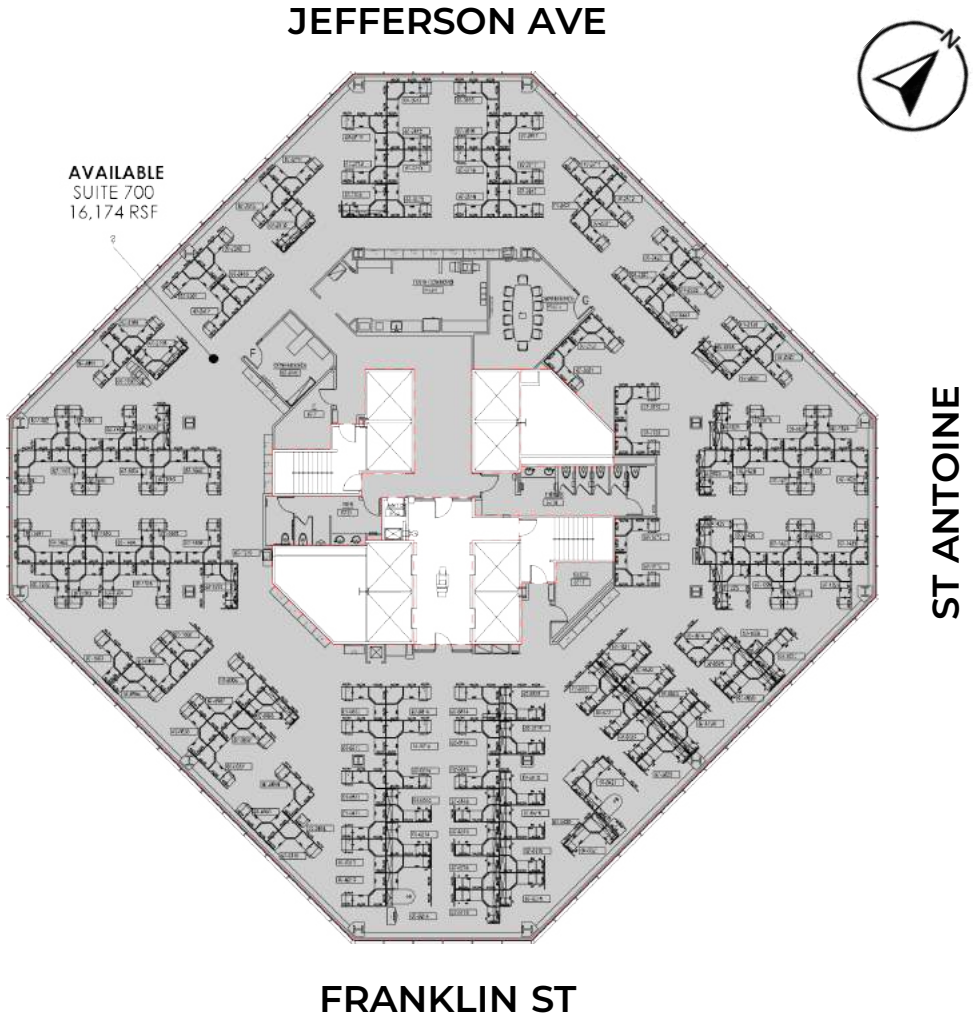
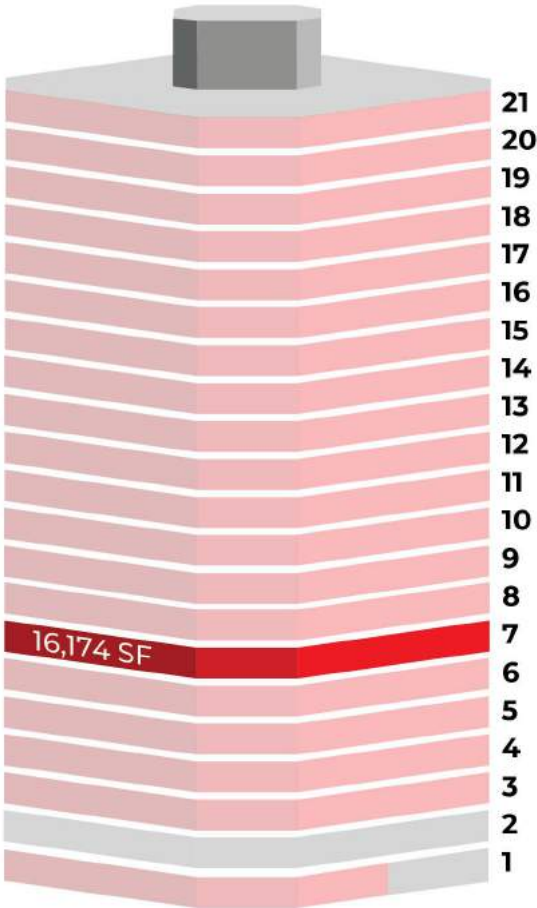

LEASING AVAILABILITY

SUITE 800 – 16,174 SF

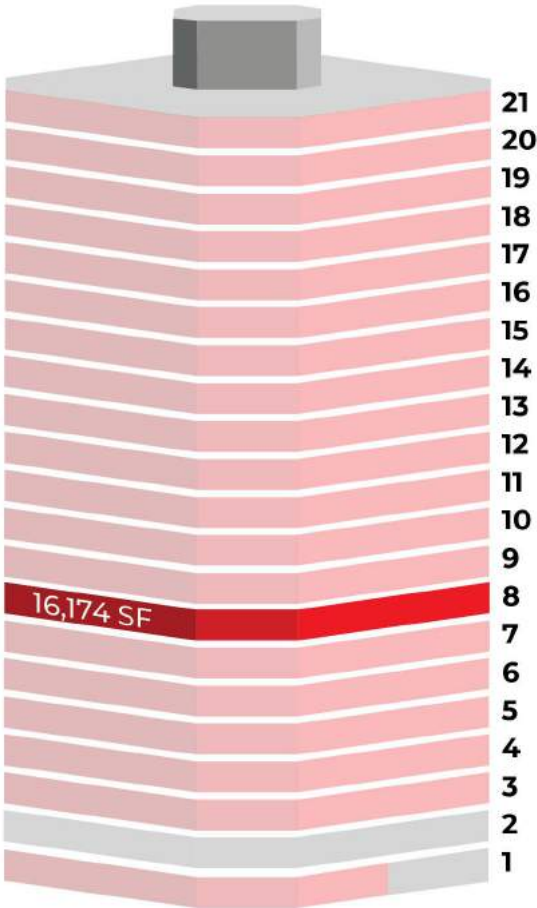

AVAILABLE **OCCUPIED**

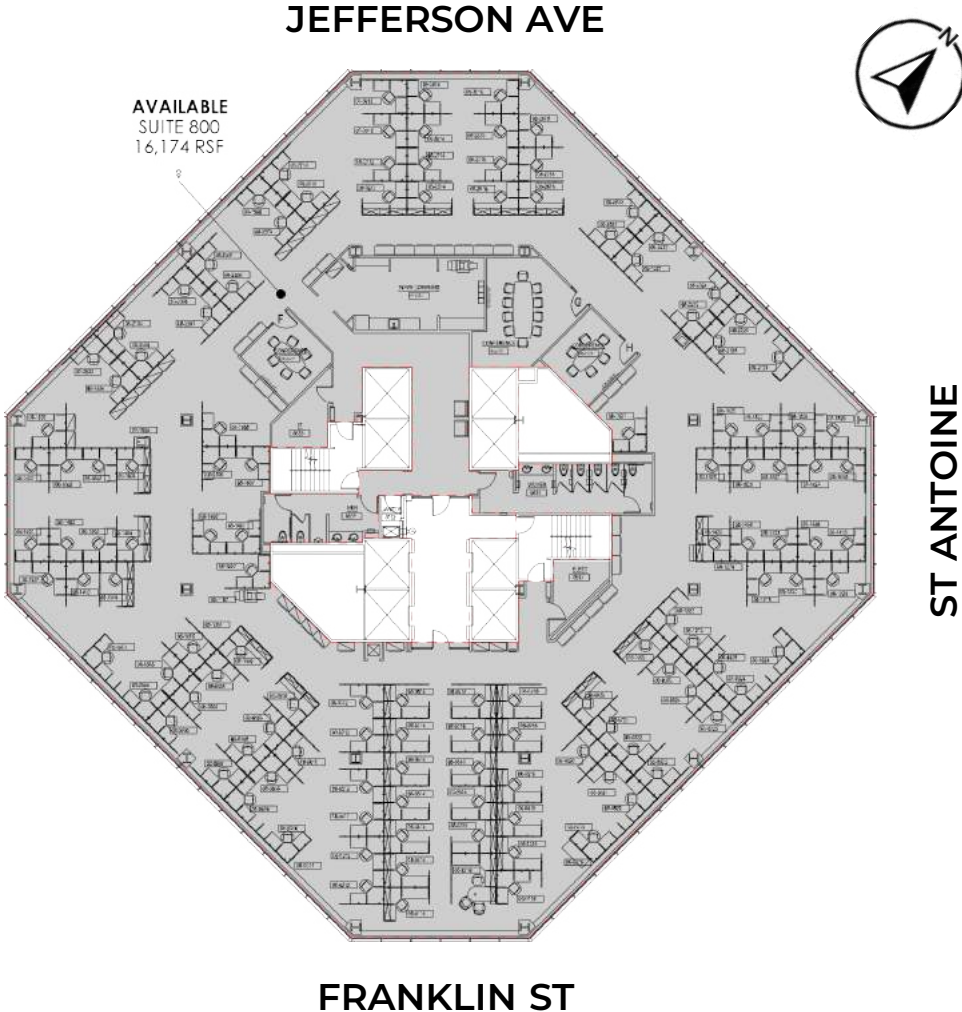

LEASING AVAILABILITY

SUITE 900 – 16,174 SF

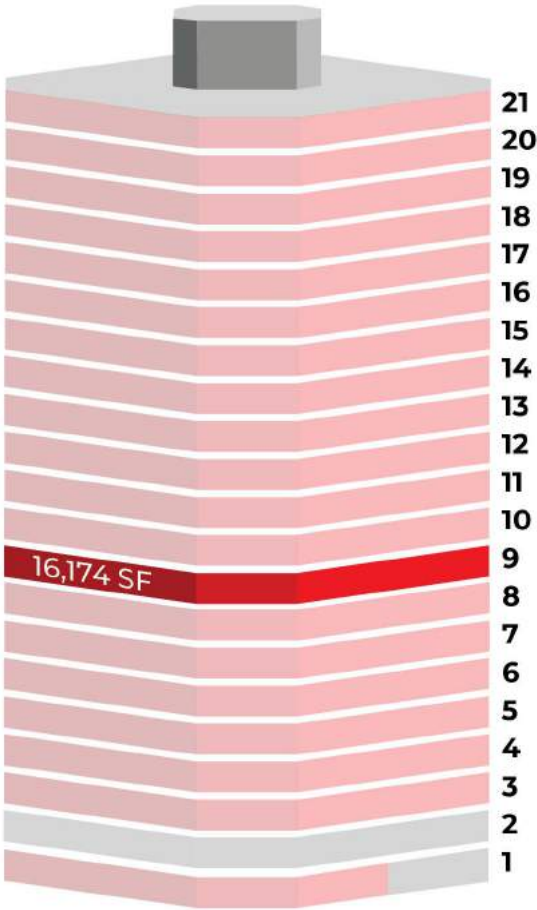

AVAILABLE **OCCUPIED**

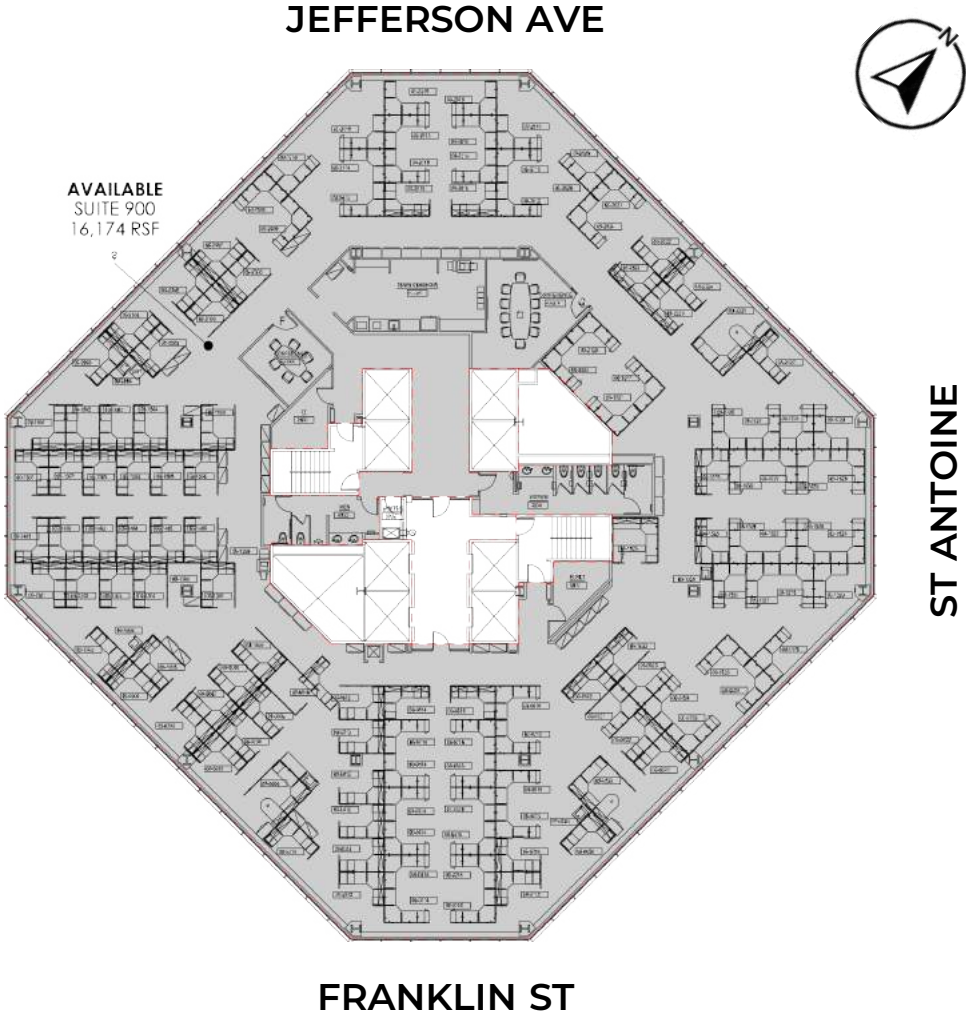

LEASING AVAILABILITY

SUITE 1000 – 16,174 SF

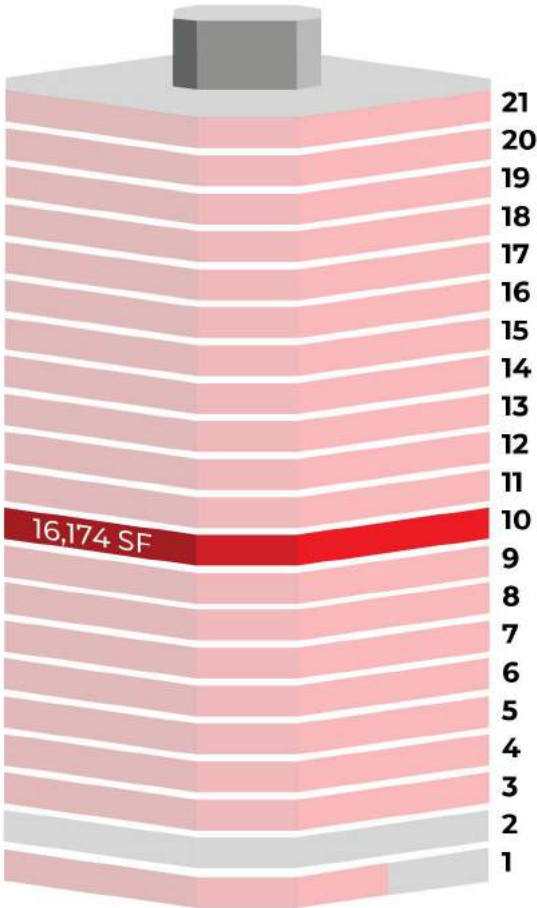

AVAILABLE **OCCUPIED**

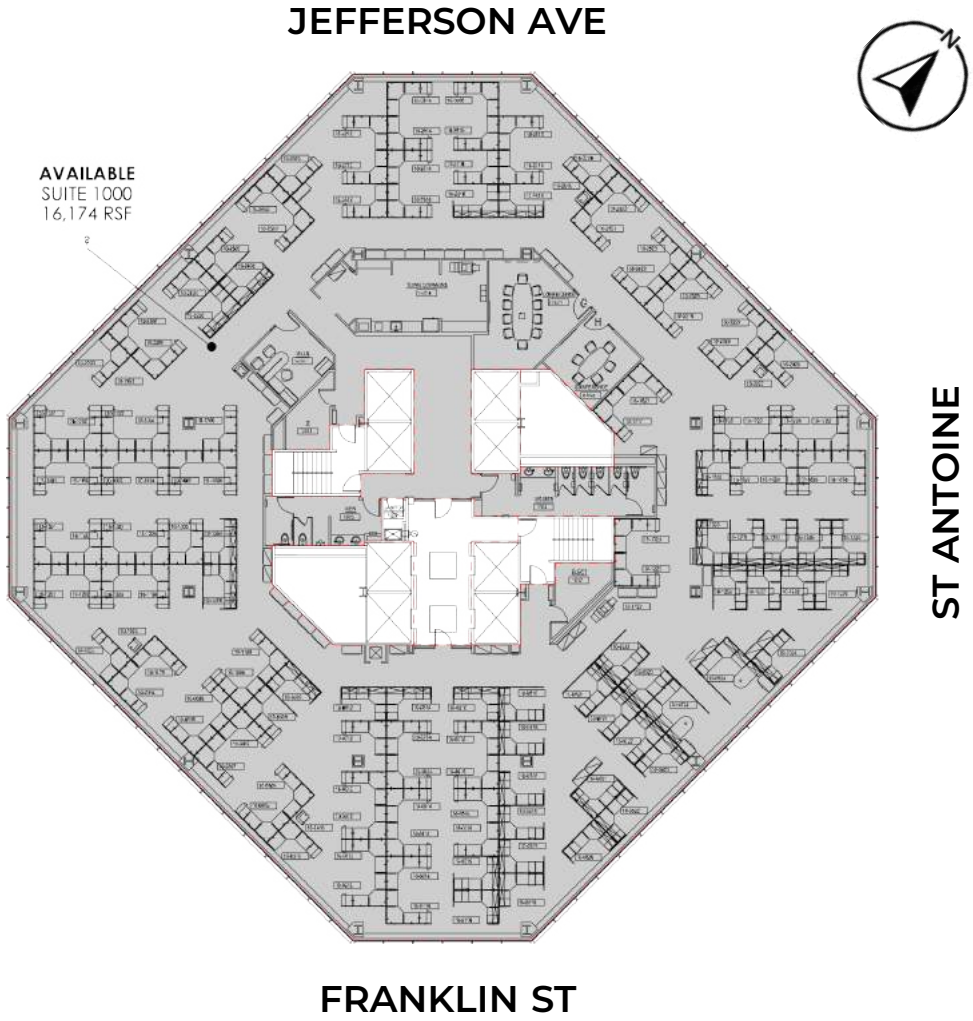

LEASING **AVAILABILITY**

SUITE 1100 – 16,261 SF

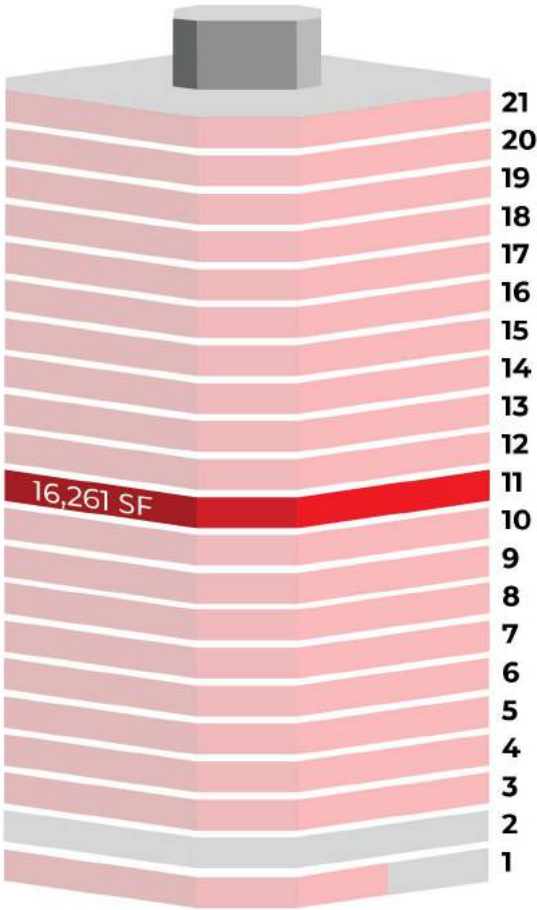

AVAILABLE **OCCUPIED**

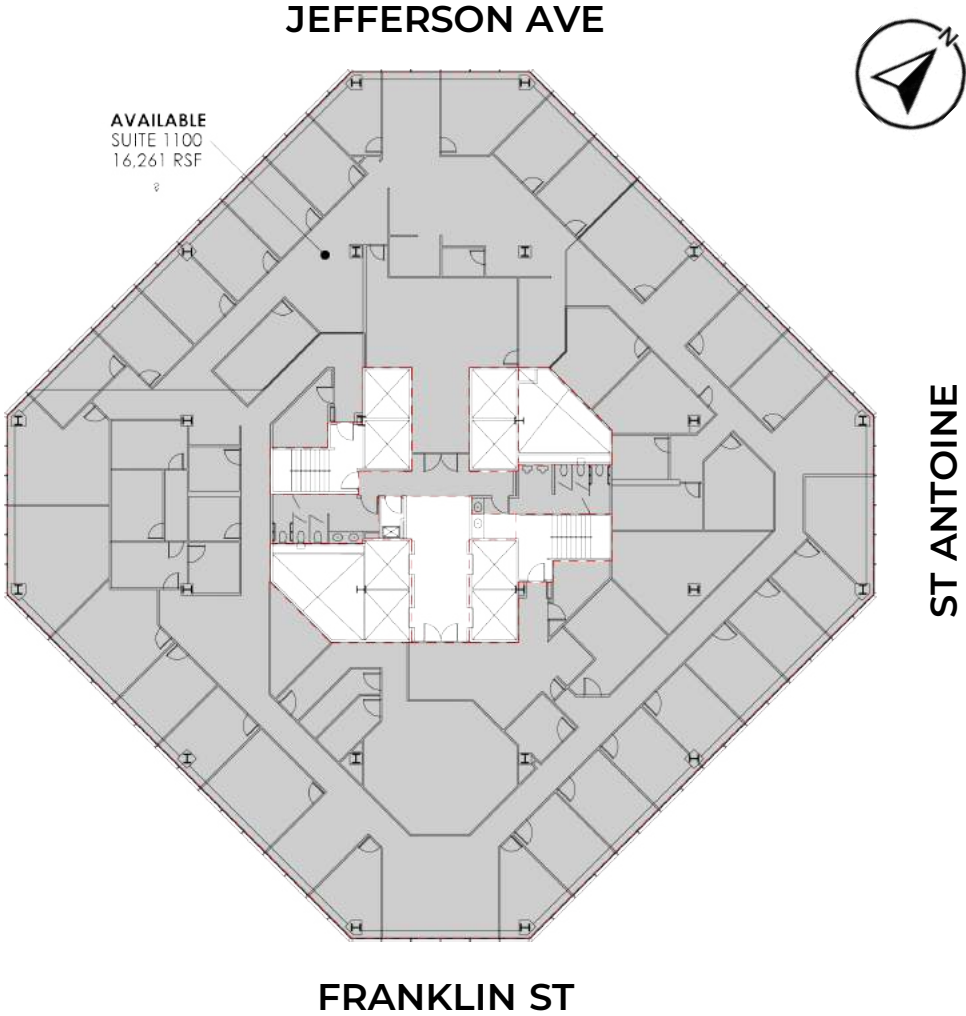

LEASING AVAILABILITY

FLOOR 12 – 15,032 SF

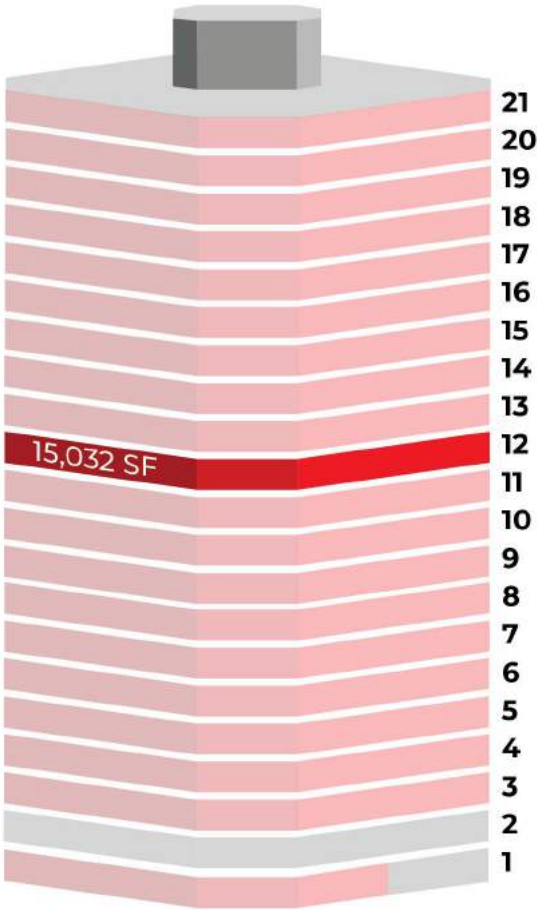

AVAILABLE **OCCUPIED**

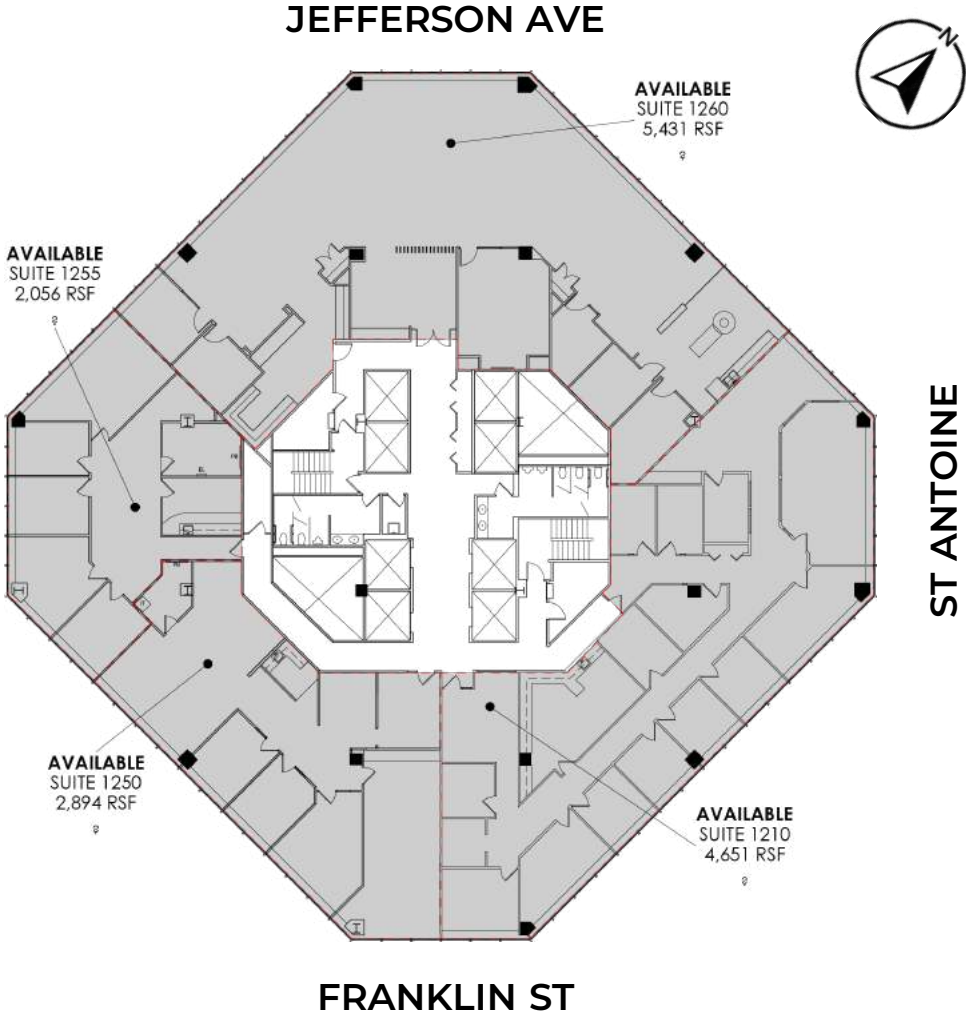

LEASING AVAILABILITY



SUITE 1300 – 16,915 SF

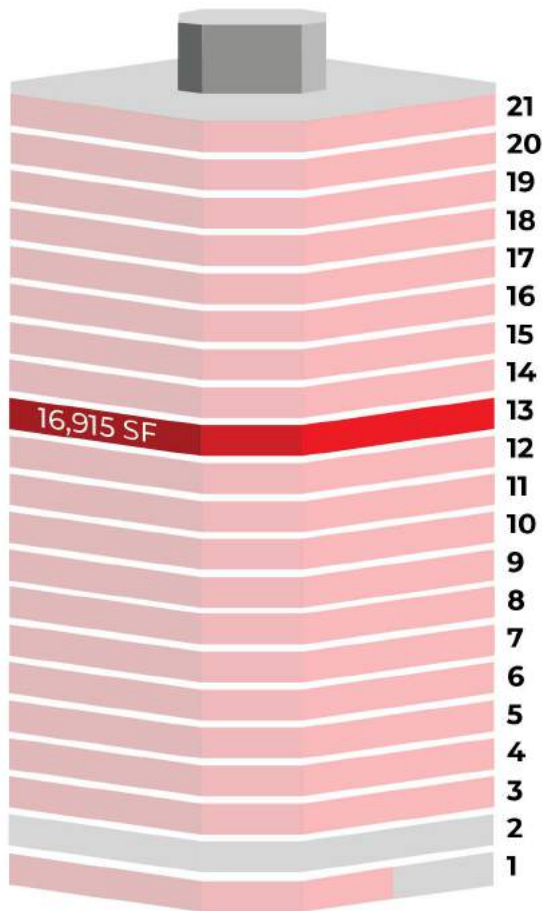

AVAILABLE

OCCUPIED

JEFFERSON AVE

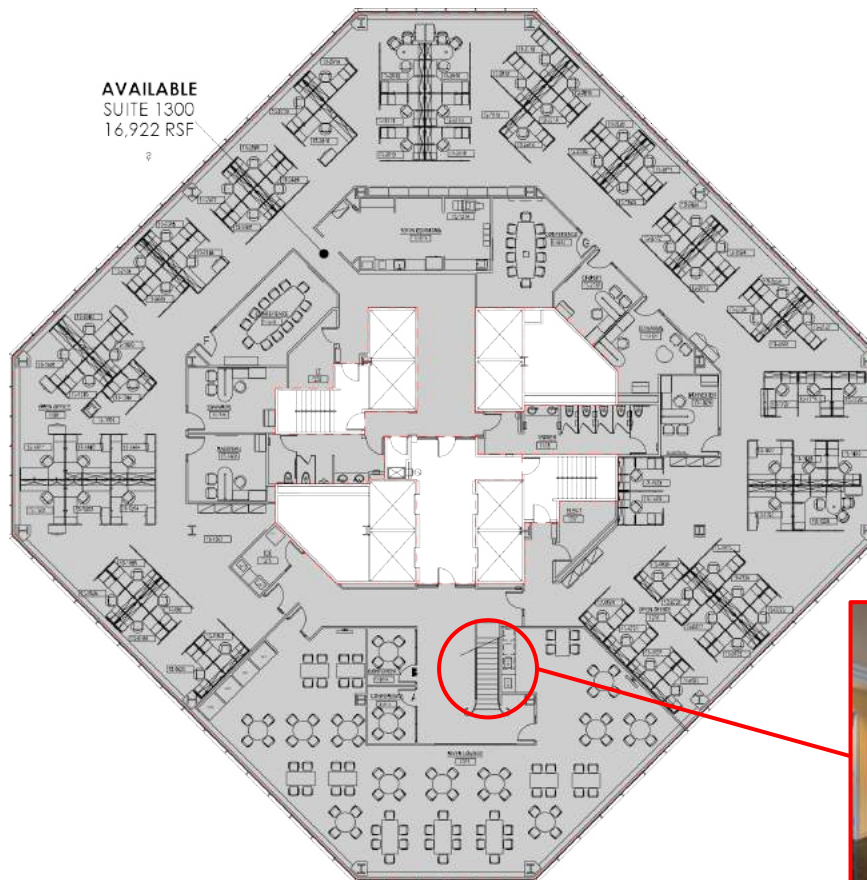

ST ANTOINE

FRANKLIN ST



Ensuite staircase between the 13th and 14th floors

LEASING AVAILABILITY

SUITE 1400 – 16,915 SF

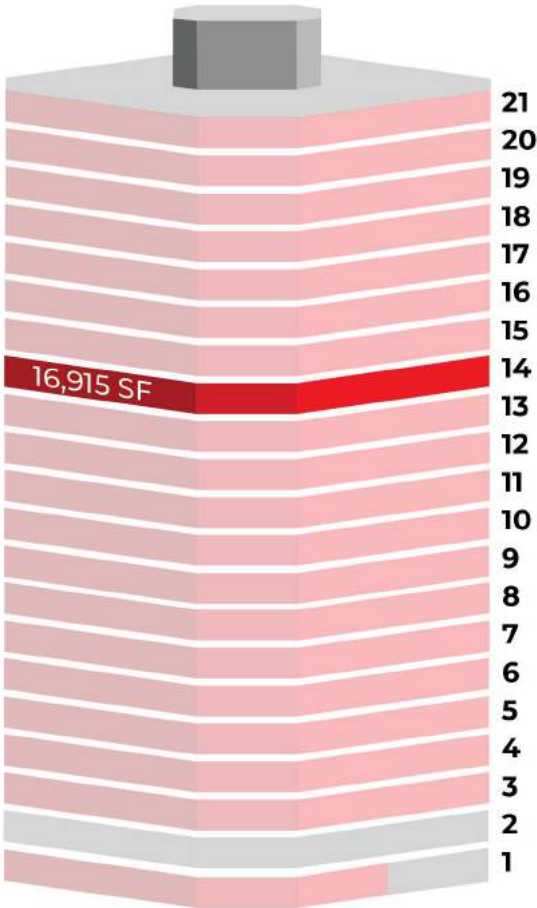

AVAILABLE **OCCUPIED**

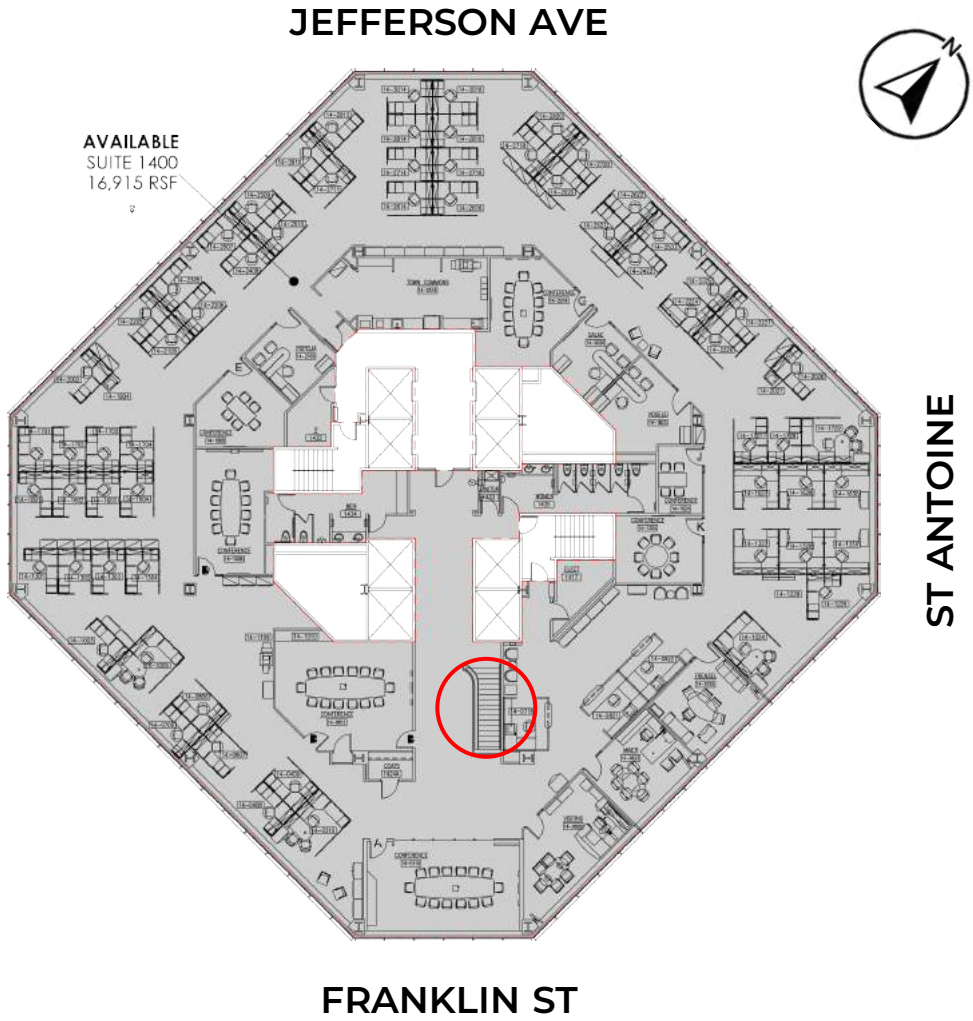

LEASING **AVAILABILITY**

SUITE 1500 – 15,864 SF

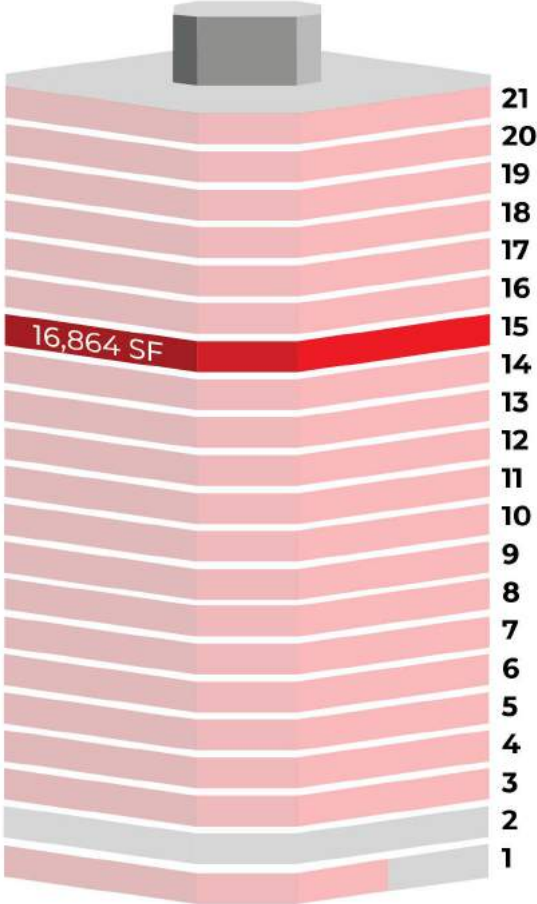

AVAILABLE **OCCUPIED**

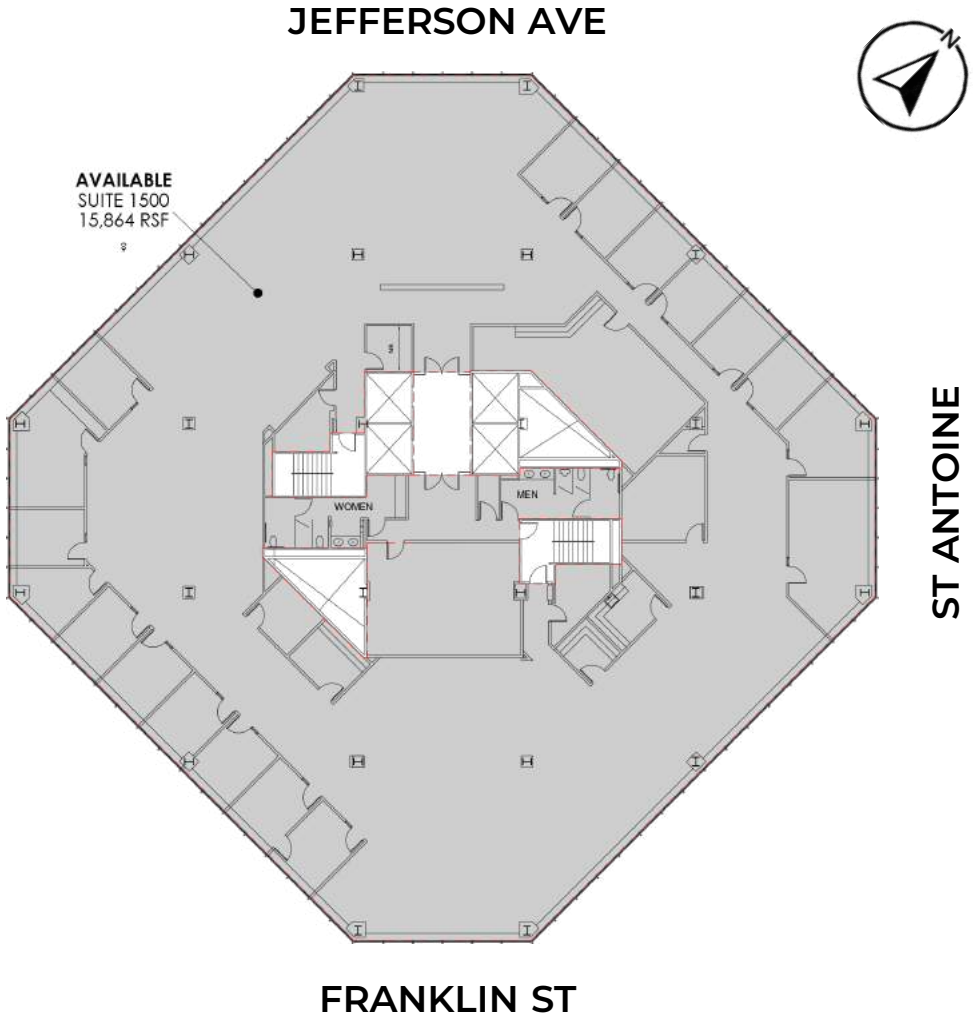

LEASING AVAILABILITY

SUITE 1600 – 16,581 SF

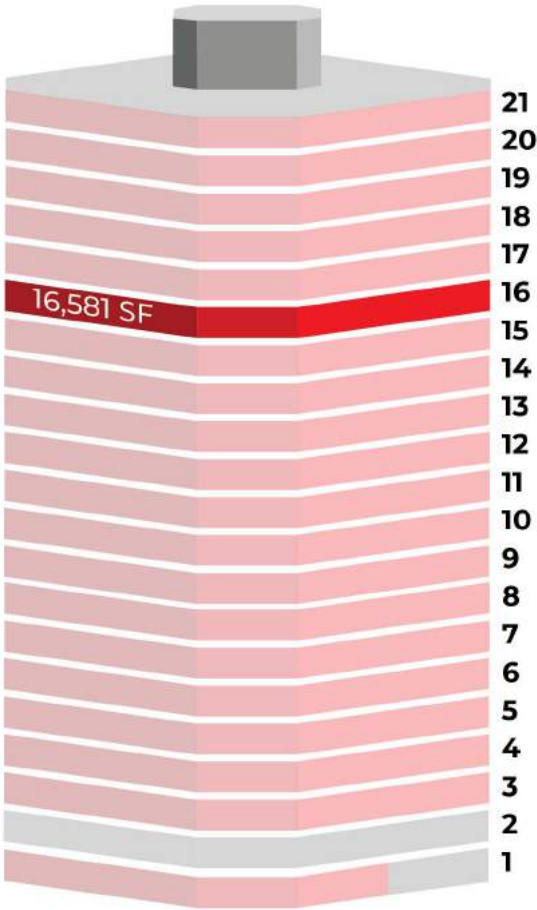

AVAILABLE **OCCUPIED**

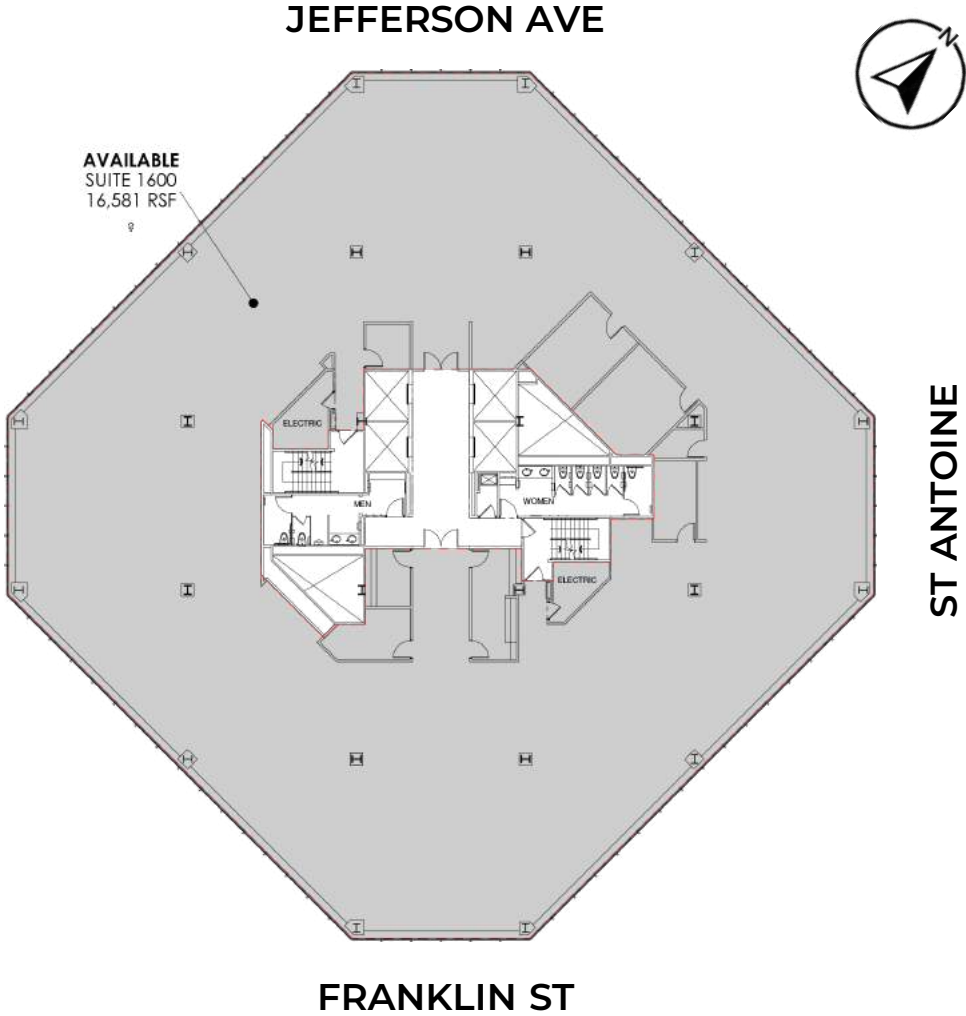

LEASING AVAILABILITY

SUITE 1700 – 16,751 SF

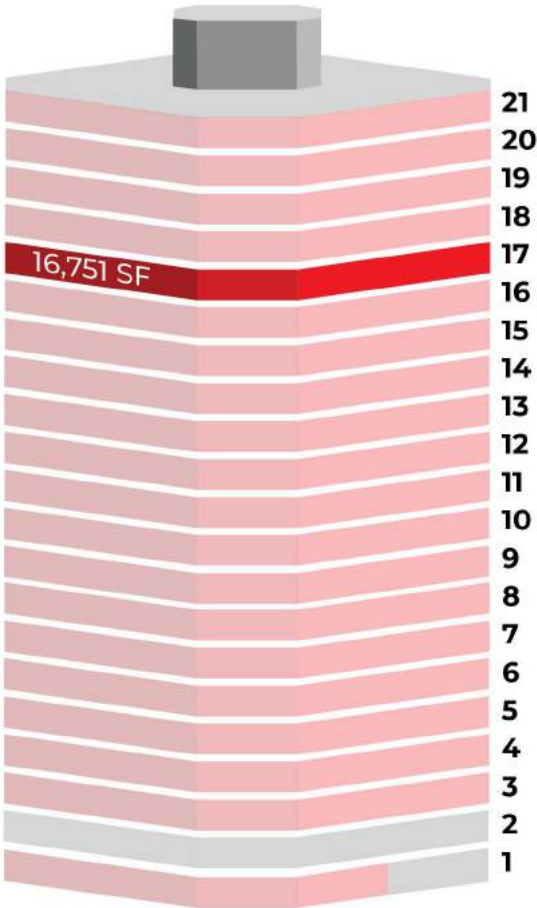

AVAILABLE **OCCUPIED**

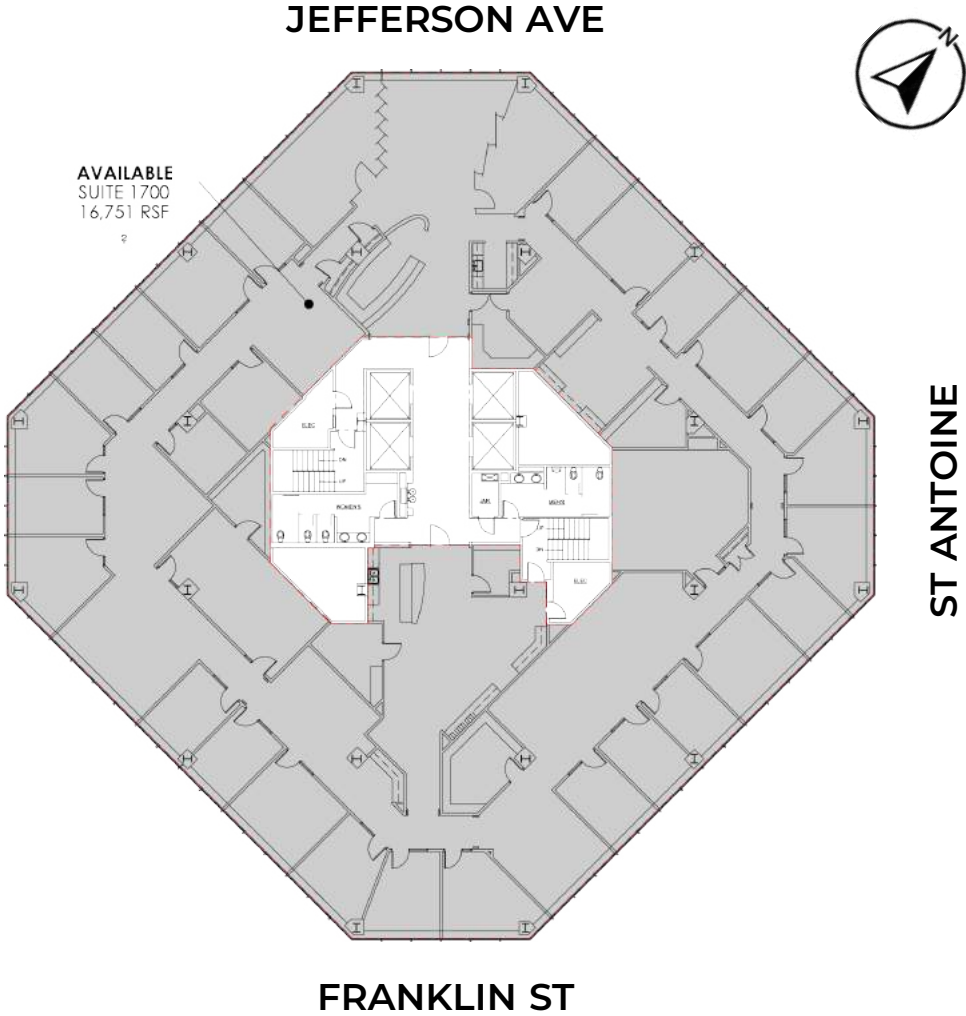

LEASING **AVAILABILITY**

SUITE 1800 – 16,697 SF

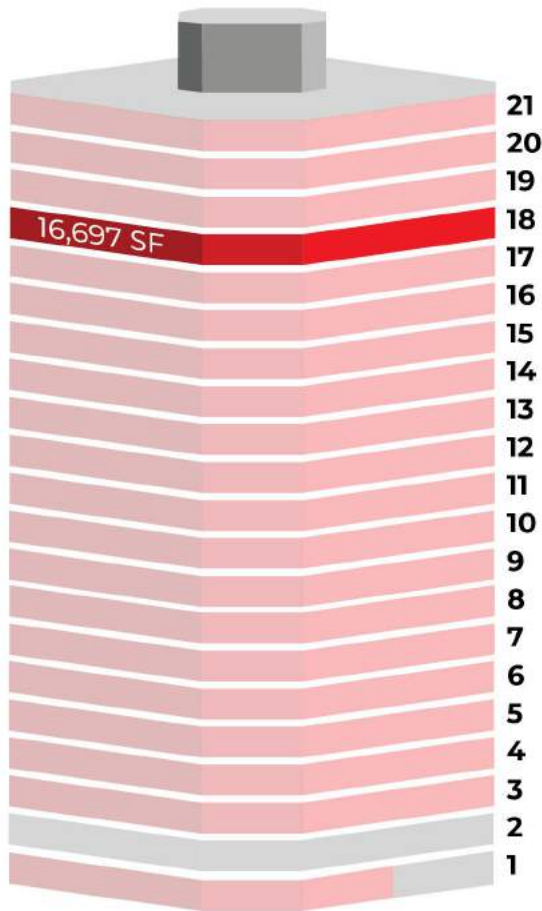

AVAILABLE **OCCUPIED**

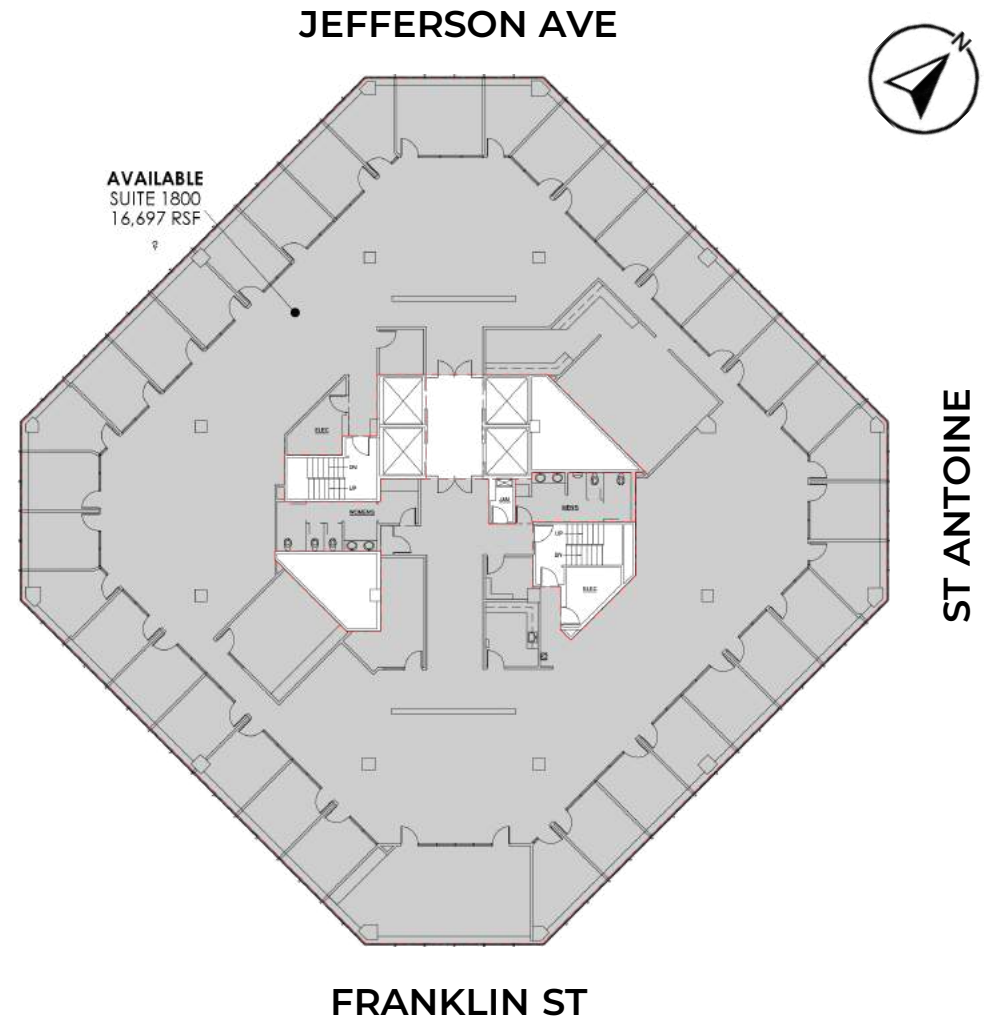

LEASING **AVAILABILITY**

SUITE 1900 – 16,736 SF

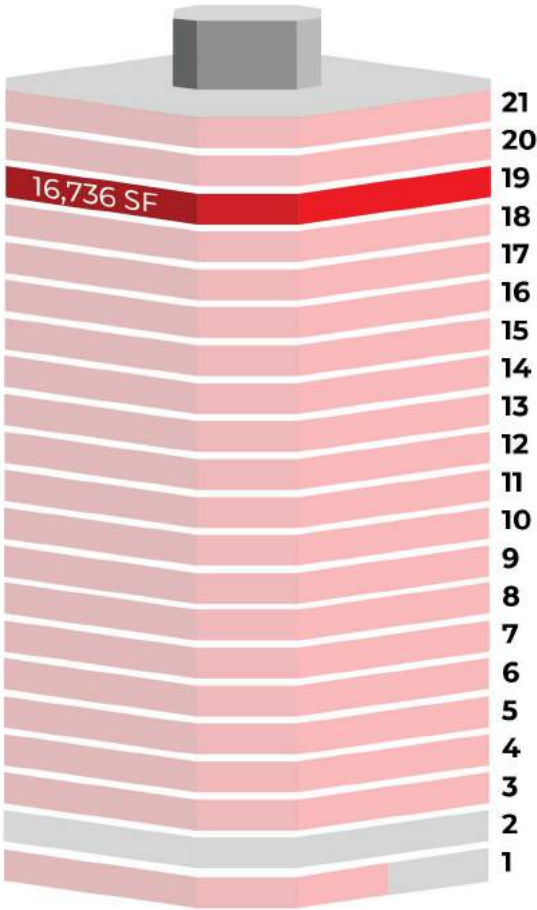

AVAILABLE **OCCUPIED**

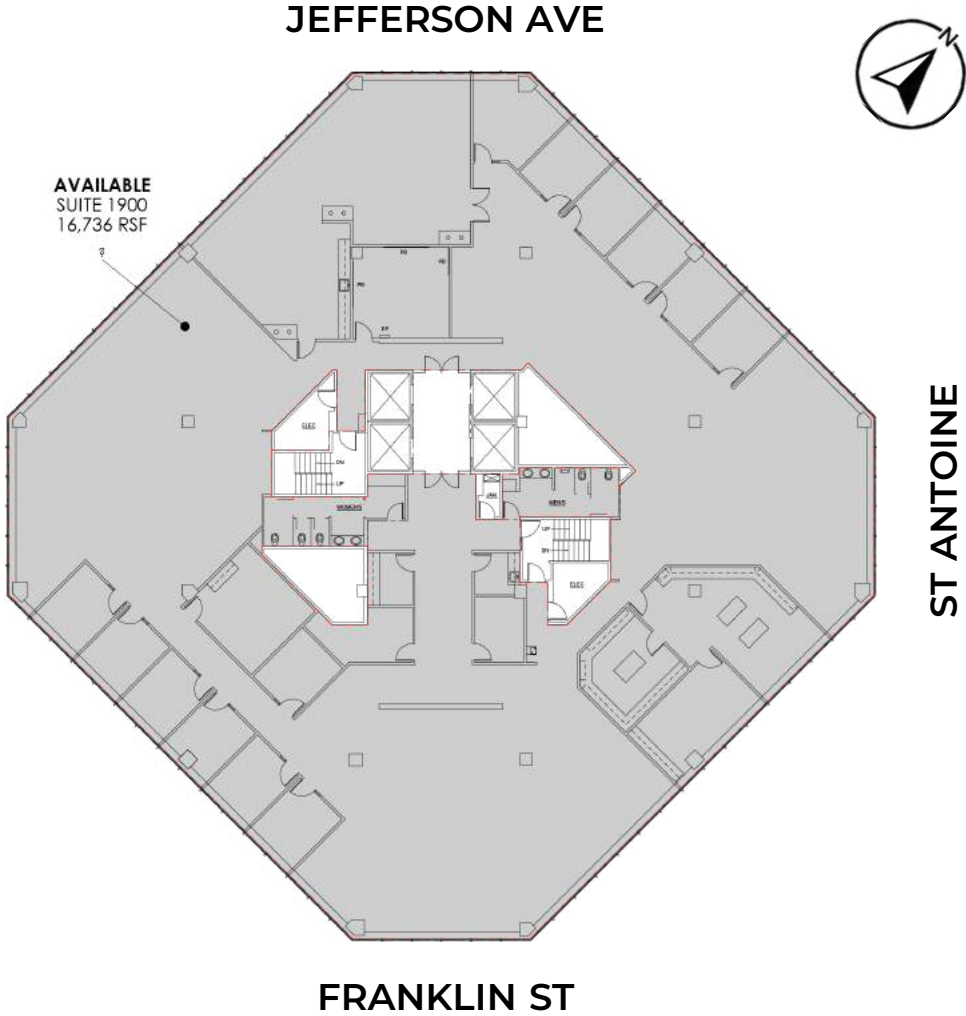

LEASING AVAILABILITY

SUITE 2000 – 16,618 SF

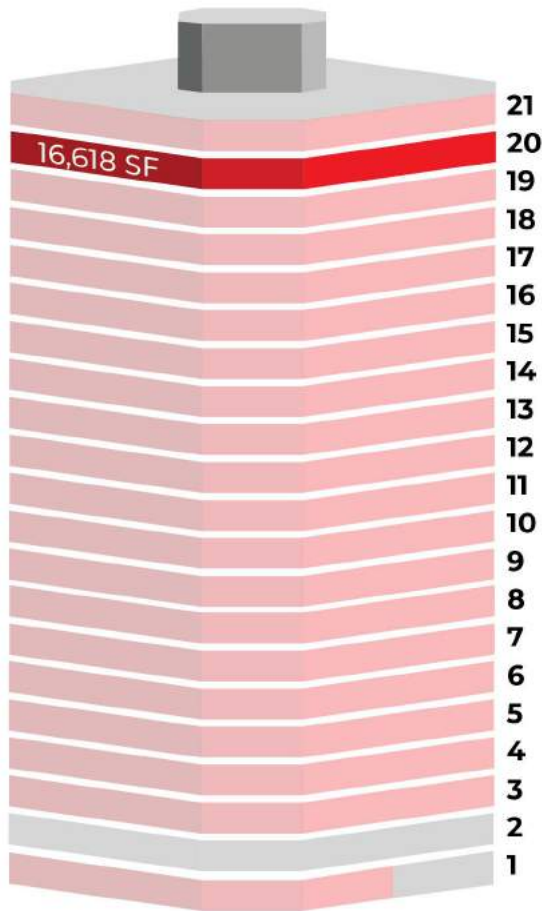

AVAILABLE **OCCUPIED**

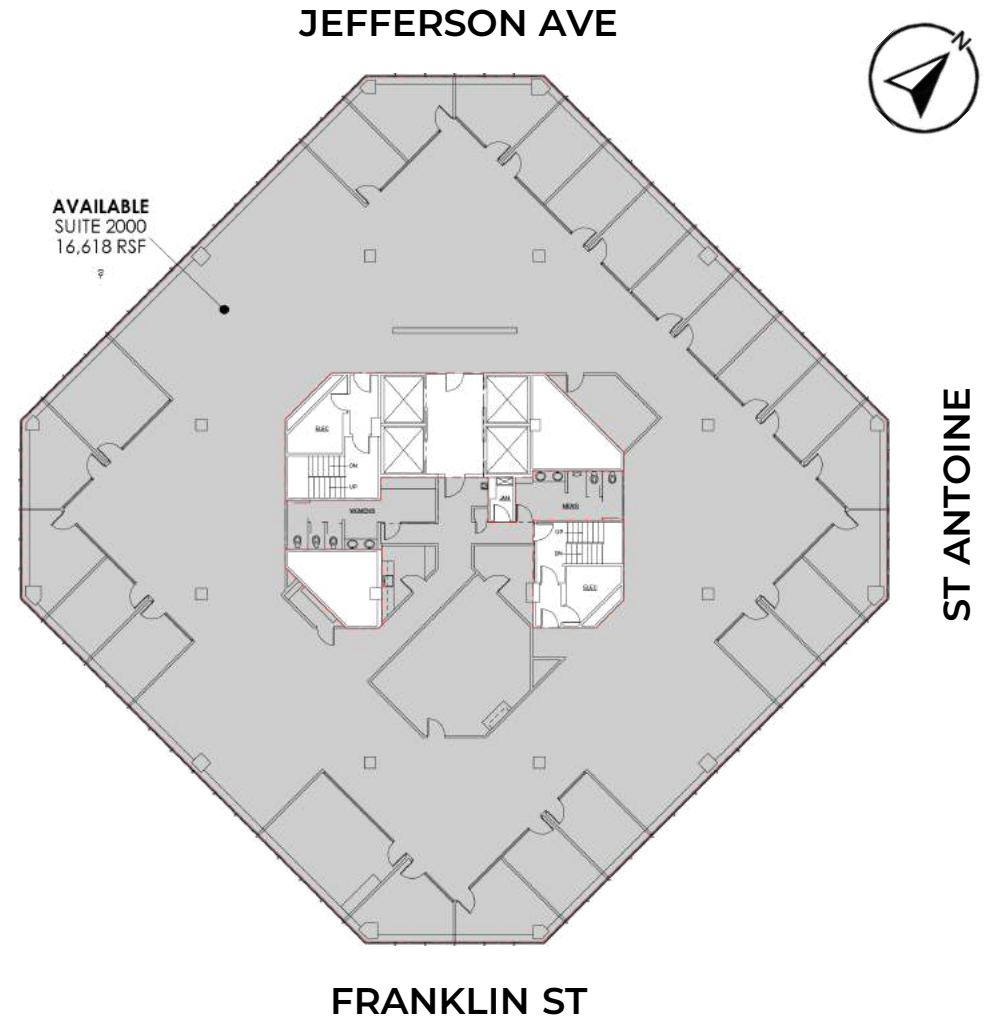

LEASING AVAILABILITY

SUITE 2100 – 16,638 SF

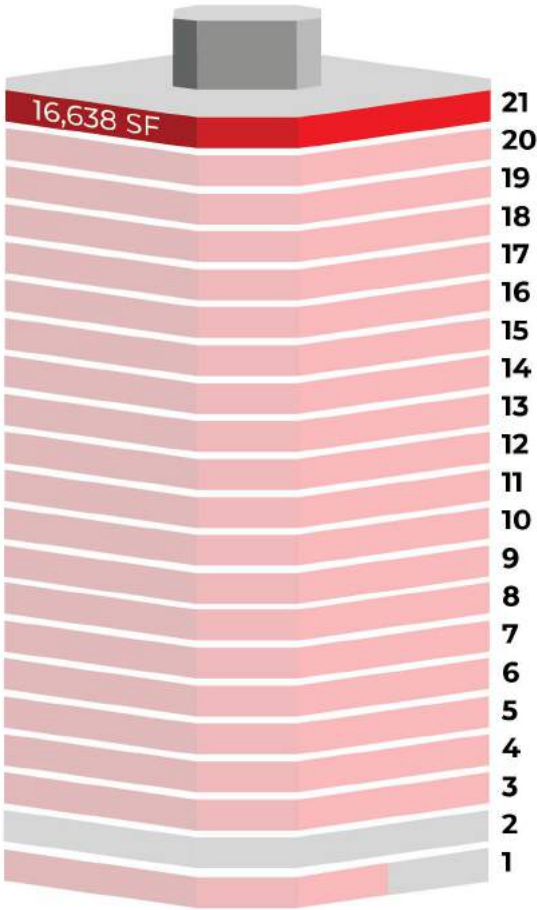

AVAILABLE **OCCUPIED**

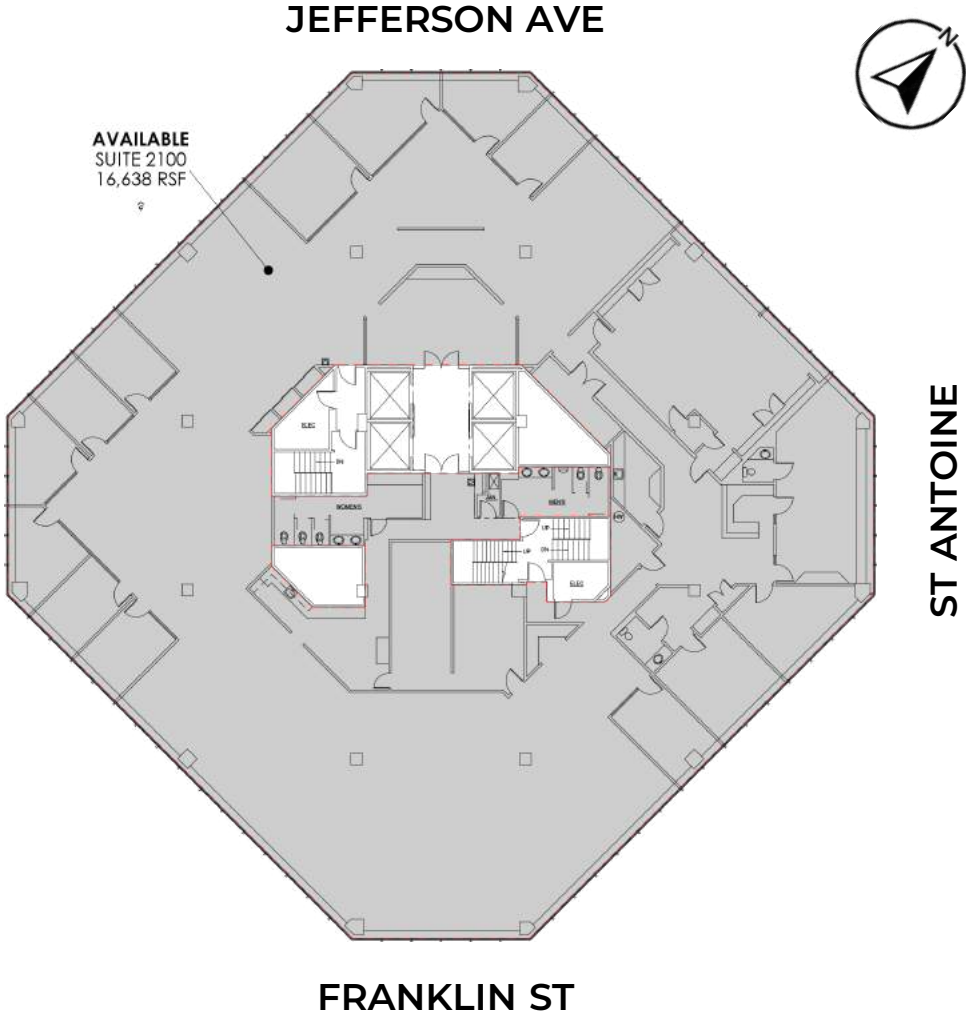

AVAILABLE PARKING

PARKING – 475 DEDICATED SPACES

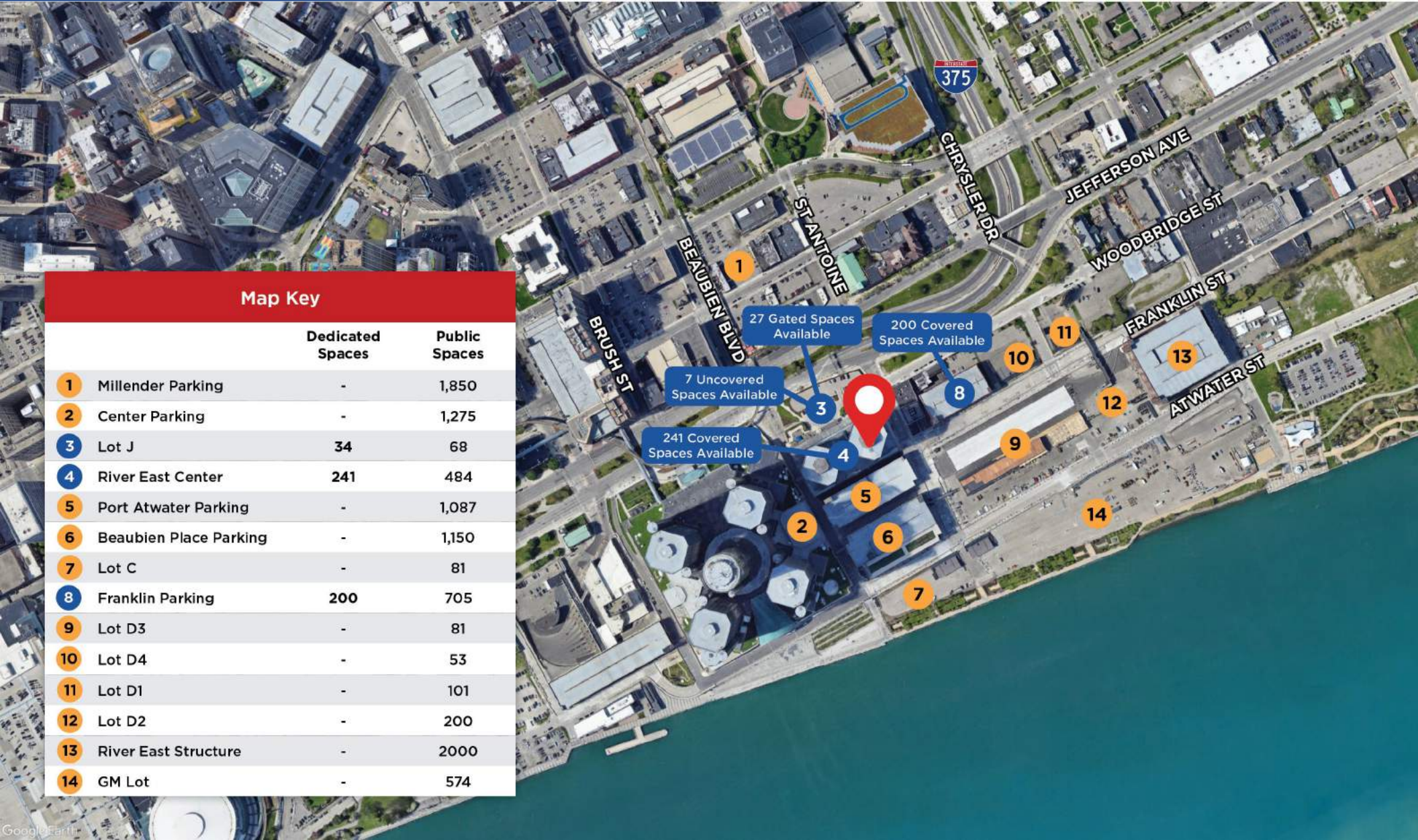

Map Key

		Dedicated Spaces	Public Spaces
1	Millender Parking	-	1,850
2	Center Parking	-	1,275
3	Lot J	34	68
4	River East Center	241	484
5	Port Atwater Parking	-	1,087
6	Beaubien Place Parking	-	1,150
7	Lot C	-	81
8	Franklin Parking	200	705
9	Lot D3	-	81
10	Lot D4	-	53
11	Lot D1	-	101
12	Lot D2	-	200
13	River East Structure	-	2000
14	GM Lot	-	574

27 Gated Spaces Available

200 Covered Spaces Available

7 Uncovered Spaces Available

241 Covered Spaces Available

REGIONAL DRIVE TIMES

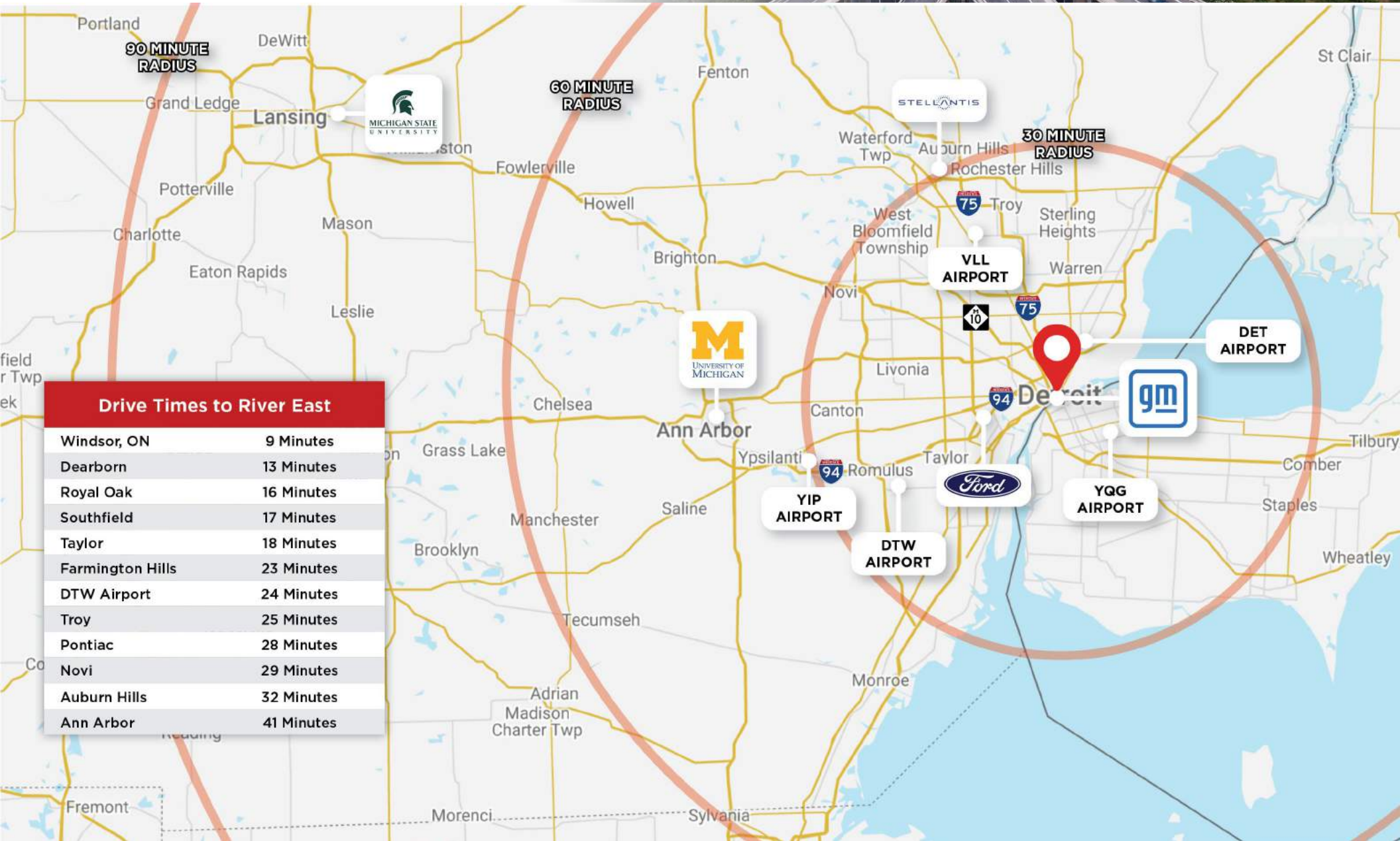

ACCESSIBLE TRANSPORTATION

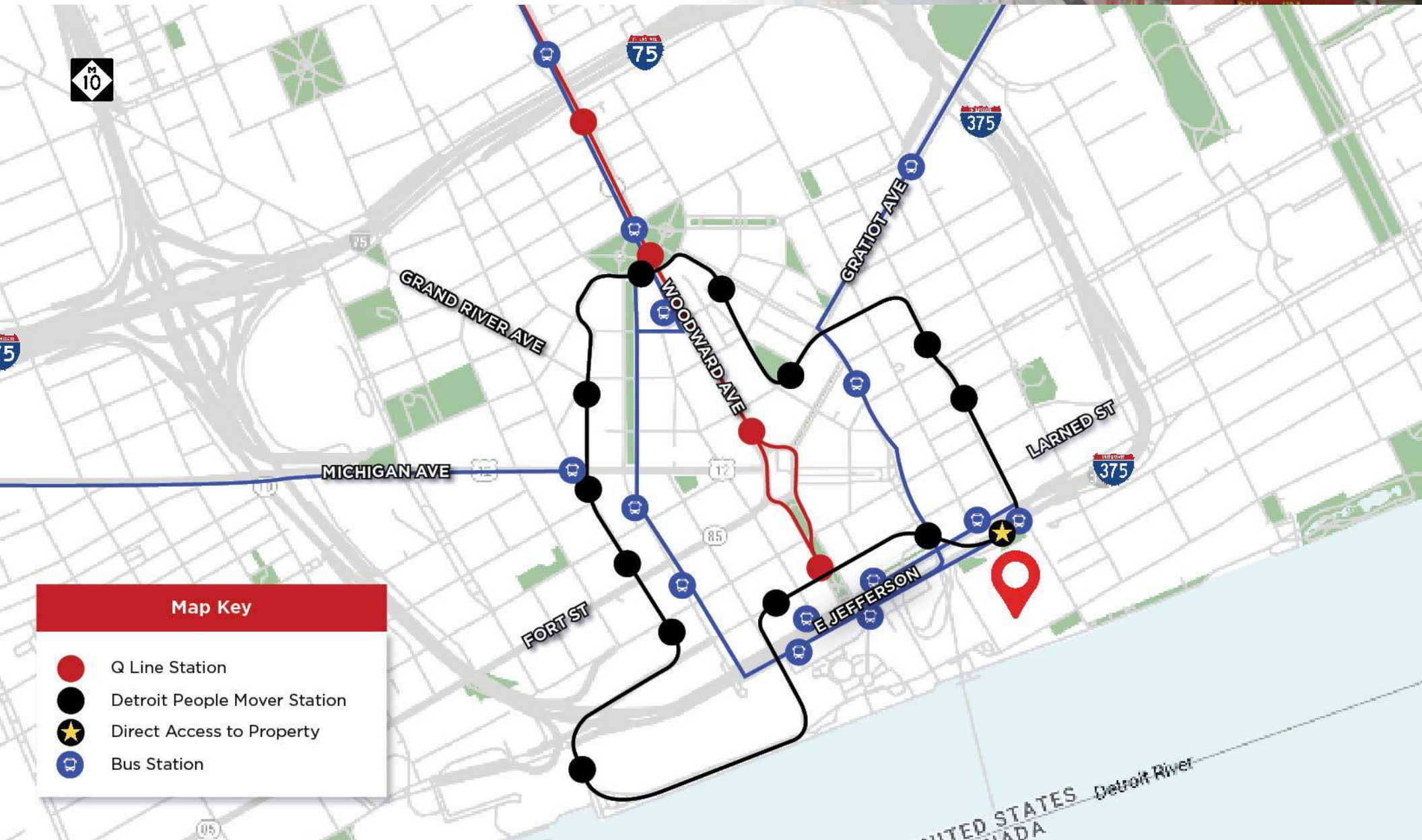

JEFFERSON AVE. DESIGN PROJECT

I-375 Restructuring

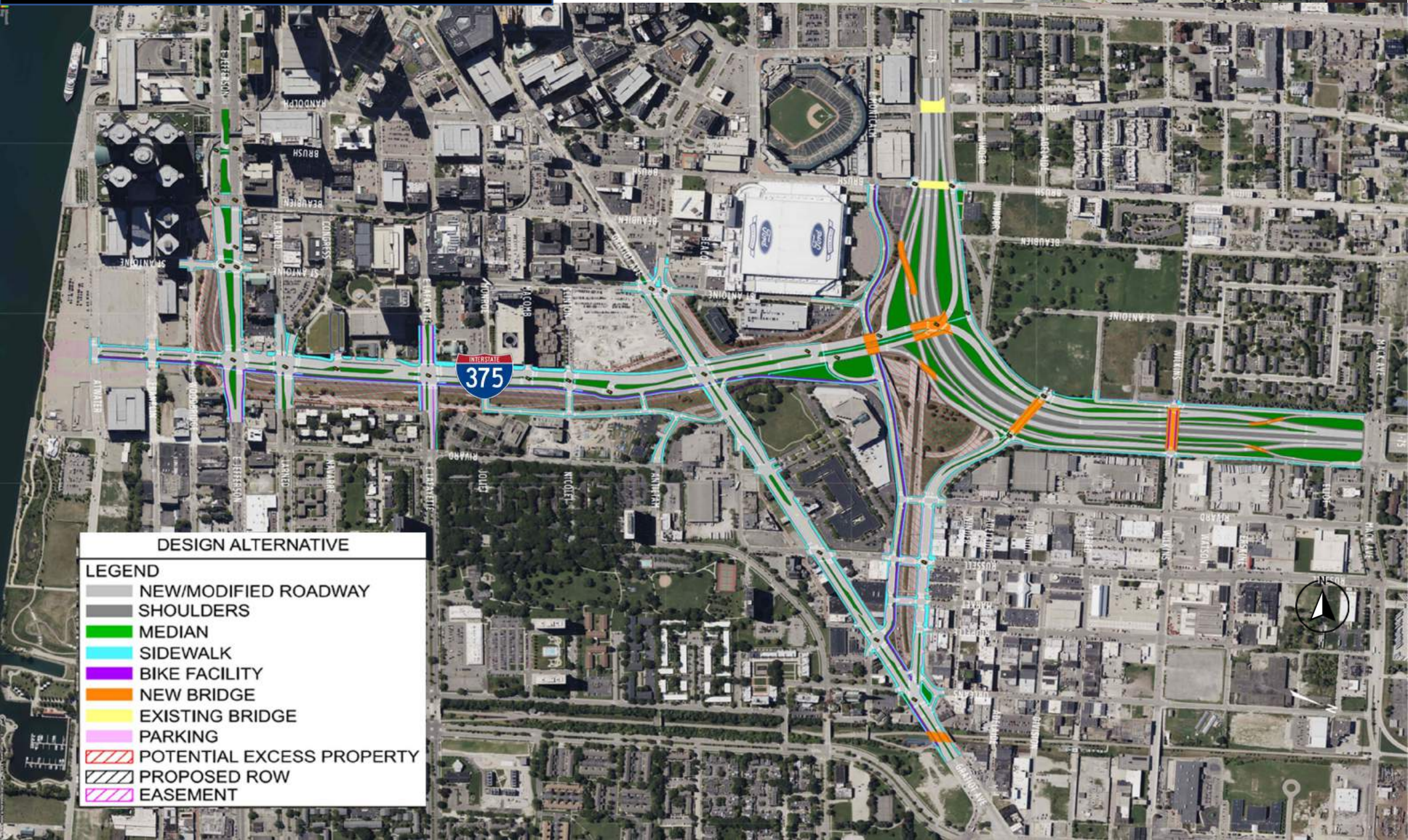

LOCAL ENTERTAINMENT

Music Venues

- Fox Theatre
- Masonic Temple
- The Fillmore Detroit
- Magic Stick
- Saint Andrew's Hall
- Music Hall Center for the Performing Arts
- El Club
- The CUBE
- The Majestic Theatre
- The Shelter
- Gem Theatre Detroit
- Sound Board Theater
- Garden Theater
- Big Pink
- Orchestra Hall
- Fisher Music Center
- Aretha Franklin Amphitheater

Casinos

- Hollywood Casino at Greektown
- MotorCity Casino Hotel
- MGM Grand Detroit

Sports

- Ford Field (Detroit Lions)
- Comerica Park (Detroit Tigers)
- Little Caesars Arena (Detroit Pistons, Detroit Redwings)
- Detroit City Fieldhouse (Detroit City FC)

Museums

- Detroit Institute of Arts
- Detroit Historical Museum
- Motown Museum
- Michigan Science Center
- Dossin Great Lakes Museum
- Museum of Contemporary Art Detroit



**Detroit
Opera**



**HOLLYWOOD
Casino**
AT GREEKTOWN

MotorCity
CASINO HOTEL

MGM GRAND
DETROIT



RENAISSANCE CENTER & NEARBY AMENITIES

Clothing

- GM Company Store
- Sam's Tailor Shop
- Sassy Fashion Couture

Gifts

- Ashley's Flowers
- City Market
- Costa D'Oro Jewelers
- GM Company Store

Grocery

- Andrew's Downtown Detroit
- City Market

Hotels

- Detroit Marriott

Event Centers

- GM Learning Center
- Detroit Marriott Ballroom
- Highlands Events
- Renaissance Conference Center
- Huntington Place

Food

- Andiamo Detroit Riverfront
- Andrew's Downtown Detroit
- Bangkok Crossing
- Birmingham Deli
- Burger King
- City Market
- Coney Town
- Fuell
- High Bar
- Highlands
- Joe Muer Seafood
- Motor City Pantry
- Panera Bread
- Potbelly Sandwich Works
- Salsarita's Fresh Mexican Grill
- Starbucks - Marriott
- Subway

Services

- Allegra Print, Signs & Marketing
- Ashley's Flowers
- Athletico Physical Therapy
- Childtime Learning Center
- Christian Science Reading Room
- Comerica Bank ATM
- Costa D'Oro Jewelers
- Great Expressions Dental Centers
- Henry Ford OptimEyes
- Mail Service and Shipping Couriers
- Renaissance Conference Center
- RenCen Fitness Center
- Sam's Tailor Shop
- U.S. Post Office



DETROIT RIVERFRONT



AMENITIES

- Aretha Franklin Amphitheatre
- Cullen Plaza
- Detroit/Wayne County Port Authority (DWCPA)
- Gabriel Richard Park
- GM Plaza
- Harbortown
- Hart Plaza
- Milliken State Park and Harbor
- Tawas Point Lighthouse
- Milliken State Park Wetlands
- Mt. Elliott Park & Pavilion
- Outdoor Adventure Center (OAC)
- Riverwalk Garden Rooms
- Valade Park
- Roberts RiverWalk Hotel
- UAW-GM Center for Human Resources
- Uniroyal Factory Site
- Belle Isle State Park
- Dequindre Cut
- Eastern Market

The initial stage of the Detroit waterfront transformation endeavor encompasses approximately three-and-a-half miles along the east riverfront, stretching from Joe Louis Arena to Gabriel Richard Park, and stands at over 80 percent completion.

The developed sections of the east riverfront, in conjunction with the Dequindre Cut—a greenway converted from former railway lines—draw in an estimated three million visitors annually. These visitors engage in various activities such as walking, running, biking, spending leisure time with family and friends, and seizing the enhanced quality of life offered by a revitalized riverfront.

The attractions along the east riverfront consist of parks, plazas, pavilions, interconnected pathways, and expansive green spaces—all interlinked by the highly popular RiverWalk.

In the summer of 2012, the Conservancy initiated the final construction phases aimed at finishing the east riverfront project, aiming to link the RiverWalk with its associated green spaces along the waterfront.

The initial construction phase involved a comprehensive renovation of Mt. Elliott Park, which reopened in June 2014. Subsequently, the second construction phase focused on improvements to Gabriel Richard Park and the development of land parcels on both the western and eastern sides of Chene Park. The forthcoming final phase will oversee the creation of public spaces along the Uniroyal site.



DOWNTOWN AT A GLANCE



SIGNAGE

OPPORTUNITIES

Detroit



VIEW FROM CANADA

**INTERNATIONAL SIGNAGE
OPPORTUNITIES**

VIEW FROM DETROIT

**CITY FACING
SIGNAGE**



YOUR SIGN



BE FRONT AND CENTER FOR **DETROIT'S PREMIER EVENTS**



CREATING
VALUE
BEYOND
**REAL
ESTATE**



FRIEDMAN
REAL ESTATE 

FRIEDMAN REAL ESTATE | 34975 W. 12 MILE ROAD | FARMINGTON HILLS, MI 48331 | FRIEDMANREALESTATE.COM

ROBERT GAGNIUK

Leasing Manager

P 248.324.2000

E robert.gagniuk@freg.com

JORDAN FRIEDMAN

Managing Director

P 248.848.3521

E jordan.friedman@freg.com

JARED FRIEDMAN

Executive Managing Director

P 248.848.3511

E jared.friedman@freg.com

DAVID FRIEDMAN

President & CEO

P 248.324.2000

E david.friedman@freg.com