

For Sale

Property Information

| | |
|----------------------|------------------------------|
| Price | \$5,975,000 |
| Property Type | Land |
| Land Size | 19.60 acres |
| Zoning | C1 - Neighborhood Commercial |
| Parcel # | R3453500000, R3454200000 |



Self Storage

428 units & 56 RV Parking Sites

| Size | # of Units |
|------------|------------|
| 5 x 10 ft | 24 |
| 10 x 10 ft | 97 |
| 10 x 15 ft | 67 |
| 10 x 20 ft | 66 |
| 10 x 25 ft | 54 |
| 10 x 30 ft | 56 |
| 12 x 30 ft | 48 |
| 15 x 40 | 16 |
| RV Storage | 56 |

Condo Storage Lots

87 Total Lots

| Size | # of Lots |
|---------------|-----------|
| 20-25 x 50 ft | 58 |
| 35 x 50 ft | 2 |
| 30 x 45 ft | 19 |
| 20 x 34 ft | 10 |

Industrial/Flex Storage Development Lots

5 Total Lots



Information

Additional property information available upon request:

- County conditional use permit
- County preliminary plat approval
- Construction budget
- Private road maintenance agreement
- Irrigation district license agreement
- Architectural renderings and site design
- Landscape design
- Highway district development agreement
- Idaho Department of Water Resources water rights confirmation
- IDEQ well design and site approval letter
- IDEQ well engineering design report
- Engineering well and drain field exhibit
- IDEQ approved well plans and specifications
- Engineering water facility plan
- Irrigation district fencing approval letter
- County Irrigation and drainage plan approval
- County condominium plan approval
- County landscape plan approval.
- Engineering preliminary plat documentation
- Traffic Impact Study
- Preliminary construction budget – dated from January 2023
- Middleton fire preliminary plat approval review letter
- Geotech Report
- Highway district 4 preliminary plat report
- Idaho Power - power line clearance letter
- Engineering civil design
- Private road maintenance draft agreement
- 2021 storage development feasibility study
- Irrigation lateral easement survey



2 TYP TRADITIONAL STORAGE INTERIOR BUILDING
ELEVATION w/o DOORS
1/4" = 1'-0"

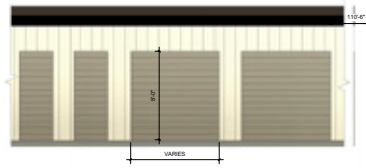

3 TYP TRADITIONAL STORAGE INTERIOR
ELEVATION w/ DOORS
1/4" = 1'-0"

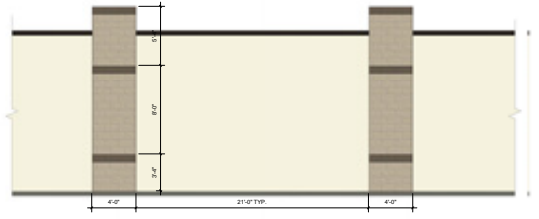

1 TYP TRADITIONAL PERIMETER BUILDING
ELEVATION
1/4" = 1'-0"



4 OFFICE ELEVATION
1/4" = 1'-0"



6 TYP MANCAVE PERIMETER BUILDING
ELEVATION
1/4" = 1'-0"



5 TYP MANCAVE INTERIOR BUILDING ELEVATION
1/4" = 1'-0"

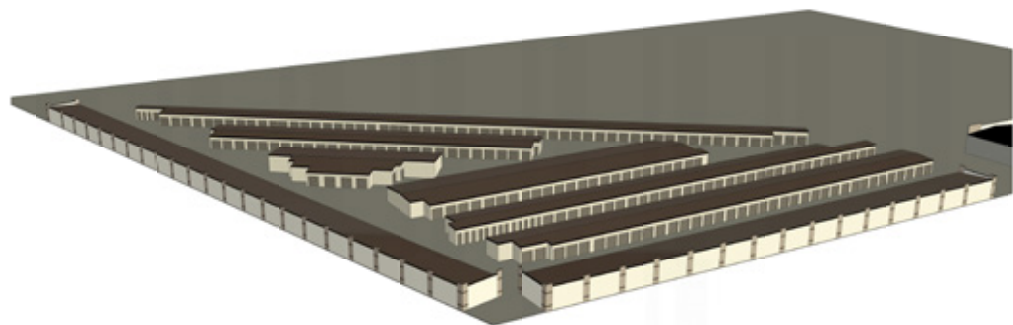
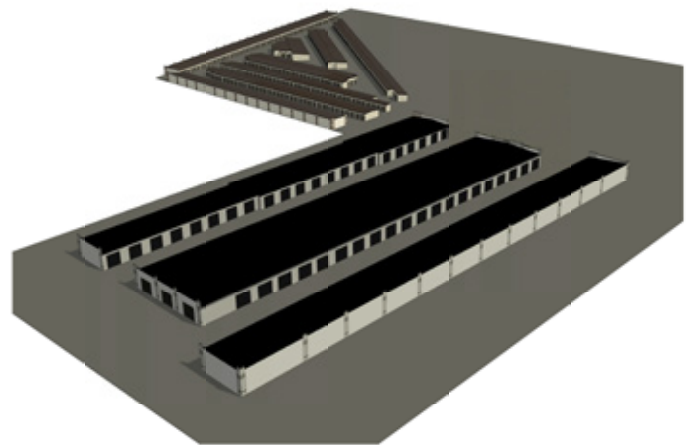

Location



[Google Map](#)



[Street View](#)



5700 E Franklin Road, Suite 205
Nampa, Idaho 83686
208 472 1660

This document has been prepared by Colliers for advertising and general information only. Colliers makes no guarantees, representations or warranties of any kind, expressed or implied, regarding the information including, but not limited to, warranties of content, accuracy and reliability. Any interested party should undertake their own inquiries as to the accuracy of the information. Colliers excludes unequivocally all inferred or implied terms, conditions and warranties arising out of this document and excludes all liability for loss and damages arising there from. This publication is the copyrighted property of Colliers and/or its licensors(s). © 2025. All rights reserved. This communication is not intended to cause or induce breach of an existing listing agreement. Colliers Paragon, LLC.