



**FOR LEASE**

## Sublease 15551 Boyle Ave

15551 Boyle Ave  
Fontana, CA 92337

This modern industrial building for sublease is situated within the SWIP (Southwest Industrial Park Specific Plan) zoning area of Fontana, a prime logistics hub in San Bernardino County. The facility comprises approximately 83,140 square feet on 222,856 square feet of land, including 4,481 square feet of office space across two floors. Designed for efficient distribution and logistics operations, the property offers quick-access loading bays, a 415-foot secured truck court, and 82 trailer parking stalls.



Year Built	2024
Building SqFt	83,140 SqFt
Available	41,570 or 83,140 SqFt
Lot Size (SF)	222,856 SqFt
Dock High Doors	12
Ground Level Doors	1
Power	2,000 Amps
Trailer Parking	80+
Truck Court	415'

- Modern, low-coverage industrial building
- Expansive secured truck court and yard area
- Excellent freeway access to I-10, I-15, I-60, and I-210
- 4 miles from Fontana Commuter Rail Station
- 8.7 miles from Ontario International Airport
- Racking system included



### Universal Elite

18645 Gale Ave Ste 233  
City of Industry, CA 91748

Office: (408) 398-5466

### MICHAEL SHI

Managing Partner

Mobile: (909) 319-4661

michael@tmgroupcre.com

License #: 02121545

### TRACY LEE

Senior Vice President

Direct: (626) 620-5100

tracytmgroup@gmail.com

License #: 02042338

FOR LEASE

Sublease 15551 Boyle Ave  
15551 Boyle Ave  
Fontana, CA 92337

## 80+ Trailer Parking Spaces!

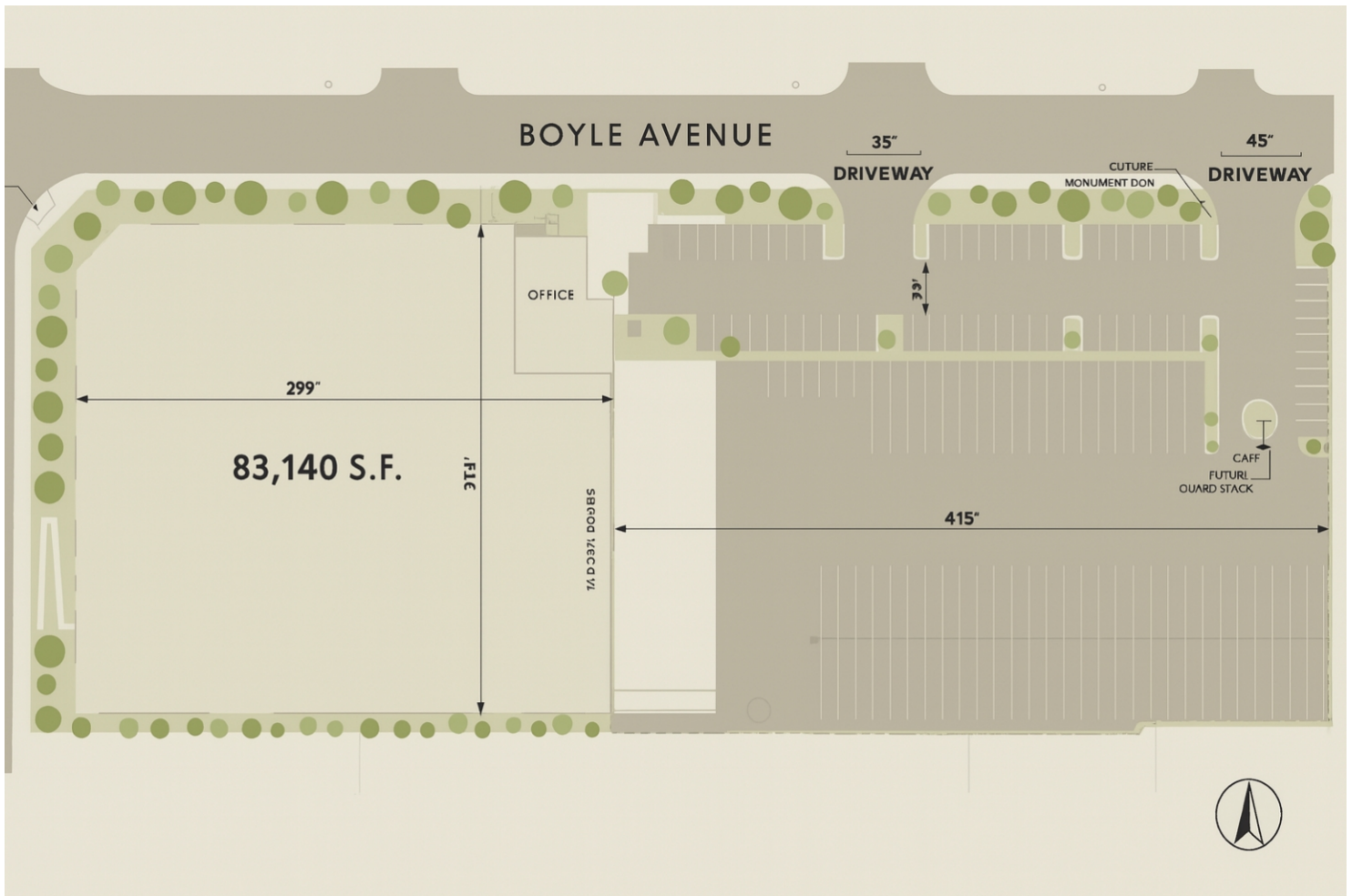

### Universal Elite

18645 Gale Ave Ste 233  
City of Industry, CA 91748

Office: (408) 398-5466

### MICHAEL SHI

Managing Partner

Mobile: (909) 319-4661

michael@tmgroupcre.com

License #: 02121545

### TRACY LEE

Senior Vice President

Direct: (626) 620-5100

tracytmgroup@gmail.com

License #: 02042338