



# WAREHOUSE FOR LEASE

400 W 48th Ave #105 & #125

400 W 48th Ave | Denver, CO 80216



**Dock High And Drive In Loading Available**

## CONTACT:

### BRAD GILPIN

SENIOR VICE PRESIDENT

303.512.1196

[bgilpin@uniqueprop.com](mailto:bgilpin@uniqueprop.com)

UNIQUE PROPERTIES

400 S. BROADWAY

DENVER, CO 80209

(p) 303.321.5888

(f) 303.321.5889

[WWW.UNIQUEPROP.COM](http://WWW.UNIQUEPROP.COM)





## 400 W 48TH AVE

### OFFERING SUMMARY

<b>Suite #125:</b>	10,230 SF
<b>Suite #105:</b>	10,582 SF
<b>Lease Rate:</b>	\$15.88/SF FSG
<b>Building Size:</b>	98,454 SF
<b>Grade Level Doors:</b>	Yes
<b>Dock High Doors:</b>	Yes
<b>Year Built:</b>	1986
<b>Renovated:</b>	2022
<b>Sprinklers:</b>	YES
<b>Zoning:</b>	I-B

### PROPERTY HIGHLIGHTS

- Fully sprinklered warehouse space with dock-high loading and drive in loading available
- Great for flex, warehouse, assembly, religious meetings, event space and more!
- Mostly open floor plans available with 7'11" to 10' clear ceiling height
- Lease rate includes utilities
- Full modern workout facility on site with locker rooms and shower facilities
- Located at the NW corner of I-25 and I-70

## FIRST FLOOR

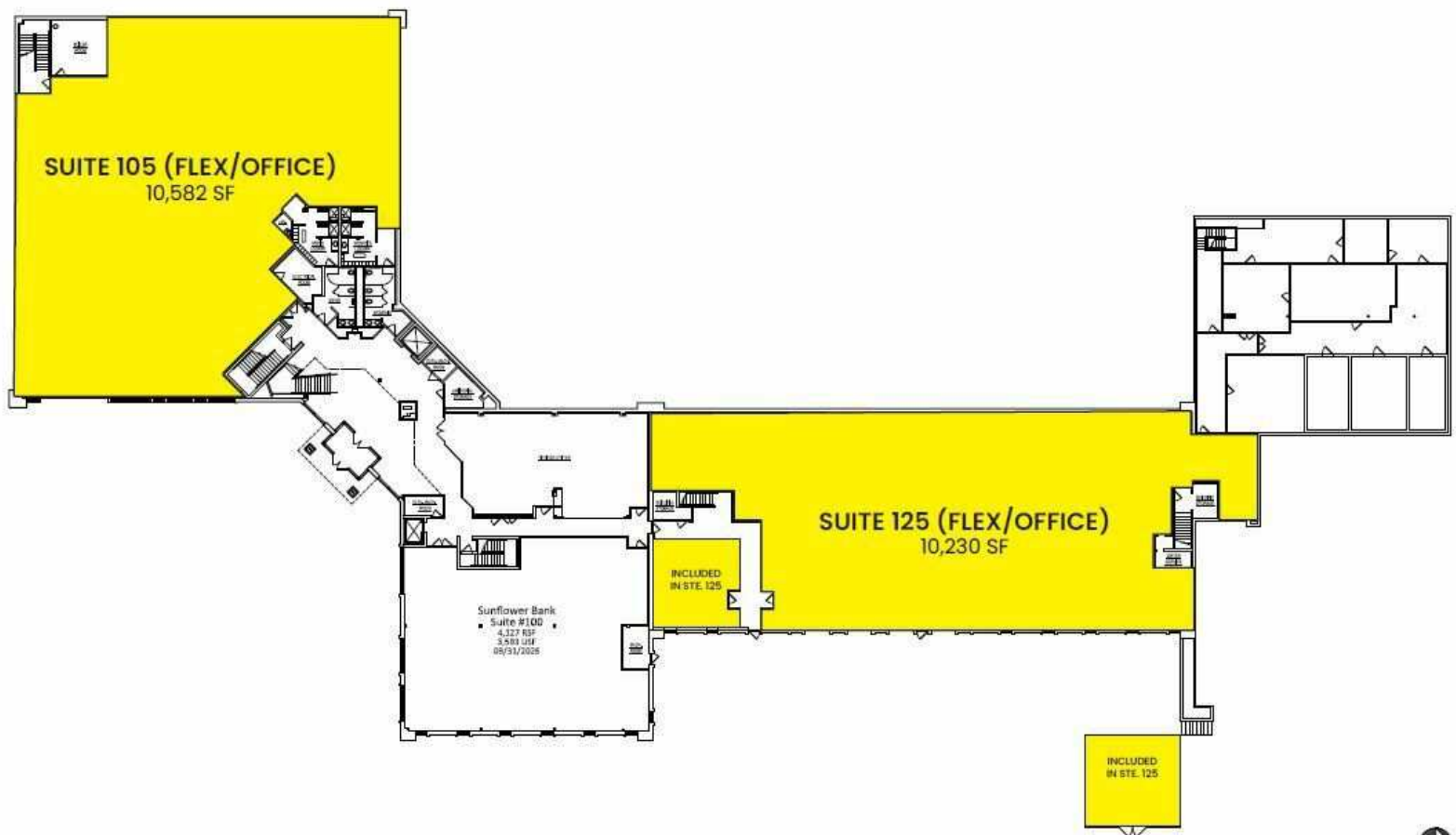



# GREAT FOR FLEX, EVENT SPACE, CHURCHES, WAREHOUSE AND MORE!

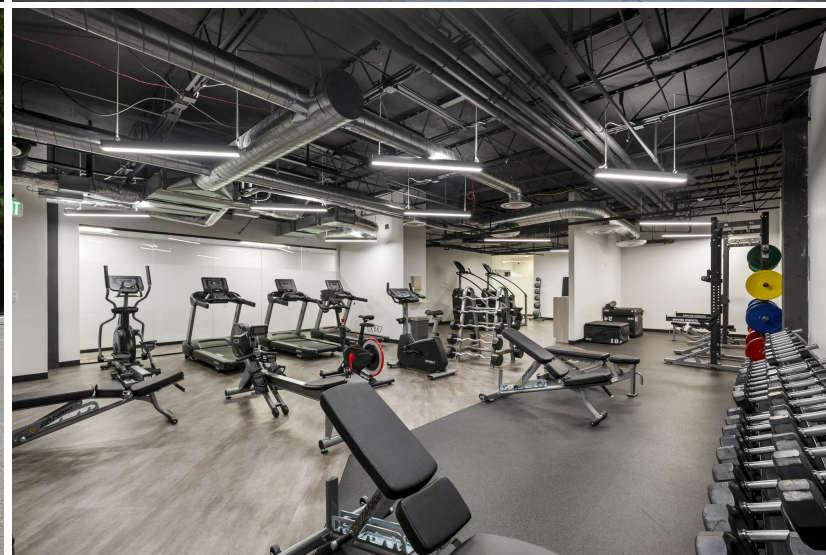



# GREAT FOR FLEX, EVENT SPACE, CHURCHES, WAREHOUSE AND MORE!

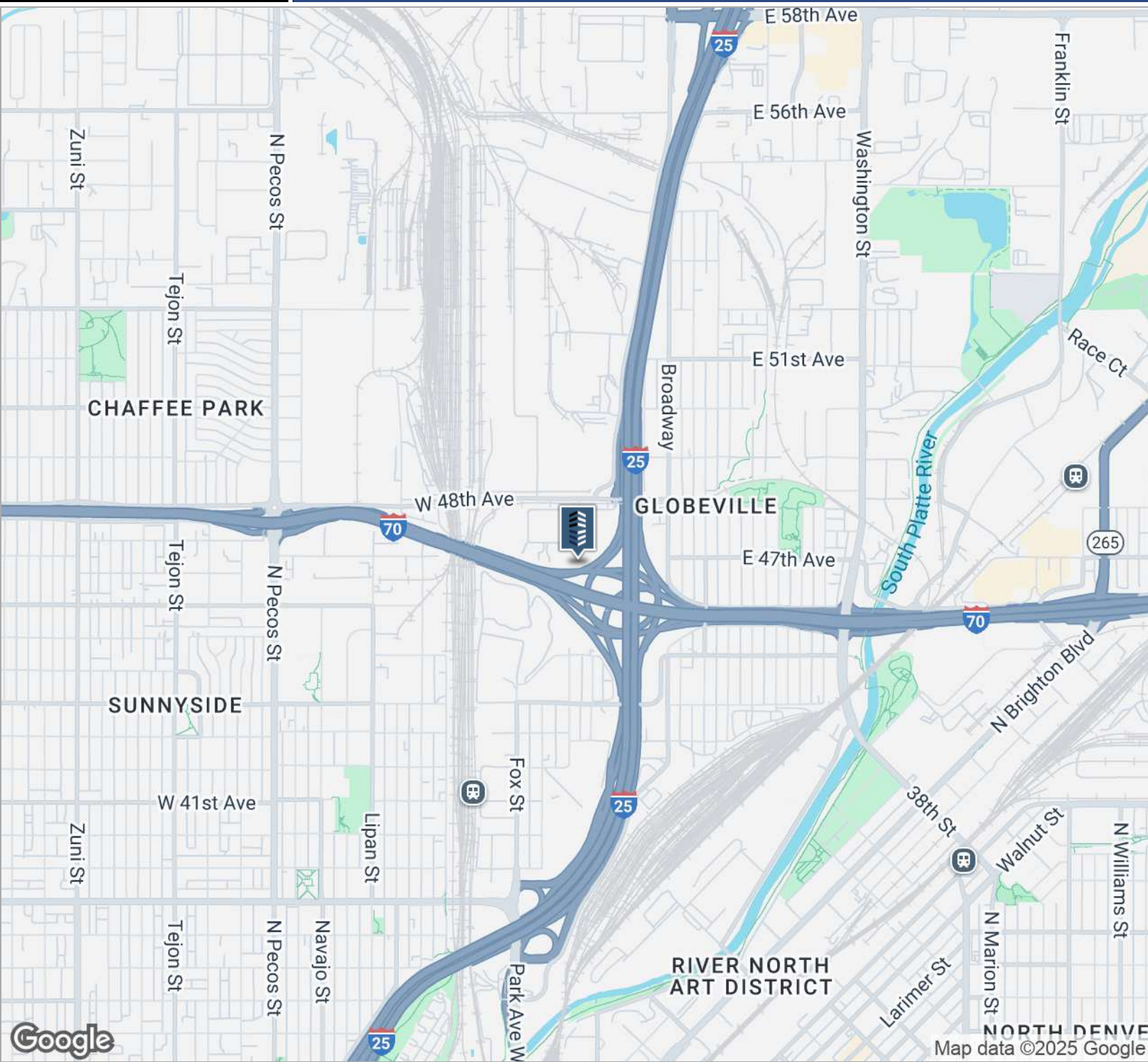

## CONTACT:

**BRAD GILPIN**

SENIOR VICE PRESIDENT

303.512.1196

[bgilpin@uniqueprop.com](mailto:bgilpin@uniqueprop.com)

The information contained herein was obtained from sources believed reliable; however, Unique Properties makes no guarantees, warranties or representations as to the completeness or accuracy thereof. The presentation on this property is submitted subject to errors, omission, changes of price, or conditions, prior to sale or lease, or withdrawal without notice.