

STONEY CREEK COMMONS

10075 Town and Country Drive | Noblesville, IN 46060



Stoney Creek Commons

MSA: Noblesville, IN | GLA: 84,226

Fitness-anchored community shopping center situated along US-37 in Noblesville, IN. The center has excellent visibility from roadway and is adjacent to high volume home improvement retailer, Lowe's. Stoney Creek is supported by customers with strong household demographics in this fast-growing suburban market.

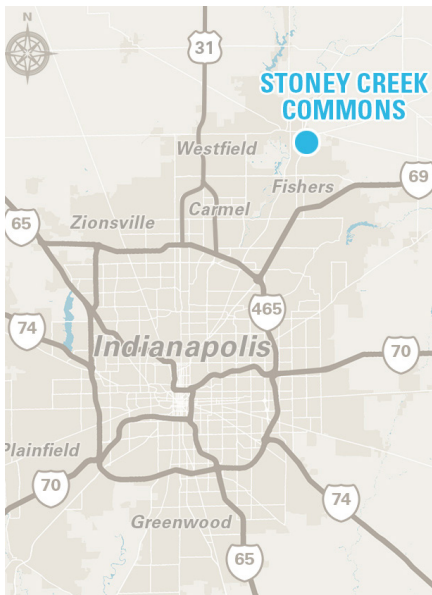

3 MILE DEMOGRAPHICS



POPULATION
49,615



% POP. GROWTH
(ANNUAL)
1.31%



AVG. HH INCOME
\$103,859



MED. HH INCOME
\$86,042



HOUSEHOLDS
18,503



BACH. DEGREE+
47.86%

**2023 Demographic Source (PopStats)*

LEASING CONTACT - Blake Beaver - bbeaver@kiterealty.com - 317.713.5640



317-577-5600 kiterealty.com



STONEY CREEK COMMONS

10075 Town and Country Drive | Noblesville, IN 46060

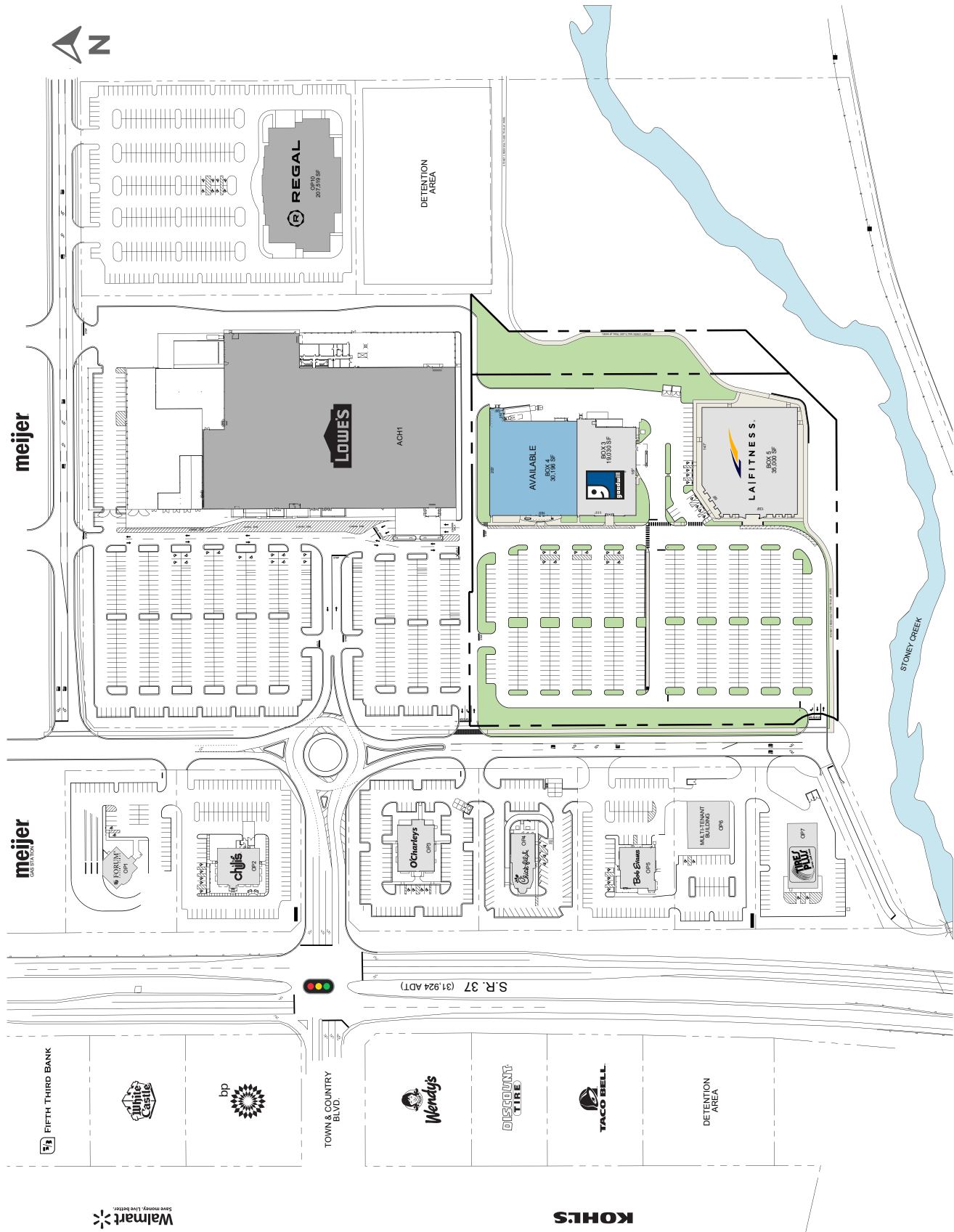

317-577-5600 kiterealty.com

KRG
LISTED
NYSE