



Location Finders Brokerage, LLC
9440 Enterprise Dr, Mokena, IL 60448
(708) 390-1629

Liberty Rd & Crystal Point Rd

Crystal Lake, IL

Commercial Space Available

1,025 - 5,424 SF

MARKET SUMMARY

- Positioned within dense retail corridor anchored by Walmart, Sam's Club, and ALDI, etc. drive high daily traffic
- Over 45,000 residents within a 5-mile radius with strong household incomes of \$123,000
- Close proximity to Crystal Lake Central High School (1,500+ students) and large apartment communities

DEMOGRAPHICS

POPULATION	1 Mile	4,861
	3 Mile	56,379
	5 Mile	129,372
# HOUSEHOLDS	1 Mile	1,816
	3 Mile	20,850
	5 Mile	46,544
AVG HH INCOME	1 Mile	\$82,030
	3 Mile	\$110,182
	5 Mile	\$123,891

CONTACT

ALAN ERICKSON
aerickson@lfirealestate.com
(708) 390-1629





Location Finders Brokerage, LLC
9440 Enterprise Dr, Mokena, IL 60448
(708) 390-1629

Liberty Rd & Crystal Point Rd

Crystal Lake, IL

Commercial Space Available

1,025 - 5,424 SF

SITE SUMMARY

- **Building GLA:** 6,634 SF
- **Available:** Up to 5,424 SF Contiguous
 - **Suite A** - 1,078 SF
 - **Suite B** - 1,148 SF
 - **Suite C** - 1,025 SF
 - **Suite D** - 1,025 SF
 - **Suite E** - 1,148 SF
- **Access:** Full access from both Liberty Rd and Crystal Point Rd
- **Parking:** 43 Total Spaces
- **Signage:** Monument signage available
- **Co-Tenancy:** Jimmy John's

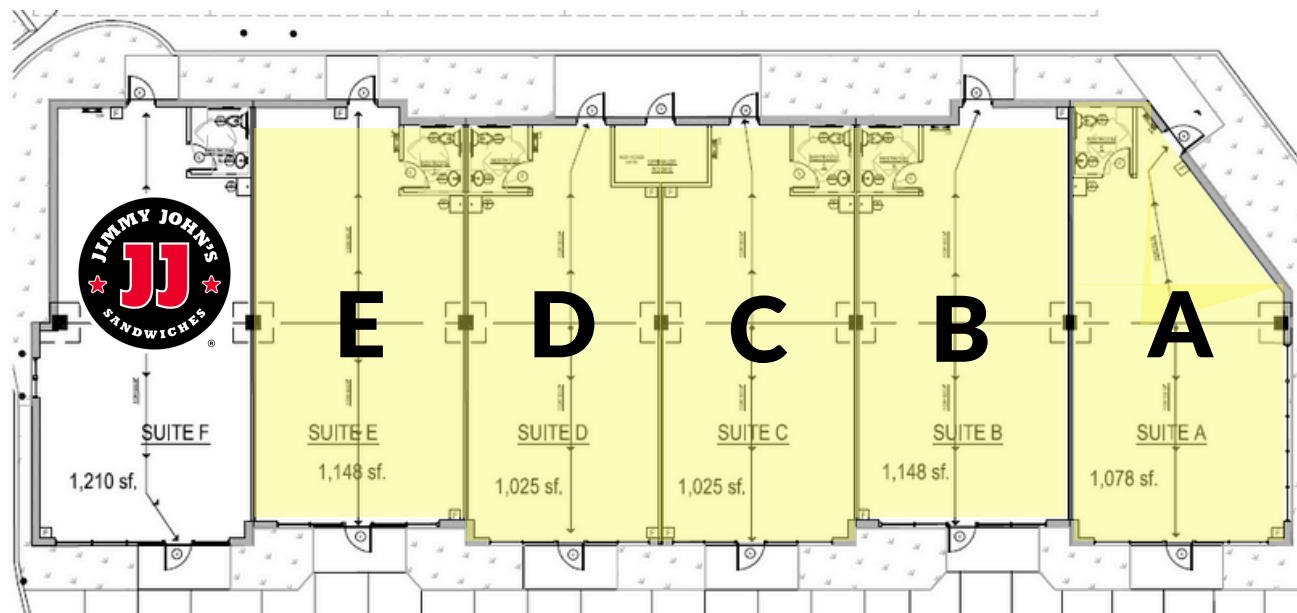
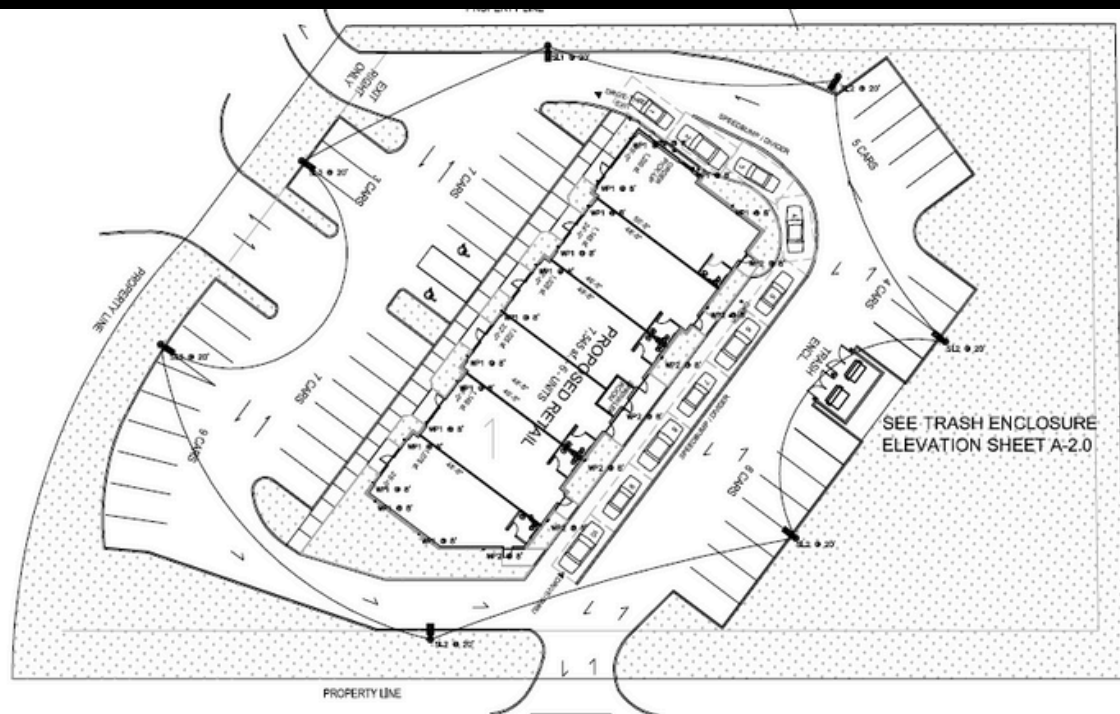

CONTACT

ALAN ERICKSON
aerickson@lfirealestate.com
(708) 390-1629

This information contained is obtained from sources we deem reliable. We have no reason to doubt its accuracy but do not guarantee it.