

ONE REMAINING GROUND FLOOR RETAIL SPACE
Available Immediately



AMLI Arts Center

**1240 W. PEACHTREE STREET
ATLANTA, GA 30309**

HIGHLIGHTS

- 350 Luxury Apartments
- Across from Woodruff Arts Center & High Museum
- Adjacent to Arts Center MARTA Rail Station
- Easy access to I-78, I-85, GA 400
- Ample free deck parking
- Near Piedmont Park
- Traffic Counts: 20,000



**OAKHURST
REALTY
PARTNERS**

For More Information:

Todd Semrau | (404) 371-4100 | tsemrau@oakrep.com
Oakhurst Realty Partners | www.oakrep.com

Information contained herein has been obtained from sources deemed reliable but we cannot guarantee its accuracy. No liability is assumed for errors or omissions.

AMLI ARTS CENTER

1240 W. PEACHTREE STREET ATLANTA, GA 30309

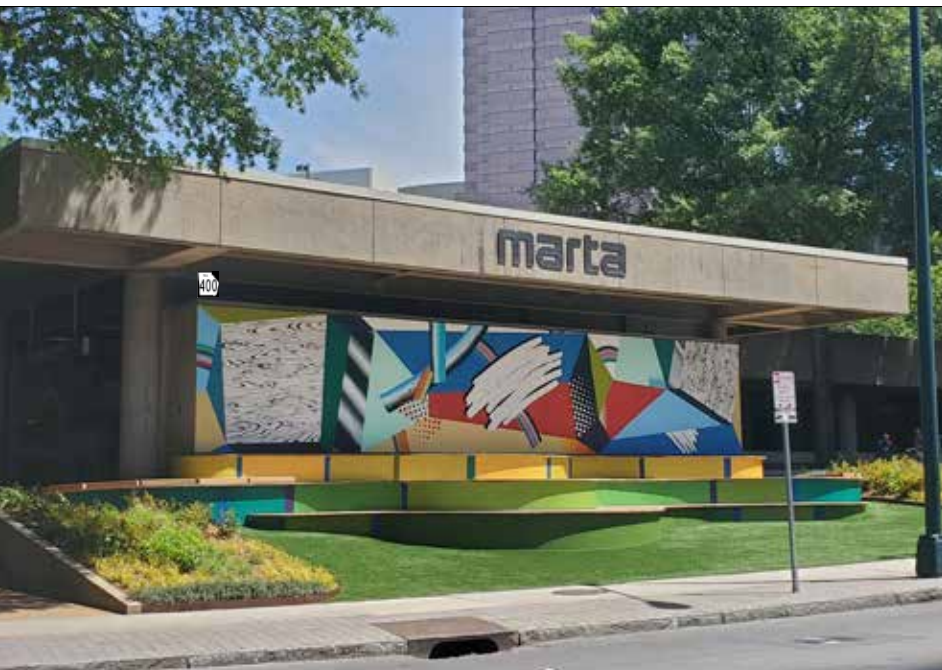

Midtown is one of the most sought after office & retail locations in metro Atlanta

AREA DEMOGRAPHICS

Within 1 Mile



76%

Bachelor's/Grad/Prof. Degree

\$106.3k

Average Household Income



28.3k

Population with a **69k** daytime population



**OAKHURST
REALTY
PARTNERS**

For More Information:

Todd Semrau | (404) 371-4100 | tsemrau@oakrep.com
Oakhurst Realty Partners | www.oakrep.com

Information contained herein has been obtained from sources deemed reliable but we cannot guarantee its accuracy. No liability is assumed for errors or omissions.

AMLI ARTS CENTER

1240 W. PEACHTREE STREET ATLANTA, GA 30309

SITE PLAN

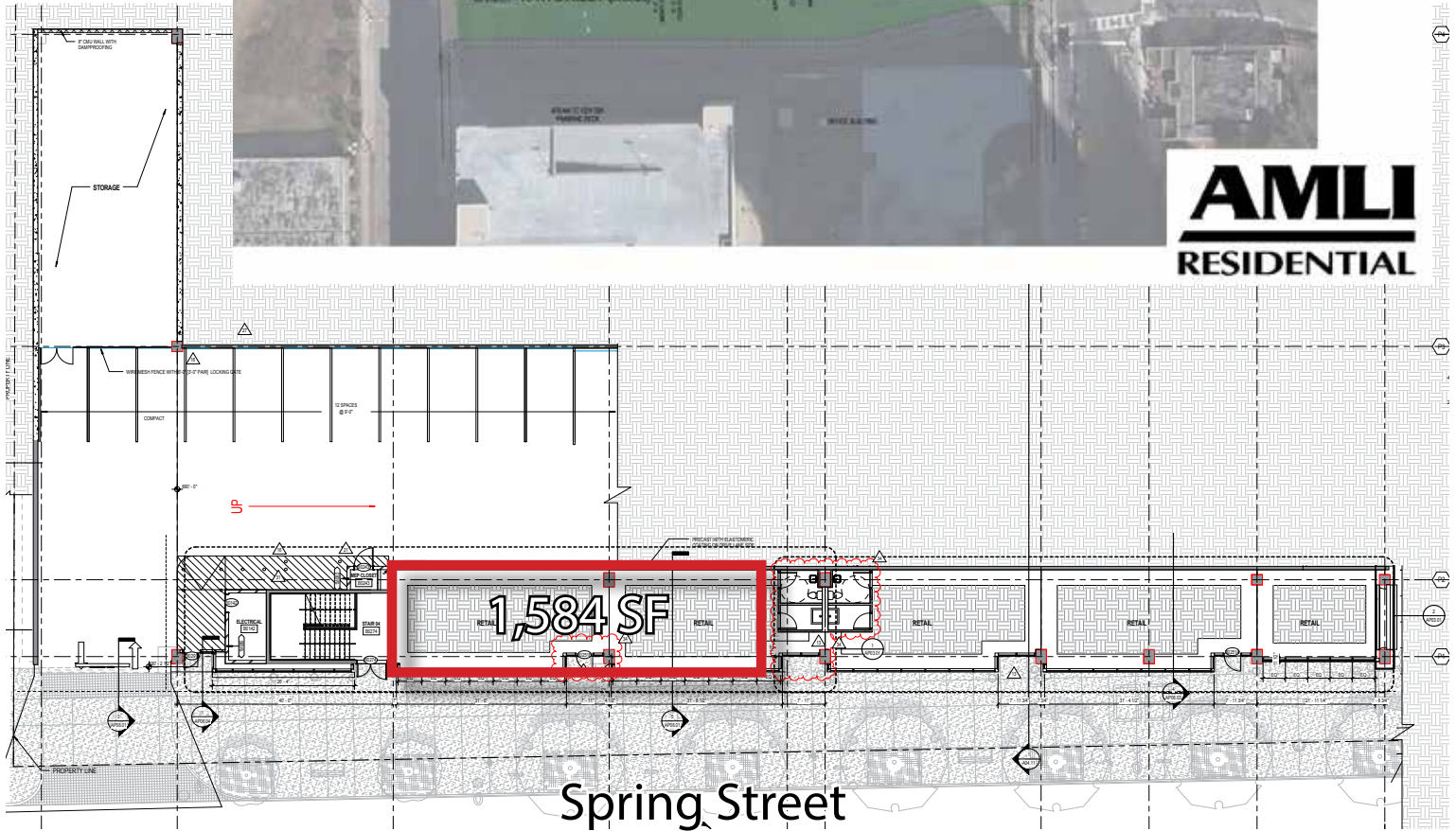
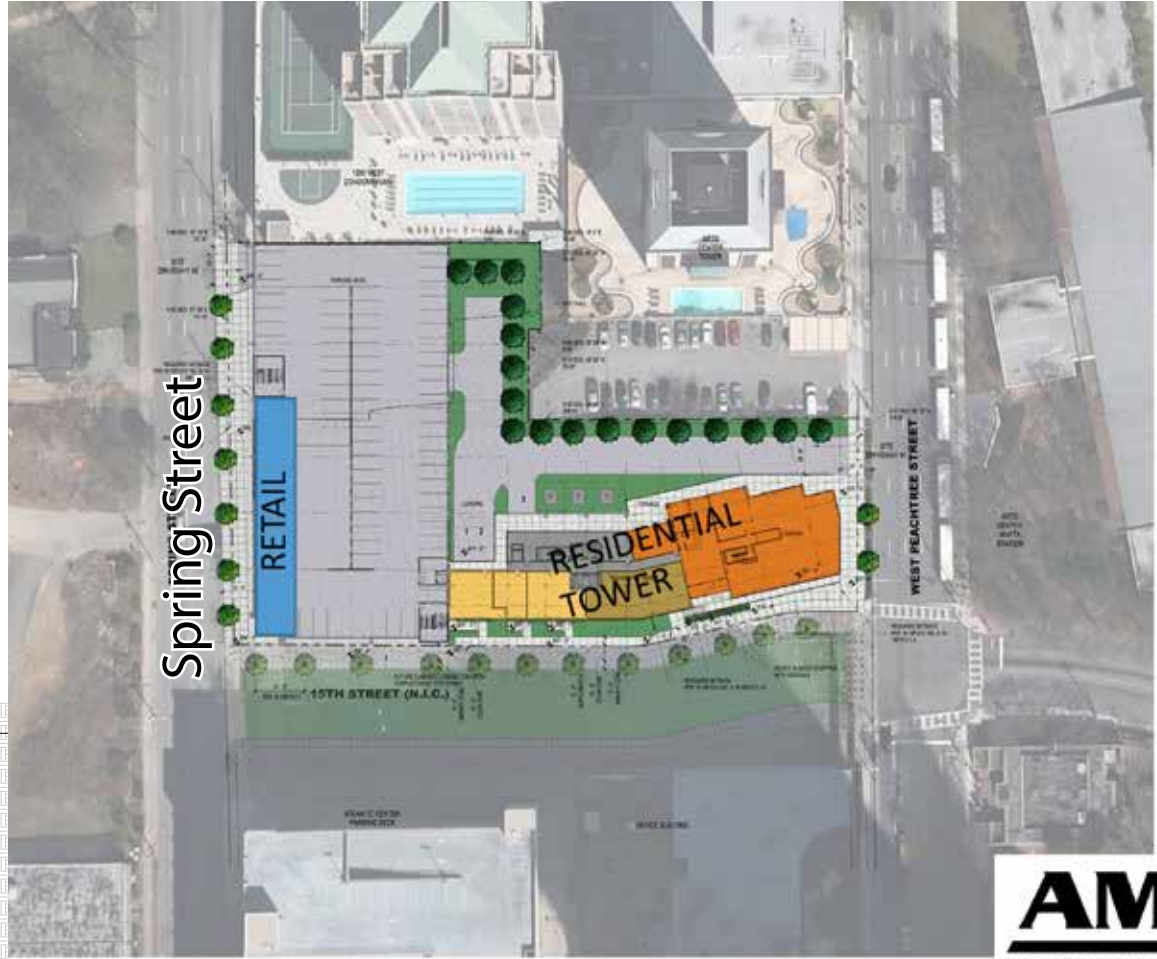

For More Information:

Todd Semrau | (404) 371-4100 | tsemrau@oakrep.com
Oakhurst Realty Partners | www.oakrep.com

Information contained herein has been obtained from sources deemed reliable but we cannot guarantee its accuracy. No liability is assumed for errors or omissions.

AMLI ARTS CENTER

1240 W. PEACHTREE STREET ATLANTA, GA 30309



IN 1.2 SQUARE MILE AREA

- 15,000 residents
- 65,000 daytime workers
- 6M annual visitors
- 20M SF office space
- Lots of dining
- Great parks
- Walkable
- Clean & attractive
- One of Southeast's most sustainable urban districts

MIDTOWN



**OAKHURST
REALTY
PARTNERS**

For More Information:

Todd Semrau | (404) 371-4100 | tsemrau@oakrep.com
Oakhurst Realty Partners | www.oakrep.com

Information contained herein has been obtained from sources deemed reliable but we cannot guarantee its accuracy. No liability is assumed for errors or omissions.