

For Lease

±9,585 SF Available

2020 W. Guadalupe Rd
Gilbert, AZ

±9,585 SF Available

- ±13,547 SF Building
- 70% Office
- 30% Evaporative Cooled Warehouse
- Grade Level Loading
- 16' Clear Height In Warehouse
- Frontage on Guadalupe Road
- Zoning LI, Town of Gilbert

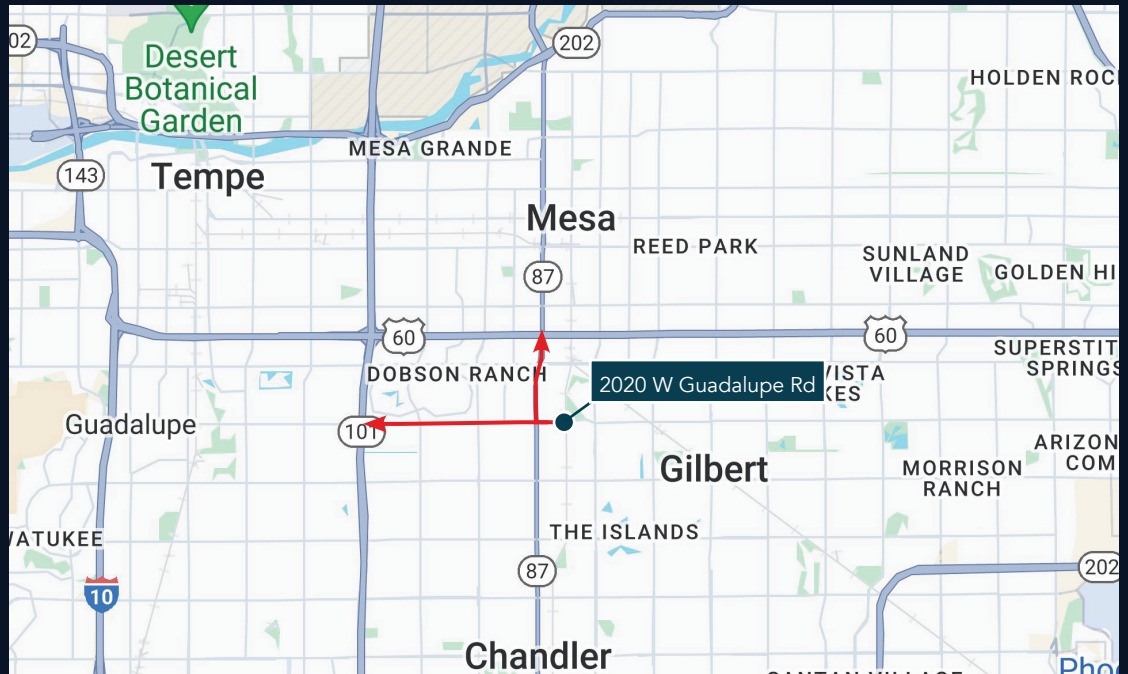

Floor Plan

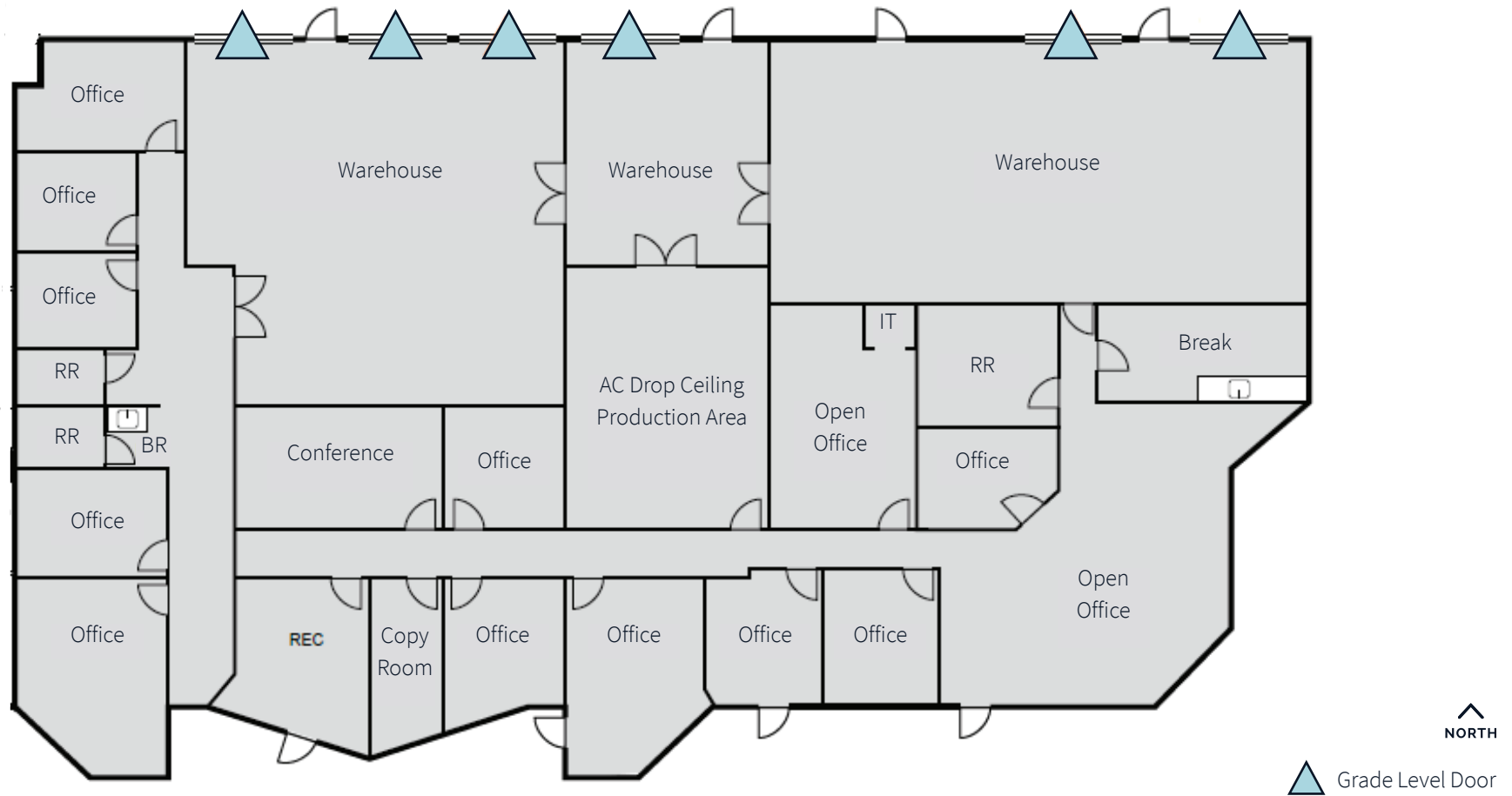

For more information, contact:

Steve Larsen, SIOR, CCIM
Executive Managing Director
Steve.Larsen@jll.com
+1 602 282 6296

Jason Moore, CCIM
Executive Vice President
Jason.Moore@jll.com
+1 602 391 8989



Although information has been obtained from sources deemed reliable, neither Owner nor JLL makes any guarantees, warranties or representations, express or implied, as to the completeness or accuracy as to the information contained herein. Any projections, opinions, assumptions or estimates used are for example only. There may be differences between projected and actual results, and those differences may be material. The Property may be withdrawn without notice. Neither Owner nor JLL accepts any liability for any loss or damage suffered by any party resulting from reliance on this information. If the recipient of this information has signed a confidentiality agreement regarding this matter, this information is subject to the terms of that agreement. ©2024 Jones Lang LaSalle IP, Inc. All rights reserved.