



## Parcel Information

### Parcel Information

Tax Map #:	157A-A-7
RPC:	15724300
Property Address:	1121 ODDFELLOWS ROAD
Owner:	BOARD OF TRUSTEES OF THE VIRGINIA AN
Owner Address:	10330 STAPLES MILL RD STE 100 GLEN ALLEN, VA 23060
Legal Acres:	0.00
PC Description:	76 Religious
Legal Description:	BLUE RIDGE
Document:	250009830
Deed Book/Page:	

## Ownership History

### Ownership History

Current Owner	BOARD OF TRUSTEES OF THE VIRGINIA AN
Purchase Date	11/12/2025
Purchase Price	\$0
Purchase Date	01/01/1993
Name	MAYS MEMORIAL CHURCH
Purchase Price	\$0
Purchase Date	01/01/1993
Name	MAYS MEMORIAL CHURCH
Purchase Price	\$0

# Valuation

## Valuation

Effective Date	01/01/2023
Value Reason	2023 Reass
Land Value	\$60,000
Improvement Value	\$419,500
Total Value	\$479,500
Effective Date	01/01/2019
Value Reason	2019 Reass
Land Value	\$40,000
Improvement Value	\$214,000
Total Value	\$254,000
Effective Date	12/02/2014
Value Reason	2015 Reass
Land Value	\$40,000
Improvement Value	\$146,000
Total Value	\$186,000
Effective Date	11/07/2010
Value Reason	2011 Reass
Land Value	\$30,000
Improvement Value	\$131,100
Total Value	\$161,100
Effective Date	10/29/2006
Value Reason	2007 Reass
Land Value	\$30,000
Improvement Value	\$132,500
Total Value	\$162,500

## Structure Details

### Exterior

Structure Use	Church
Building Type	Church:001
Frame Material	Wood Frame
Exterior Cover	
Exterior Cover 2	
Year Built	1950
Stories	1
Foundation	
Roof	4
Roof Material	
Garage Sq. Ft.	
Detached Garage Sq. Ft.	
Deck Sq. Ft.	

### Interior

Rooms Total	0
Bedrooms	
Full Bathroom	0
Half Bathroom	2
Attic	None
Heating	3716 sf
Cooling	Y
Masonry Fireplace	
Condition	normal for age
Finish Size Sq. Ft.	1858
Basement Sq. Ft.	1858

Sketch #1

01 W/ ENCLOSED STRG

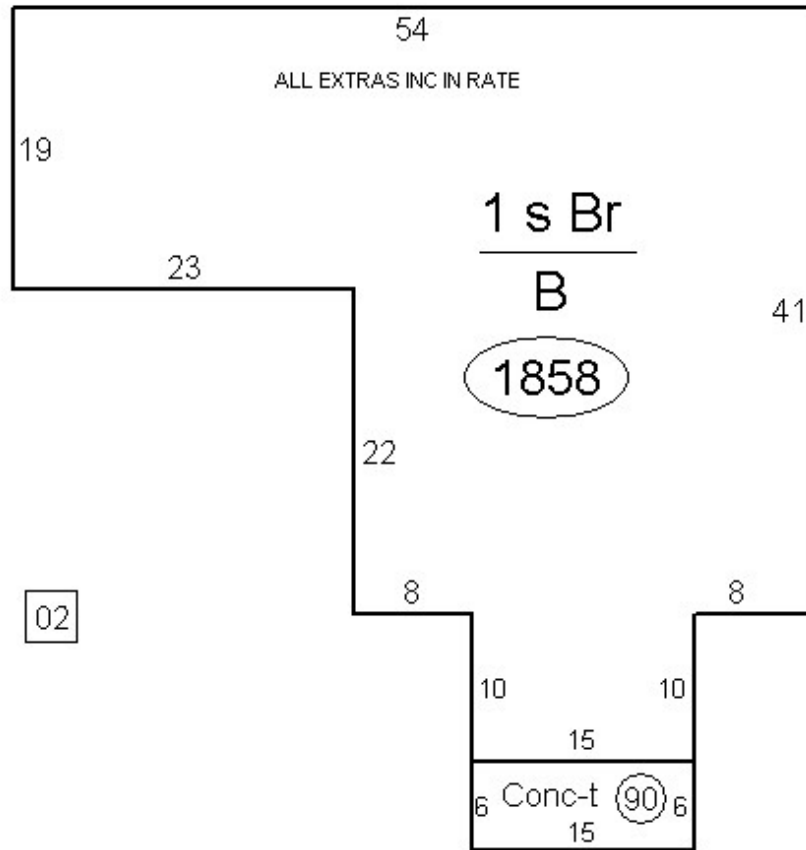

02

03 BR

# Map

