

24435 HALSTED ROAD

24435 Halsted Road, Farmington Hills, MI 48335



FOR SALE

248.476.3700

EXCLUSIVELY LISTED BY:

ERIC SZERLAG

Vice President

eszerlag@thomasduke.com

MARK SZERLAG

Senior Partner

mszerlag@thomasduke.com

OFFERING SUMMARY: 24435 Halsted Road | Farmington Hills, MI 48335

**PROPERTY OVERVIEW**

A 15,170 SF (Gross) Freestanding Industrial/Flex Building.

OFFERING SUMMARY

Sale Price:	\$1,150,000
Building Size:	15,170 SF
Price / SF:	\$75.81
Year Built:	1979
Renovated:	2004
Zoning:	LI-1 Light Industrial

PROPERTY HIGHLIGHTS

- Easy access to I-96, I-275 and M-5
- Free standing building
- High visibility on Halsted Road with great signage

BUILDING/PROPERTY INFORMATION: 24435 Halsted Road | Farmington Hills, MI 48335
BUILDING INFORMATION

Price/SF:	\$75.81
Price/AC:	\$0
Building Size:	15,170 SF
Year Built:	1979
Drive Ins:	1
Power:	1200a/240v 3 phase
Last Renovated:	2004
Number of Floors:	2
Utilities:	Municipal Water & Sanitary S
Parking Spaces:	40

PROPERTY INFORMATION

Lot Size:	0.74 AC
Property Type:	Industrial
Property Subtype:	Flex Space
2025 Summer Tax:	\$9,651.35
2024 Winter Tax:	\$2,911.16
Zoning	LI-1 Light Industrial
Traffic Count:	Halsted = 17,129; Grand Rive 42,376; M-5 = 50,987
Legal Description:	Available upon request
APN:	23-19-426-013

LOCATION INFORMATION

Located on the west side of Halsted, just north of Grand River with easy access to I-96, I-696, M-5 and I-275.

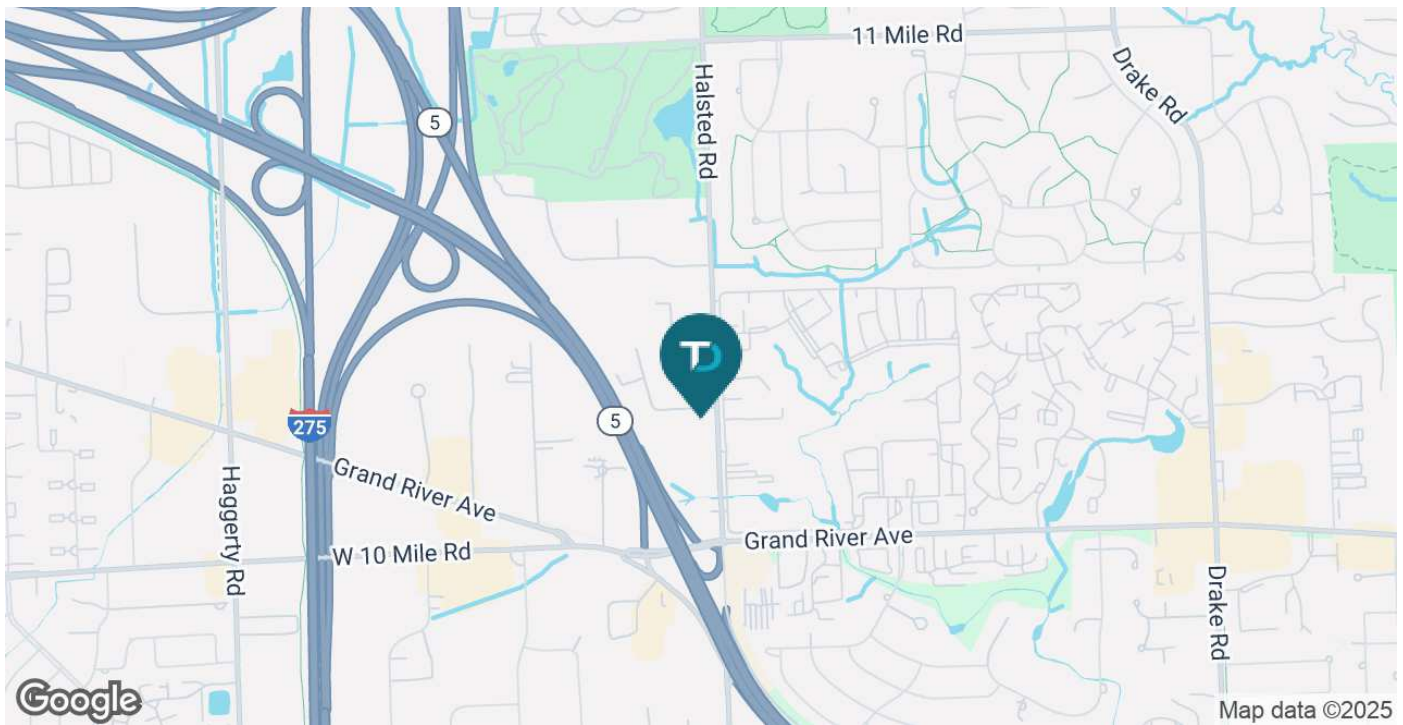

ADDITIONAL PHOTOS: 24435 Halsted Road | Farmington Hills, MI 48335



ADDITIONAL PHOTOS: 24435 Halsted Road | Farmington Hills, MI 48335



ADDITIONAL PHOTOS: 24435 Halsted Road | Farmington Hills, MI 48335

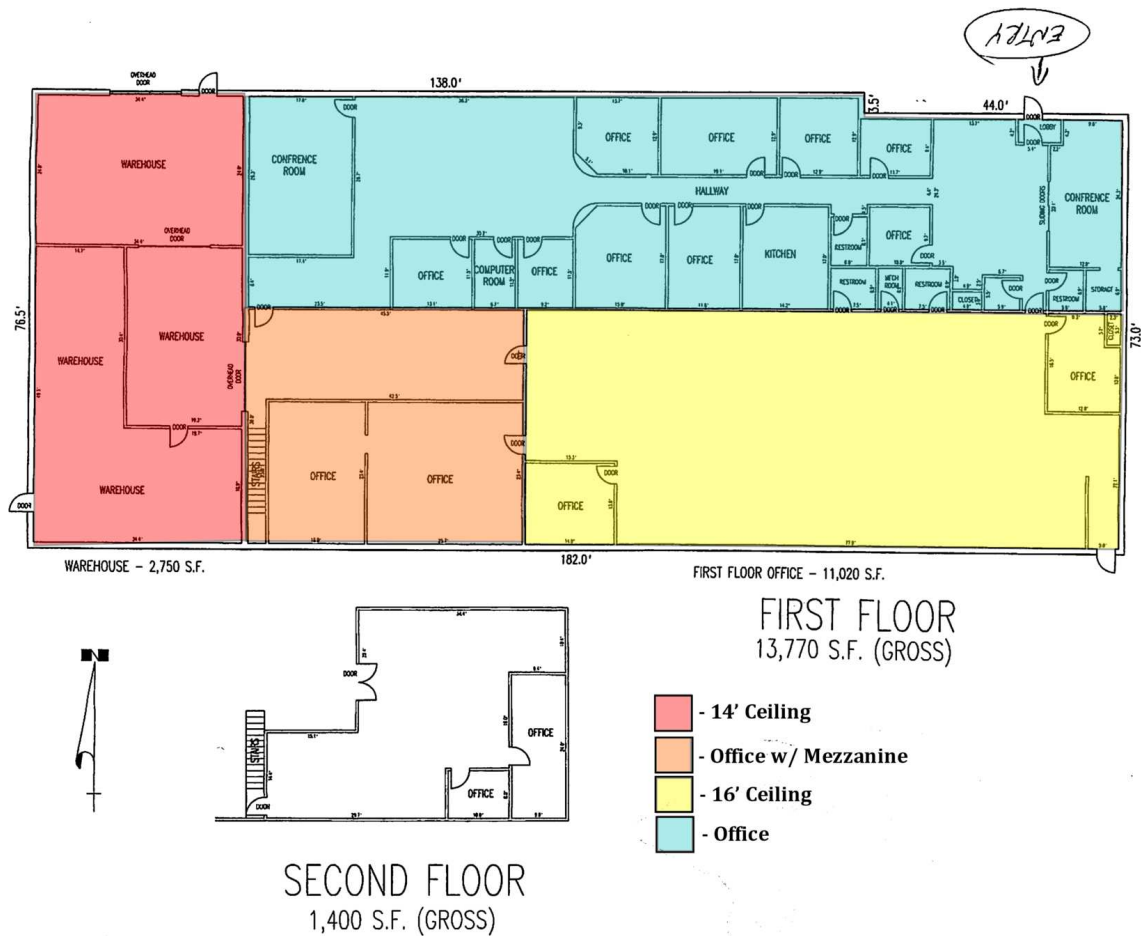

RETAILER MAP: 24435 Halsted Road | Farmington Hills, MI 48335

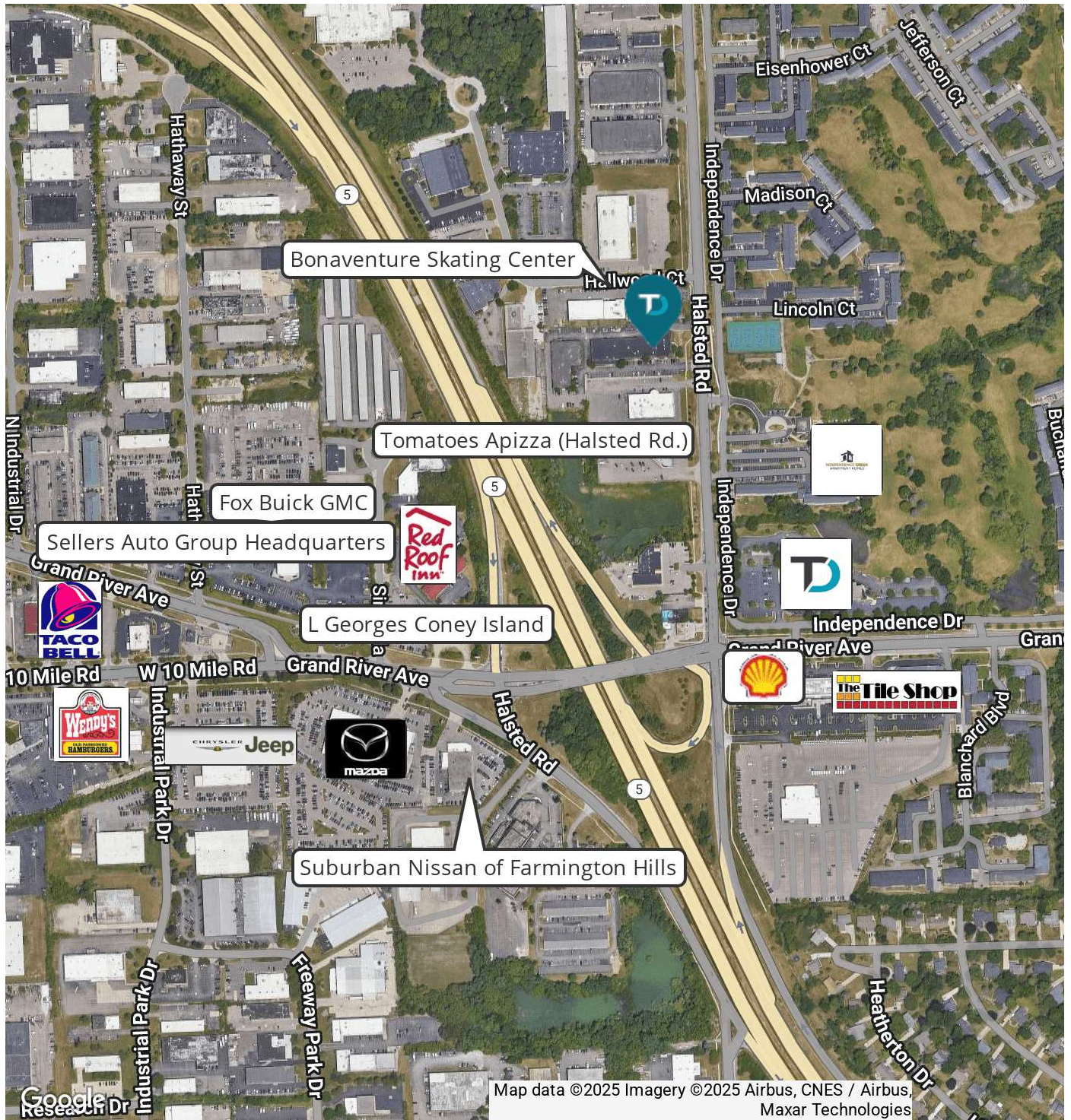

DEMOGRAPHICS MAP & REPORT:

24435 Halsted Road | Farmington Hills, MI 48335

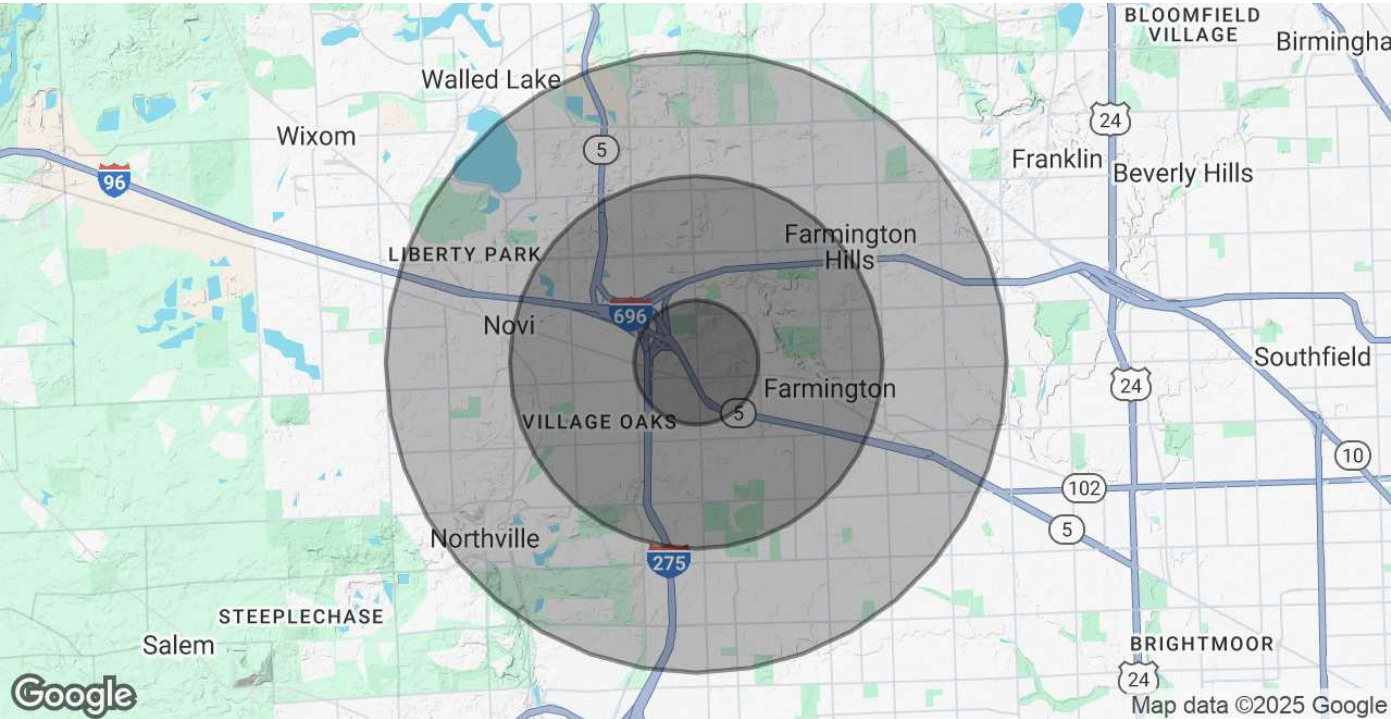

POPULATION	1 MILE	3 MILES	5 MILES
Total Population	12,229	68,505	193,480
Average Age	37	42	44
Average Age (Male)	36	41	42
Average Age (Female)	38	44	45
HOUSEHOLDS & INCOME	1 MILE	3 MILES	5 MILES
Total Households	5,767	29,572	82,014
# of Persons per HH	2.1	2.3	2.4
Average HH Income	\$119,920	\$132,265	\$136,364
Average House Value	\$266,155	\$348,033	\$371,785
Demographics data derived from AlphaMap			