

Freestanding
Industrial Building
for
LEASE

3,782 sf

\$15.95/sf nnn

- + primary: industrial
- + building: 3,782 sf
- + land: 0.23 ac
- + zoning: c-3
- + parcel id: 20-22-30-6812-00-420
- + parking: ample



1012 maltby Ave
orlando, fl 32803

patrick goetz
vice president
(407) 734.7210
pat@BBDRE.com



Bishop Beale Duncan
COMMERCIAL REAL ESTATE



highlights

located near
colonial drive in
orlando

- fenced property with front security gate
- 10' - 12' clear height
- 3-10' x 10' grade level doors
- 1 restroom
- large front office with reception desk
- metal construction
- building sign opportunity



250 N. Orange Ave., Ste. 1500
Orlando, FL 32801
+ (407) 426.7702
www.BBDRE.com

This offer is subject to errors, omissions, prior sale or withdrawal without notice.



for more information, contact patrick goetz vice president (407) 734.7210 pat@BBDRE.com

property location

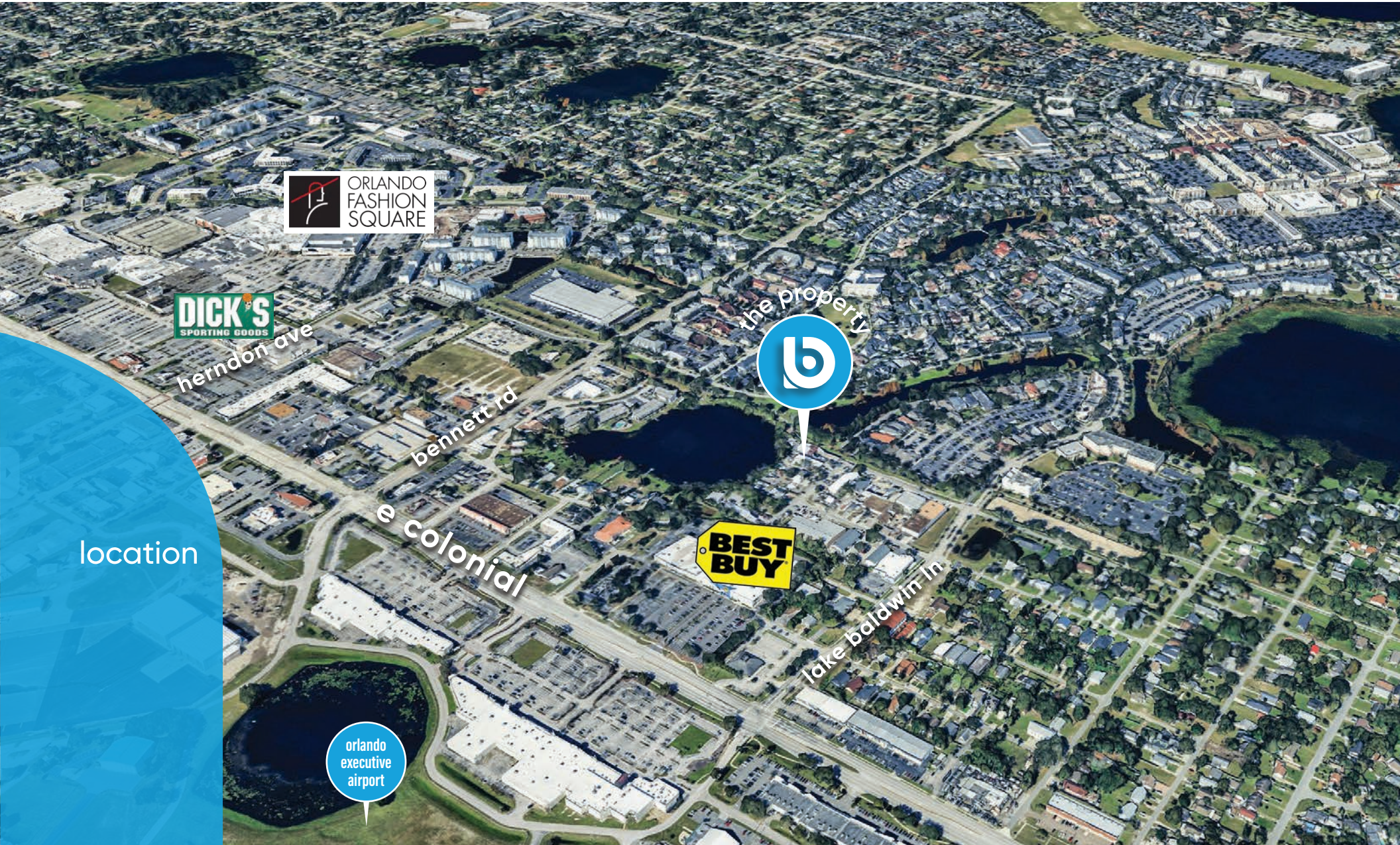

location



property aerial



aerial

for more information, contact patrick goetz vice president (407) 734.7210 pat@BBDRE.com

interior photos



office



warehouse



warehouse



warehouse

interiors



1012 maltby | 3,782 sf

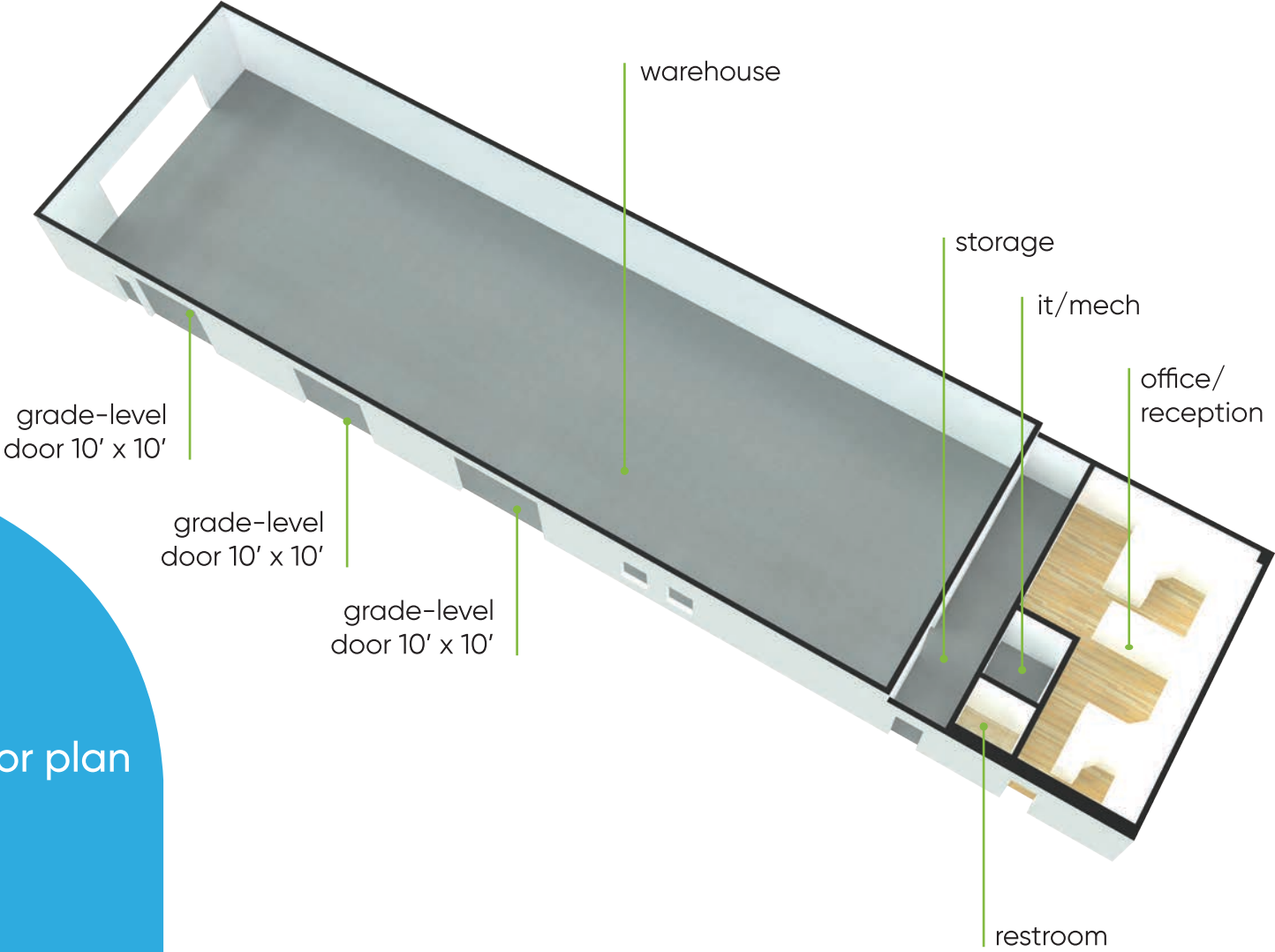

floor plan



1012 maltby | 3,782 sf

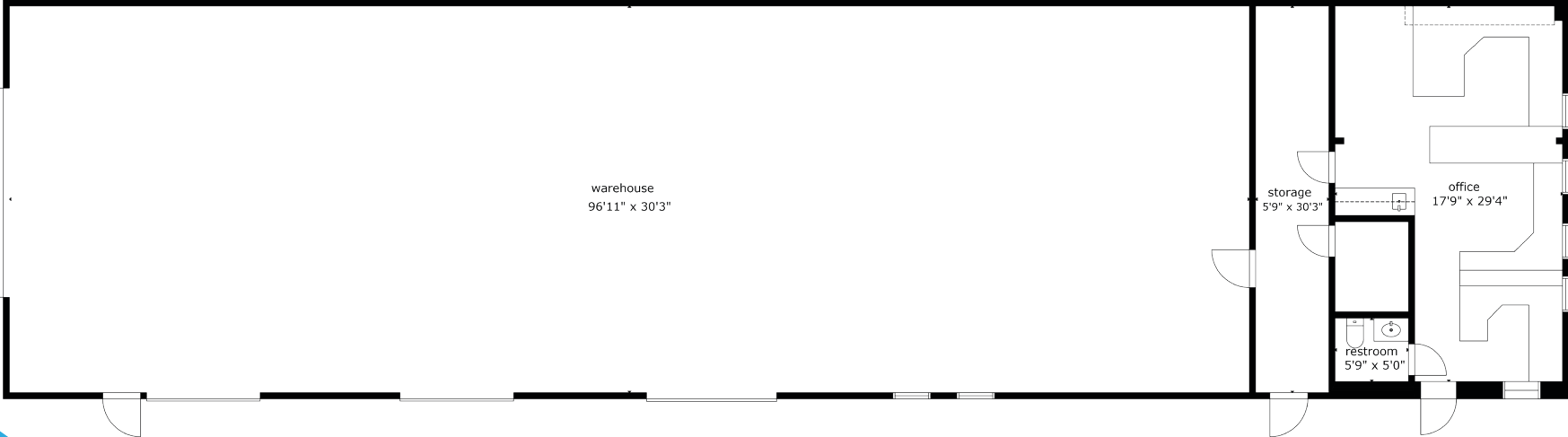

floor plan



for more information, contact patrick goetz vice president (407) 734.7210 pat@BBDRE.com

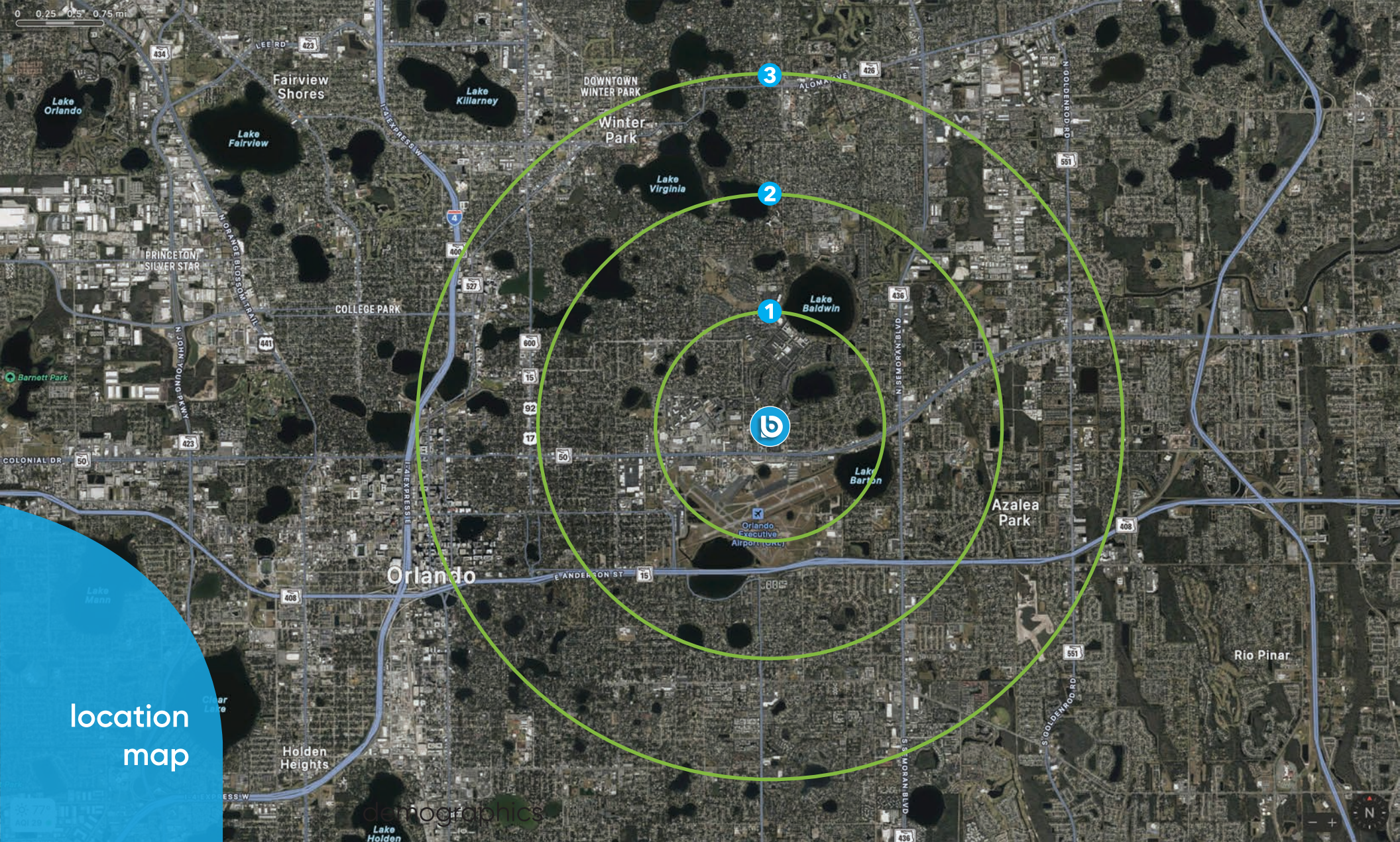

location
map

Radius	Population	HH Income	Businesses	Employees
1-Mile	10,311	\$120,540	1,284	9,885
2-Mile	43,617	\$110,238	4,156	26,387
3-Mile	114,059	\$98,970	12,990	96,051



for more information, contact patrick goetz vice president (407) 734.7210 pat@BBDRE.com