



Ranked in Top 50
Commercial Firms in U.S.

Up to
2,300± SF
Available

890± SF
Available

FOR LEASE

30 Welles Street, Glastonbury, CT 06033

3 In-line Retail Units Available – 890± SF and up to 2,300± SF Available

LEASE RATE: \$26.00/SF NNN

HIGHLIGHTS

- 14,895 SF Retail Plaza
- 3 Retail Units Available
- 2 units can be combined for 2,300± SF Total
- 1-story
- Ample Parking on 1.87 acres
- Zoning: TC
- Easy Access to Rt. 2

CONTACT

Robert Gaucher

(860) 761-6007

bgaucher@orlcommercial.com

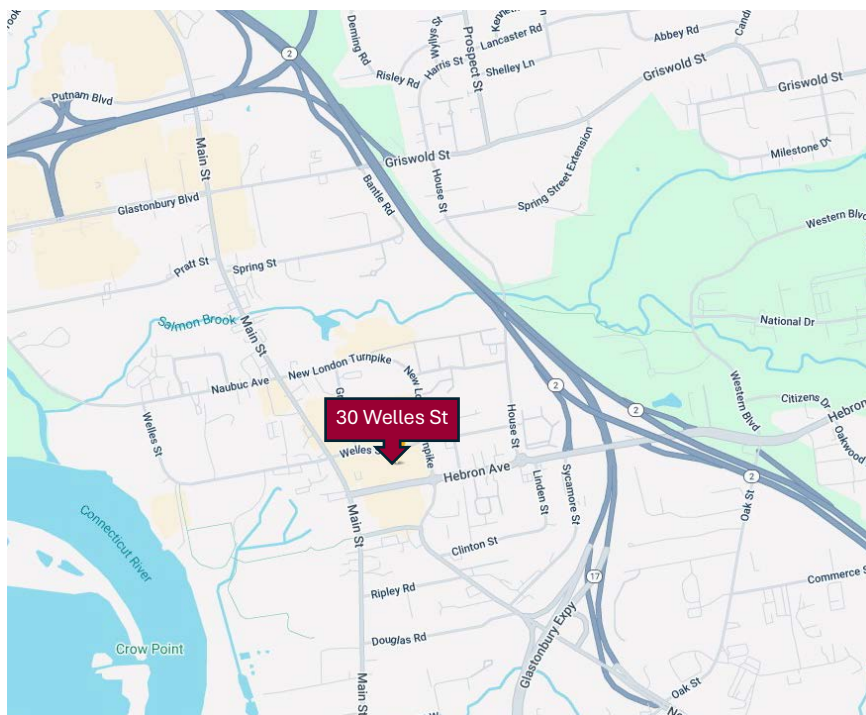

WWW.ORLCOMMERCIAL.COM



2430 Silas Deane Highway, Rocky Hill, CT 06067 | (860) 721-0033 | (860) 721-7882

2 Summit Place, Branford, CT 06450 | (203) 488-1555 | (203) 315-4046

Broker of Record: Jay Morris | 860.721.0033 | jmorris@orlcommercial.com | License: REB.0755257

While the information contained herein has been obtained from sources deemed to be reliable, no guarantee is made as to its accuracy.



FOR LEASE

LEASE RATE \$26.00/SF NNN

30 Welles St, Glastonbury, CT 06033

890± SF and up to 2,300± SF Available

BUILDING INFORMATION

GROSS BLD. AREA: 14,895± SF

AVAILABLE AREA: 890± SF, up to 2,300± SF

CONSTRUCTION: Brick Masonry

ROOF TYPE: Flat, Tar & Gravel

YEAR BUILT: 1978

MECHANICAL EQUIPMENT

AIR CONDITIONING: 100% A/C

HEAT: Forced Air, Gas

SPRINKLERED: TBD

ELECTRIC/POWER: TBD

SITE INFORMATION

SITE AREA: 1.87 acres

ZONING: TC

PARKING: Ample parking

SIGNAGE: On- Building and Monument

VISIBILITY: Excellent on Welles and Hebron

HWY ACCESS: Rt. 2 Exit 8

UTILITIES

SEWER/WATER: City

GAS: Yes

EXPENSES

RE TAXES: ☒ Tenant ☐ Landlord

UTILITIES: ☒ Tenant ☐ Landlord

INSURANCE: ☒ Tenant ☐ Landlord

MAINTENANCE: ☒ Tenant ☐ Landlord

JANITORIAL: ☒ Tenant ☐ Landlord

NNN EXPENSES: \$9.00/SF (estimated)

NEW FAÇADE RENDERING

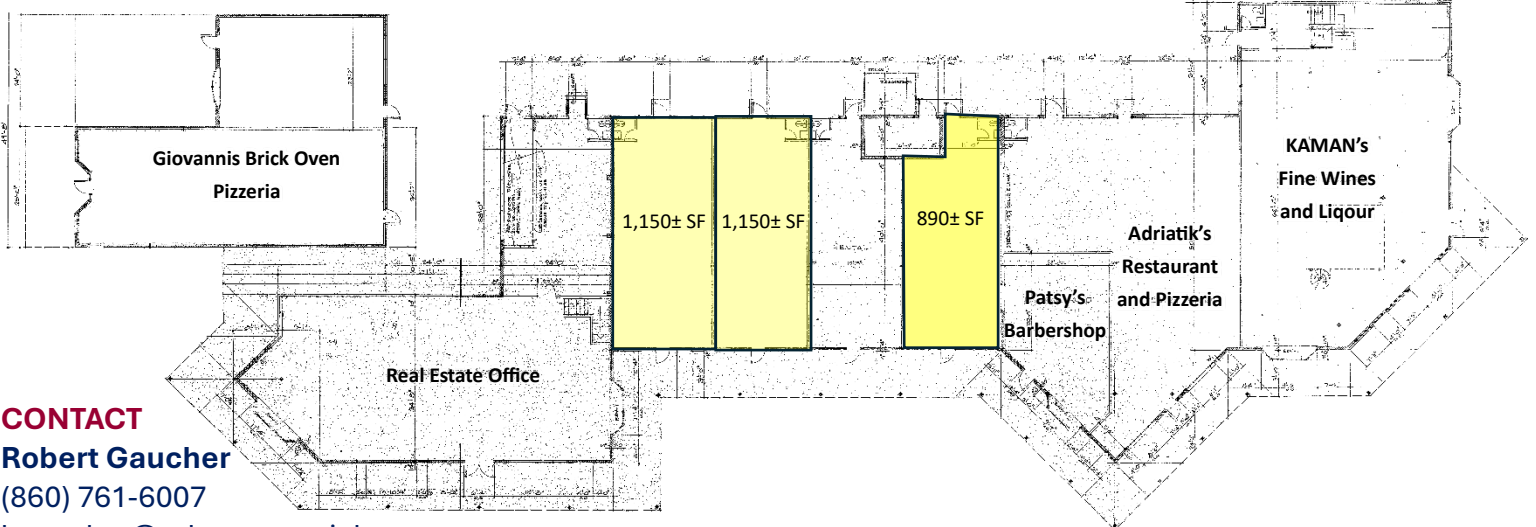

CONTACT

Robert Gaucher

(860) 761-6007

bgaucher@orlcommercial.com



WWW.ORLCOMMERCIAL.COM



2430 Silas Deane Highway, Rocky Hill, CT 06067 | ☎ (860) 721-0033 | 📠 (860) 721-7882

2 Summit Place, Branford, CT 06450 | ☎ (203) 488-1555 | 📠 (203) 315-4046

Broker of Record: Jay Morris | 860.721.0033 | jmorris@orlcommercial.com | License: REB.0755257

While the information contained herein has been obtained from sources deemed to be reliable, no guarantee is made as to its accuracy.