

FOR SALE

2644 SOUTH CRODDY WAY | SANTA ANA, CA



PROPERTY HIGHLIGHTS

- ± 11,998 SF Freestanding Building
- Three (3) Ground Level Doors
- 16' Clear Height
- Large Fenced Yard
- Fully Sprinklered
- 1,000 Amps (Verify)
- Zoning: M-1

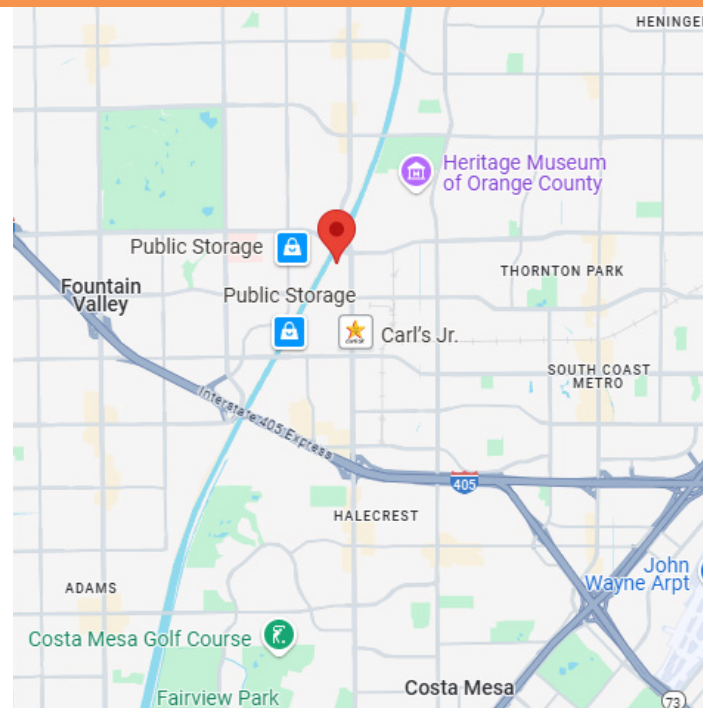

TYLER GEBAUER

949.419.3329

Tyler.Gebauer@marcusmillichap.com

CA License: 02101217

BRYANT TRAN

949.419.3398

Bryant.Tran@marcusmillichap.com

CA License: 02173105

Marcus & Millichap

FOR SALE

2644 SOUTH CRODDY WAY | SANTA ANA, CA

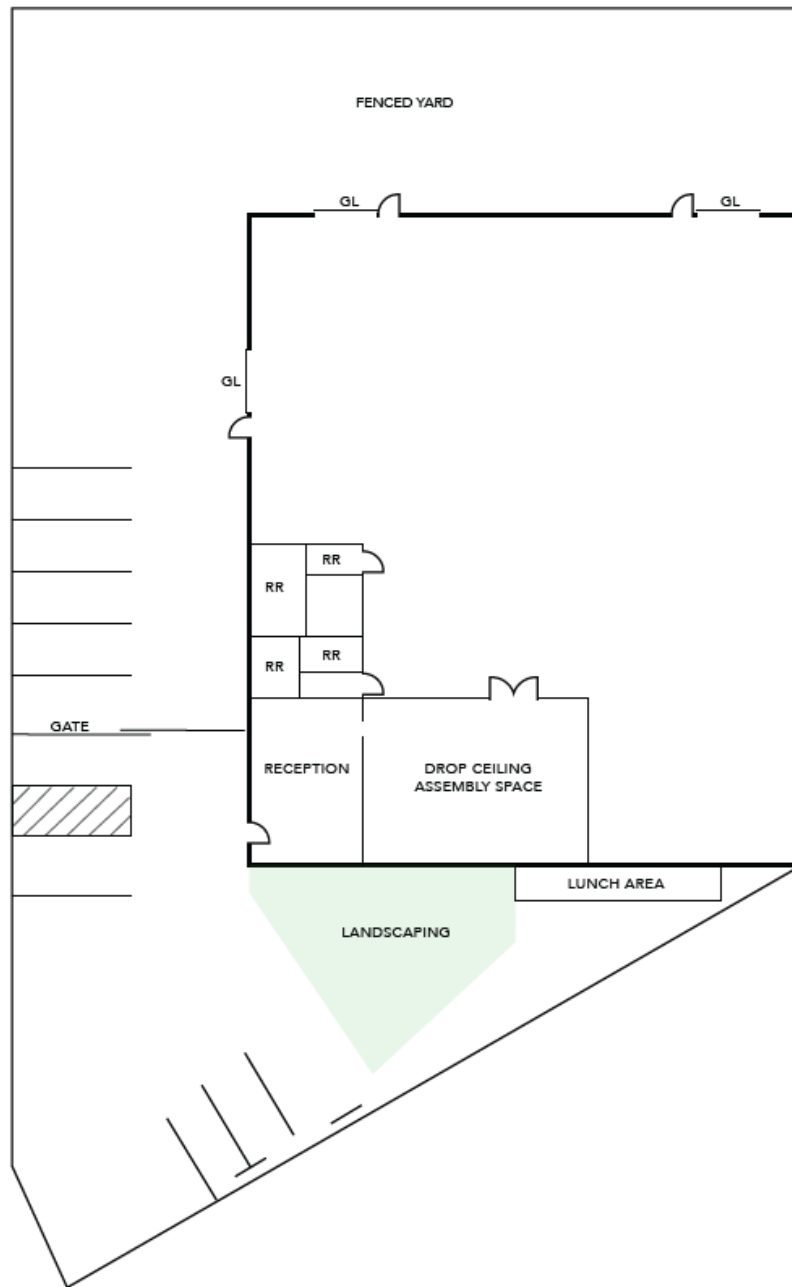

TYLER GEBAUER

949.419.3329

Tyler.Gebauer@marcusmillichap.com

CA License: 02101217

BRYANT TRAN

949.419.3398

Bryant.Tran@marcusmillichap.com

CA License: 02173105

Marcus & Millichap

FOR SALE

2644 SOUTH CRODDY WAY | SANTA ANA, CA



TYLER GEBAUER

949.419.3329

Tyler.Gebauer@marcusmillichap.com

CA License: 02101217

BRYANT TRAN

949.419.3398

Bryant.Tran@marcusmillichap.com

CA License: 02173105

Marcus & Millichap