

# 807 Bluff Road

Columbia, South Carolina

*For Sublease*



## Office Space Available

### FEATURES

- ▶ 22,091 total SF - Fully integrated tech knowledge (18,257 SF of office space)
- ▶ Options to sublease portions of the space
- ▶ Office areas consists of individual offices, open work spaces, conference rooms, bathrooms, break room
- ▶ Located just outside of downtown across from SC State Fairgrounds
- ▶ Currently Softdocs Headquarters
- ▶ Excellent Condition
- ▶ Surface level parking
- ▶ Tax Map #R11206-01-01
- ▶ Rate: \$25,000/month/modified gross



*Great Location Outside Downtown Columbia*

Henry F. Mabry Jr., CCIM

(P) 803.779.3555 • [hmabry@mabryproperties.com](mailto:hmabry@mabryproperties.com)

*Every effort has been made to provide accurate information but no liabilities are assumed for errors and omissions.*

**MABRY**  
COMMERCIAL PROPERTIES, LLC

# 807 Bluff Road

Columbia, South Carolina

*For Sublease*

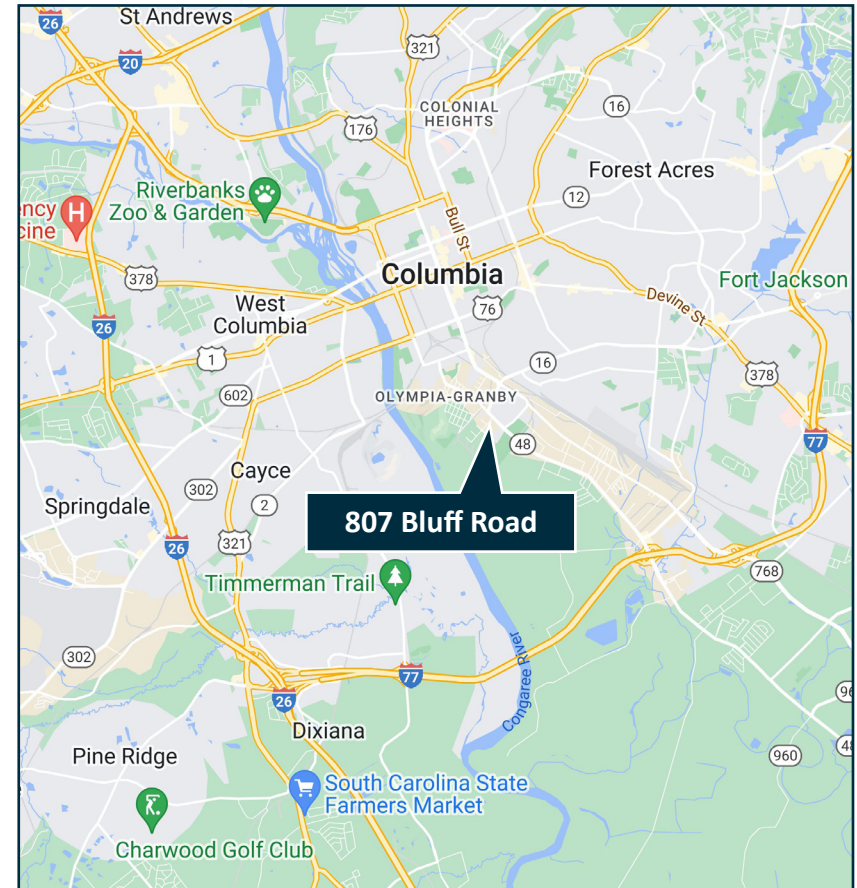

**Great Location Near Downtown Columbia**

Henry F. Mabry Jr., CCIM

(P) 803.779.3555 • [hmabry@mabryproperties.com](mailto:hmabry@mabryproperties.com)

*Every effort has been made to provide accurate information but no liabilities are assumed for errors and omissions.*

**MABRY**  
COMMERCIAL PROPERTIES, LLC

# 807 Bluff Road

Columbia, South Carolina

*For Sublease*

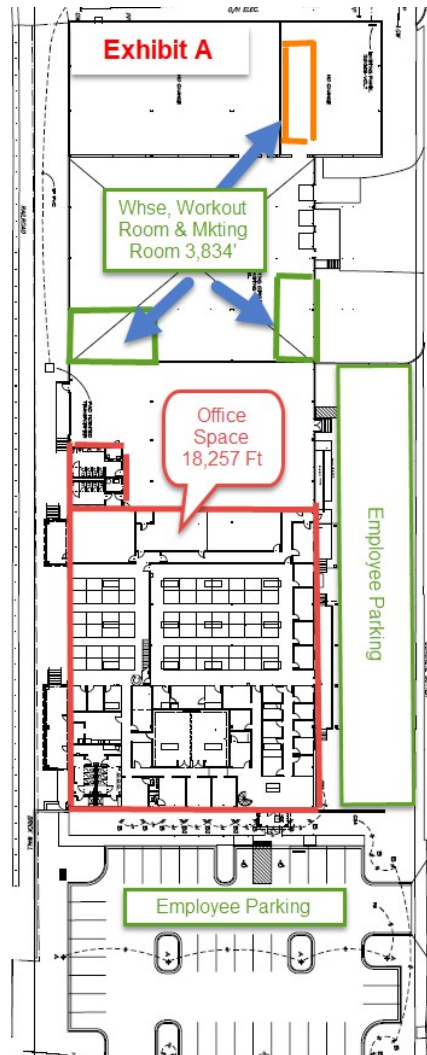

Floor Plan

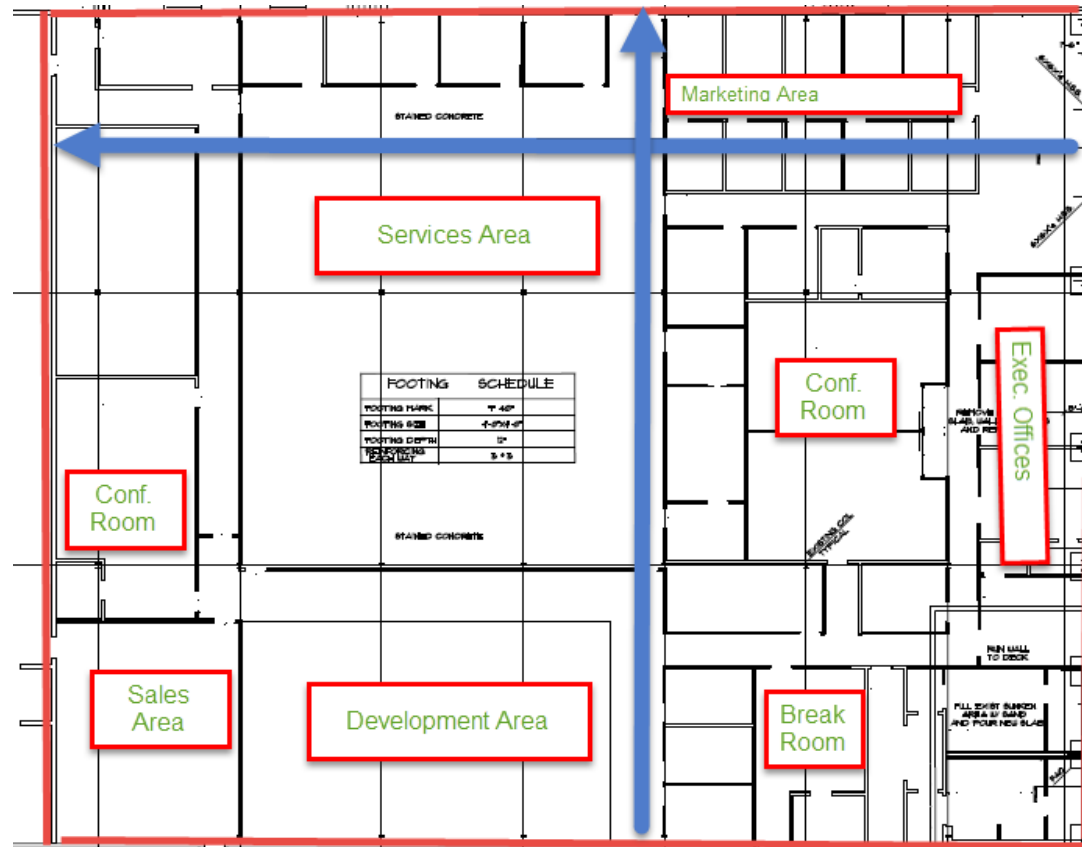

Henry F. Mabry Jr., CCIM

(P) 803.779.3555 • [hmabry@mabryproperties.com](mailto:hmabry@mabryproperties.com)

*Every effort has been made to provide accurate information but no liabilities are assumed for errors and omissions.*

**MABRY**  
COMMERCIAL PROPERTIES, LLC