

4501 South Cottage Grove Avenue



Presented By:
Coldwell Banker

Cottage Grove, Chicago, IL 60653



4501 South Cottage Grove Avenue

Cottage Grove, Chicago, IL 60653

Property Details

Located in the vibrant Bronzeville neighborhood, this expansive 25,238 sqft commercial land offers a prime opportunity for companies in the technology, retail, or medical fields. For technology companies, the land's strategic location in the heart of Bronzeville offers easy access to a highly educated and diverse workforce, as well as proximity to leading research institutions and top-notch talent. Additionally, the area's thriving arts and culture scene, as well as its growing reputation as a hub for innovation, make it an attractive destination for tech startups looking to establish a presence in the area.

Retail companies can take advantage of the land's prime location on a bustling commercial corridor, with excellent visibility and foot traffic. The site's expansive size offers ample space for large-scale retail operations, as well as potential for mixed-use development that could include residential and office components to create a dynamic and thriving community.

For medical companies, the land's proximity to world-class hospitals and medical facilities, including the University of Chicago Medical Center, make it an ideal location for healthcare providers and medical research institutions. The site's large size and flexible zoning offer endless possibilities for customized development that can meet the specific needs of medical companies.

Overall, this commercial land for sale on 4501 S Cottage Grove in Bronzeville presents a unique opportunity for companies in the technology, retail, or medical fields to establish a strategic presence in one of Chicago's most vibrant and dynamic neighborhoods. With its prime location, ample space, and endless potential, this site is sure to attract interest from a wide range of businesses seeking to capitalize on the area's many strengths.

The B1-5 zoning classification for your commercial land on 4501 S Cottage Grove in Bronzeville offers a versatile range of commercial uses, including retail, service, and professional businesses. The maximum height allowed under this classification is 60 feet and the floor area ratio can be up to 2.2, which offers ample space for large-scale development without detracting from the surrounding neighborhood's character. With a variety of permitted uses, including banks, restaurants, retail stores, offices, and medical clinics, B1-5 zoning provides a flexible framework that can accommodate the needs of any business looking to establish a presence in Bronzeville. This zoning classification ensures that any development on the site complies with local regulations and maintains the area's integrity and character. Overall, the B1-5 zoning classification for your commercial land provides a solid foundation for creative and customized development, making it an ideal location for businesses in the technology, retail, or medical fields.

Price:	\$1,499,000
Property Type:	Land
Property Subtype:	Commercial
Proposed Use:	Commercial
Sale Type:	Investment
Total Lot Size:	0.58 AC
No. Lots:	1
Zoning Description:	B1-5
APN / Parcel ID:	20-02-311-001-0000

Excellent opportunity to capitalize on future development in a robust market with strong economic growth and increasing demand in Bronzeville. 4501 South Cottage Grove is appx. 168.25x150, Lot Square Footage: 25238, this property is being sold "as-is".

Price: \$1,499,000

- Premier Corner Vacant Lot
- Minutes from Chicago Downtown & Lake
- Surrounded by State & Federal Businesses

View the full listing here: <https://www.loopnet.com/Listing/Cottage-Grove-Chicago-IL/26166799/>

4501 South Cottage Grove Avenue

Cottage Grove, Chicago, IL 60653

Location



4501 South Cottage Grove Avenue

Cottage Grove, Chicago, IL 60653

Property Photos



Aerial



Aerial

4501 South Cottage Grove Avenue

Cottage Grove, Chicago, IL 60653

Property Photos

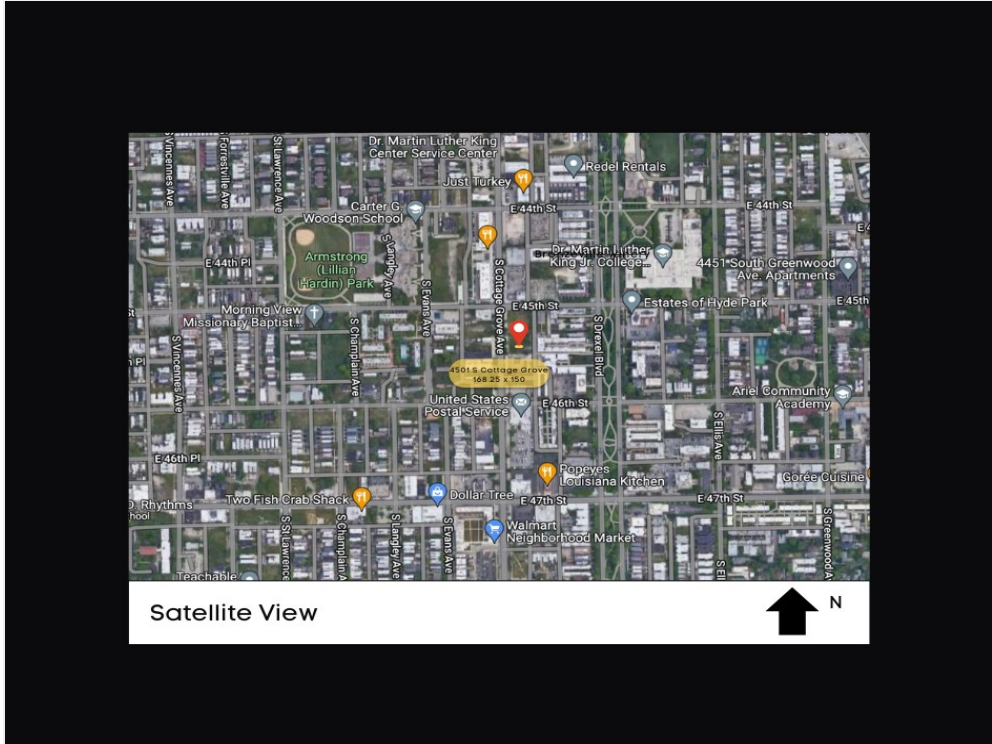

Satellite View

Satellite 4501

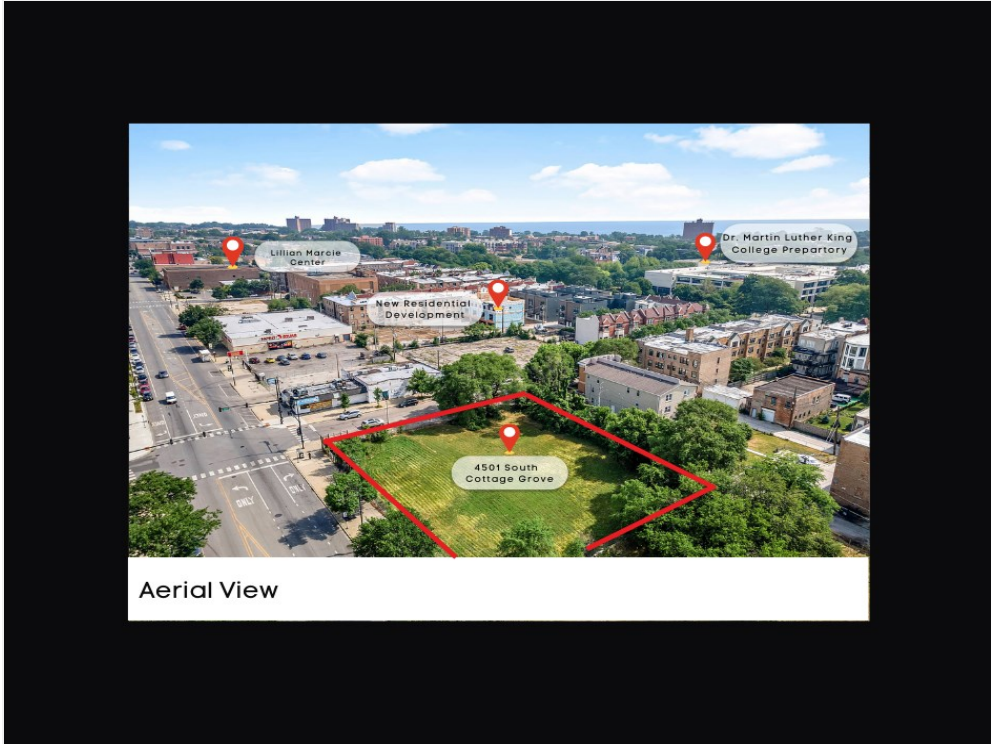

Aerial View

Aerial

4501 South Cottage Grove Avenue

Cottage Grove, Chicago, IL 60653

Property Photos

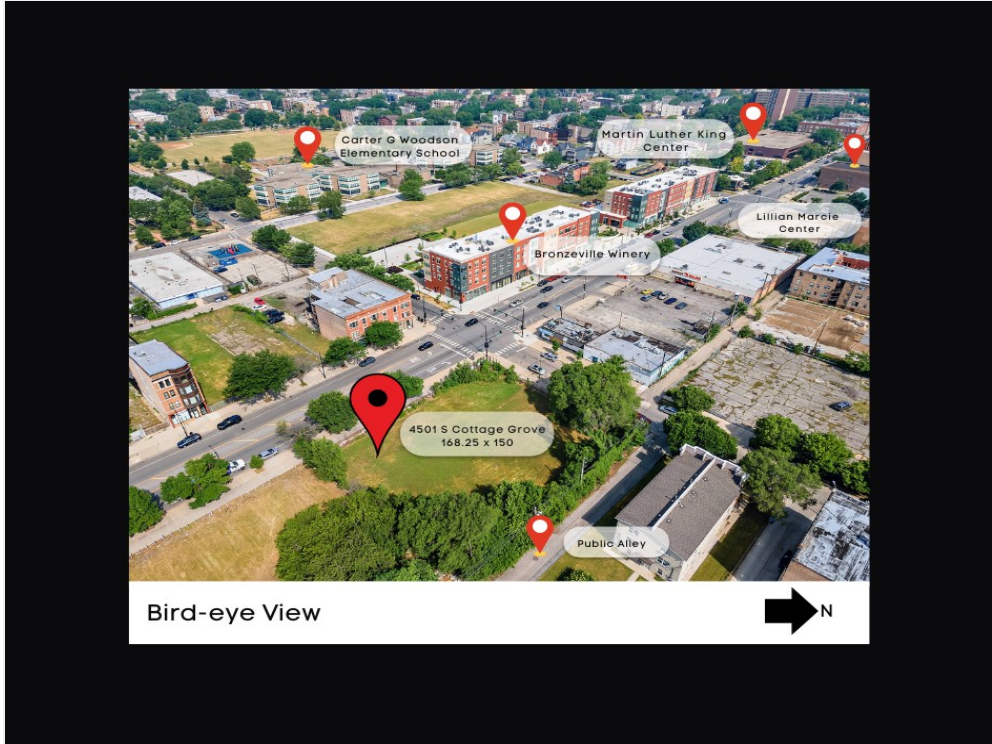

Aerial



Aerial

4501 South Cottage Grove Avenue

Cottage Grove, Chicago, IL 60653

Property Photos



Aerial



Aerial

4501 South Cottage Grove Avenue

Cottage Grove, Chicago, IL 60653

Property Photos



Lake Park Pointe



Lake Park Pointe

4501 South Cottage Grove Avenue

Cottage Grove, Chicago, IL 60653

Property Photos



Bronzeville Winery



Chicago Fire Department Engine Company #45

4501 South Cottage Grove Avenue

Cottage Grove, Chicago, IL 60653

Property Photos



Henry W. McGee Post Office

4501 South Cottage Grove Avenue

Cottage Grove, Chicago, IL 60653



Sybil Martin

SRM7000@aol.com

(773) 451-1200

Coldwell Banker

1314 E 47th St

Chicago, IL 60653

