

# For Lease



## 1355 & 1365 Judd Ave SW

Wyoming, MI, 49509

Centralized in Grand Rapids, this property includes an Industrial Building with almost an acre allowed for outdoor storage in the I2- Heavy Industrial District of Wyoming. The building is equipped with heavy power, fire suppression and CO2 censored ventilation that could be utilized for a multitude of different uses. The owner recently acquired 1365 Judd for the purpose of picking up additional parking for the 1355 Judd.

1355 Judd is currently used as a commissary kitchen and food truck storage and is specially equipped with 4 certified kitchens, prepping areas, a walk-in cooler and 2 walk in freezers. This equipment is owned by the landlord and could be negotiated into the lease deal.

### Highlights

- Outdoor Storage / Additional Parking (See Pictures)
- Centralized Location to Downtown Grand Rapids and surrounding areas.
- 18' ceilings in warehouse portion, most of the building could be opened up onto additional warehouse.
- Warehouse area is equipped with 1-14'x14' overhead door, 1 - loading dock, CO2 ventilation and hevay electrical

Lease Rate \$7.95/SF/YR NNN

Building Size 12,576 sqft

Total Acres 1.25 Acres

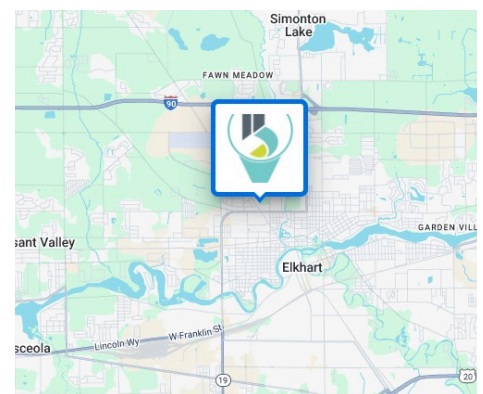

Kevin VanHaitsma  
Vice President  
kvanhaitsma@bradleyco.com  
c 616.308.1727

Case Overweg  
Vice President  
coverweg@bradleyco.com  
c 616.540.4924

# Floorplan

1355 & 1365 Judd Ave SW, Wyoming, MI 49509

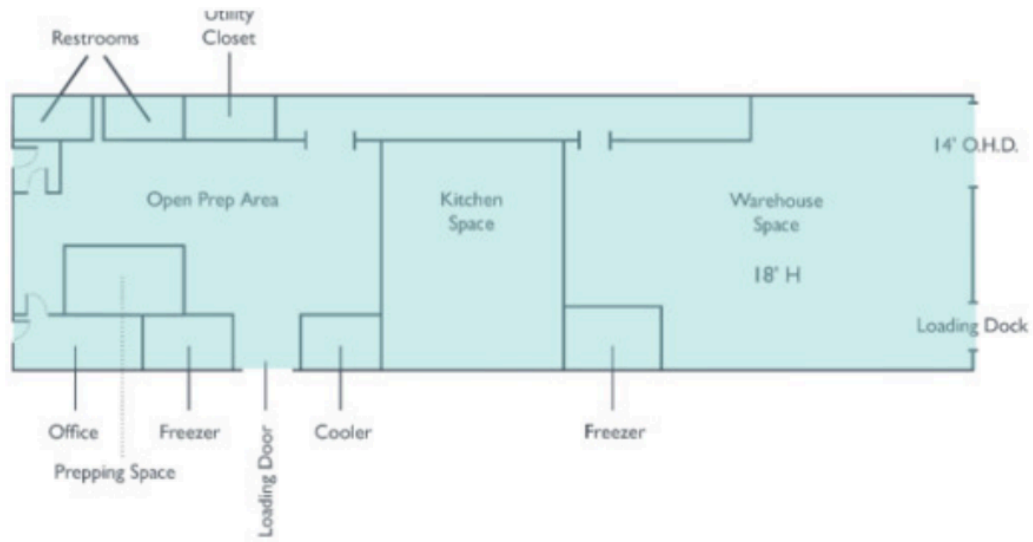

## Availabilities

Suite	Size	Type	Rate
1355 & 1365 Judd Ave	12,576 SF	NNN	\$7.95 SF/YR

# Additional Photos

1355 & 1365 Judd Ave SW, Wyoming, MI 49509

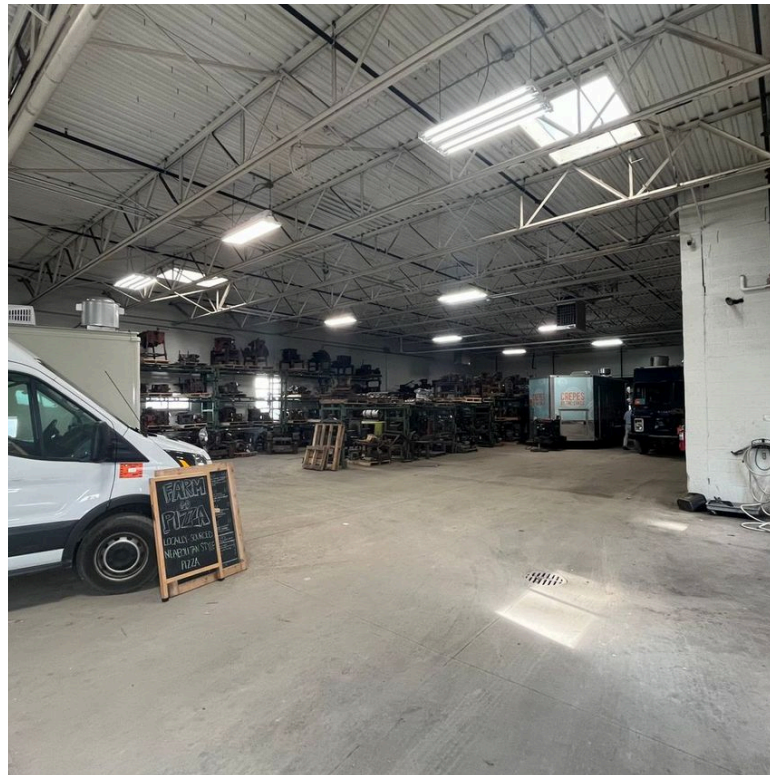
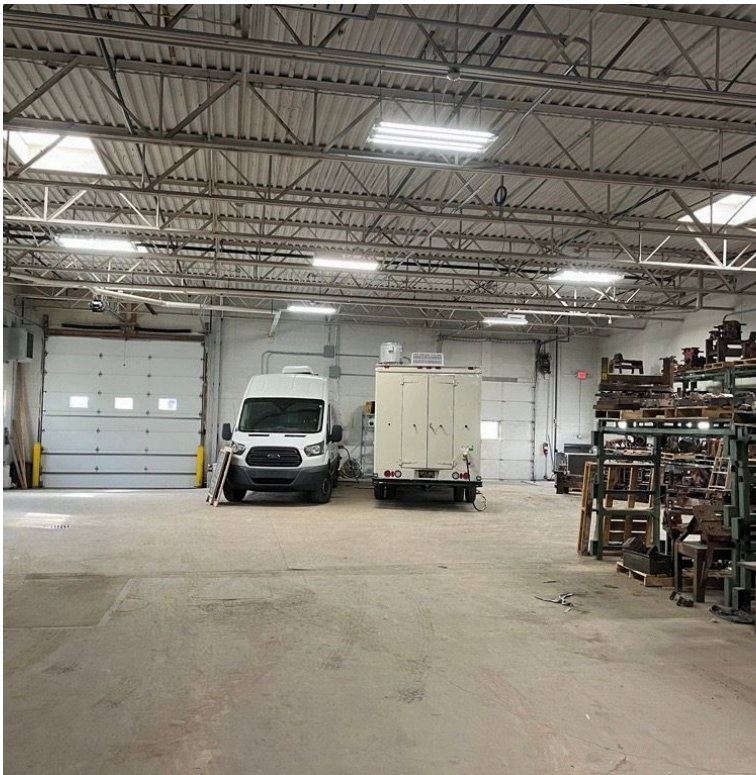

# Interior Photos

1355 & 1365 Judd Ave SW, Wyoming, MI 49509



# Location Map

1355 & 1365 Judd Ave SW, Wyoming, MI 49509

