

# 20TH STREET INDUSTRIAL

2915 20<sup>th</sup> St NE, Cleveland, TN

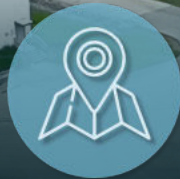

## **GREAT LOCATION**

Easy Access to APD-40  
and US-64; 10 Minutes to  
I-75 Freeway



## **IL ZONING**

Light Industrial:  
Light Manufacturing,  
Distribution, etc.

**LEASING FLYER**







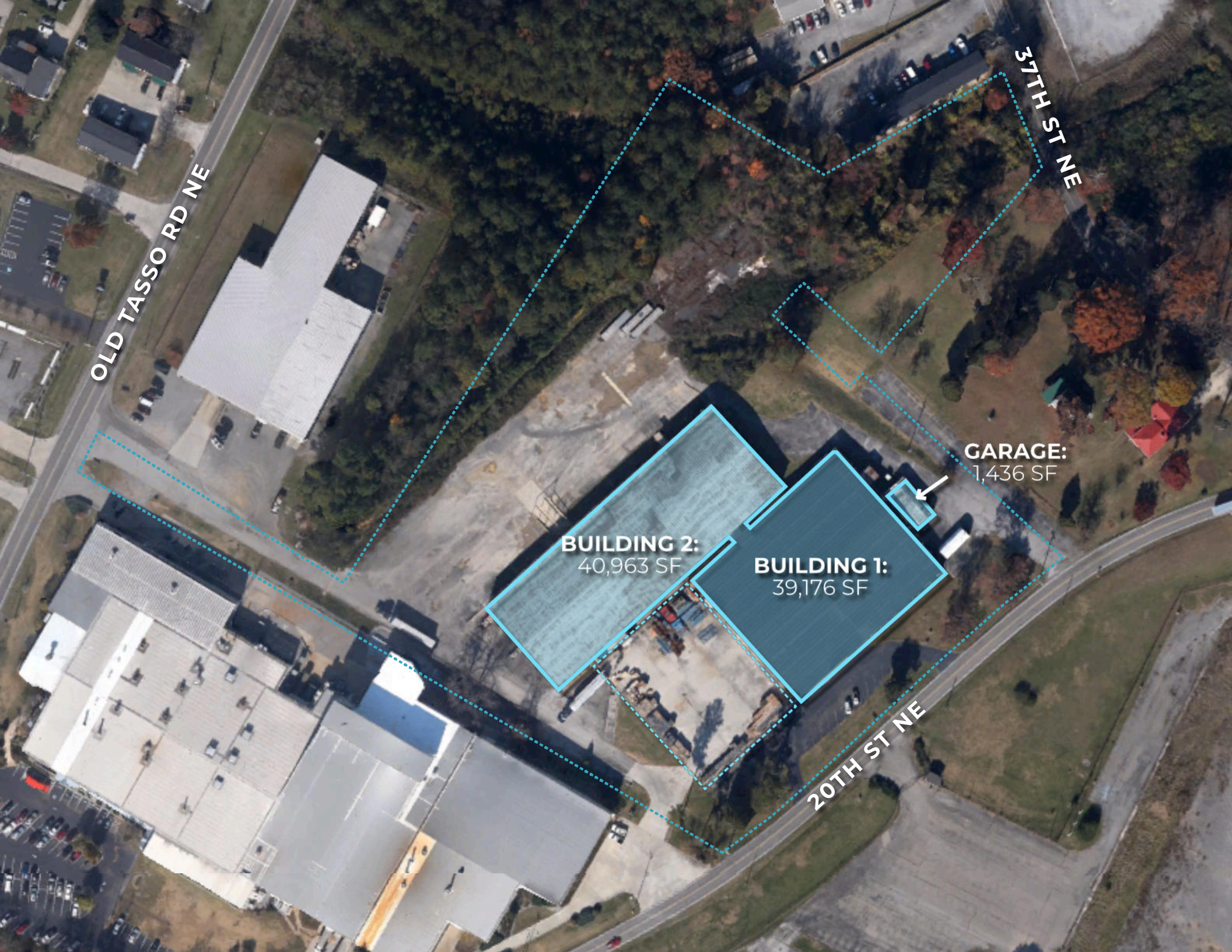

OLD TASSO RD NE

37TH ST NE

**BUILDING 2:**  
40,963 SF

**BUILDING 1:**  
39,176 SF

**GARAGE:**  
1,436 SF

20TH ST NE



# AVAILABLE SPACE

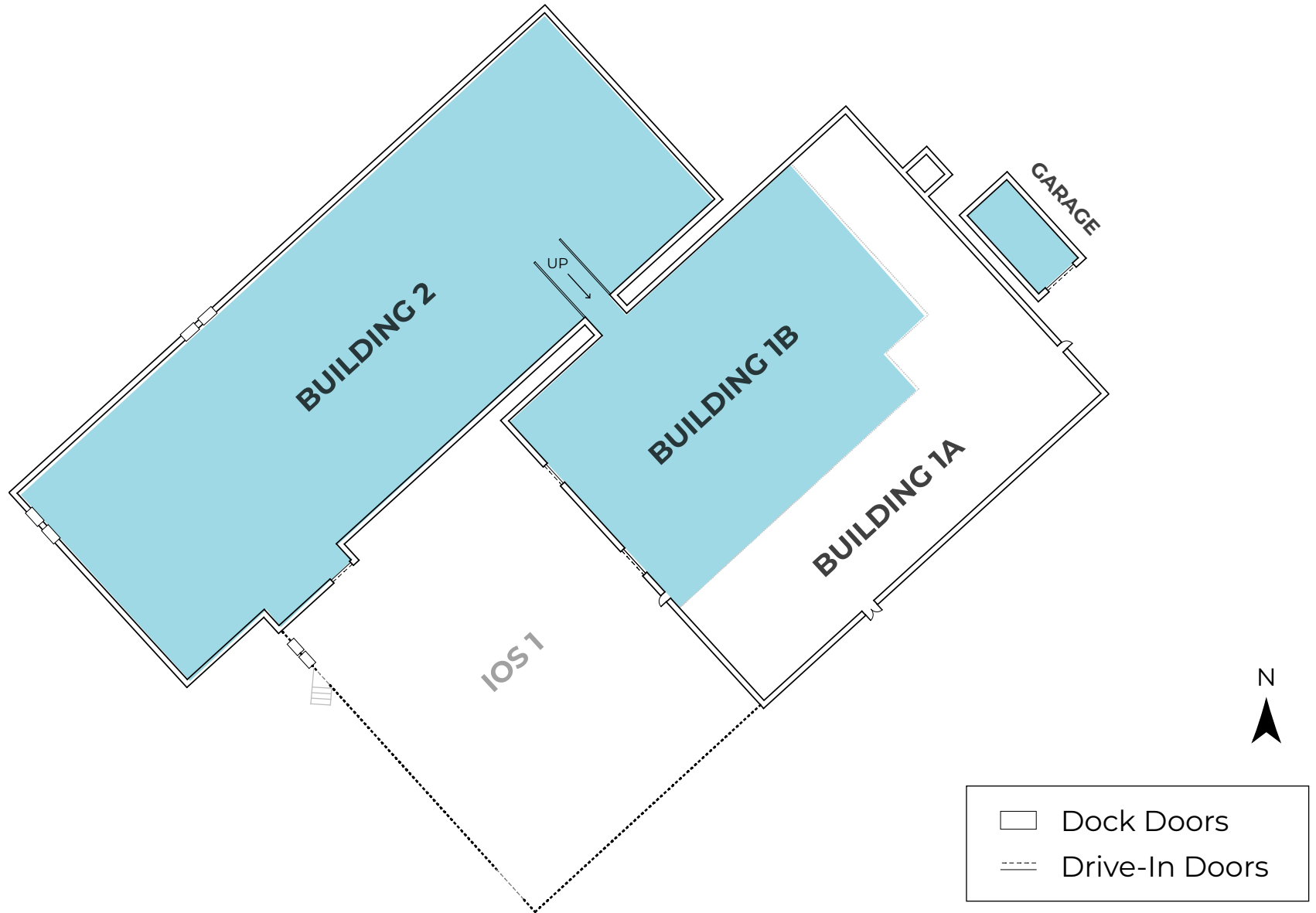

Sketch is a rough estimation and not to scale.

# AVAILABLE SPACE

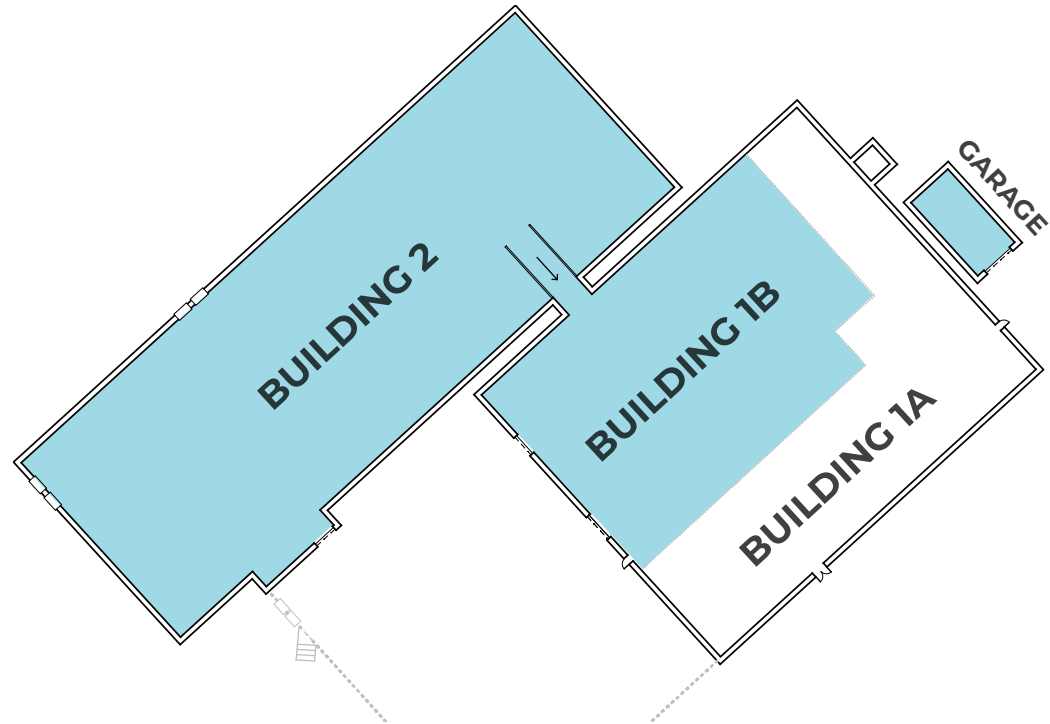

BUILDING	1B	2	Garage
SIZE	+/- 20,000 Sqft.	+/- 41,000 Sqft.	+/- 1,450 Sqft.
LOADING DOCKS	-	4	-
DRIVE-INS	2	1	1
AVAILABILITY	180 Days	180 Days	60 Days

Sketch is a rough estimation and not to scale.









**IOS 2:**  
DIVISIBLE +/- 4.5 AC

**IOS 1:**  
+/- 28,000 SF  
GATED LOT

Sketch is a rough estimation and not to scale.



# AVAILABLE LAND



SPACE	IOS 1	IOS 2
LOT SIZE	+/- 28,000 Sqft.	+/- 4.5 AC [Divisible]
GATED/SECURED	Yes	-
LOADING DOCKS	2	-
DRIVE-INS	1	-

Sketch is a rough estimation and not to scale.



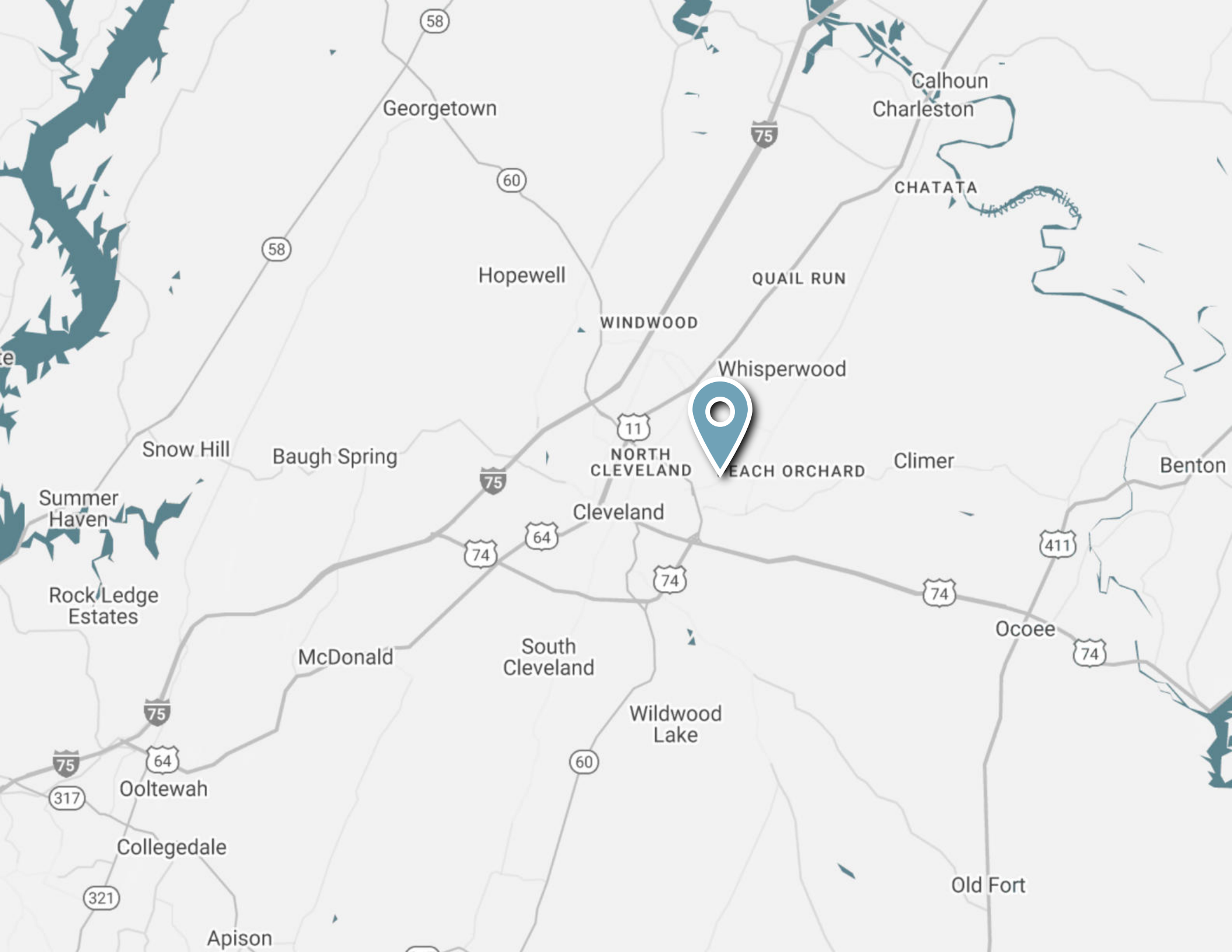



BlendPack

AIRL, Inc.

FERGUSON

Seifeler

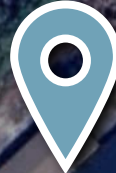

CORMETECH.

derby  
SUPPLY CHAIN SOLUTIONS

Rhodes  
CLIMATE CONTROLLED  
STORAGE

AAA  
Mini Storage

CORMETECH.

IRONCRAFT

TOY YARD

Whirlpool  
CORPORATION

Coca-Cola





**Brad Peters**

[bpeters@ipausa.com](mailto:bpeters@ipausa.com)

858-209-4329

*DRE#02025155*