

Davie Ave / International Dr. parcel, Statesville, B-5 zoning

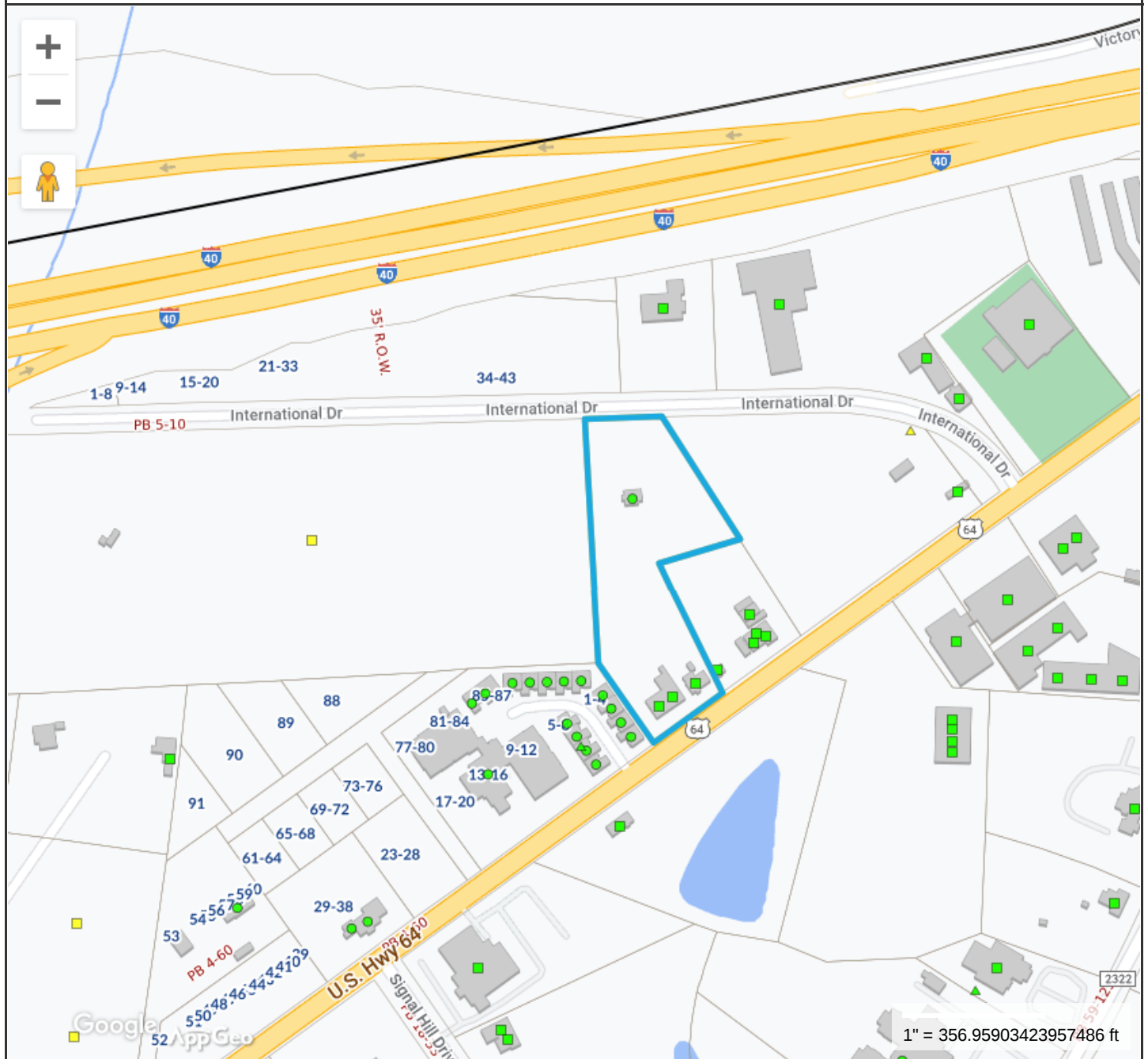

Tax Map Information

• PIN	4755143591.000
• Address	2329 DAVIE AVE
• Account #	Acct 80091089
• Tax Owner	MCINTYRE KRISTAN L
• Mailing Address	200 WILDWOOD LOOP STATESVILLE, NC 28625
• GIS Owner	MCINTYRE KRISTAN L
• Deed Info	22E / 169 - WB - 20220201
• Tax Acres	3.7 AC
• Lot #	
• Description	GURLEY US64
• Zoning	B-5
• Old Parcel #	0106Q00000A017
• Bldg Value	\$153,680
• OBXF Value	\$920
• Land Value	\$236,800
• Total Value	\$391,400
• Defer Value	\$0
• Tax Districts	STATESVILLE---



**MAP FOR REFERENCE ONLY
NOT A LEGAL DOCUMENT**

Iredell County, North Carolina makes no claims and no warranties, expressed or implied, concerning the validity or accuracy of the GIS data presented on this map.

Geometry updated 10/11/2023
Data updated 10/16/2023

Print map scale is approximate. Critical layout or measurement activities should not be done using this resource.