

WAIANAЕ MALL

86-120 Farrington Highway, Waianae, HI, 96792



PROPERTY

Waianae Mall is the heart of retail on the west coast of Oahu. Drugstore-anchored with excellent visibility, the center has great frontage along Farrington Highway. This high-traffic neighborhood shopping center has strong community ties and sales through its mix of national and local tenants that include: Long's / CVS Drugs, City Mill, Starbucks, Jamba Juice, Pizza Hut, Burger King, Goodyear Tires, American Savings Bank and Bank of Hawaii.

CENTER SIZE

171,600 SF

2020 DEMOGRAPHICS	1-Mile	3-Mile	5-Mile
Estimated Population	9,375	34,072	50,262
2021 Projected Population	9,375	34,072	50,262
Total Households	2,235	8,042	11,991
Average Household Income	\$87,549	\$83,020	\$82,918
Daytime Population	8,786	29,593	43,351
Median Age	32	31	32
Bachelor Degree or Higher	15%	15%	16%



ALEXANDER & BALDWIN

822 Bishop Street, Honolulu, HI 96813 | www.alexanderbaldwin.com

Leasing: **Aja M. S. Shimamura (S)** (808) 525-6662 | ashimamura@abhi.com



WAIANAE MALL

86-120 Farrington Highway, Waianae, HI, 96792

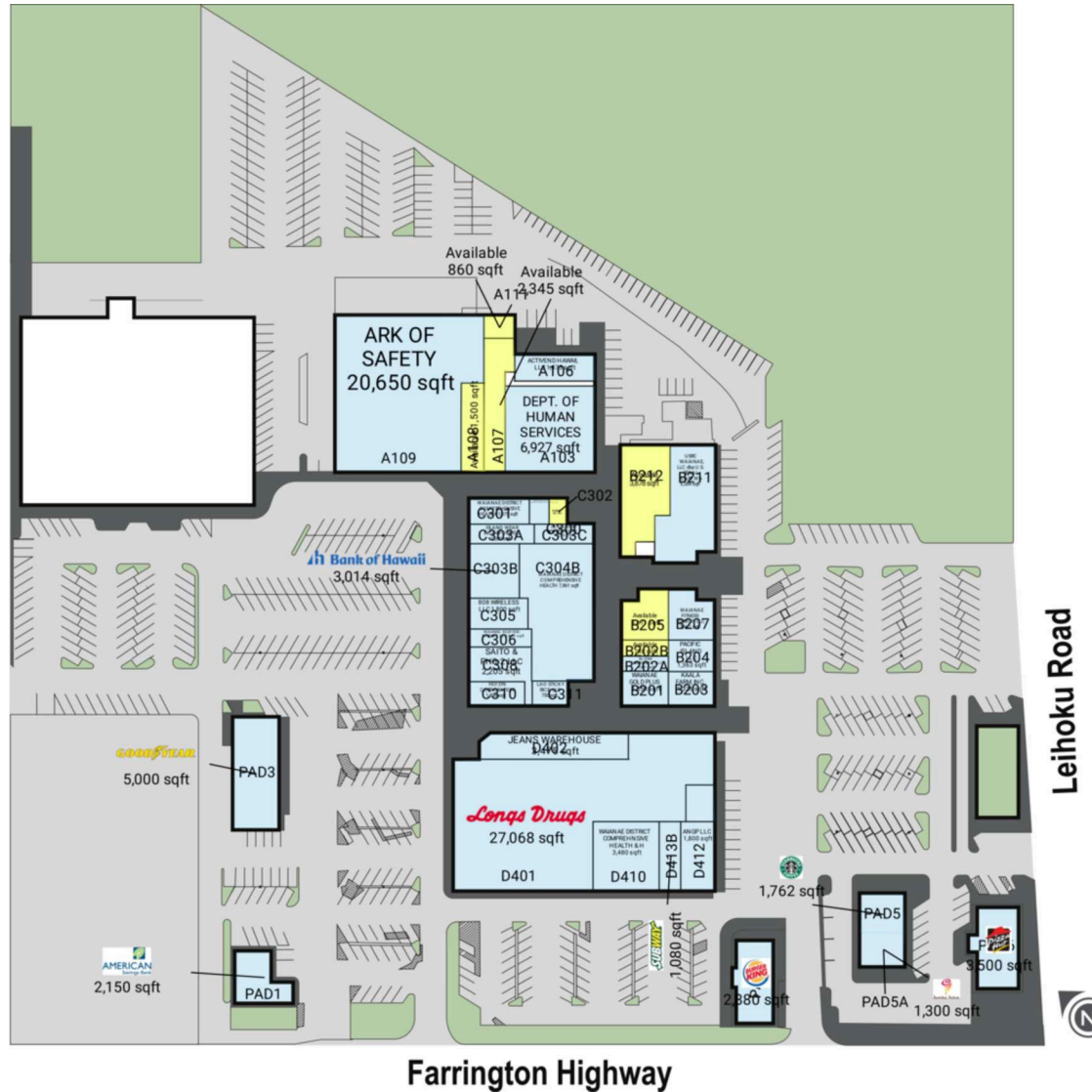

ALEXANDER & BALDWIN

822 Bishop Street, Honolulu, HI 96813 | www.alexanderbaldwin.com

Leasing: **Aja M. S. Shimamura (S)** (808) 525-6662 | ashimamura@abhi.com



WAIANAË MALL

86-120 Farrington Highway, Waianae, HI, 96792

AVAILABLE SPACES

SPACE	SF	SPACE	SF
A107	2,345 SF	B205	1,671 SF
A108	1,500 SF	B212	3,878 SF
A111	860 SF	C302	500 SF
B202B	798 SF		

All information is subject to change without notice. Dimensions, configurations, and frontages are approximate and any measurements are estimates. No promise is made that the spaces, common areas, amenities, landscaping, or features depicted are or will be built, or if built will be as shown. Landlord makes no representations about specific tenants or where they may operate. Unless Landlord signs a binding lease for a specific space, you do not have a right to lease any space. No content from these pages may be copied, republished, or distributed in any way without Landlord's written consent. Despite Landlord's efforts to provide accurate information, it is not possible to ensure it is always up to date, and Landlord assumes no responsibility for any actions taken in reliance on this information.



ALEXANDER & BALDWIN

822 Bishop Street, Honolulu, HI 96813 | www.alexanderbaldwin.com

Leasing: **Aja M. S. Shimamura (S)** (808) 525-6662 | ashimamura@abhi.com

