

# Office Space For Lease

THE RIDGE PROFESSIONAL PLAZA  
700 E MOUNTAINVIEW AVE  
ELLENSBURG, WA



UP TO 10,400 SF AVAILABLE  
MULTIPLE OFFICE CONFIGURATIONS

SOLAR DOLAR, LLC  
509-899-7371 - JOEL GREAR  
SOLARDOLARLLC@GMAIL.COM



# Overview

## Property/Offices

- Great visibility from Mountain View Ave
- Quiet neighborhood
- Enhanced overhead lighting throughout office
- Professionally maintained and operated
- Secured entries
- Some suites have kitchen areas
- Home to a variety of professional services
- Heated & air conditioned

## Utilities

- High speed internet available
- City of Ellensburg water (fire and potable)
- City of Ellensburg natural gas
- City of Ellensburg electricity

## Zoning

- Residential Office

## Current Availability

- Varies - Up to 10,400 sf potentially





# Highlights



Easy Access



Customer Friendly



Maintained  
Facility



Natural Light



ADA Restrooms



Spacious Offices



Conference  
Rooms/Kitchenettes

# Floor Plan

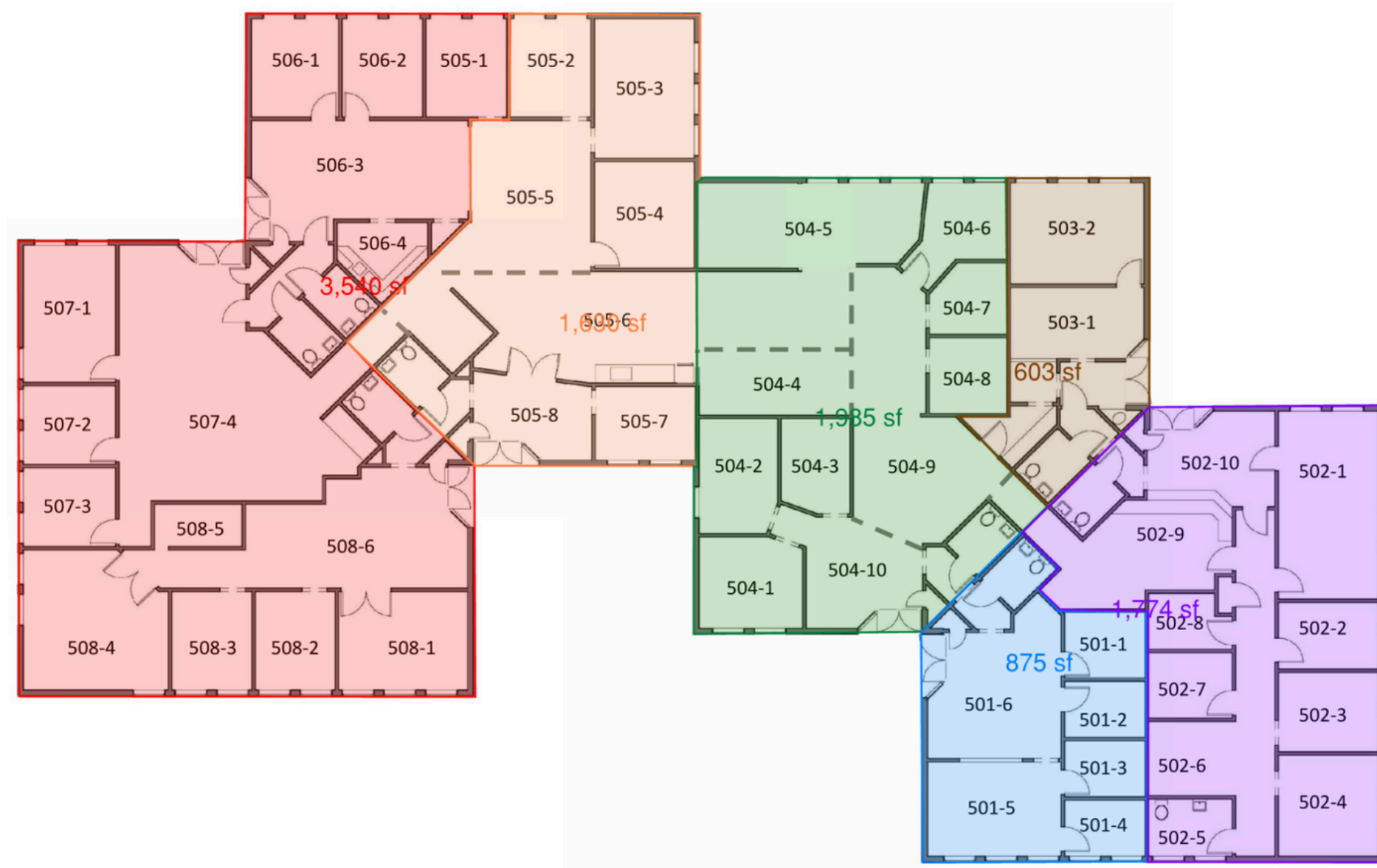



The background image shows the exterior of a single-story commercial building with a tan-colored stucco wall and a dark grey shingled roof. There are several windows and glass doors. On the left, a window has a logo for 'BPE LAW GROUP'. In the center, there are two glass doors with addresses '508' and '505'. The door '505' has a sign that says 'BASALT FAMILY WELLNESS' and a phone number '509.426.3750'. To the right of the doors, another window has a logo for 'BASALT FAMILY WELLNESS'. A blue arrow-shaped graphic points from the left towards the center, containing the text 'Contact Us' in white. At the bottom, there is a dark blue banner with white text providing contact information. The bottom of the image shows a concrete sidewalk and green grass.

# Contact Us

Phone : 509-899-7371

Contact : Joel Greear

Email : [solardolarllc@gmail.com](mailto:solardolarllc@gmail.com)

Address : 700 E Mountainview Ave  
Ellensburg, WA 98926