

PROPOSED MEDICAL OFFICE AND SITE IMPROVEMENTS

AT

2723 & 2695 WEST RIDGE ROAD
ROCHESTER, NY 14626

TOWN OF GREECE
MONROE COUNTY
NEW YORK

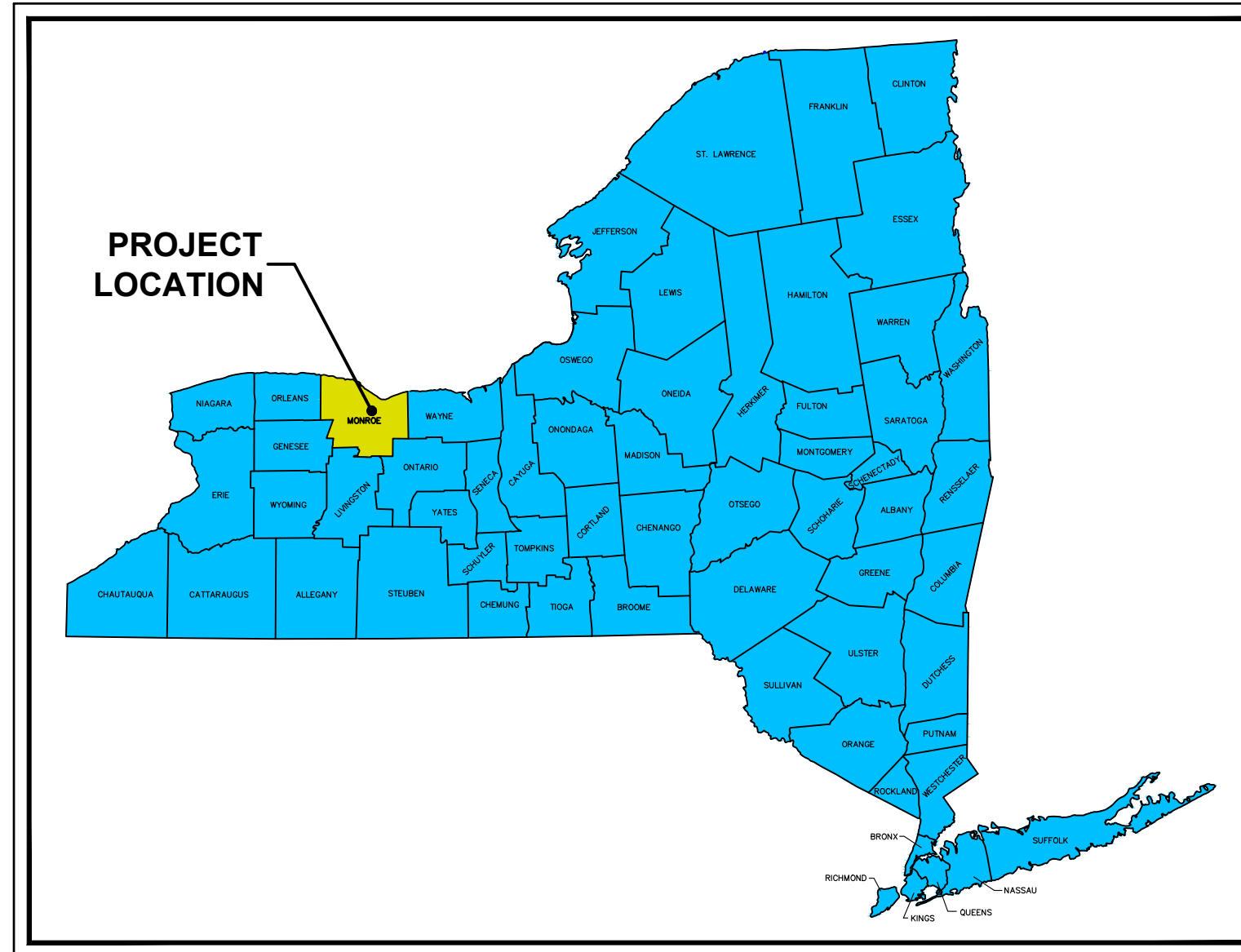

SITE LOCATION MAP
NOT TO SCALE

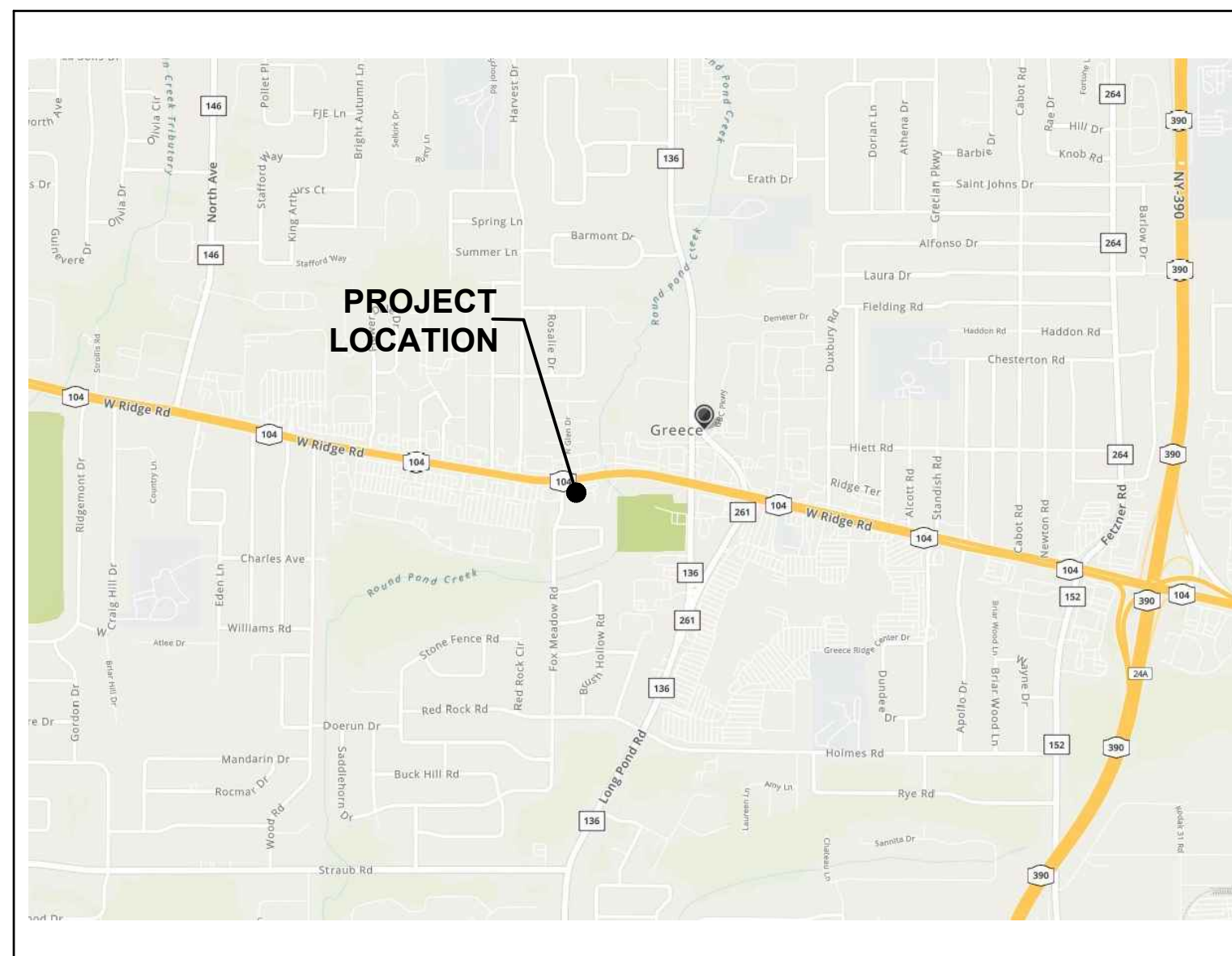

PROJECT LOCATION MAP
NOT TO SCALE

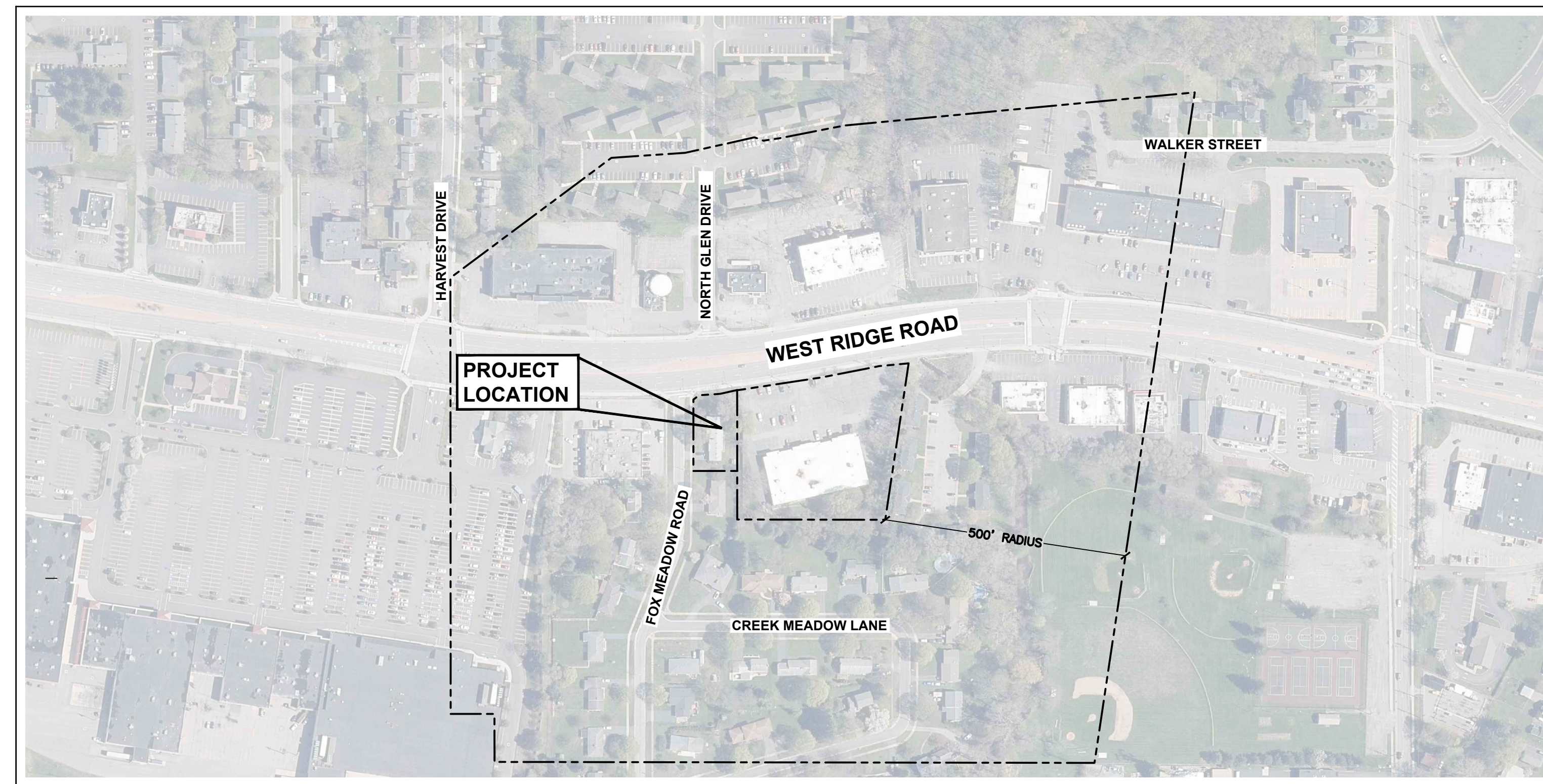
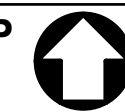

AERIAL MAP
1"=200'



PREPARED BY:



110 FAYETTE STREET
MANLIUS, NEW YORK 13104

email: MNAP@NAPCON.COM
PH: (315) 682-5580 FAX: (315) 682-5544

PREPARED FOR:



4103 NEW COURT AVE
SYRACUSE, NY 13206
(315) 374-6537

APPLICANT:

MR. PETER ELITZER
952 TROY SCHENECTADY ROAD
ROCHESTER, NY 14612
(518) 785-1650

SHEET INDEX:

TITLE SHEET	C-0
GENERAL NOTES	C-1
SITE PREPARATION PLAN	C-2
LAYOUT AND UTILITY PLAN	C-3
GRADING AND EROSION CONTROL PLAN	C-4
LANDSCAPING PLAN	C-5
LIGHTING PLAN	C-6
SITE DETAILS	C-7
SITE DETAILS	C-8
SITE DETAILS	C-9

PLANNING BOARD APPROVAL:

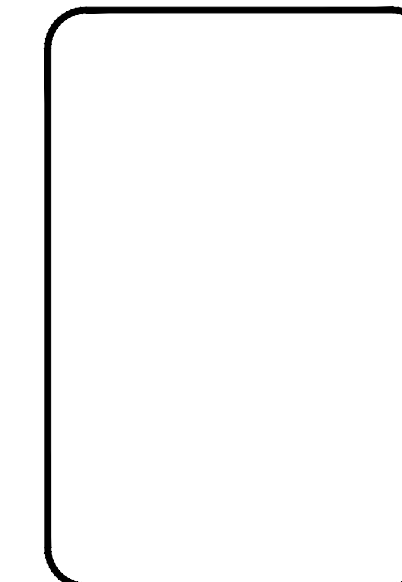

APPROVED BY COMMISSIONER OF
PUBLIC WORKS

NAME DATE

APPROVED BY CHIEF ENGINEER

NAME DATE

APPROVED BY FIRE MARSHALL

NAME DATE

PLANNING
REVIEW ONLY
NOT FOR
CONSTRUCTION



APPROVED BY OWNER

NAME DATE

SHEET TITLE:

TITLE SHEET

NO.	REVISION/ISSUE	DATE

COPYRIGHT © 2022
NAPIERALA CONSULTING

IT IS A VIOLATION OF LAW FOR ANY PERSON, UNLESS
ACTING UNDER THE DIRECTION OF A LICENSED
ARCHITECT, PROFESSIONAL ENGINEER, LANDSCAPE
ARCHITECT, OR LAND SURVEYOR TO ALTER ANY ITEM ON
THIS DOCUMENT IN ANY WAY.

ANY LICENSEE WHO ALTERS THIS DOCUMENT IS
REQUIRED BY LAW TO AFFIX HIS OR HER SEAL AND THE
NOTATION "ALTERED BY" FOLLOWED BY HIS OR HER
SIGNATURE AND SPECIFIC DESCRIPTION OF THE
ALTERATIONS.

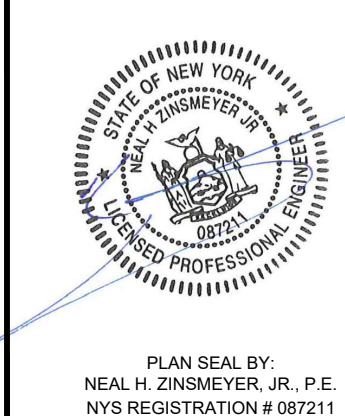

PROJECT NO.
22-2055

DATE
11 FEB 2022

PROPOSED MEDICAL OFFICE

TOWN OF GREECE
JEFFERSON COUNTY, NY

C-0

GENERAL NOTES

- 1. PROPERTY LINE AND SURVEY INFORMATION PROVIDED BY PASSERO ASSOCIATES, PROJECT No. 20213243.001 DATED 10/25/2021.
2. THE PLANS SHOW SUBSURFACE STRUCTURES, ABOVEGROUND STRUCTURES, AND/OR UTILITIES FROM FIELD LOCATION AND RECORD MAPPING.
3. THE ENGINEER SHALL BE NOTIFIED IN WRITING OF ANY CONDITIONS THAT VARY FROM THOSE SHOWN ON THE PLANS.
4. THE CONTRACTOR IS INSTRUCTED TO COOPERATE WITH ANY AND ALL OTHER CONTRACTORS PERFORMING WORK ON THIS JOB SITE DURING THE PERFORMANCE OF THIS CONTRACT.
5. THE CONTRACTOR SHALL RESTORE LAWNS, DRIVEWAYS, CULVERTS, SIGNS, AND OTHER PUBLIC OR PRIVATE PROPERTY DAMAGED OR REMOVED TO AT LEAST AS GOOD A CONDITION AS BEFORE BEING DISTURBED AS DETERMINED BY THE ENGINEER.
6. THE CONTRACTOR SHALL BE RESPONSIBLE FOR OBTAINING AND INCURRING THE COST OF ALL REQUIRED PERMITS, INSPECTIONS, CERTIFICATES, ETC. AND SHALL COMPLY WITH ALL PERMITS.
7. ALL WORK SHALL BE DONE IN STRICT COMPLIANCE WITH ALL APPLICABLE NATIONAL, STATE, AND LOCAL CODES, STANDARDS, ORDINANCES, RULES, AND REGULATIONS.
8. ALL PROPOSED UTILITIES AND APPURTENANCES ARE TO BE CONSTRUCTED IN COMPLIANCE WITH THE LOCAL MUNICIPALITY'S CODES AND REGULATIONS GOVERNING THE INSTALLATION OF SUCH UTILITIES.
9. THE ENGINEER RESERVES THE RIGHT TO EXAMINE ANY WORK DONE ON THIS PROJECT AT ANY TIME TO DETERMINE CONFORMANCE WITH THE REQUIREMENTS OF THE CONTRACT DOCUMENTS OF THIS PROJECT AS INTENDED AND INTERPRETED BY THE ENGINEER.
10. MISCELLANEOUS WORK NOT SPECIFICALLY SHOWN ON THE CONTRACT DRAWINGS SUCH AS PATCHING, BLOCKING, TRIMMING, ETC. SHALL BE PERFORMED AS REQUIRED TO MAKE THE WORK COMPLETE.
11. THE CONTRACTOR SHALL PROTECT EXISTING PROPERTY LINE INFORMATION. ANY MONUMENTATION DISTURBED OR DESTROYED, AS JUDGED BY THE ENGINEER OR OWNER, SHALL BE REPLACED AT THE CONTRACTOR'S EXPENSE UNDER THE SUPERVISION OF A NEW YORK STATE LICENSED LAND SURVEYOR.
12. IT IS THE CONTRACTOR'S RESPONSIBILITY TO EXAMINE ALL PLAN SHEETS AND COORDINATE WORK WITH ALL OTHER CONTRACTS FOR THE SITE.
13. THE CONTRACTOR SHALL:
A. VERIFY ALL CONDITIONS IN THE FIELD PRIOR TO COMMENCEMENT OF WORK AND NOTIFY THE ENGINEER OF ANY DISCREPANCIES.
B. EXAMINE THE SITE AND INCLUDE IN HIS WORK THE EFFECT OF ALL EXISTING CONDITIONS ON THE WORK.
C. PROVIDE AND INSTALL ALL MATERIALS AND PERFORM ALL WORK IN ACCORDANCE WITH RECOGNIZED GOOD STANDARD PRACTICE.
D. HOLD THE OWNER HARMLESS AGAINST ANY AND ALL CLAIMS ARISING FROM WORK DONE BY THE CONTRACTOR ON THE SITE.
14. ALL TRENCH EXCAVATION AND ANY REQUIRED SHEETING AND SHORING SHALL BE DONE IN ACCORDANCE WITH THE LATEST REVISIONS OF NEW YORK STATE INDUSTRIAL CODE RULE 23 AND OSHA REGULATIONS FOR CONSTRUCTION. SHEET PILING SHALL BE DESIGNED AND SEALED BY A NEW YORK STATE PROFESSIONAL ENGINEER.
15. CONTRACTOR SHALL BE RESPONSIBLE FOR DEWATERING AND THE MAINTENANCE OF SURFACE DRAINAGE DURING THE COURSE OF WORK. HE SHALL SUBMIT A DEWATERING PLAN DESIGNED AND SEALED BY A NEW YORK STATE PROFESSIONAL ENGINEER. CONTRACTOR SHALL MAINTAIN EXISTING SITE DRAINAGE PATTERNS THROUGHOUT CONSTRUCTION.
16. ALL BACKFILL USED IN TRENCHES EXCAVATED IN EXISTING ROADWAYS SHALL BE PLACED IN MAXIMUM 6-INCH LIFTS AND COMPACTED BY MEANS OF A MECHANICAL COMPACTOR BETWEEN LIFTS TO 90% STANDARD PROCTOR COMPACTION.
17. WHEN BACKFILLING AROUND PROPOSED OR EXISTING STRUCTURES, MATERIAL SHALL BE PLACED IN MAXIMUM 6-INCH LIFTS AND COMPACTED BY MEANS OF A MECHANICAL COMPACTOR BETWEEN LIFTS TO 90% STANDARD PROCTOR COMPACTION.
18. ALL UTILITY WORK INVOLVING CONNECTIONS TO EXISTING SYSTEMS SHALL BE COORDINATED WITH THE ENGINEER AND THE UTILITY OWNER. NOTIFY THE ENGINEER AND THE UTILITY OWNER 72 HOURS BEFORE EACH AND EVERY CONNECTION TO AN EXISTING SYSTEM IS MADE.
19. CONSTRUCTION OF ALL PROPOSED UTILITIES MUST BEGIN AT ITS POINT OF CONNECTION TO THE EXISTING UTILITY OR AT THE LOWEST POINT IN THE SYSTEM. RIMS, GRATES, INVERTS, CLEARANCES, AND LOCATION AT CROSSINGS MUST BE VERIFIED PRIOR TO THE BEGINNING OF CONSTRUCTION.
20. MAINTAIN FLOW FOR ALL EXISTING UTILITIES.
21. THE CONTRACTOR SHALL BE RESPONSIBLE FOR PROVIDING ALL FIELD LAYOUT. THE CONTRACTOR SHALL TAKE TIES TO ALL UTILITY CONNECTIONS AND PROVIDE MARKED-UP AS-BUILT PLANS FOR ALL UTILITIES SHOWING TIES TO CONNECTIONS, BENDS, VALVES, LENGTHS OF LINES, AND INVERTS. THE OWNER AND HIS REPRESENTATIVES SHALL REVIEW AS-BUILT PLANS SHOWING ALL UNDERGROUND UTILITIES INSTALLED OR ENCOUNTERED. THE CONTRACTOR SHALL PROVIDE ANY CORRECTION OR OMISSIONS TO THE SATISFACTION OF THE OWNER AND HIS REPRESENTATIVES BEFORE UTILITIES WILL BE ACCEPTED.
22. THE CONTRACTOR SHALL MAINTAIN ALL TRAFFIC IN ALL AREAS IN ACCORDANCE WITH THE NYSDOT MANUAL OF UNIFORM TRAFFIC CONTROL DEVICES.
23. THE CONTRACTOR SHALL MAINTAIN ACCESS TO ALL COMMERCIAL, RESIDENTIAL, AND PUBLIC PROPERTIES OR AS DIRECTED BY THE ENGINEER.
24. ALL EXCAVATIONS SHALL BE BACKFILLED TO EXISTING GRADE AT THE END OF EACH WORKDAY.
25. THE CONTRACTOR SHALL TAKE CARE TO PREVENT DAMAGE TO EXISTING UTILITIES. DAMAGED UTILITIES SHALL BE IMMEDIATELY REPAIRED BY THE CONTRACTOR AT THE CONTRACTOR'S EXPENSE.

SITE DEMOLITION NOTES

- 1. THE GENERAL CONSTRUCTION CONTRACTOR RESPONSIBLE FOR DEMOLITION WORK AS NOTED ON THIS PLAN.
2. EXISTING FEATURES ARE BASED ON A SURVEY BY PASERO ASSOCIATES.
3. OWNER WILL PROVIDE AN 'ALL CLEAR' PRIOR TO DEMOLITION.
4. THE CONTRACTOR SHALL CONTACT DIG SAFELY NEW YORK AT 811 FOR UTILITY STAKEOUTS A MINIMUM OF THREE (3) BUSINESS DAYS PRIOR TO ANY DEMOLITION WORK, SITE WORK, OR EXCAVATION.
5. THE CONTRACTOR SHALL COORDINATE WITH ALL PUBLIC AND PRIVATE UTILITIES FOR RESPECTIVE REQUIREMENTS FOR THE REMOVAL/ABANDONMENT OF UTILITY MAINS/LATERALS SERVICING THE SITE.

GRADING NOTES

- 1. MAXIMUM SLOPE FOR ALL CUT AND FILL LAWN AREAS SHALL BE 3H:1V UNLESS SHOWN OTHERWISE ON PLANS.
2. SLOPES GREATER THAN 4H:1V SHALL BE STABILIZED IMMEDIATELY AFTER GRADING OCCURS IN ACCORDANCE WITH THE NEW YORK STANDARDS AND SPECIFICATIONS FOR EROSION AND SEDIMENT CONTROL.
3. UNLESS OTHERWISE NOTED, LIMITS OF DISTURBANCE ARE AS REPRESENTED BY PROPOSED GRADES. NO GRADING SHALL TAKE PLACE BEYOND LIMITS SHOWN.
4. CONTRACTOR SHALL NOT DISTURB GREATER THAN ONE (1) ACRE OF SOIL.

TOWN OF GREECE STANDARD NOTES

- a. NO BUILDING PERMITS SHALL BE ISSUED UNLESS AND UNTIL HIGHWAY PERMITS ARE ISSUED.
b. THE DEVELOPER/CONTRACTOR IS RESPONSIBLE FOR REMOVAL AND DISPOSAL OF BRUSH, TREES, AND DEBRIS FROM ANY LOT CLEARING.
c. APPROVAL IS FOR ONLY THOSE ITEMS IDENTIFIED AS "NEW" OR "PROPOSED" ON THE SITE PLAN. GRANTING APPROVAL OF THIS SITE PLAN DOES NOT SUPERSEDE ANY OTHER CONDITIONS IMPOSED BY THE TOWN OF GREECE OR ANY OTHER AGENCY.
d. ANY TOWN OF GREECE APPROVAL OR PERMIT FOR THE PREMISES DOES NOT RELIEVE THE APPLICANT, DEVELOPER, OR OWNER OF THE PREMISES FROM OBTAINING ALL OTHER TOWN, COUNTY, STATE, OR FEDERAL GOVERNMENT APPROVALS OR PERMITS THAT ARE REQUIRED FOR THE PREMISES.
e. THE LANDSCAPING ON THE PREMISES SHALL BE MAINTAINED BY THE CURRENT OWNER OF THE PREMISES, AND BY ANY FUTURE OWNER. THE OWNER OF THE PREMISES SHALL REPLACE ANY DEAD PLANTS WITH THE SAME SPECIES OR A SIMILAR SPECIES. THE REPLACEMENT PLANT SHALL BE NO SMALLER THAN THE PREVIOUS PLANT WHEN IT ORIGINALLY WAS INSTALLED.
f. PRIOR TO THE ISSUANCE OF A FINAL CERTIFICATE OF OCCUPANCY FOR THE PREMISES, THE APPLICANT SHALL PROVIDE CERTIFICATION VERIFYING PROPER INSTALLATION OF LANDSCAPE AREAS ON THE SITE IN ACCORDANCE WITH THE LANDSCAPE PLAN APPROVED BY THE PLANNING BOARD, AND IN ACCORDANCE WITH THE TOWN'S LANDSCAPE GUIDELINES FOR DEVELOPMENT. SAID CERTIFICATION SHALL BE ON THE CERTIFICATION FORM PROVIDED IN SAID GUIDELINES AND SHALL BE COMPLETED BY A [NEW YORK STATE LICENSED LANDSCAPE ARCHITECT / CERTIFIED NURSERY PROFESSIONAL].
g. ALL HEATING, VENTILATING, AND AIR CONDITIONING (HVAC) EQUIPMENT SHALL BE SCREENED FROM PUBLIC VIEW.
h. LIGHT SPILL SHALL BE CONTAINED ON THE PREMISES. OUTDOOR LIGHT SOURCES SHALL BE AIMED OR SHIELDED SO THAT THEY ARE NOT VISIBLE WHEN VIEWED FROM OFF THE PREMISES, AND SO THAT LIGHT SPILL IS CAST ONLY DOWNWARD ONTO THE PREMISES. EXEMPT FROM THIS REQUIREMENT ARE LOW-WATTAGE LIGHTS THAT ARE LOCATED NEAR THE PRINCIPAL ENTRANCE TO A BUILDING, AND LOW-WATTAGE LIGHTS, NOT HIGHER THAN 42 INCHES ABOVE GRADE, THAT DEFINE A WALKWAY OR OTHER ACCESS TO A BUILDING.
i. WATER MAINS AND HYDRANTS SHALL BE INSTALLED AND BE IN PROPER OPERATING CONDITIONS PRIOR TO THE COMMENCEMENT OF ANY ABOVEGROUND CONSTRUCTION.
j. SUITABLE ACCESS ROADS AND TEMPORARY STREET SIGNS SHALL BE INSTALLED AND MAINTAINED SO AS TO PROVIDE CONTINUOUS ACCESS TO FIRE DEPARTMENT AND OTHER EMERGENCY VEHICLES PRIOR TO THE COMMENCEMENT OF ANY ABOVEGROUND CONSTRUCTION.
k. PERMANENTLY MOUNTED "NO PARKING - FIRE LANE" SIGNS SHALL BE POSTED ALONG THE FIRE LANES AT INTERVALS OF 50 FEET OR LESS.
l. (FOR MULTI-FAMILY RESIDENTIAL SITE PLANS ONLY): THE TOWN'S 2001 COMMUNITY MASTER PLAN UPDATE (CLOUGH, HARBOUR & ASSOCIATES, SEPTEMBER 2001) CONTAINS CURRENT AND PROJECTED POPULATION GROWTH; AN INVENTORY AND ANALYSIS OF PUBLIC, PRIVATE, AND SEMI-PRIVATE RECREATION FACILITIES, BOTH ACTIVE AND PASSIVE; AND RECOMMENDATIONS FOR FUTURE ACTIONS. BASED ON THIS DOCUMENT, THE PLANNING BOARD FINDS THAT THE TOWN CURRENTLY NEEDS, OR WILL NEED, ADDITIONAL PARK AND RECREATION SPACE IN THE VICINITY OF THE PROPOSAL. THE PLANNING BOARD FURTHER FINDS THAT DEVELOPMENT OF THESE APARTMENTS WILL CONTRIBUTE TO THE DEMAND FOR ADDITIONAL PARK AND RECREATION SPACE, AND THAT THIS APARTMENT DEVELOPMENT PROVIDES NO SUITABLE PARK OR RECREATION LAND TO ADDRESS SAID CURRENT OR FUTURE NEED. THEREFORE, PURSUANT TO SECTION 274-A OF THE NEW YORK STATE TOWN LAW, PAYMENT OF THE TOWN'S RECREATION FEE SHALL BE REQUIRED FOR DWELLING UNIT IN THIS APARTMENT DEVELOPMENT, PAYABLE TO THE TOWN UPON THE ISSUANCE OF THE ORIGINAL BUILDING PERMIT FOR EACH DWELLING UNIT.
m. NO SITE WORK SHALL COMMENCE UNLESS AND UNTIL A PRE-GRADING AND/OR PRE-CONSTRUCTION MEETING HAS TAKEN PLACE INVOLVING THE TOWN DEPARTMENTS OF PUBLIC WORKS, ENGINEERING, AND/OR TECHNICAL SERVICES.
n. NO BUILDING PERMITS SHALL BE ISSUED UNLESS AND UNTIL THE APPLICANT EXECUTES AN AGREEMENT FOR MAINTENANCE OF THE PROPOSED STORM WATER MANAGEMENT POND. SAID AGREEMENT SHALL BE SUBJECT TO APPROVAL BY THE PLANNING BOARD'S ATTORNEY AND THE COMMISSIONER OF PUBLIC WORKS.
o. UPON COMPLETION OF CONSTRUCTION OF THE STORM WATER POND, THE APPLICANT SHALL PROVIDE CERTIFICATION THAT THE POND WAS CONSTRUCTED AS DESIGNED AND APPROVED. SAID CERTIFICATION SHALL BE PROVIDED IN THE FORM OF AN AS-BUILT TOPOGRAPHIC SURVEY WITH PERTINENT UTILITY STRUCTURES SHOWN, PREPARED BY A NEW YORK STATE LICENSED LAND SURVEYOR. NO FINAL APPROVAL SIGNATURES SHALL BE PLACED ON THE SITE PLAN UNLESS AND UNTIL THE APPLICANT HAS SUBMITTED TO THE TOWN A FINANCIAL GUARANTEE (SUCH AS A LETTER OF CREDIT, CERTIFIED CHECK, OR OTHER ACCEPTABLE INSTRUMENT), IN AN AMOUNT APPROVED BY THE TOWN'S COMMISSIONER OF PUBLIC WORKS AND THE TOWN ATTORNEY, THAT IS SUFFICIENT TO PROPERLY CONSTRUCT THE PROPOSED POND, AND TO PROVIDE THE AFOREMENTIONED CERTIFICATION. NO RELEASE OF SAID FINANCIAL GUARANTEE SHALL BE MADE UNLESS AND UNTIL THE IMPROVEMENTS AND CERTIFICATION ARE COMPLETED TO THE SATISFACTION OF THE TOWN'S COMMISSIONER OF PUBLIC WORKS AND THE TOWN ATTORNEY.

UTILITY NOTES

- 1. ALL CONSTRUCTION SHALL CONFORM WITH APPROPRIATE CODE AND REGULATORY REQUIREMENTS.
2. ALL UTILITIES SHALL BE INSTALLED IN ACCORDANCE WITH MUNICIPAL REGULATIONS AND THE STANDARDS OF THE PRIVATE UTILITY COMPANIES.
3. PRIVATE UTILITY SERVICE FINAL LOCATION, SIZE AND DEPTH ARE SUBJECT TO THE APPROVAL OF THE UTILITY COMPANY.
4. EXTERIOR BUILDING LIGHTING LUMINAIRES SHALL BE OF SIZE AND TYPE, AND AT LOCATIONS SPECIFIED BY THE ARCHITECTS ELECTRICAL SITE PLAN AND SHALL CONFORM TO THE MUNICIPAL ZONING REQUIREMENTS.
5. STORM DRAINAGE
STORM DRAINAGE PIPING SHALL BE SMOOTH INTERIOR CORRUGATED PLASTIC PIPE (SICPP) UNLESS OTHERWISE NOTED (SICPP). PIPE JOINTS AND FITTINGS SHALL CONFORM TO AASHTO M252 OR AASHTO M294.
6. ELECTRIC AND GAS
ALL ELECTRIC AND GAS INSTALLATION SHALL BE COORDINATED WITH NATIONAL GRID.

LEGEND: PROPOSED (SEE EXISTING CONDITION SURVEY FOR LEGEND OF EXISTING ELEMENTS)

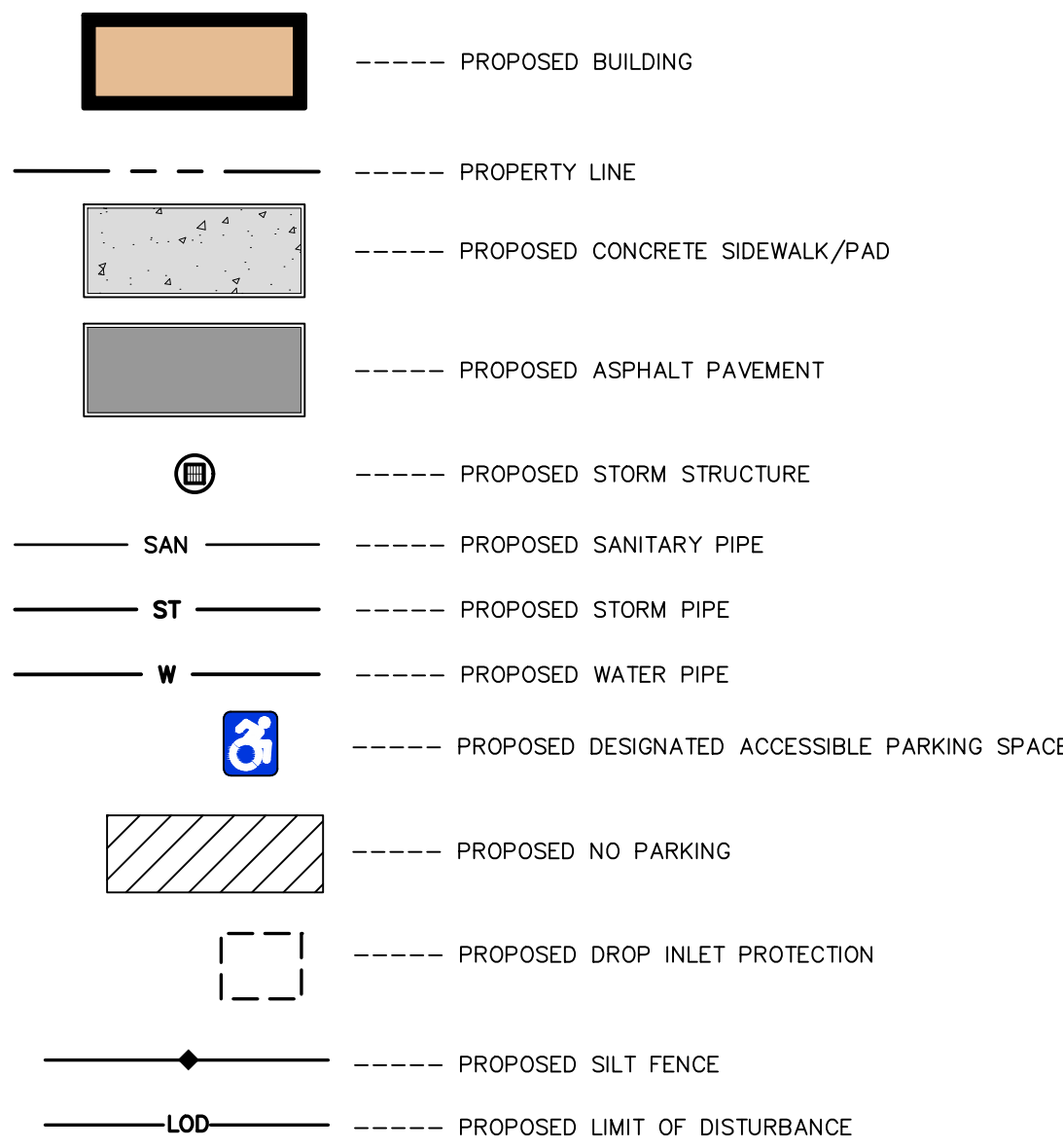

LANDSCAPE NOTES

TEMPORARY SEEDING MIXTURES
PERMANENT SEEDING MIXTURES
FOR SPRING, SUMMER OR EARLY FALL SEEDINGS:
LBS./ACRE LBS./1000 SQ. FT.
CREEPING RED FESCUE (var. ENSYLVA) 10
PERENNIAL RYE GRASS (var. PENNFINE) 10
SEED MIXTURE NO. 2
SWITCHGRASS (var. SHELTER, PATHFINDER, TRAILBLAZER, OR BLACKWELL) 20
FOR LATE FALL OR EARLY WINTER
A. WINTER RYE (AROSTOOK) 100 2.50
SEED MIXTURE NO. 3
BIRDSFOOT TREFOIL (var. EMPIRE, PARDEE) 10
REDTOP 2
TALL FESCUE (var. KY 31, REBEL) 20
SEED MIXTURE NO. 4
CREEPING RED FESCUE (var. ENSYLVA) 20
CHEWNGS FESCUE (COMMON) 20
PERENNIAL RYE GRASS (var. PENNFINE) 5
RED CLOVER (COMMON) 10
SEED MIXTURE 1 TO BE APPLIED TO SHADED AREAS.
SEED MIXTURE 2 IS IN PURE LIVE SEED. TO BE APPLIED TO AREAS UPLAND OF WETLANDS AND ALONG STORMWATER MITIGATION BASIN BANKS.
SEED MIXTURE 3 TO BE APPLIED TO ALL SWALES AND WATERWAYS. WHITE CLOVER OR LADINO CLOVER MAY BE SUBSTITUTED FOR BIRDSFOOT TREFOIL AND SEEDED AT THE SAME RATE. PERENNIAL RYEGRASS MAY BE SUBSTITUTED FOR REDTOP BUT INCREASE SEEDING RATE TO 5 LBS./ACRE (0.1 LBS./1000 SQ. FT)
SEED MIXTURE 4 TO BE APPLIED TO ALL AREAS. (NOT FOR USE IN PLAYGROUNDS OR AS TURF)
METHOD OF SEEDING
BROADCAST, DRILLING WITH A CULTIPACK TYPE SEEDER, OR HYDROSEEDING ARE ACCEPTABLE. GOOD SOIL TO SEED CONTACT IS THE KEY TO SUCCESSFUL SEEDINGS.
MULCHING
APPLY STRAW MULCH AT A RATE OF 2 TON/ACRE (90 LBS./1,000 SF) ANCHORED WITH WOOD FIBER MULCH (HYDROMULCH) AT 500 - 750 LBS./ACRE (11 - 17 LBS./1,000 SF). THE WOOD FIBER MULCH MUST BE APPLIED THROUGH A HYDROSEEDER AFTER MULCHING.
IRRIGATION
WATERING MAY BE ESSENTIAL TO ESTABLISH TO NEW SEEDING. WEATHER CONDITIONS WILL DICTATE WHEN TO WATER. EACH APPLICATION MUST BE UNIFORMLY APPLIED AND 1 TO 2 INCHES OF WATER SHOULD BE APPLIED PER APPLICATION.
PERMANENT SEEDING TO OCCUR AFTER FINAL GRADING HAS OCCURRED. PERMANENT SEEDING WILL INCLUDE:
A. SCARIFY ALL COMPACT, SLOWLY PERMEABLE, MEDIUM AND FINE TEXTURED SUBSOIL AREAS. SCARIFY AT APPROXIMATELY RIGHT ANGLES TO THE SLOPE DIRECTION IN SOIL AREAS THAT ARE STEEPER THAN 5 PERCENT.
B. REMOVE REFUSE, WOOD PLANT PARTS, STONES OVER 3 INCHES IN DIAMETER, AND OTHER LITTER.
TOPSOIL MATERIALS
A. TOPSOIL SHALL HAVE AT LEAST 2 PERCENT AND NO GREATER THAN 6 PERCENT BY WEIGHT OF FINE TEXTURED STABLE ORGANIC MATERIAL.
B. TOPSOIL SHALL HAVE NOT LESS THAN 20 PERCENT FINE TEXTURED MATERIAL (PASSING THE NO. 200 SIEVE) AND NOT MORE THAN 15 PERCENT CLAY.
C. TOPSOIL TREATED WITH SOIL STERILANTS OR HERBICIDES SHALL BE SO IDENTIFIED TO THE PURCHASER.
D. TOPSOIL SHALL BE RELATIVELY FREE OF STONES OVER 1 1/2 INCHES IN DIAMETER, TRASH, NOXIOUS WEEDS SUCH AS NUTSEDGE AND QUACKGRASS, AND WILL HAVE LESS THAN 10% GRAVEL BY VOLUME.
E. TOPSOIL CONTAINING SOLUBLE SALTS GREATER THAN 500 PPM SHALL NOT BE USED.
APPLICATION AND GRADING
A. TOPSOIL SHALL BE DISTRIBUTED TO A UNIFORM DEPTH OVER THE AREA. IT SHALL NOT BE PLACED WHEN IT IS PARTLY FROZEN, MUDDY, OR ON FROZEN SLOPES OR OVER ICE, SNOW, OR STANDING WATER PUDDLES.
B. TOPSOIL PLACED AND GRADED ON SLOPES STEEPER THAN 5% SHALL BE PROMPTLY FERTILIZED, SEEDDED, MULCHED AND STABILIZED BY "TRACKING" WITH SUITABLE EQUIPMENT.
C. A MINIMUM OF 4 INCHES OF TOPSOIL IS TO BE USED IN ALL AREAS.
SOIL AMENDMENTS
A. LIME TO A pH OF 7.0. LIME IS NOT TO BE APPLIED WITHIN 50 FEET OF STREAMS AND WETLANDS.
B. FERTILIZER APPLICATION RATE TO BE BASED ON SOIL TESTS.
1. IN NO CASE SHALL FERTILIZER BE APPLIED BETWEEN DECEMBER 1 AND APRIL 1 ANNUALLY.
2. FERTILIZER SHALL NOT BE SPREAD WITHIN 20 FEET OF A SURFACE WATER.
3. ANY FERTILIZER FALLING OR SPILLED INTO IMPERVIOUS SURFACE AREAS SUCH AS PARKING LOTS, ROADWAYS, AND SIDEWALKS SHALL BE IMMEDIATELY CONTAINED AND LEGALLY APPLIED OR PLACED IN AN APPROPRIATE CONTAINER.
4. INCORPORATE THE FERTILIZER, AND LIME IF SPECIFIED, INTO THE TOP 2 - 4 INCHES OF THE TOPSOIL OR SOIL PROFILE.
5. WHEN APPLYING FERTILIZER BY HYDROSEEDING CARE SHOULD BE TAKEN TO APPLY MIX ONLY TO SEED BED AREAS AT AN APPROPRIATE FLOW RATE TO PREVENT EROSION AND SPRAYING ONTO IMPERVIOUS AREAS.

PERMANENT SEEDING TO OCCUR AFTER FINAL GRADING HAS OCCURRED. PERMANENT SEEDING WILL INCLUDE:
A. SCARIFY ALL COMPACT, SLOWLY PERMEABLE, MEDIUM AND FINE TEXTURED SUBSOIL AREAS. SCARIFY AT APPROXIMATELY RIGHT ANGLES TO THE SLOPE DIRECTION IN SOIL AREAS THAT ARE STEEPER THAN 5 PERCENT.
B. REMOVE REFUSE, WOOD PLANT PARTS, STONES OVER 3 INCHES IN DIAMETER, AND OTHER LITTER.
TOPSOIL MATERIALS
A. TOPSOIL SHALL HAVE AT LEAST 2 PERCENT AND NO GREATER THAN 6 PERCENT BY WEIGHT OF FINE TEXTURED STABLE ORGANIC MATERIAL.
B. TOPSOIL SHALL HAVE NOT LESS THAN 20 PERCENT FINE TEXTURED MATERIAL (PASSING THE NO. 200 SIEVE) AND NOT MORE THAN 15 PERCENT CLAY.
C. TOPSOIL TREATED WITH SOIL STERILANTS OR HERBICIDES SHALL BE SO IDENTIFIED TO THE PURCHASER.
D. TOPSOIL SHALL BE RELATIVELY FREE OF STONES OVER 1 1/2 INCHES IN DIAMETER, TRASH, NOXIOUS WEEDS SUCH AS NUTSEDGE AND QUACKGRASS, AND WILL HAVE LESS THAN 10% GRAVEL BY VOLUME.
E. TOPSOIL CONTAINING SOLUBLE SALTS GREATER THAN 500 PPM SHALL NOT BE USED.
APPLICATION AND GRADING
A. TOPSOIL SHALL BE DISTRIBUTED TO A UNIFORM DEPTH OVER THE AREA. IT SHALL NOT BE PLACED WHEN IT IS PARTLY FROZEN, MUDDY, OR ON FROZEN SLOPES OR OVER ICE, SNOW, OR STANDING WATER PUDDLES.
B. TOPSOIL PLACED AND GRADED ON SLOPES STEEPER THAN 5% SHALL BE PROMPTLY FERTILIZED, SEEDDED, MULCHED AND STABILIZED BY "TRACKING" WITH SUITABLE EQUIPMENT.
C. A MINIMUM OF 4 INCHES OF TOPSOIL IS TO BE USED IN ALL AREAS.
SOIL AMENDMENTS
A. LIME TO A pH OF 7.0. LIME IS NOT TO BE APPLIED WITHIN 50 FEET OF STREAMS AND WETLANDS.
B. FERTILIZER APPLICATION RATE TO BE BASED ON SOIL TESTS.
1. IN NO CASE SHALL FERTILIZER BE APPLIED BETWEEN DECEMBER 1 AND APRIL 1 ANNUALLY.
2. FERTILIZER SHALL NOT BE SPREAD WITHIN 20 FEET OF A SURFACE WATER.
3. ANY FERTILIZER FALLING OR SPILLED INTO IMPERVIOUS SURFACE AREAS SUCH AS PARKING LOTS, ROADWAYS, AND SIDEWALKS SHALL BE IMMEDIATELY CONTAINED AND LEGALLY APPLIED OR PLACED IN AN APPROPRIATE CONTAINER.
4. INCORPORATE THE FERTILIZER, AND LIME IF SPECIFIED, INTO THE TOP 2 - 4 INCHES OF THE TOPSOIL OR SOIL PROFILE.
5. WHEN APPLYING FERTILIZER BY HYDROSEEDING CARE SHOULD BE TAKEN TO APPLY MIX ONLY TO SEED BED AREAS AT AN APPROPRIATE FLOW RATE TO PREVENT EROSION AND SPRAYING ONTO IMPERVIOUS AREAS.

PROPOSED MEDICAL OFFICE
TOWN OF GREECE
MONROE CO., NY
PREPARED FOR: WHELAN & CURRY CONSTRUCTION SERVICES, INC
4105 NEW COURT AVE
SYRACUSE, NY 13206

GENERAL NOTES
PROJECT TITLE:
SHEET TITLE:

Table with 3 columns: NO., DATE, REVISION/ISSUE

PLANNING REVIEW ONLY NOT FOR CONSTRUCTION
NAPERALE CONSULTING
PROFESSIONAL ENGINEER, P.E.
SUITE • DESIGN • ENGINEERING
110 FAYETTE STREET
MANLIUS, NEW YORK, 13104
email: MNAAP@NAPCON.COM
PH: (315) 682-5880 FAX: (315) 682-5844

22-2055
11 FEB 2022
AS NOTED
C-1
PROJECT NO.
DATE
SCALE
SHEET

APPLICANT
MR. PETER ELITZER
952 TROY SCHENECTADY ROAD
ROCHESTER, NY 14612
(518) 785-1650

Professional Engineer Seal for Neal M. Napack, No. 09219, State of New York.

Professional Engineer Seal for Neal M. Napack, No. 09219, State of New York.



PROJECT TITLE:
PROPOSED MEDICAL OFFICE
 TOWN OF GREECE
 PREPARED FOR:
WHELAN & CURRY CONSTRUCTION SERVICES, INC
 4105 NEW COURT AVE
 SYRACUSE, NY 13206

SHEET TITLE:
SITE PREPARATION PLAN

NO.	REVISION/ISSUE	DATE

PREPARED BY:
NAPERALA CONSULTING
 PROFESSIONAL ENGINEER, P.C.
 SUITE • DESIGN • ENGINEERING
 110 FAYETTE STREET
 MANLIUS, NEW YORK 13104
 email: MNA@NAPCON.COM
 PH: (315) 682-5860 FAX: (315) 682-5544

PROJECT NO.	22-2055
DATE	11 FEB 2022
SCALE	1"=20'

APPLICANT
 MR. PETER ELITZER
 952 TROY SCHENECTADY ROAD
 ROCHESTER, NY 14612
 (518) 785-1650

PLANNING REVIEW ONLY
 NOT FOR CONSTRUCTION

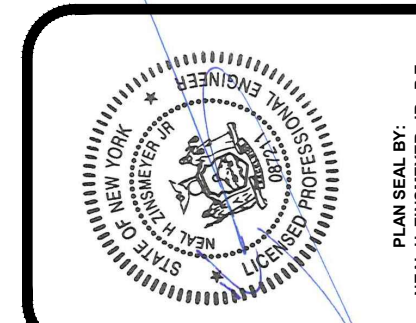

COPYRIGHT © 2022
 NAPERALA CONSULTING
 IT IS A VIOLATION OF LAW FOR ANY
 PERSON TO REPRODUCE OR TRANSMIT
 IN ANY FORM OR BY ANY MEANS
 WITHOUT THE WRITTEN PERMISSION
 OF NAPERALA CONSULTING.
 ANY LICENSEE WHO ALTERS THIS
 DOCUMENT OR ANY PART THEREOF
 WITHOUT THE WRITTEN PERMISSION
 OF NAPERALA CONSULTING SHALL
 BE SUBJECT TO THE PENALTIES
 SPECIFICALLY DESCRIBED IN THE
 EMBLEM.

C-2

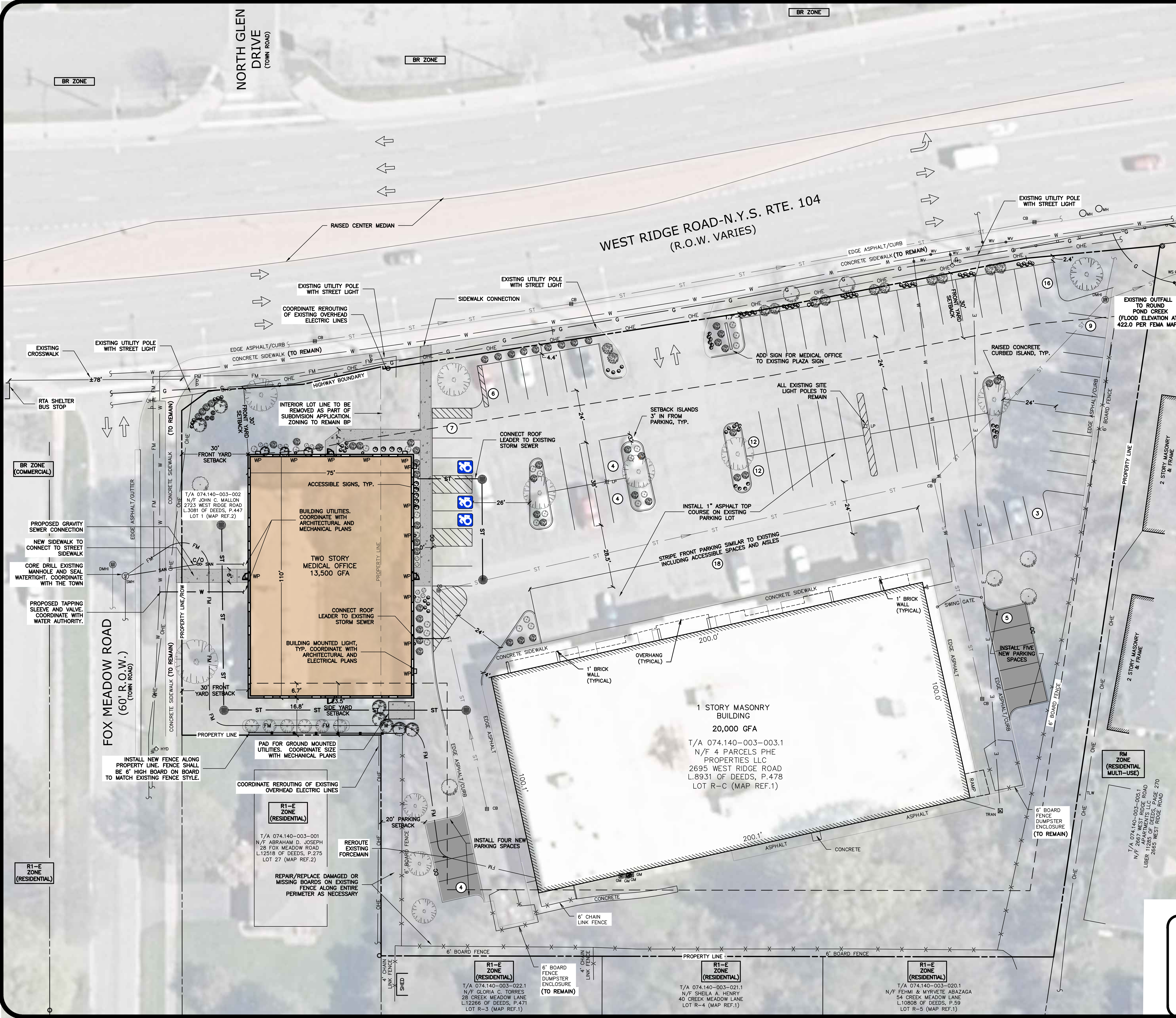

SITE CRITERIA CHECKLIST		
PROJECT SITE INFORMATION		
ADDRESS	2723 & 2695 WEST RIDGE ROAD ROCHESTER, NY 14626 TOWN OF GREECE	
TAX MAP ID NO.	074.140-003-002 & 074.140-003-003.1	
TOTAL SITE AREA ²	110,545 (2.53 ACRES)	
LAND USE ¹	MEDICAL (PERMITTED USE)	
BUILDING SIZE ¹	13,500 GFA	
ZONING INFORMATION		
ZONING DISTRICT ¹	BUSINESS PROFESSIONAL (BP)	
	REQUIRED	PROVIDED
BUILDING HEIGHT ¹	2 STORIES/40' MAX.	2 STORIES/28.5'
MIN. LOT AREA ²	15,000 SF	110,545 SF
MIN. LOT WIDTH ²	100'	>400'
MIN. LOT DEPTH ²	120'	>260'
MAX LOT COVERAGE ²	50%	26%
IMPERVIOUS AREA ²	N/A	69%
FRONT YARD SETBACK ¹	30'	30'
SIDE YARD SETBACK	N/A ¹ 15 ³	N/A ¹ NO CHANGE ³
REAR YARD SETBACK ¹ (ADJOINING RESIDENTIAL)	20'+ ONE FOOT FOR EVERY 1,000 SF OF GFA IN EXCESS OF 10,000 SF. = 23.5'	*16.8'
PARKING SPACES ²	RETAIL: 4 SPACES PER 1,000 GFA 4 X 20 = 80 SPACES MEDICAL: 5 SPACES PER 1,000 GFA 5 X 13.5 = 68 SPACES TOTAL = 148 SPACES	**100 SPACES
PARKING SPACE SIGN INFORMATION	9'X18'	9'X18'
ONE ATTACHED SIGN PER BUSINESS MAXIMUM SIZE OF SIGN FOR EACH 10' OF BUSINESS FRONTAGE, TOTAL SQUARE FOOTAGE SHALL NOT EXCEED 50SF		

ZONING NOTES:
 1. ZONING INFORMATION AS PROVIDED IN THE CHART REFERS TO THE BP ZONE AND PROPOSED MEDICAL OFFICE PROJECT.
 2. ZONING INFORMATION AS PROVIDED IN THE CHART REFERS TO THE PROJECT UPON SUBDIVISION/LOT CONSOLIDATION INTO ONE PARCEL.
 3. ZONING INFORMATION AS PROVIDED IN THE CHART REFERS TO THE BR ZONE

*AREA VARIANCE FOR SIDE YARD SETBACK SUBMITTED TO ZBA ON 2/11/22
 **AREA VARIANCE FOR PARKING SPACES SUBMITTED TO ZBA ON 2/11/22

PROJECT NOTES:
 1. THIS IS A SINGLE PHASE PROJECT

PROPOSED MEDICAL OFFICE
 TOWN OF GREECE
 PREPARED FOR:
WHELAN & CURRY CONSTRUCTION SERVICES, INC
 4105 NEW COURT ACE
 SYRACUSE, NY 13206

LAYOUT AND UTILITY PLAN

NO.	REVISION/ISSUE	DATE

PREPARED BY:
NAPERALA CONSULTING
 PROFESSIONAL ENGINEER, P.E.
 SUITE • DESIGN • ENGINEERING
 MANLIUS, NEW YORK, 13104
 email: MNAPE@NAPCON.COM
 PH: (315) 682-5580 FAX: (315) 682-5544

APPLICANT
 MR. PETER ELITZER
 952 TROY SCHENECTADY ROAD
 ROCHESTER, NY 14612
 (518) 785-1650

PLANNING REVIEW ONLY NOT FOR CONSTRUCTION

22-2055
 11 FEB 2022
 1"=20'

PROJECT NO.
 DATE
 SCALE
 SHEET

C-3

WEST RIDGE ROAD-N.Y.S. RTE. 104
(R.O.W. VARIES)

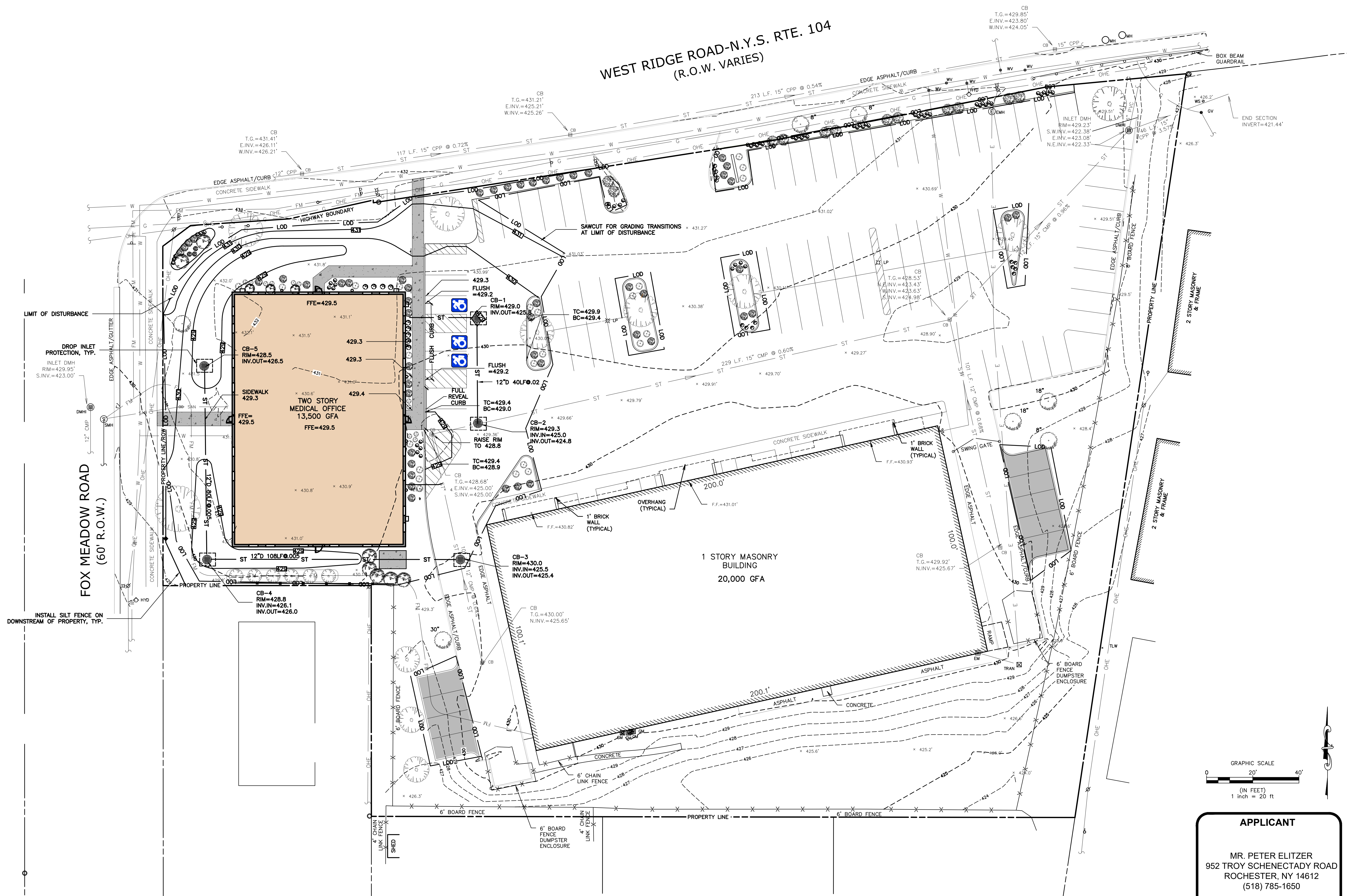

FOX MEADOW ROAD
(60' R.O.W.)

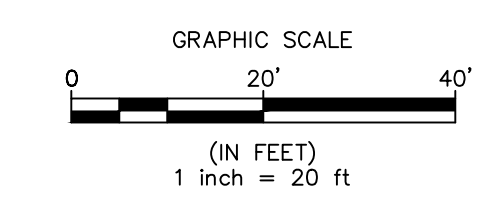

APPLICANT

MR. PETER ELITZER
952 TROY SCHENECTADY ROAD
ROCHESTER, NY 14612
(518) 785-1650

**PLANNING REVIEW ONLY
NOT FOR CONSTRUCTION**

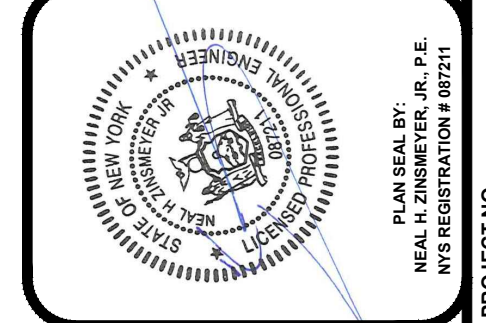

COPYRIGHT © 2022
NAPIERALA CONSULTING
IT IS A VIOLATION OF LAW FOR ANY
REPRODUCTION OR TRANSMISSION
IN ANY FORM OR BY ANY MEANS,
ELECTRONIC OR MECHANICAL,
INCLUDING PHOTOCOPYING, RECORDING,
OR BY ANY INFORMATION STORAGE
RETRIEVAL SYSTEM, WITHOUT THE
WRITTEN PERMISSION OF THE
COPYRIGHT OWNER.
ANY LICENSEE WHO ALTERS THIS
DOCUMENT IS SUBJECT TO THE
PENALTIES AND SANCTIONS PROVIDED
IN SECTION 1703 OF THE
ELECTRONIC SIGNATURE ACT.

PROJECT TITLE:
PROPOSED MEDICAL OFFICE
TOWN OF GREECE
PREPARED FOR:
WHELAN & CURRY CONSTRUCTION SERVICES, INC
4105 NEW COURT AGE
SYRACUSE, NY 13206

SHEET TITLE:
GRADING AND EROSION CONTROL PLAN

NO.	REVISION/ISSUE	DATE

PREPARED BY:
NAPIERALA CONSULTING
PROFESSIONAL ENGINEER, P.E.
SPECIALTY: DESIGN • ENGINEERING
MANHATTAN, NEW YORK, 13104
email: MNAP@NAPCON.COM
PH: (315) 682-5580 FAX: (315) 682-5544

PROJECT NO.: 22-2055
DATE: 11 FEB 2022
SCALE: 1"=20'
C-4

KEY	QUANTITY	LATIN NAME	COMMON NAME	CALIPER	HEIGHT	ROOT
EVERGREEN TREES						
EA	6	PICEA ABEIS 'CUPRESSINA'	COLUMNAR NORWAY SPRUCE	-	6'	-
JV	7	JUNIPERUS VIRGINIANA	SKYROCKET JUNIPER	-	5'	-
ORNAMENTAL TREES						
AC	1	ACER CAMPESTRE	HEDGE MAPLE	2"	-	-
AG	4	AMEL. GRANDIFLORA	ROBIN HILL SERVICEBERRY	3 CLUMP	6'	-
CC	3	CERCIS CANADENSIS	EASTERN REDBUD	2"	-	-
SHRUBS/PLANTS						
SD	43	STELLA D'ORO	DAYLILY	-	-	3 GAL.
TO	6	THUJA OCCIDENTALIS	FIRE CHIEF ARBORVITAE	-	-	3 GAL.
FO	13	PHYSCARPUS OPUL.	NINEBARK TINY WINE	-	-	3 GAL.
SB	27	SPIRAEA BUMALDA	GOLD FLAME	-	-	5 GAL.
AB	2	ARONIA 'BRILLIANT'	CHOKEBERRY	-	-	5 GAL.
BY	33	BUXUS	GREEN VELVET BOXWOOD	-	-	3 GAL.
LS	28	LIRIOPE SPICATA	LILYTURF	-	-	3 GAL.
IL	10	ILEX VERTICILLATA	WINTERBERRY HOLLY	-	-	3 GAL.
HY	5	TAXUS MEDIA	UPRIGHT YEW	-	24"	-
GRASSES						
CA	9	CALAMAGROSTIS	KARL FOERSTER GRASS	-	-	2 GAL.

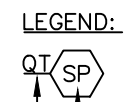
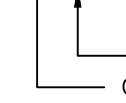
LEGEND:
 SPECIES KEY
 QUANTITY

GENERAL LANDSCAPING NOTES:

1. ALL TREES AND SHRUBS SHALL BE SURROUNDED BY A BED OF BARK MULCH
2. DEAD MATERIAL SHALL BE REPLACED AND PLANT MATERIAL SHALL BE REGULARLY PRUNED AND NOURISHED TO MAINTAIN HEALTH
3. ANY FERTILIZER USED FOR THE ESTABLISHMENT AND MAINTENANCE OF GRASS AND VEGETATION SHALL BE FREE OF PHOSPHORUS
4. SPACING AS SHOWN OR NOTED ON THE PLAN
5. LANDSCAPING MAY BE SUBSTITUTED BY BASED ON AVAILABILITY OF SIMILAR PLANT AND SIZE

TOWN OF GREECE LANDSCAPE REQUIREMENTS

1. THE APPLICANT IS RESPONSIBLE FOR COMPLIANCE WITH 6 NYCRR PART 575 PROHIBITED AND REGULATED INVASIVE SPECIES.
2. THE LANDSCAPING ON THE PREMISES SHALL BE MAINTAINED BY THE CURRENT OWNER OF THE PREMISES, AND BY ANY FUTURE OWNER. THE OWNER OF THE PREMISES SHALL REPLACE ANY DEAD PLANTS WITH THE SAME SPECIES OR SIMILAR SPECIES. THE REPLACEMENT PLANT SHALL BE NO SMALLER THAN THE PREVIOUS PLAN WHEN IT ORIGINALLY WAS INSTALLED.
3. PRIOR TO ISSUANCE OF FINAL CERTIFICATE OF OCCUPANCY FOR THE PREMISES, THE APPLICANT SHALL PROVIDE CERTIFICATION VERIFYING PROPER INSTALLATION OF LANDSCAPE AREAS ON THE SITE IN ACCORDANCE WITH THE LANDSCAPING PLAN APPROVED BY THE PLANNING BOARD, AND IN ACCORDANCE WITH THE TOWN'S LANDSCAPED GUIDELINES FOR DEVELOPMENT. SUCH CERTIFICATION SHALL BE ON THE CERTIFICATION FORM PROVIDED IN SUCH GUIDELINES AND SHALL BE COMPLETED BY A NEW YORK STATE LICENSED LANDSCAPE ARCHITECT OR CERTIFIED NURSERY PROFESSIONAL.
4. NURSERY STOCK SHALL MEET OR EXCEED QUALITY STANDARDS ESTABLISHED IN THE CURRENT EDITION OF AMERICAN STANDARD FOR NURSERY STOCK, PUBLISHED BY THE AMERICAN ASSOCIATION OF NURSEYMEN, WASHINGTON, D.C.
5. NURSERY STOCK SHALL BE TRANSPORTED, STAGED, AND OTHERWISE HANDLED IN ACCORDANCE WITH STANDARDS ESTABLISHED IN AMERICAN STANDARD FOR NURSERY STOCK.
6. NURSERY STOCK SHALL BE OBTAINED FROM A REPUTABLE NURSERY WITH HARDINESS ZONE 4, 5, 06 6 AS DEFINED BY THE UNITED STATES DEPARTMENT OF AGRICULTURE.

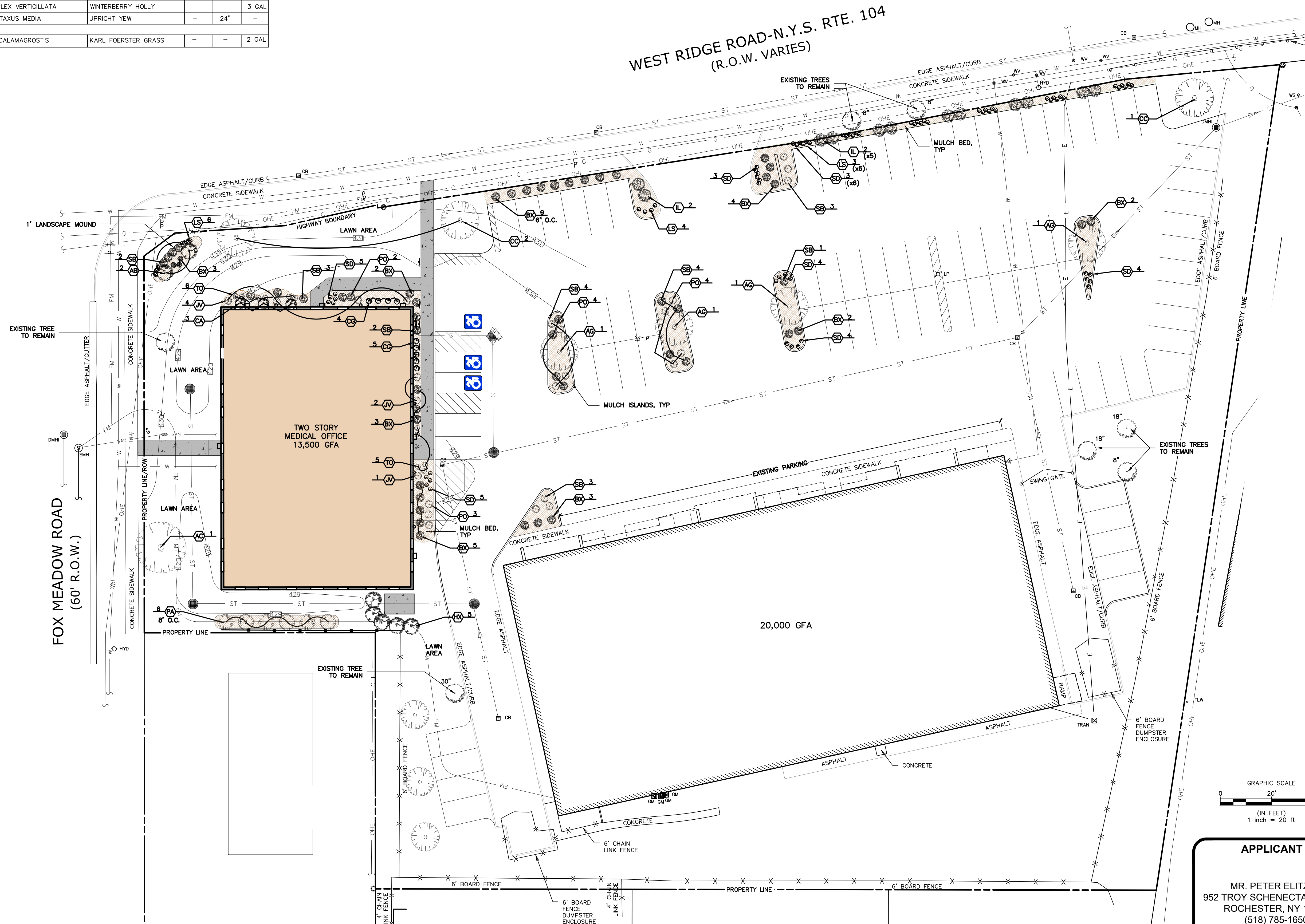

**PLANNING REVIEW ONLY
NOT FOR CONSTRUCTION**

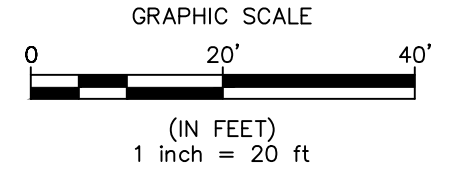

APPLICANT
 MR. PETER ELITZER
 952 TROY SCHENECTADY ROAD
 ROCHESTER, NY 14612
 (518) 785-1650

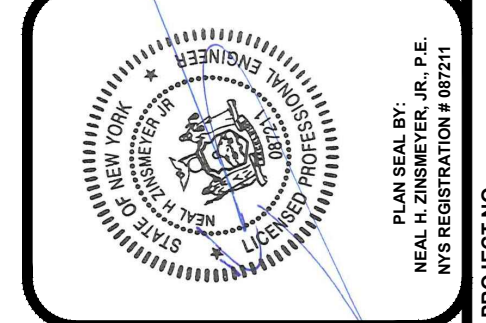

COPYRIGHT © 2022
 NAPERALA CONSULTING
 IT IS A VIOLATION OF LAW FOR ANY
 REPRODUCTION OR TRANSMISSION
 IN ANY FORM OR BY ANY MEANS
 WITHOUT THE WRITTEN PERMISSION
 OF THE CONSULTANT.
 ANY LICENSEE WHO ALTERS THIS
 DOCUMENT OR ANY PART THEREOF
 WITHOUT THE WRITTEN PERMISSION
 OF THE CONSULTANT SHALL BE
 SUBJECT TO THE PENALTIES OF
 THE PROFESSIONAL ENGINEERING
 LAW.

PROJECT TITLE:
PROPOSED MEDICAL OFFICE
 TOWN OF GREECE
 PREPARED FOR:
WHELAN & CURRY CONSTRUCTION SERVICES, INC
 MONROE CO., NY
 4103 NEW COURT ACE
 SYRACUSE, NY 13206

SHEET TITLE:
LANDSCAPING PLAN

NO.	REVISION/ISSUE	DATE

PREPARED BY:
NAPERALA CONSULTING
 PROFESSIONAL ENGINEER, P.C.
 SUIII • DESIGN • ENGINEERING
 110 FAYETTE STREET
 MANLIUS, NEW YORK 13104
 email: MNAAP@NAPCON.COM
 PH: (315) 682-5860 FAX: (315) 682-5544

PROJECT NO.: **22-2055**
 DATE: **11 FEB 2022**
 SCALE: **1"=20'**
C-5

Qty	Label	Arrangement	LLF	Description	Lum. Watts
2	WM-1A	SINGLE	0.900	NV-W-T4-16L-35-40K-WM-MSO-3G-814 @ 10'	19
2	WM-1B	SINGLE	0.900	NV-W-T3-16L-35-40K-WM-MSO-3G-814 @ 10'	19
2	WM-1B-EM	SINGLE	0.900	NV-W-T3-16L-35-40K-WM-EMCP-MSO-3G-814 @ 10'	19
1	WM-1A-EM	SINGLE	0.900	NV-W-T4-16L-35-40K-WM-EMCP-MSO-3G-814 @ 10'	19
6	WM-1C	SINGLE	0.950	KLP-UD-T4-16L-530-40K-WM @ 8'	25

MADE IN USA SILICONE OPTICS

Label	CalcType	Units	Avg	Max	Min	Avg/Min	Max/Min
CalcPts_1	Illuminance	Fc	0.32	12.5	0.0	N.A.	N.A.
PROPERTY LINE	Illuminance	Fc	0.00	0.0	0.0	N.A.	N.A.

TOWN OF GREECE
NLS LIGHTING
REV 3
2/9/22

- LIGHTING NOTES:
- LIGHTING VALUES DO NOT TAKE INTO ACCOUNT ANY EXISTING SITE LIGHTS OR STREET LIGHTS

NLS LIGHTING **KLIP**
WALL/CEILING/FLOOD LIGHTING

The Klip is a sleek, versatile, and amazingly designed Decorative Wall Sconce offering the latest in energy efficient LED technology.

This wall mounted luminaire is available in 16 and 32 LEDs at either 350 or 530 Milliamms in available temperatures of 3000, 4000 and 5000 Kelvin. The Klip can be ordered as a Down Light only, Up Light only, or a Combination of Up and Down Light.

The Klip also features a diffused tempered glass lens providing minimal glare and great uniformity. It features highly efficient long life Lumileds "Luxeon M Series" LEDs by Advance.

STAR POWER™ OPTICAL SYSTEM
The Star Power™ reflector is an excellent system which provides great value and performance.

LED WATTAGE CHART

Wattage	16 LEDs	32 LEDs
30W	16	32
60W	32	64

Project Name: _____ Type: _____

Cat #	Light Dist.	Optics	No. of LEDs	Millamps	Kelvin	Volts	Mount	Color	Options
KLIP	10'	Type 2 (T2)	16 (16L)	350 (35)	3000K (30K)	120-277 (UNV)	Wall Mount (WM)	Bronze (BRZ)	PhotoCell (PC) 10' or 15' Cable Cutoff Cover (CC) Flat Lens (FL)
	10'	Type 4 (T4)	32 (32L)	350 (35)	4000K (40K)	120-277 (UNV)	Wall Mount (WM)	Bronze (BRZ)	PhotoCell (PC) 10' or 15' Cable Cutoff Cover (CC) Flat Lens (FL)
	10'	Type 4 (T4)	32 (32L)	350 (35)	5000K (50K)	120-277 (UNV)	Wall Mount (WM)	Bronze (BRZ)	PhotoCell (PC) 10' or 15' Cable Cutoff Cover (CC) Flat Lens (FL)

145

NLS LIGHTING **NV-W**
HIGH PERFORMANCE FULL CUT OFF WALL PACK

FORM AND FUNCTION

- Sleek, low profile housing
- Superior performance
- Engineered for optimum thermal management
- 1,170-480,000 lumens
- Reduce energy consumption and costs up to 65%

CONSTRUCTION

- Die Cast Aluminum
- Internal cooling fins, Finite Element Analysis (FEA) designed
- Corrosion resistant external hardware
- One piece silicone gasket ensures IP-66 seal for electronic compartment
- Two piece silicone Micro Optic system ensures IP-67 level seal around each LED
- Silicone-Micro Optics: Recessed, full cutoff, vandal resistant and non yellowing
- Dark Sky Compliant

FINISH

- 3-5 mils electrostatic powder coat
- NLS standard high-quality finishes prevent corrosion, protect against salt and extreme environmental conditions

WARRANTY

Five year standard warranty

LISTINGS

- Certified to UL 1598
- UL 8752
- CSA C22.2 No. 250.0
- DesignLights Consortium™ (DLC)
- DesignLights Consortium Premium™ (DLCP)
- IP67 (IP67 rated)

LED WATTAGE CHART

Wattage	16 LEDs	32 LEDs
30W	16	32
60W	32	64

Project Name: _____ Type: _____

Cat #	Light Dist.	No. of LEDs	Millamps	Kelvin	Volts	Mount	Color	Options
NV-W	10'	16 (16L)	350 (35)	3000K (30K)	120-277 (UNV)	Wall Mount (WM)	Bronze (BRZ)	Location Control (LOC) Emergency Control with Indicator (ECWI) 10' or 15' Cable Cutoff Cover (CC) Photo Cell (PC) 10' or 15' Cable Cutoff Cover (CC) Flat Lens (FL) 10' or 15' Cable Cutoff Cover (CC) Flat Lens (FL) 10' or 15' Cable Cutoff Cover (CC) Flat Lens (FL)
	10'	32 (32L)	350 (35)	4000K (40K)	120-277 (UNV)	Wall Mount (WM)	Bronze (BRZ)	Location Control (LOC) Emergency Control with Indicator (ECWI) 10' or 15' Cable Cutoff Cover (CC) Photo Cell (PC) 10' or 15' Cable Cutoff Cover (CC) Flat Lens (FL) 10' or 15' Cable Cutoff Cover (CC) Flat Lens (FL)
	10'	32 (32L)	350 (35)	5000K (50K)	120-277 (UNV)	Wall Mount (WM)	Bronze (BRZ)	Location Control (LOC) Emergency Control with Indicator (ECWI) 10' or 15' Cable Cutoff Cover (CC) Photo Cell (PC) 10' or 15' Cable Cutoff Cover (CC) Flat Lens (FL) 10' or 15' Cable Cutoff Cover (CC) Flat Lens (FL)

88

FOX MEADOW ROAD
(60' R.O.W.)

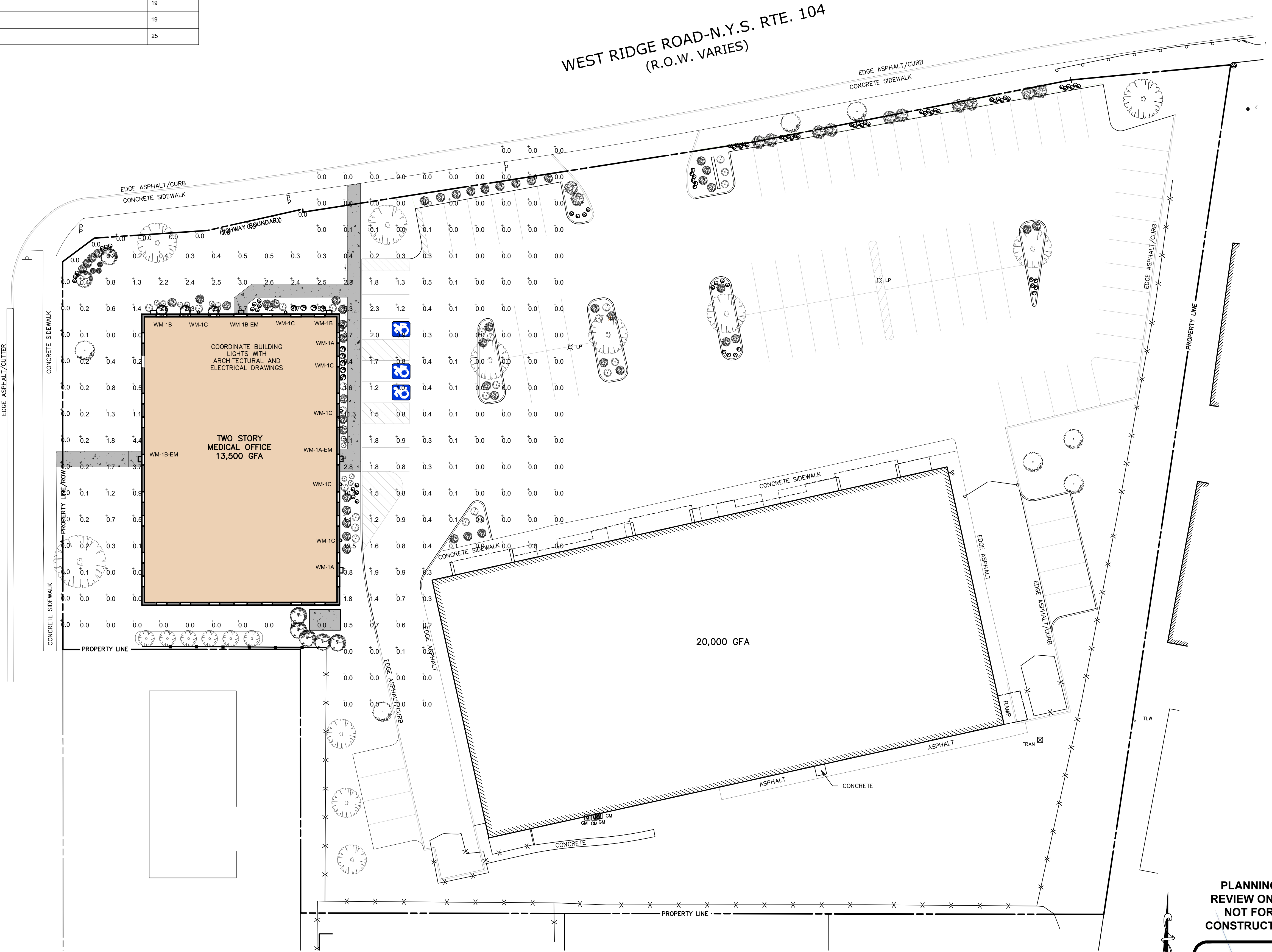

GRAPHIC SCALE
0 20' 40'
(IN FEET)
1 inch = 20 ft

APPLICANT

MR. PETER ELITZER
952 TROY SCHENECTADY ROAD
ROCHESTER, NY 14612
(518) 785-1650

PLANNING REVIEW ONLY
NOT FOR CONSTRUCTION

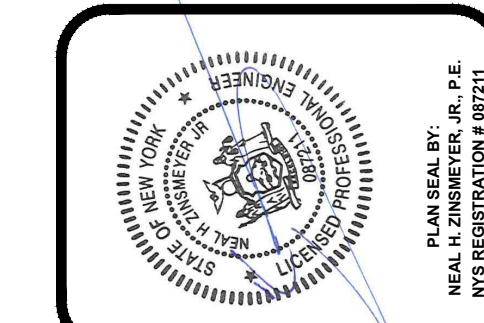

COPYRIGHT © 2022
NAPIERALA CONSULTING
IT IS A VIOLATION OF LAW FOR ANY REPRODUCTION OF THIS DOCUMENT WITHOUT THE WRITTEN PERMISSION OF NAPIERALA CONSULTING. ANY LICENSEE WHO ALTERS THIS DOCUMENT OR ALTERS ANY ITEM ON THIS DOCUMENT IS SUBJECT TO THE PENALTIES OF LAW. NOTATION "ALTERED BY" FOLLOWED BY A NAME AND DATE SHALL BE A VIOLATION OF THE SPECIFIC DESCRIPTION OF THE WORK.

PROJECT TITLE: PROPOSED MEDICAL OFFICE TOWN OF GREECE PREPARED FOR: WHELAN & CURRY CONSTRUCTION SERVICES, INC	PROJECT NO.: 22-2055	DATE: 11 FEB 2022	SCALE: 1"=20'
SHEET TITLE: LIGHTING PLAN	NO.	REVISION/ISSUE	DATE
PREPARED BY: NAPIERALA CONSULTING PROFESSIONAL ENGINEER, P.C. SUITE • DESIGN • ENGINEERING 110 FAYETTE STREET MANLUS, NEW YORK, 13104 email: MNAP@NAPCON.COM PH: (315) 682-5580 FAX: (315) 682-5544	<p>C-6</p>		

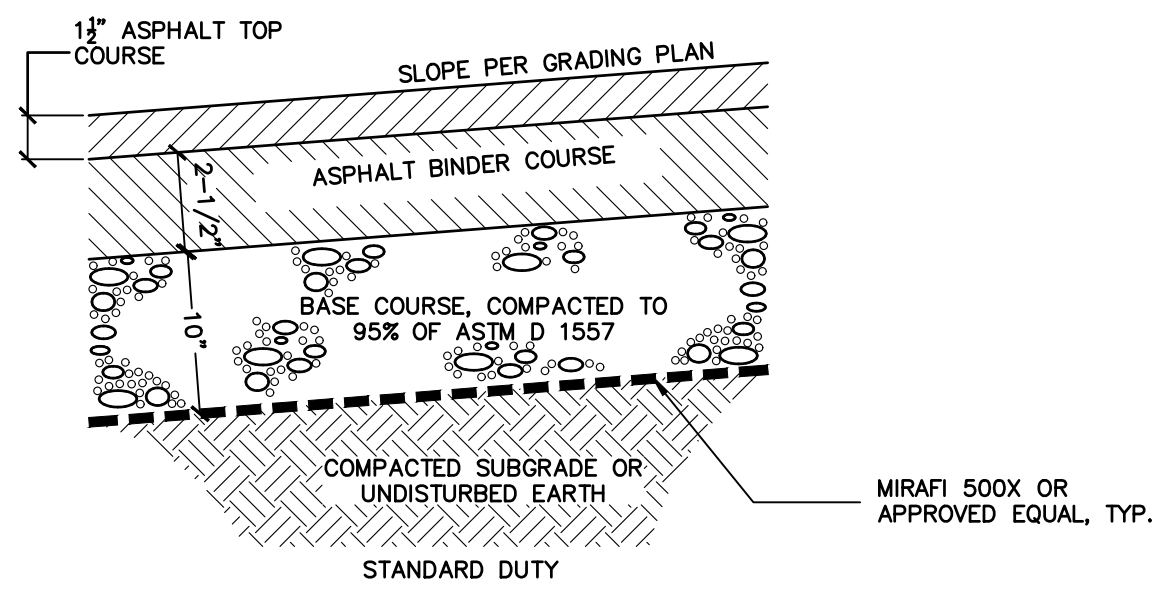

1 STANDARD PAVEMENT SECTIONS

C-7 SCALE: NTS ALL PAVEMENT SECTIONS TO BE CONFIRMED WITH THE GEOTECHNICAL REPORT

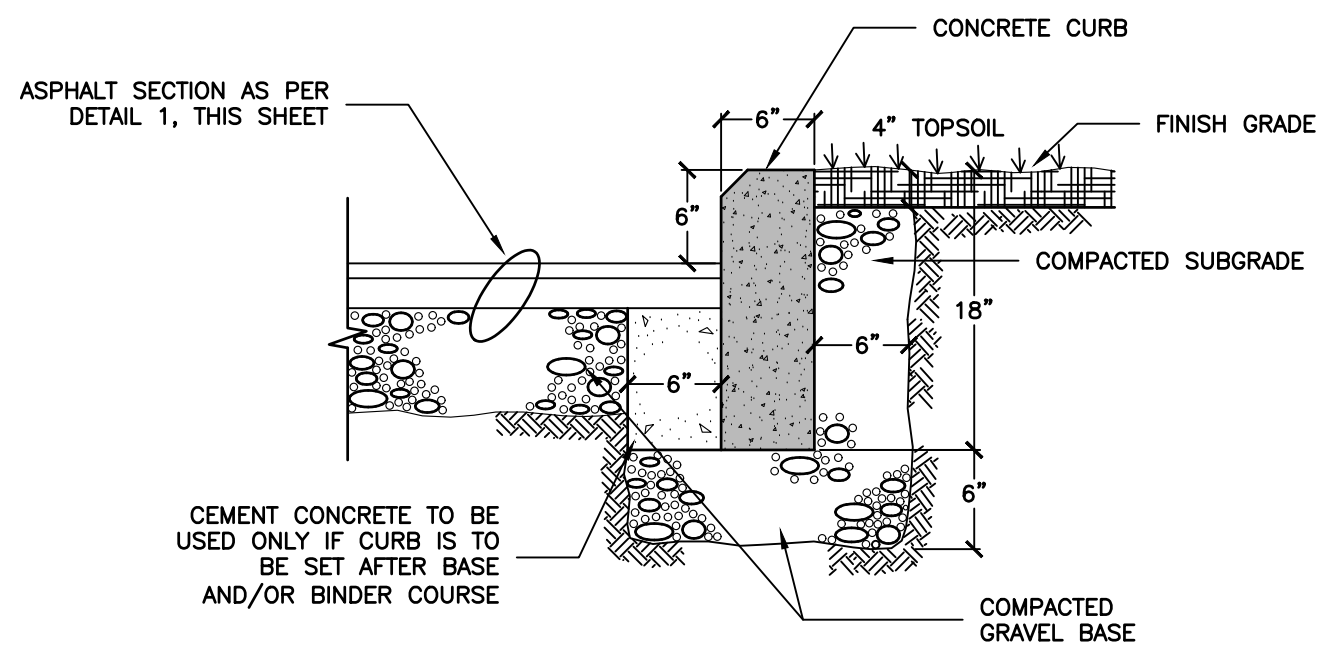

2 CONCRETE CURB

C-7 SCALE: NTS

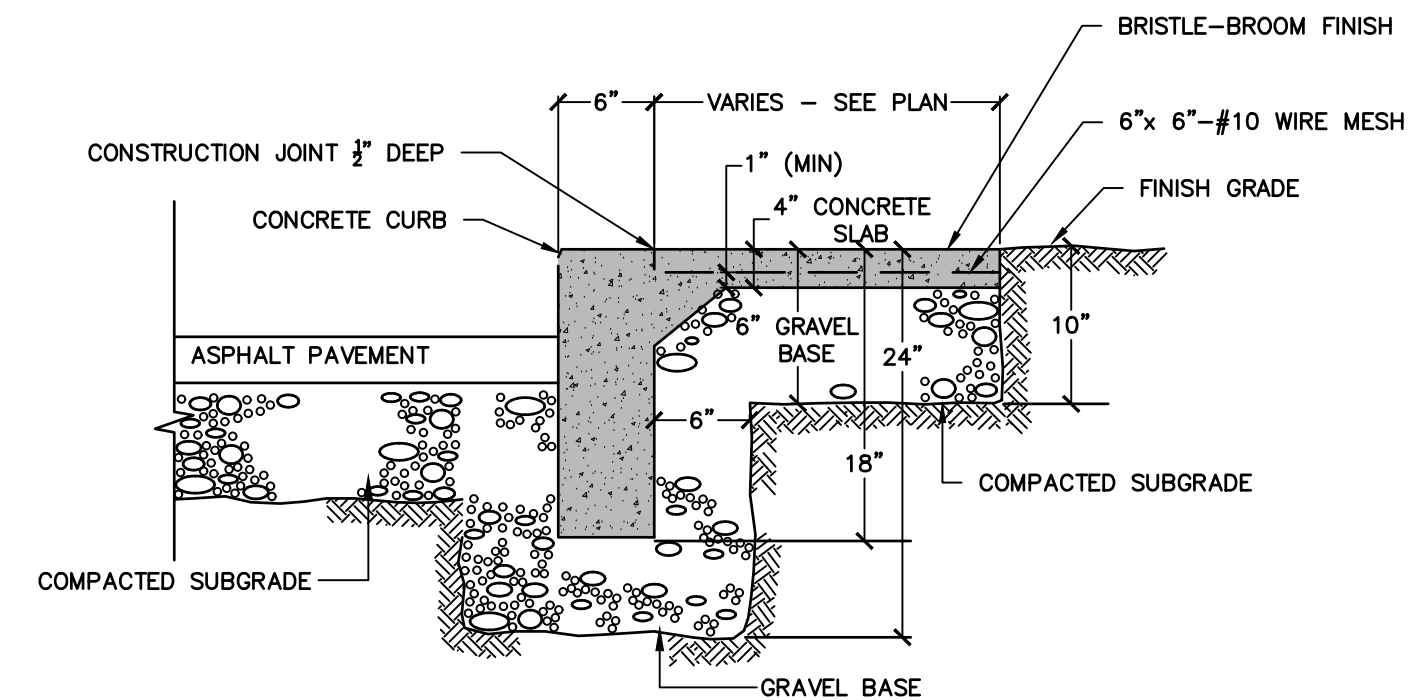

3 INTEGRAL CONCRETE CURB & SIDEWALK

C-7 SCALE: NTS

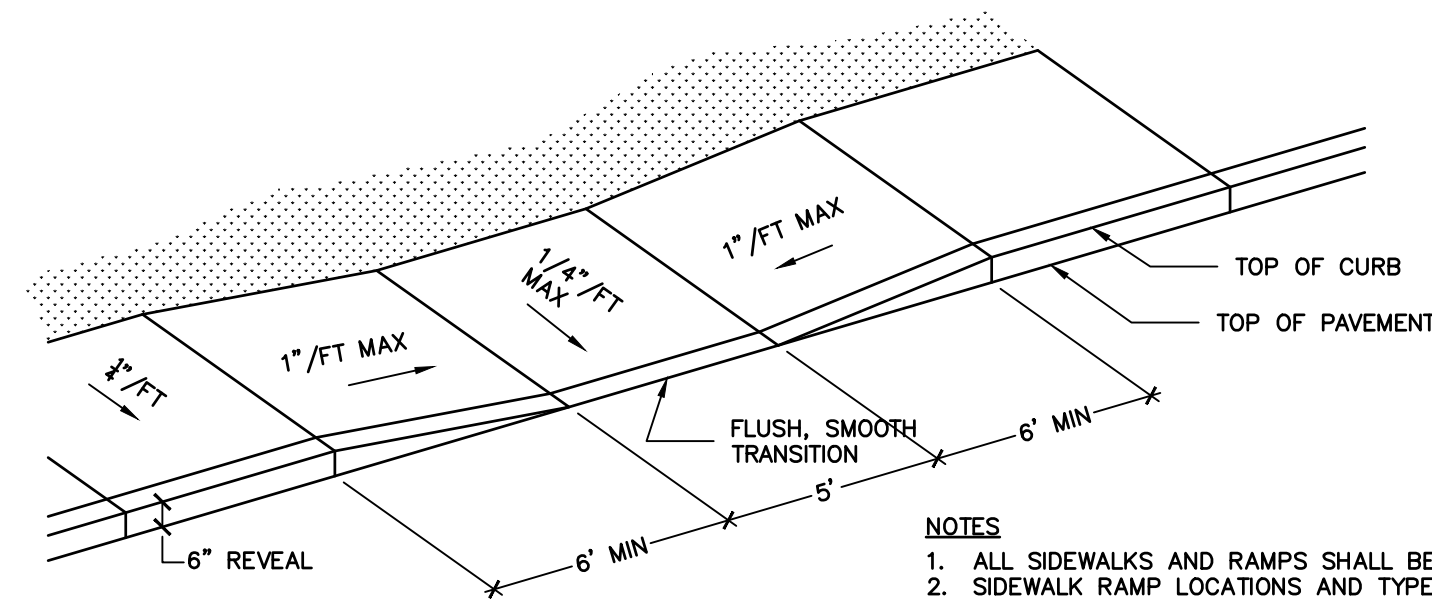

5 SIDEWALK WITHIN TOWN RIGHT OF WAY

C-7 SCALE: NTS

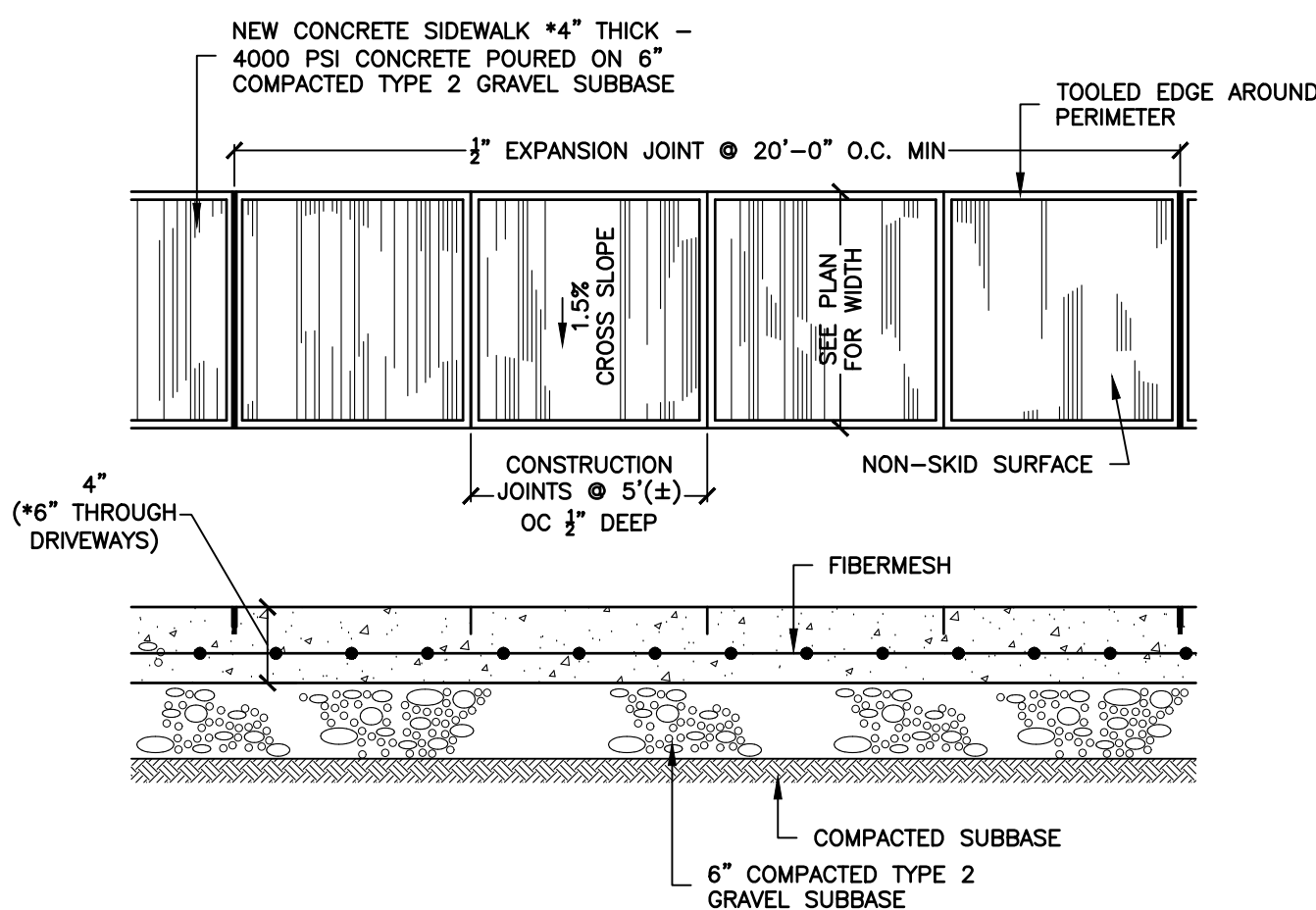

6 ASPHALT RESTORATION DETAIL

C-7 SCALE: NTS

4 GENERAL SIDEWALK DETAIL

C-7 SCALE: NTS

8 ACCESSIBLE PARKING SIGNS

C-7 SCALE: NTS

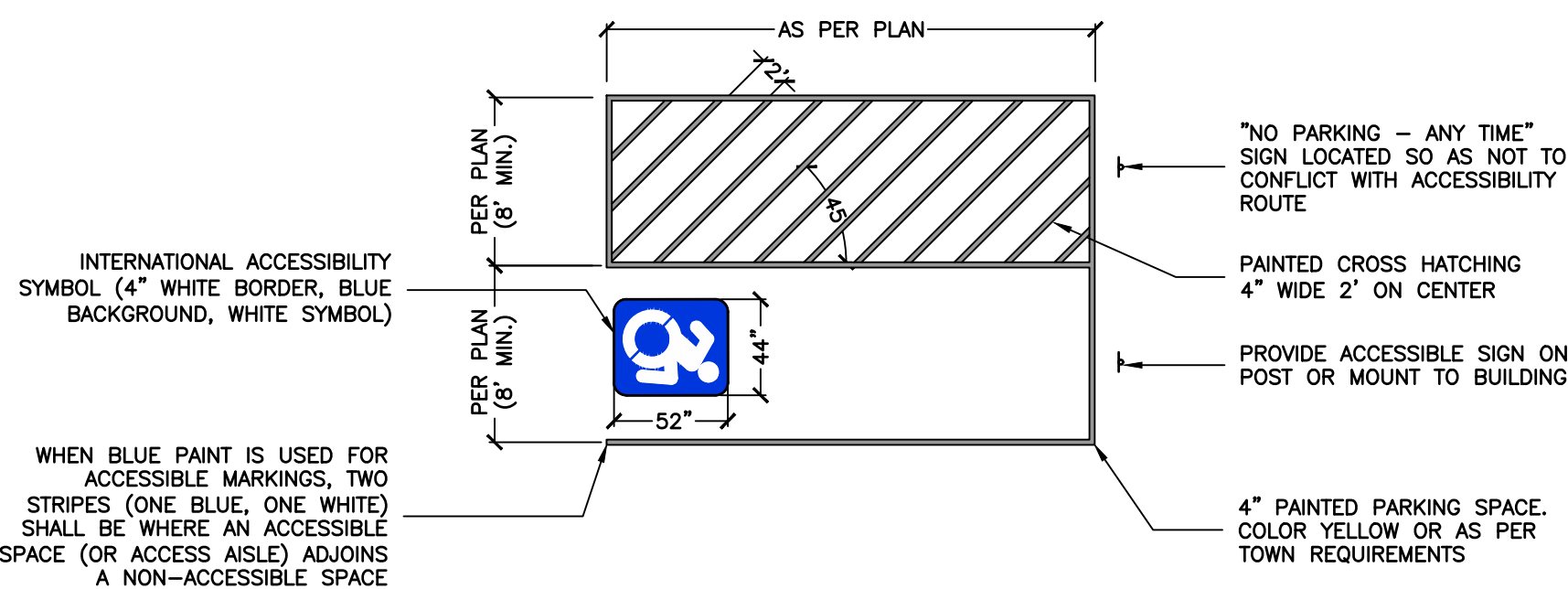

7 ACCESSIBLE PARKING PAVEMENT MARKING DETAIL

C-7 SCALE: NTS

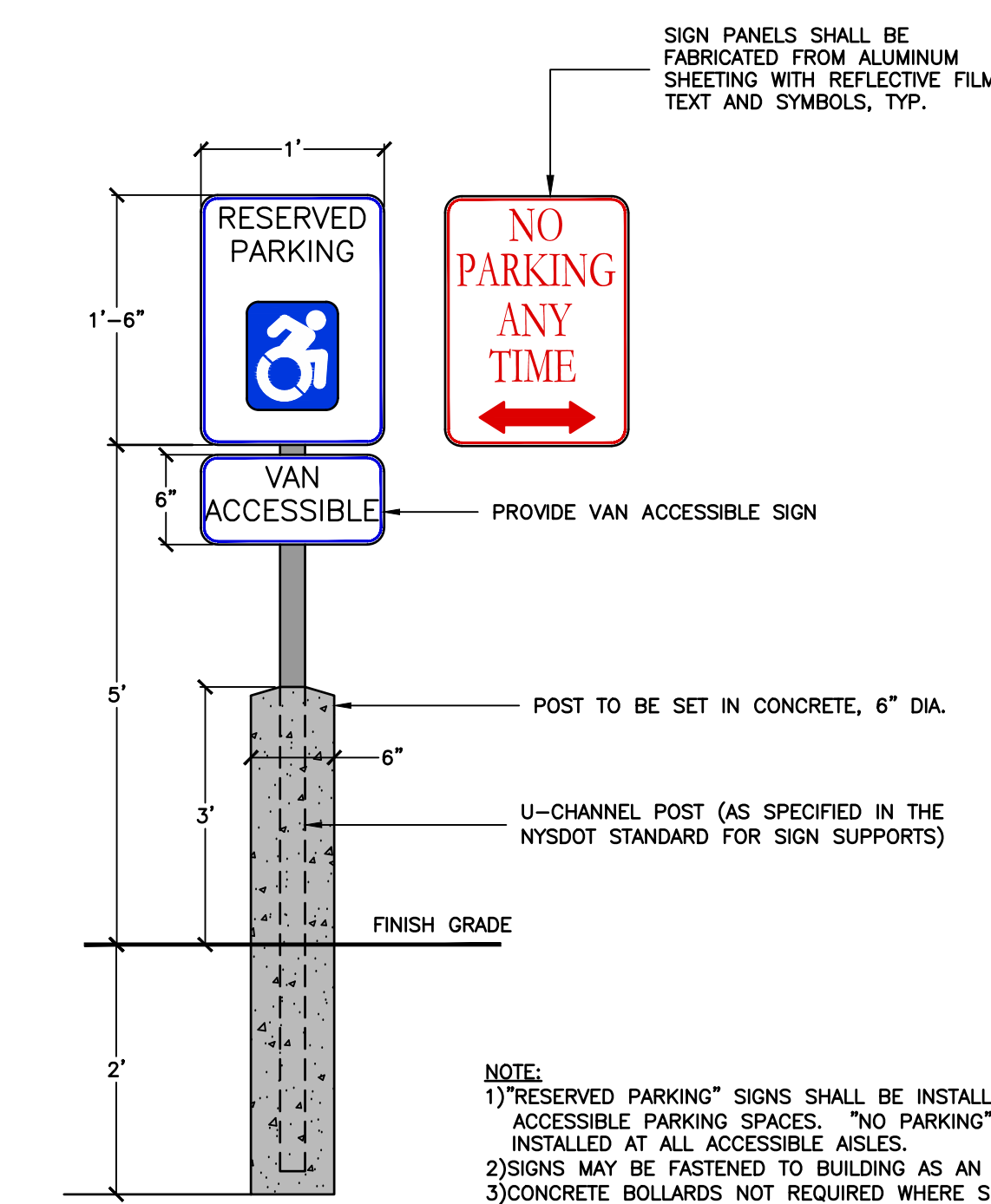

NOTE:
1) "RESERVED PARKING" SIGNS SHALL BE INSTALLED AT ALL ACCESSIBLE PARKING SPACES. "NO PARKING" SIGNS SHALL BE INSTALLED AT ALL ACCESSIBLE AISLES.
2) SIGNS MAY BE FASTENED TO BUILDING AS AN ALTERNATE OPTION
3) CONCRETE BOLLARDS NOT REQUIRED WHERE SIGNS ARE INSTALLED BEHIND CURB AND SIDEWALK

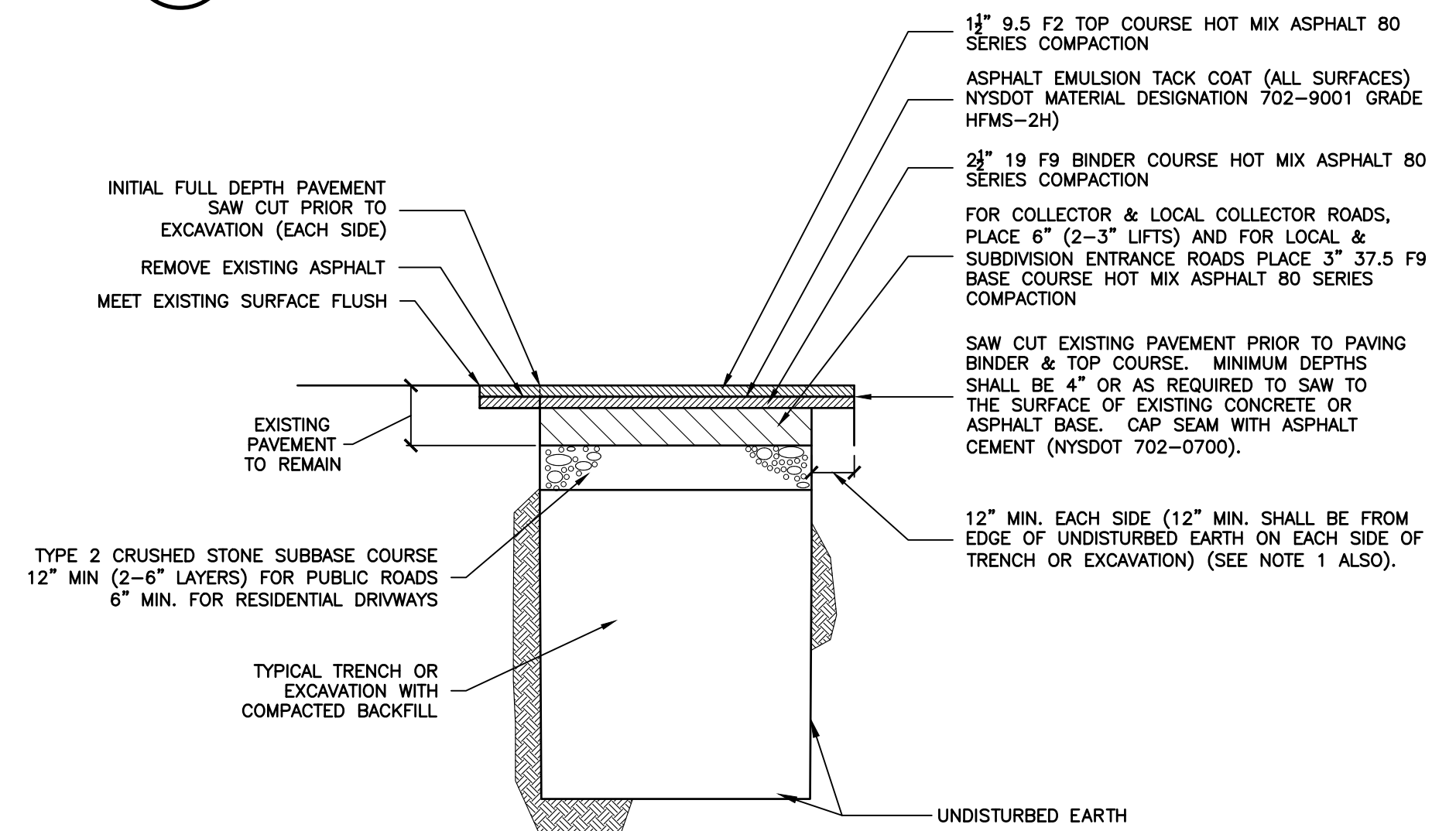

NOTES
1. ALL FINAL OR PERMANENT SAW CUTS SHALL BE (1) ONE STRAIGHT LINT CUT. SAID SAW CUTS SHALL BE MADE AT THE FARTHEST POINTS DAMAGED FROM THE CENTERLINE OF THE TRENCH OR EXCAVATION, INCLUDING CUTS FOR SERVICE INSTALLATIONS, ETC. ALL SAW CUTS SHALL BE AS ORDERED BY THE COMMISSIONER OF PUBLIC WORKS.
2. FOR CONCRETE DRIVEWAY OR PAVEMENT RESTORATION, THE MINIMUM CONCRETE THICKNESS SHALL BE SEVEN (7) INCHES OR AS ORDERED BY THE COMMISSIONER OF PUBLIC WORKS.
3. PAVEMENT KEY (FINAL SAWCUT, PAVEMENT REMOVAL, TACK COAT, ASPHALT BINDER & TOP COURSES) SHALL BE CONSTRUCTED SAME DAY AS HOT MIX ASPHALT IS PLACED OVER THE TRENCH OR EXCAVATION AND SHALL NOT BE LEFT OPEN OVERNIGHT.
4. ALL EXCAVATED MATERIAL SHALL BE REMOVED FROM WITHIN THE TOWN RIGHT OF WAY. EXISTING OR NEW MATERIAL SHALL NOT BE PLACED OR STORED WITHIN THE TOWN RIGHT OF WAY.
5. FOR ASPHALT PAVEMENT RESTORATION, ASPHALT TOP COURSE MATERIALS AND THICKNESS SHALL EQUAL THE EXISTING PAVEMENT SECTION OR, AS A MINIMUM, AS NOTED ABOVE AND AS ORDERED BY THE COMMISSIONER OF PUBLIC WORKS.

TOWN OF GREECE STANDARD DETAIL TO BE USED WHERE ANY PAVEMENT RESTORATION IS REQUIRED IN A TOWN ROAD

PROJECT TITLE: **PROPOSED MEDICAL OFFICE**
TOWN OF GREECE
PREPARED FOR: **WHELAN & CURRY CONSTRUCTION SERVICES, INC**
4103 NEW COURT ACE
SYRACUSE, NY 13206

SHEET TITLE: **DETAILS**

NO.	REVISION/ISSUE	DATE

PREPARED BY: **NAPIERALA CONSULTING**
PROFESSIONAL ENGINEER, P.E.
SUIVE • DESIGN • ENGINEERING
110 FAYETTE STREET
MANHATTAN, NEW YORK 10014
email: MNAAP@NAPCON.COM
PH: (315) 682-5560 FAX: (315) 682-5544

PLANNING REVIEW ONLY NOT FOR CONSTRUCTION

PROJECT NO. **22-2055**
DATE **11 FEB 2022**
SCALE **AS NOTED**

PLANNING REVIEW ONLY NOT FOR CONSTRUCTION

DATE **11 FEB 2022**
SCALE **AS NOTED**
C-7

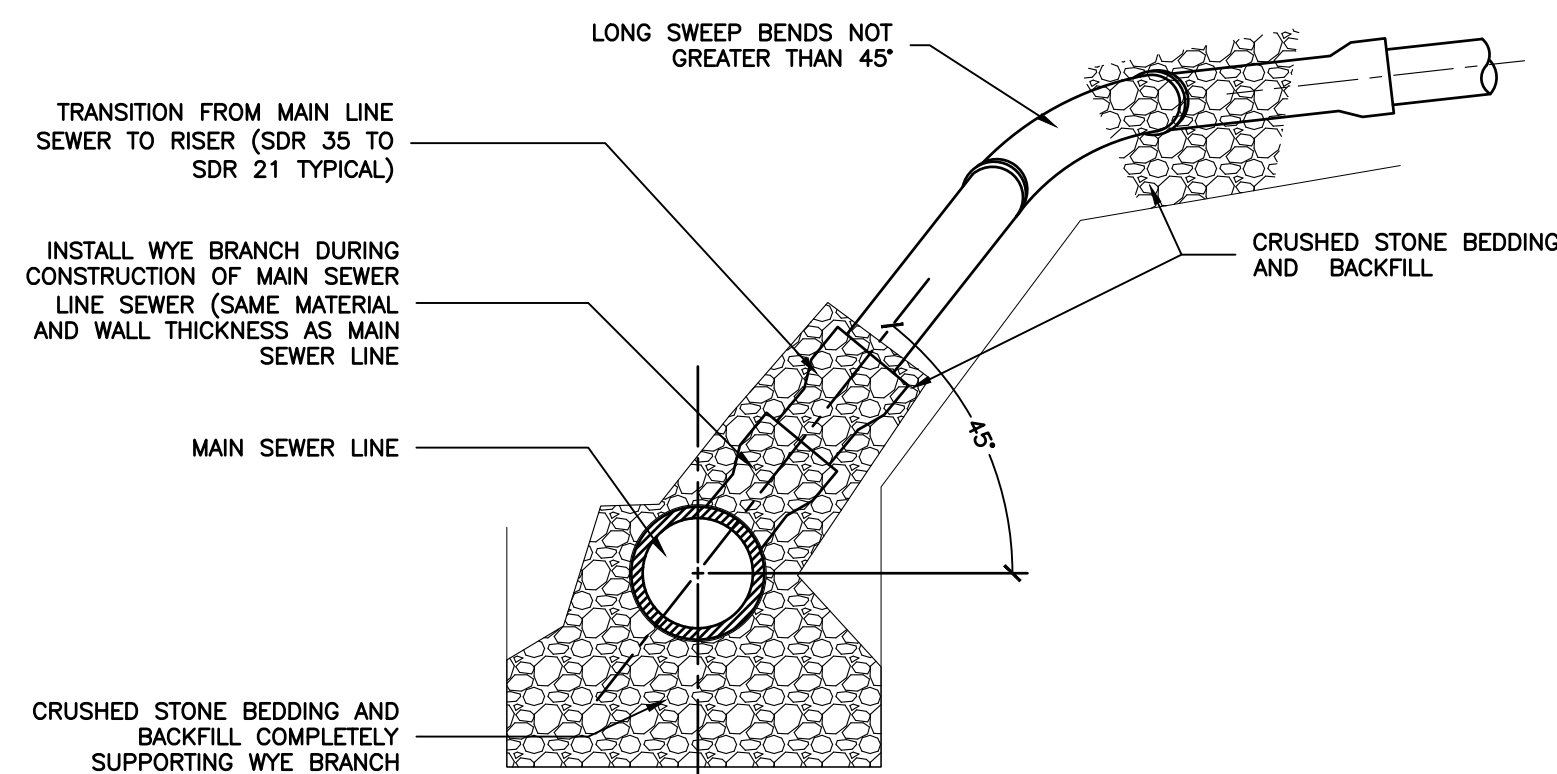

- NOTES:
1. RISER AND LATERAL PIPE SHALL BE PVC WITH A MINIMUM WALL THICKNESS OF SDR 21 AND SHALL HAVE ELASTOMERIC GASKET JOINTS. ALL SANITARY LATERALS SHALL BE A MINIMUM OF 4" DIAMETER AND LAID AT A MINIMUM SLOPE OF 1/4" PER FOOT. ALL STORM LATERALS SHALL BE A MINIMUM OF 6" DIAMETER AND LAID AT A MINIMUM SLOPE OF 1/8" PER FOOT.
 2. INSTALL WYE BRANCH IN MAIN SEWER IN THE DIRECTION OF FLOW.
 3. FOR MAIN LINE SEWER AND FOR SEWER LATERALS REFER TO STANDARD BEDDING DETAIL STORM & SANITARY SEWER FOR EXCAVATION, BEDDING AND BACKFILL (INITIAL & SUBSEQUENT) REQUIREMENTS. REFER TO STANDARD STORM & SANITARY SEWER LATERAL AND CLEANOUT DETAIL FOR LATERAL CLEANOUT AND MARKER REQUIREMENTS.

1 SEWER LATERAL RISER DETAIL TOWN OF GREECE STANDARD DETAIL
C-8 SCALE: NTS

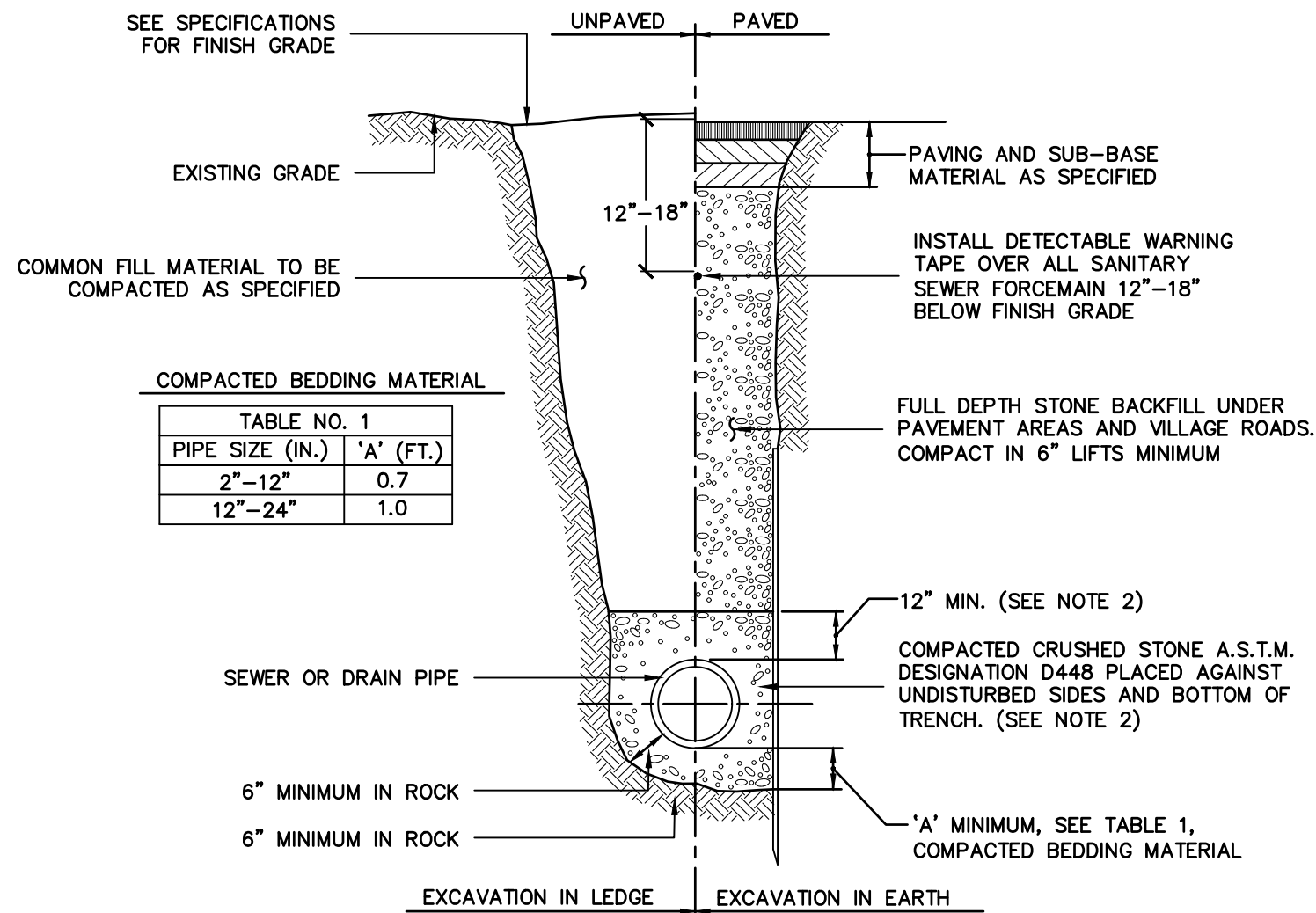

- NOTES:
1. SHEETING, WHEN REQUIRED, TO BE CUT OFF AT LEAST 5 FEET BELOW STREET AND A MINIMUM OF 1 FOOT ABOVE TOP OF PIPE. WOOD SHEETING DRIVEN BELOW MID-DIAMETER OF THE PIPE SHALL BE LEFT IN PLACE. STEEL SHEETING DRIVEN BELOW MID-DIAMETER MAY BE WITHDRAWN IF APPROVED IN WRITING BY THE ENGINEER. FOR PVC PIPE ALL SHEETING DRIVEN BELOW MID-DIAMETER SHALL BE LEFT IN PLACE.
 2. WHEN APPROVED BY THE ENGINEER FOR PIPES OTHER THAN PVC SELECTED GRAVEL FILL MATERIAL MAY BE USED FROM MID-DIAMETER OF PIPE TO 12" ABOVE TOP OF PIPE. NO STONES LARGER THAN 2 INCHES IN ANY DIMENSION WILL BE PERMITTED IN THIS AREA. 3. TRENCHES LOCATED ON THE ROAD SHOULDER SHALL BE TREATED THE SAME AS EXCEPT FOR PAVING.
 4. PROVIDE AT LEAST ONE IMPERVIOUS DAM IN GRAVEL BEDDING BETWEEN EACH MANHOLE WHERE DIRECTED, OR EVERY 300 FEET, WHICHEVER IS LESS. SEE DETAIL BEDDING MATERIAL FOR PVC PIPE SHALL MEET THE REQUIREMENTS OF ASTM D2321 CLASS I OR CLASS II EMBEDMENT MATERIALS.

2 TYPICAL SEWER AND DRAIN TRENCH
C-8 SCALE: NTS

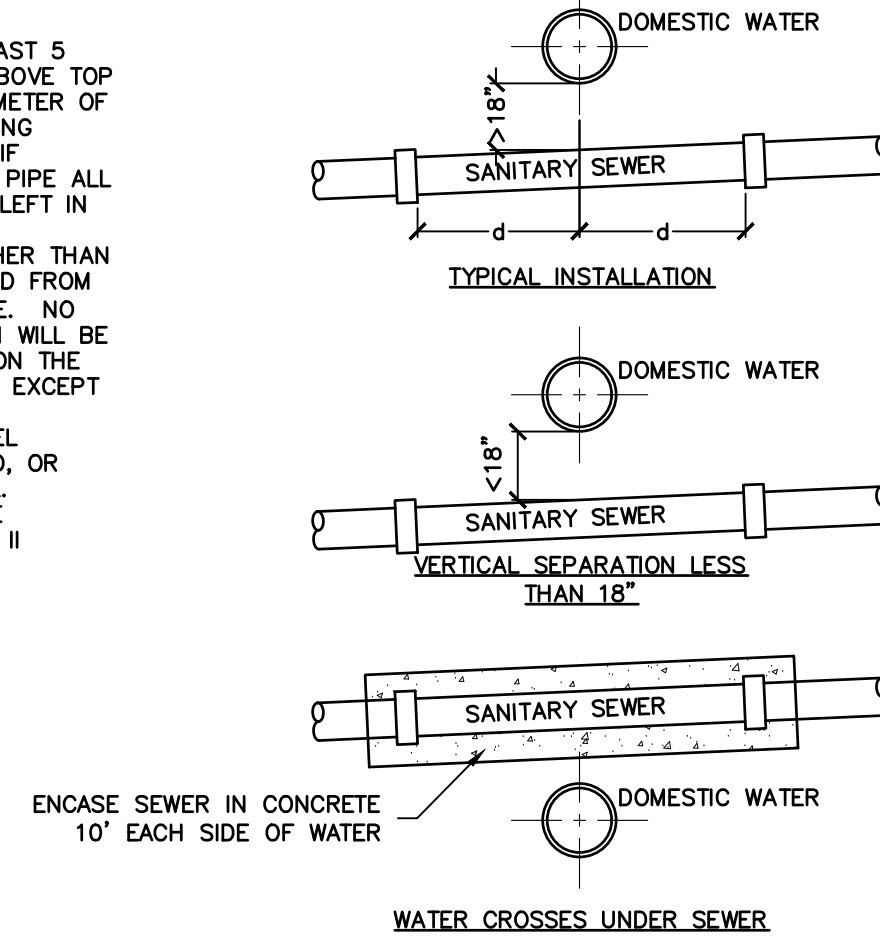

- TYPICAL INSTALLATION
1. MINIMUM VERTICAL SEPARATION IS 18" FROM TOP OF PIPE TO BOTTOM OF PIPE.
 2. SEWER JOINTS ARE TO SPACED EQUIDISTANT AND AS FAR AS POSSIBLE FROM THE WATER MAIN JOINTS.
- VERTICAL SEPARATION LESS THAN 18"
1. SEWER SHALL BE DESIGNED AND CONSTRUCTED EQUAL TO THE WATER PIPE, AND SHALL BE PRESSURE TESTED AT 150 PSI TO ASSURE WATER TIGHTNESS PRIOR TO BACKFILLING.
 2. SEWER JOINTS ARE TO SPACED EQUIDISTANT AND AS FAR AS POSSIBLE FROM THE WATER MAIN JOINTS.
- WATER CROSSES UNDER SEWER
1. SEWER SHALL BE DESIGNED AND CONSTRUCTED EQUAL TO THE WATER PIPE, AND SHALL BE PRESSURE TESTED AT 150 PSI TO ASSURE WATER TIGHTNESS PRIOR TO BACKFILLING.
 2. SEWER JOINTS ARE TO SPACED EQUIDISTANT AND AS FAR AS POSSIBLE FROM THE WATER MAIN JOINTS.
 3. PROVIDE ADEQUATE STRUCTURAL SUPPORT FOR SEWER TO MAINTAIN LINE AND GRADE

3 WATER AND SEWER SEPARATION
C-8 SCALE: NTS

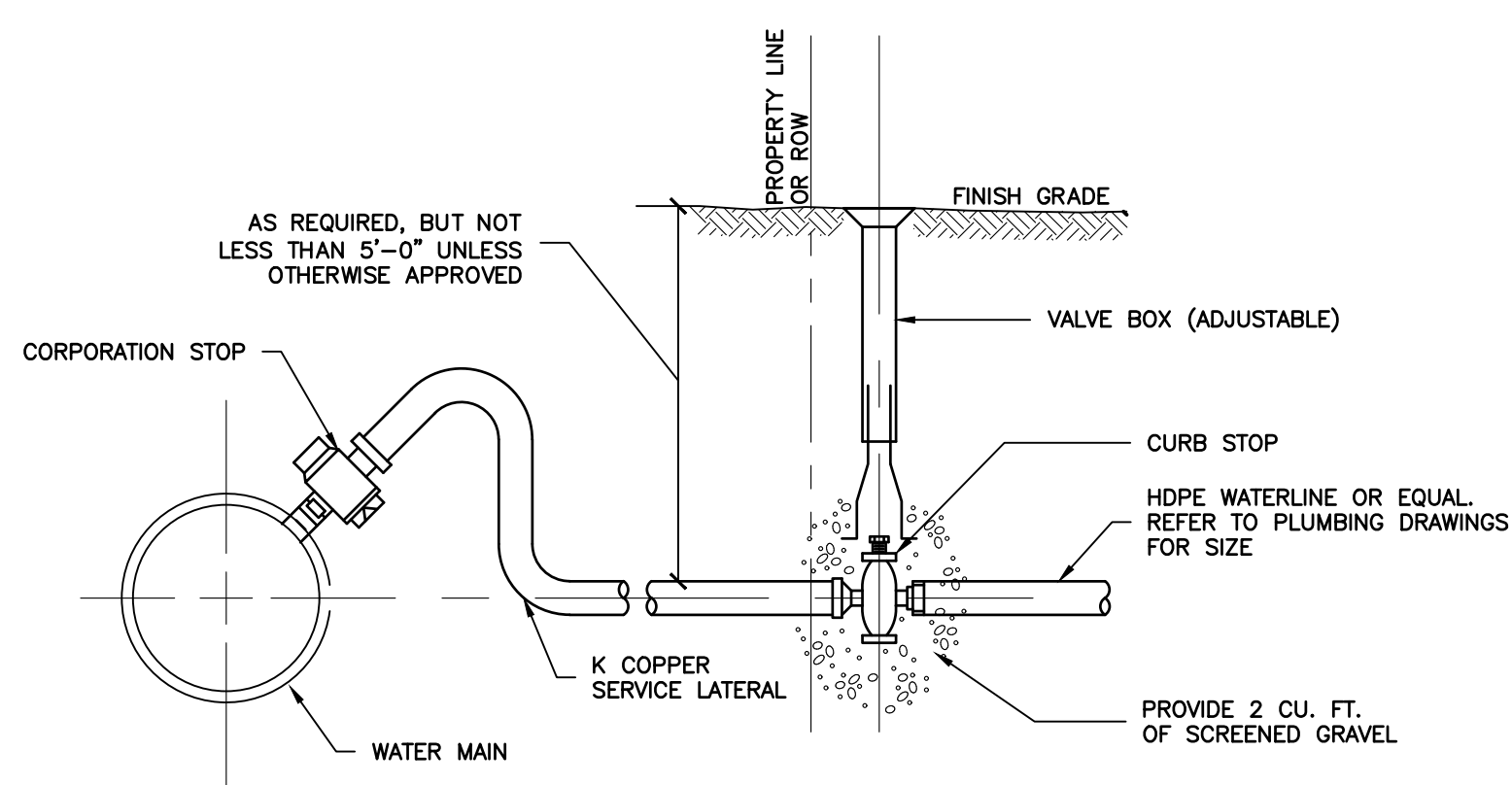

4 WATER SERVICE CONNECTION COORDINATE WATER SERVICE WITH TOWN
C-8 SCALE: NTS

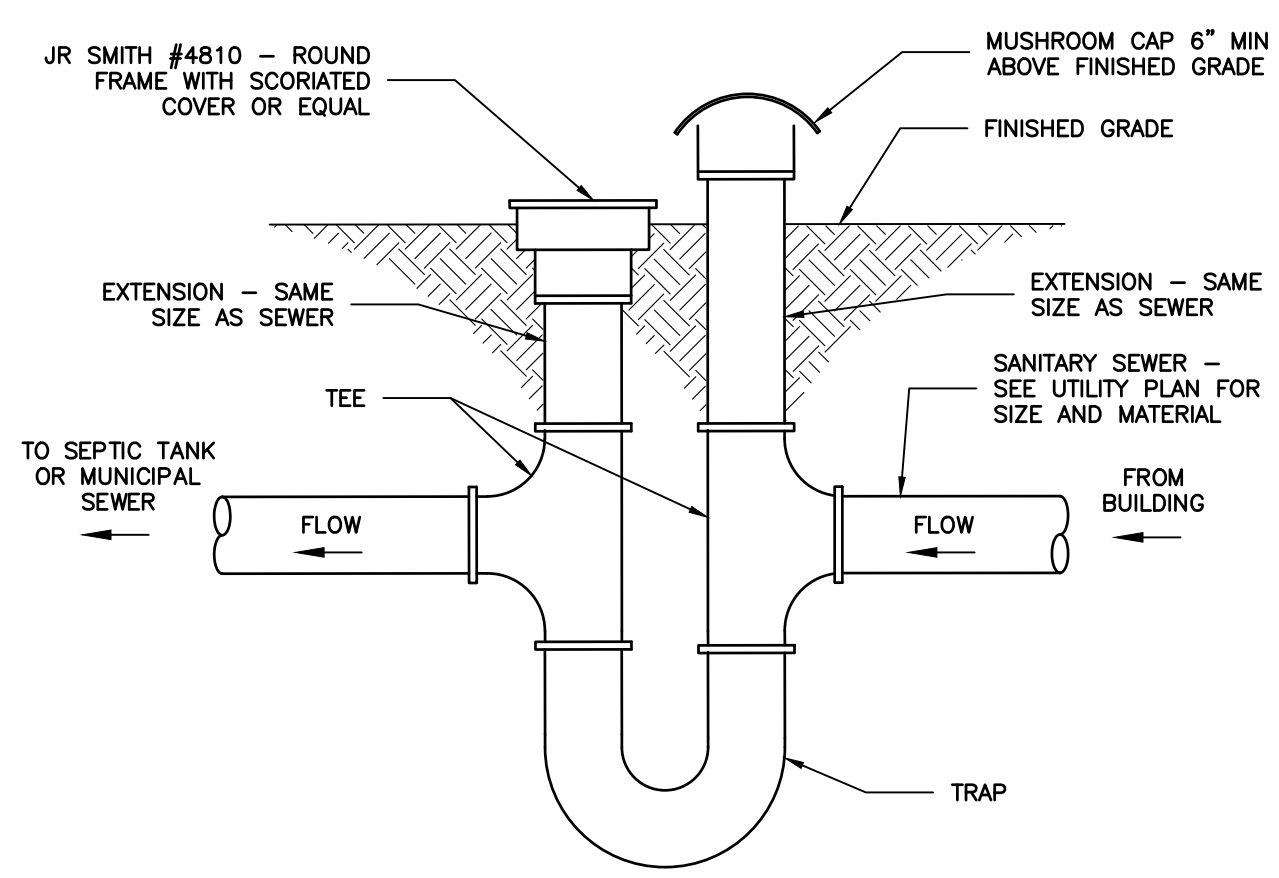

5 CAST IRON VENT AND TRAP
C-8 SCALE: NTS

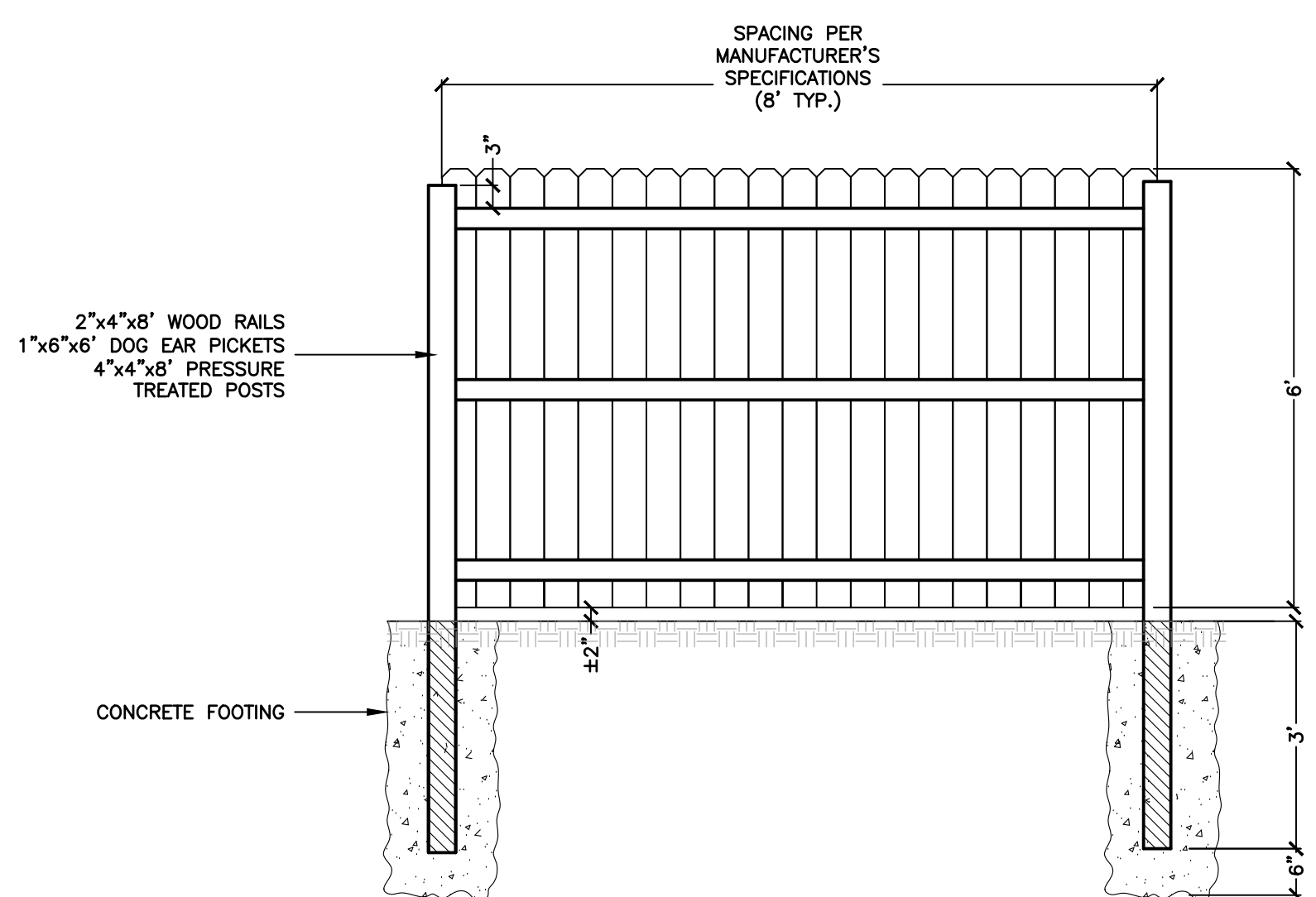

6 6' VINYL SCREENING FENCE
C-6 SCALE: NTS

INSTALL FENCE WITH POSTS AND RAILS FACING INTO PROJECT SIDE OF PROPERTY. REFER TO FENCE MANUFACTURER FOR ADDITIONAL INSTALLATION REQUIREMENTS

PROJECT TITLE: **PROPOSED MEDICAL OFFICE**
TOWN OF GREECE
PREPARED FOR: **WHELAN & CURRY CONSTRUCTION SERVICES, INC**
4103 NEW COURT ACE
SYRACUSE, NY 13206

SHEET TITLE: **DETAILS**

NO.	REVISION/ISSUE	DATE

PLANNING REVIEW ONLY NOT FOR CONSTRUCTION

PROJECT NO. **22-2055**
DATE **11 FEB 2022**
SCALE **AS NOTED**

C-8

PREPARED BY: **NAPIERALA CONSULTING**
PROFESSIONAL ENGINEER, P.C.
STATE OF NEW YORK LICENSE NO. 13104
110 FAYETTE STREET
MANHATTAN, NEW YORK 10013
email: MNA.P@NAPCON.COM
PH: (315) 682-5860 FAX: (315) 682-5544

COPYRIGHT © 2022
NAPIERALA CONSULTING
IT IS A VIOLATION OF LAW FOR ANY PROFESSIONAL ENGINEER OR ARCHITECT TO REPRODUCE OR TRANSMIT IN ANY MANNER OR BY ANY MEANS, ELECTRONIC OR MECHANICAL, INCLUDING PHOTOCOPYING, RECORDING, OR BY ANY INFORMATION STORAGE AND RETRIEVAL SYSTEM, WITHOUT PERMISSION IN WRITING FROM NAPIERALA CONSULTING. ANY LICENSEE WHO ALTERS THIS DOCUMENT IS REQUIRED BY LAW TO NOTATION "ALTERED BY" FOLLOWED BY SPECIFIC DESCRIPTION OF THE ALTERATION.

EROSION AND SEDIMENT CONTROLS

- STABILIZATION PRACTICES (TEMPORARY)
 - TEMPORARY SEEDING AND PLANTING OF ALL UNPAVED AREAS WHEN CONSTRUCTION ACTIVITY HAS CEASED, OR WILL CEASE, IN AN AREA FOR 14 DAYS.
 - MULCHING EXPOSED AREAS.
 - FREQUENT WATERING TO MINIMIZE WIND EROSION DURING CONSTRUCTION.
- STABILIZATION PRACTICES (PERMANENT)
 - LAND CLEARING ACTIVITIES SHALL BE DONE ONLY IN AREAS WHERE EARTHWORK WILL BE PERFORMED AND SHALL PROGRESS AS EARTHWORK IS NEEDED.
 - PERMANENT SEEDING AND PLANTING OF ALL UNPAVED AREAS.
- STRUCTURAL MEASURES TEMPORARY
 - STABILIZED CONSTRUCTION ENTRANCE: AT THE ENTRANCE TO THE ALL DISTURBED AREAS FROM AN EXISTING ROADWAY A STABILIZED CONSTRUCTION ENTRANCE SHALL BE PROVIDED. THE PURPOSE OF THE STABILIZED CONSTRUCTION ENTRANCE IS TO REDUCE OR ELIMINATE THE TRACKING OF SEDIMENT ONTO THE PUBLIC RIGHT-OF-WAY.
 - SILT FENCE: SILT FENCE SHALL BE INSTALLED AS SHOWN ON THE EROSION CONTROL PLAN. THE FABRIC SHALL MEET THE SPECIFICATIONS NOTED ON THE DETAILS UNLESS OTHERWISE APPROVED BY THE APPROPRIATE EROSION AND SEDIMENT CONTROL PLAN APPROVAL AUTHORITY. SUCH APPROVAL SHALL NOT CONSTITUTE STATEWIDE ACCEPTANCE.
 - DUST CONTROL: DUST CONTROL IS THE CONTROL OF DUST RESULTING FROM LAND-DISTURBING ACTIVITIES. THE PURPOSE IS TO PREVENT SURFACE AND AIR MOVEMENT OF DUST FROM DISTURBED SOIL SURFACES THAT MAY CAUSE OFF-SITE DAMAGE, HEALTH HAZARDS, AND TRAFFIC SAFETY PROBLEMS.
- STRUCTURAL PRACTICES (PERMANENT)
 - ROCK OUTLET PROTECTION: ROCK OUTLET PROTECTION IS A SECTION OF ROCK PROTECTION PLACED AT THE OUTLET END OF CULVERTS, CONDUITS, OR CHANNELS. THE PURPOSE OF THE ROCK OUTLET PROTECTION IS TO REDUCE THE DEPTH, VELOCITY, AND ENERGY OF WATER, SUCH THAT THE FLOW WILL NOT ERODE THE RECEIVING DOWNSTREAM REACH.
 - REINFORCED SLOPE PROTECTION: A TEMPORARY PROTECTIVE COVERING PLACED ON A PREPARED PLANTING AREA THAT IS ANCHORED IN PLACE BY STAPLES OR OTHER MEANS TO AID IN CONTROLLING EROSION BY ABSORBING RAIN SPLASH ENERGY AND WITHSTAND OVERLAND FLOW AS WELL AS PROVIDE A MICROCLIMATE TO PROTECT AND PROMOTE SEED ESTABLISHMENT.
 - LAND GRADING: PERMANENT RESHAPING OF THE EXISTING LAND SURFACE BY GRADING IN ACCORDANCE WITH AN ENGINEERING TOPOGRAPHIC PLAN AND SPECIFICATION TO PROVIDE EROSION CONTROL AND VEGETATIVE ESTABLISHMENT ON DISTURBED, RESHAPED AREAS.

5. SEQUENCE OF MAJOR ACTIVITIES

- THE CONTRACTOR SHALL BE RESPONSIBLE FOR IMPLEMENTING THE ABOVE LISTED EROSION AND SEDIMENT CONTROL PRACTICES. THE CONTRACTOR MAY DESIGNATE THESE TASKS TO CERTAIN SUBCONTRACTORS AS IS SEEN FIT, BUT THE ULTIMATE RESPONSIBILITY FOR IMPLEMENTING THESE CONTROLS AND ENSURING THEIR PROPER FUNCTION REMAINS WITH THE CONTRACTOR. THE ORDER OF ACTIVITIES WILL BE AS FOLLOWS:
- CONSTRUCT TEMPORARY CONSTRUCTION ENTRANCE/EXIT AT THE LOCATION SHOWN ON THE PLAN.
 - INSTALL PERIMETER SILT FENCE AND SECURITY CONSTRUCTION FENCE IN THE LOCATIONS SHOWN ON THE PLAN.
 - DEMOLITION OF EXISTING BUILDING AND REMOVAL OF EXISTING ASPHALT.
 - SITE GRADING, IMPORT OF FILL MATERIAL TO RAISE SITE TO PROPOSED GRADE (OR SUB-GRADE, AS APPROPRIATE).
 - BEGIN WITH EMBANKMENT ALONG NORTH SIDE OF CONSTRUCTION.
 - BUILDING PAD AREA
 - ALL OTHER AREAS.
 - BUILDING FOUNDATION EXCAVATION (BUILDING CONSTRUCTION TO CONTINUE CONCURRENTLY WITH REMAINING SITE WORK).
 - DISTURBED AREAS OF THE SITE WHERE CONSTRUCTION ACTIVITY HAS CEASED FOR MORE THAN 14 DAYS SHALL BE TEMPORARILY SEEDED AND WATERED.
 - UNDERGROUND UTILITY, STORAGE TANK, AND DISPENSER PIPING INSTALLATIONS.
 - INSTALL FILTER FABRIC DROP INLET PROTECTION AT ALL STORM INLETS.
 - SITE CONCRETE CONSTRUCTION.
 - FINALIZE PAVEMENT SUBGRADE PREPARATION.
 - REMOVE INLET PROTECTION NO MORE THAN 24 HOURS PRIOR TO PLACING ASPHALT PAVEMENT.
 - PAVE AREAS NOTED ON PLAN.
 - FINAL GRADING, SEEDING, AND PLANTING.
 - REMOVE SILT FENCE ONLY AFTER ALL PAVING IS COMPLETE AND EXPOSED SURFACES ARE STABILIZED.

EROSION CONTROL NOTES

- LAND DISTURBING ACTIVITIES SHALL NOT COMMENCE UNTIL APPROVAL TO DO SO HAS BEEN RECEIVED BY GOVERNING AUTHORITIES. THE GENERAL CONTRACTOR SHALL STRICTLY ADHERE TO THE APPROVED SWPPP DRAWINGS DURING CONSTRUCTION OPERATIONS.
- NO LAND CLEARING OR GRADING SHALL BEGIN UNTIL THE APPROPRIATE EROSION CONTROL MEASURES HAVE BEEN INSTALLED.
- ALL EXPOSED AREAS SHALL BE SEEDED AS SPECIFIED WITHIN 7 DAYS OF FINAL GRADING.
- SHOULD CONSTRUCTION STOP FOR LONGER THAN 14 DAYS, THE SITE SHALL BE SEEDED AS SPECIFIED.
- MAINTAIN EROSION CONTROL MEASURES AFTER EACH RAIN AND AT LEAST ONCE A WEEK.
- THIS PLAN SHALL NOT BE CONSIDERED ALL INCLUSIVE AS THE GENERAL CONTRACTOR SHALL TAKE ALL NECESSARY PRECAUTIONS TO PREVENT SEDIMENT FROM LEAVING THE SITE.
- GENERAL CONTRACTOR SHALL COMPLY WITH ALL STATE AND LOCAL ORDINANCES THAT APPLY.
- ADDITIONAL EROSION AND SEDIMENT CONTROL MEASURES WILL BE INSTALLED IF DEEMED NECESSARY BY ON SITE INSPECTION.
- IF INSTALLATION OF STORM DRAINAGE SYSTEM SHOULD BE INTERRUPTED BY WEATHER OR NIGHTFALL, THE PIPE ENDS SHALL BE COVERED WITH FILTER FABRIC.
- GENERAL CONTRACTOR SHALL BE RESPONSIBLE TO TAKE WHATEVER MEANS NECESSARY TO ESTABLISH PERMANENT SOIL STABILIZATION.
- ALL WORK TO BE DONE IN STRICT ACCORDANCE WITH THE NEW YORK STANDARDS AND SPECIFICATIONS FOR EROSION AND SEDIMENT CONTROL.

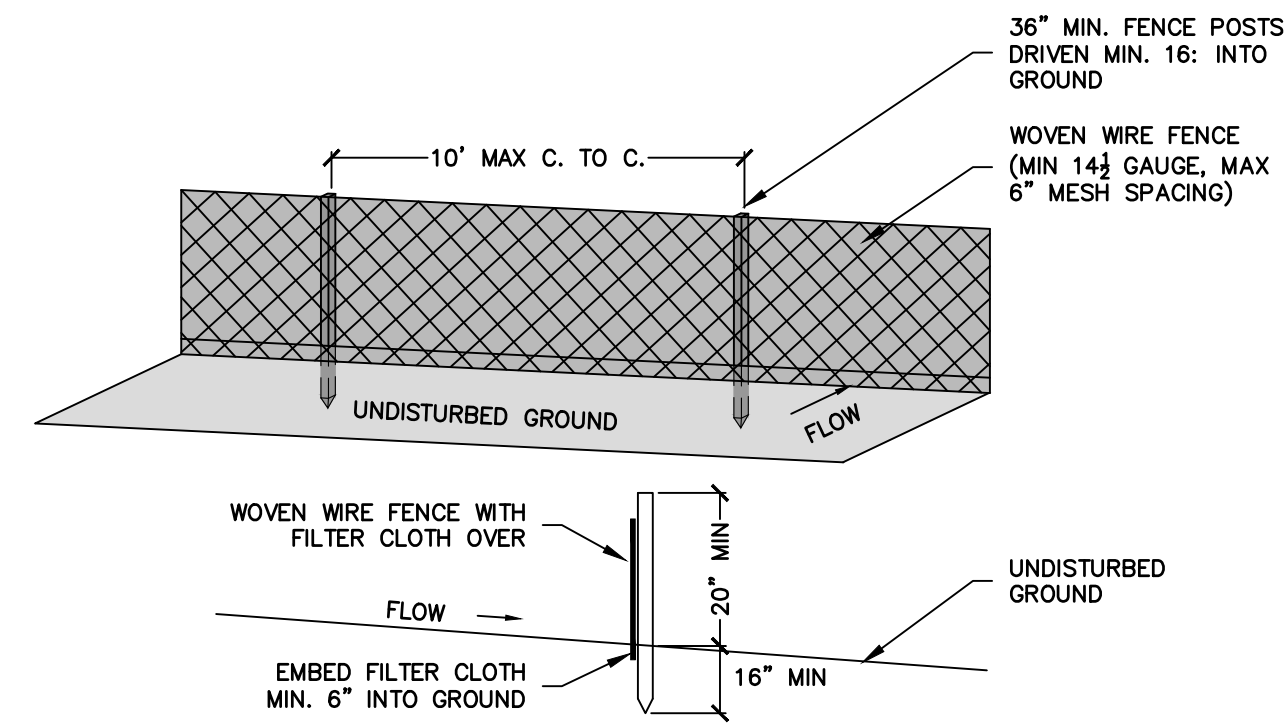

- POSTS: STEEL, EITHER "T" OR "U" TYPE OR 2" HARDWOOD
- FENCE: WOVEN WIRE, 14 1/2 GAUGE, 6" MAX. MESH OPENING
- PREFABRICATED UNIT: GEOFAB, ENVIROFENCE, OR APPROVED EQUAL
- WOVEN WIRE FENCE TO BE FASTENED SECURELY TO FENCE POSTS WITH WIRE TIES OR STAPLES.
 - FILTER CLOTH IS TO BE FASTENED SECURELY TO WOVEN WIRE FENCE WITH TIES SPACED EVERY 24" AT TOP AND MID SECTION.
 - WHEN TWO SECTIONS OF FILTER CLOTH ADJOIN EACH OTHER, THEY SHALL BE OVERLAPPED BY SIX INCHES AND FOLDED.
 - MAINTENANCE SHALL BE PERFORMED AS NEEDED AND MATERIAL REMOVED WHEN "BULGES" DEVELOP IN THE SILT FENCE.

1 EROSION CONTROL NOTES

C-9 SCALE: NTS

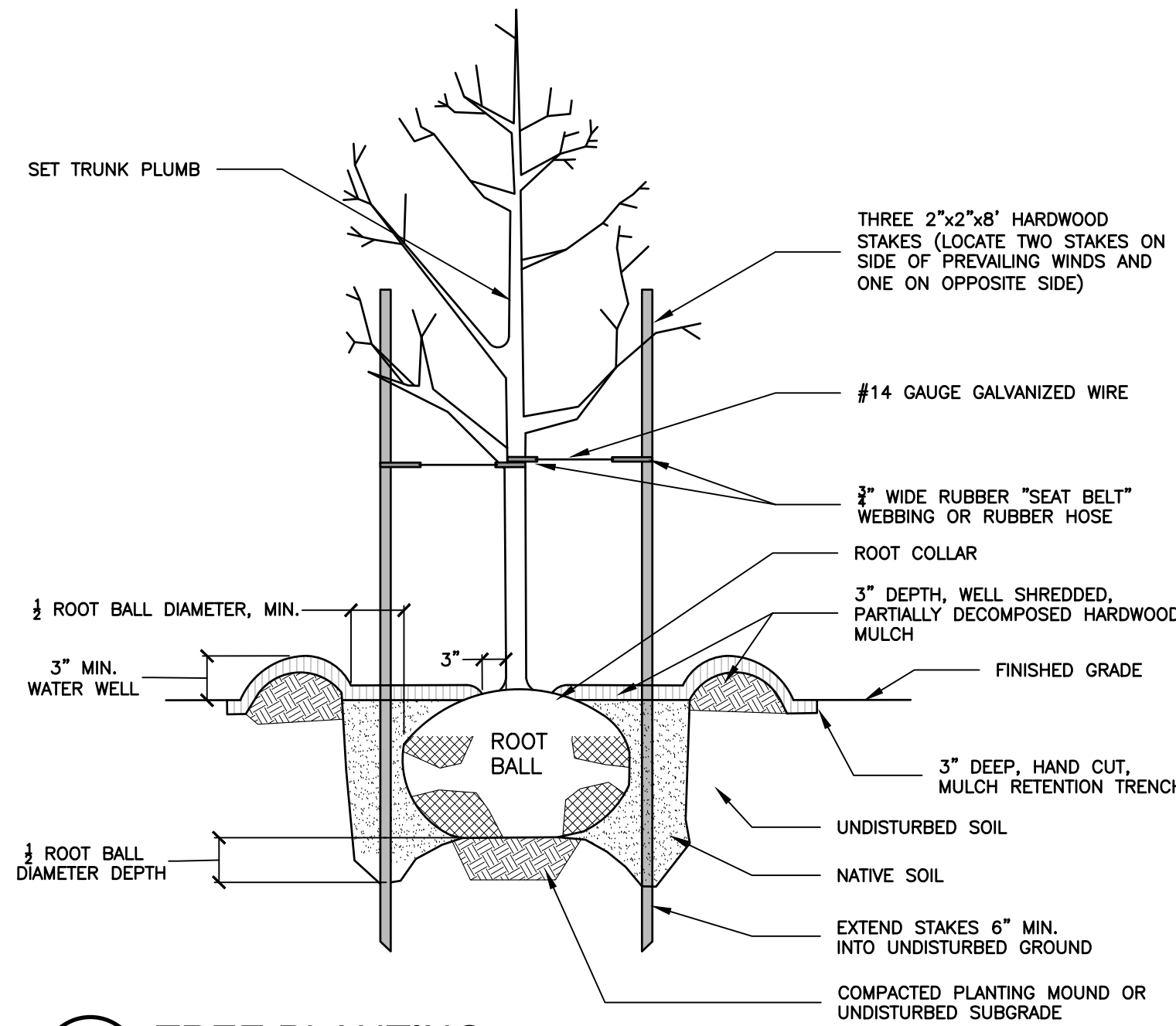

4 SHRUB PLANTING DETAIL

C-9 SCALE: NTS

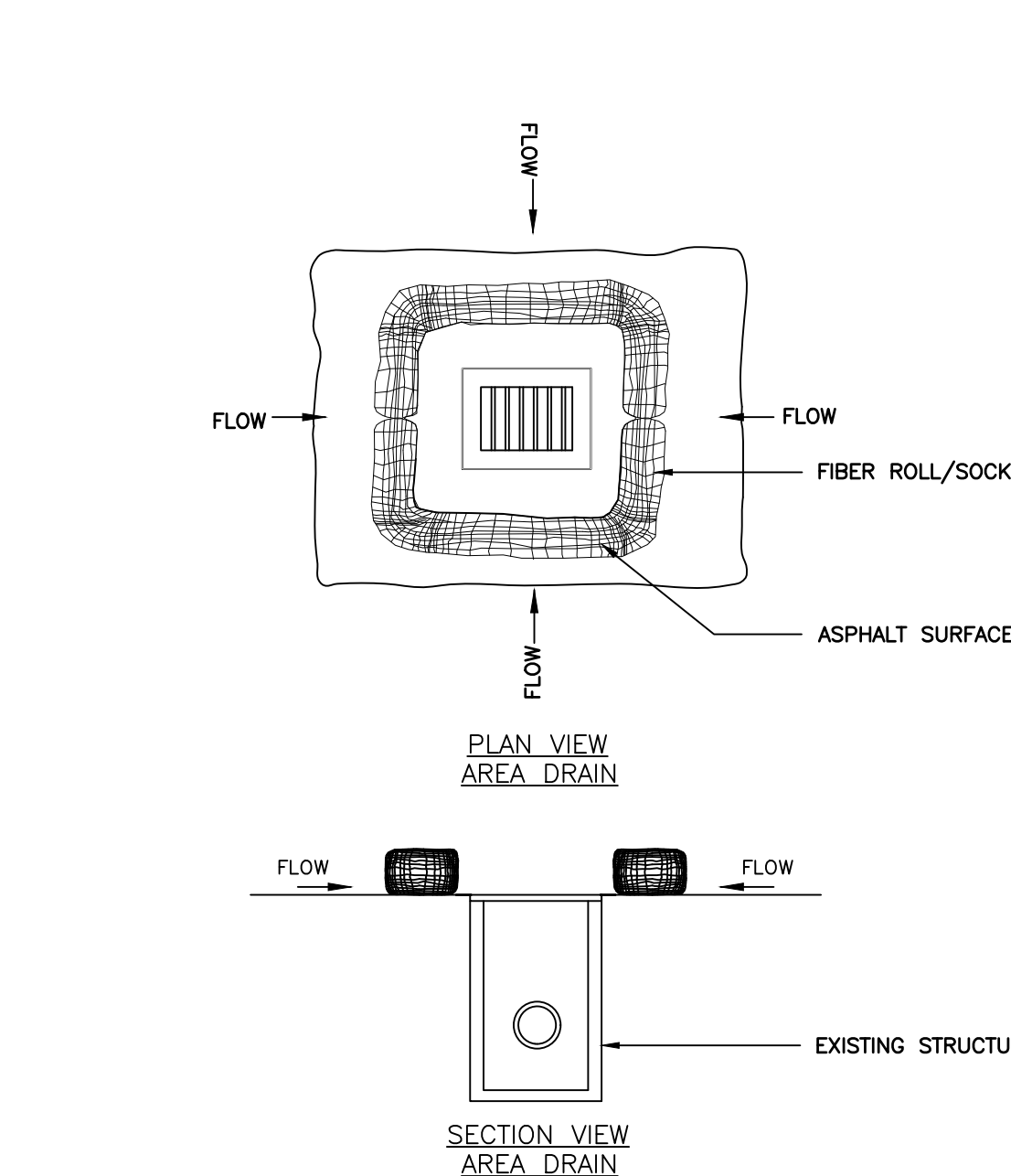

2 SILT FENCE

C-9 SCALE: NTS

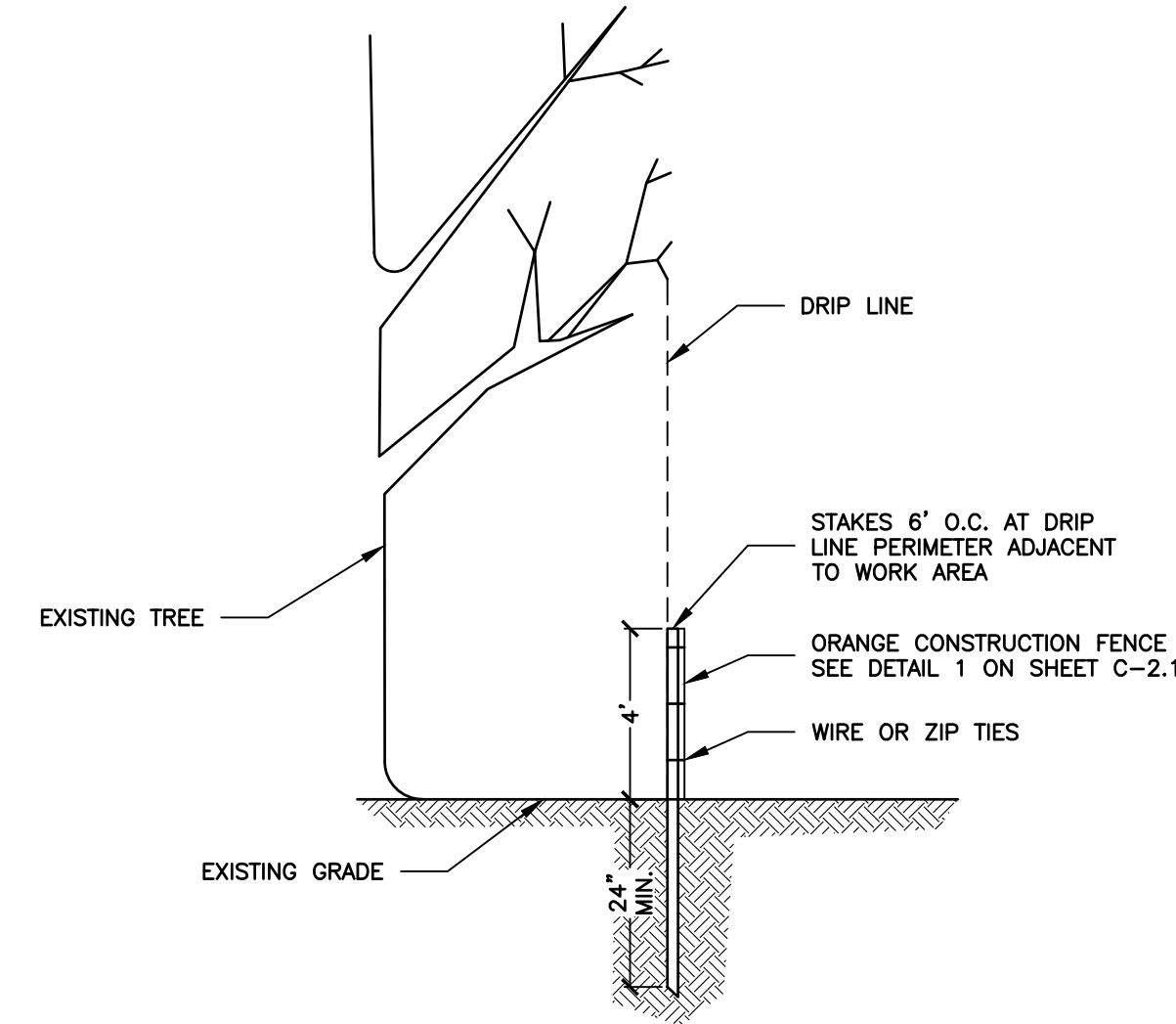

5 TYPICAL TREE PROTECTION FENCING

C-9 SCALE: NTS

6 NEW GRASS AREAS

C-9 SCALE: NTS

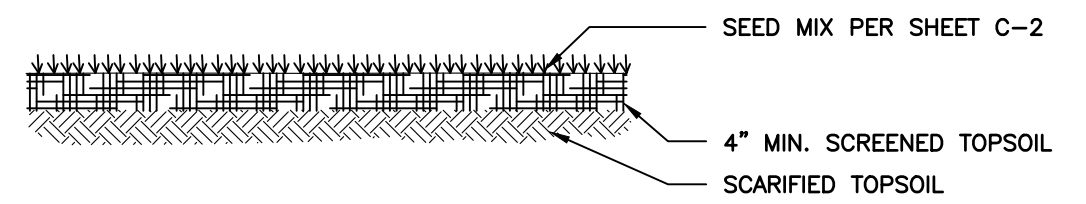

3 TREE PLANTING

C-9 SCALE: NTS

TOWN OF GREECE STANDARD DETAIL

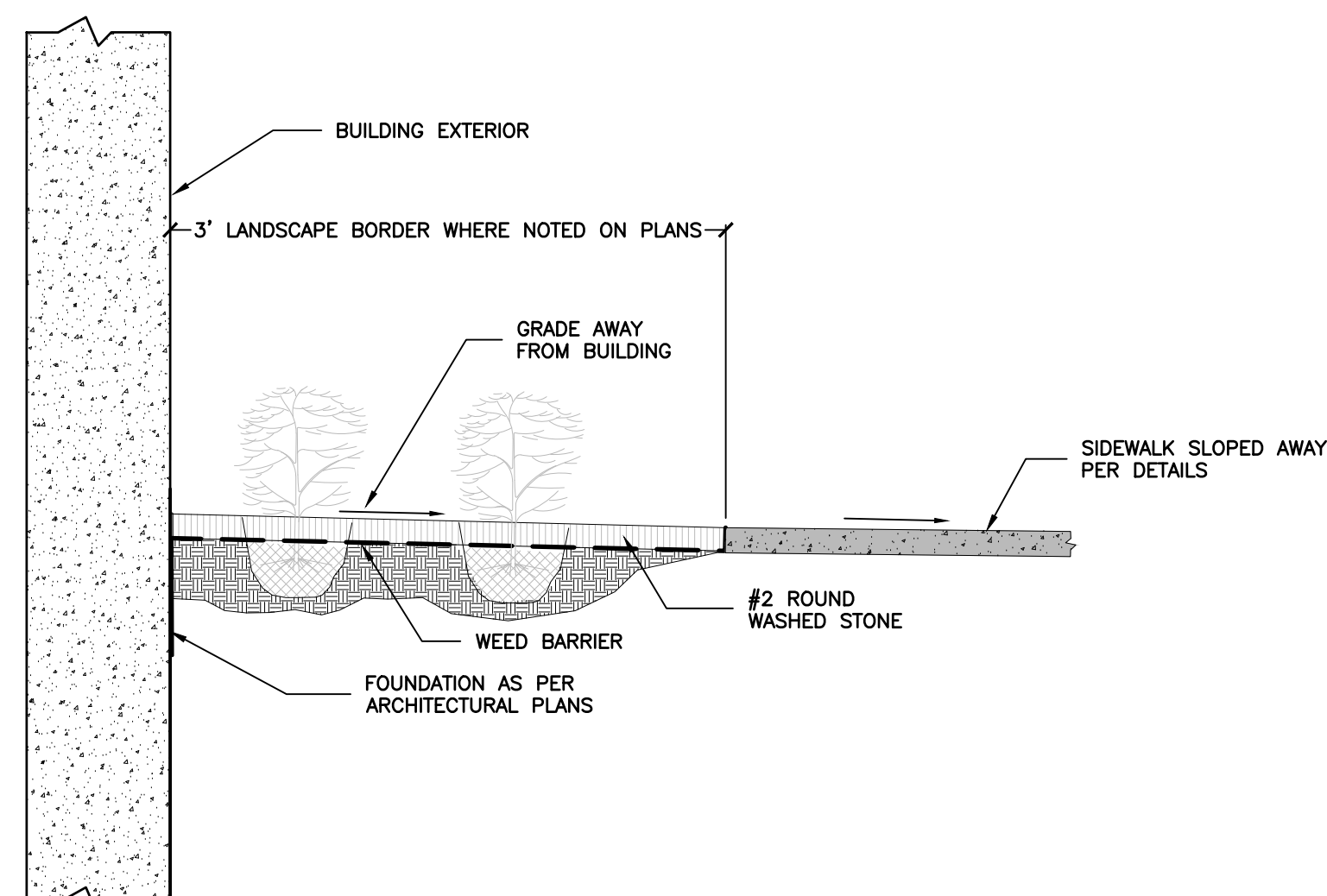

7 PERIMETER LANDSCAPING

C-9 SCALE: NTS

8 EROSION CONTROL SOCKS

C-9 SCALE: NTS

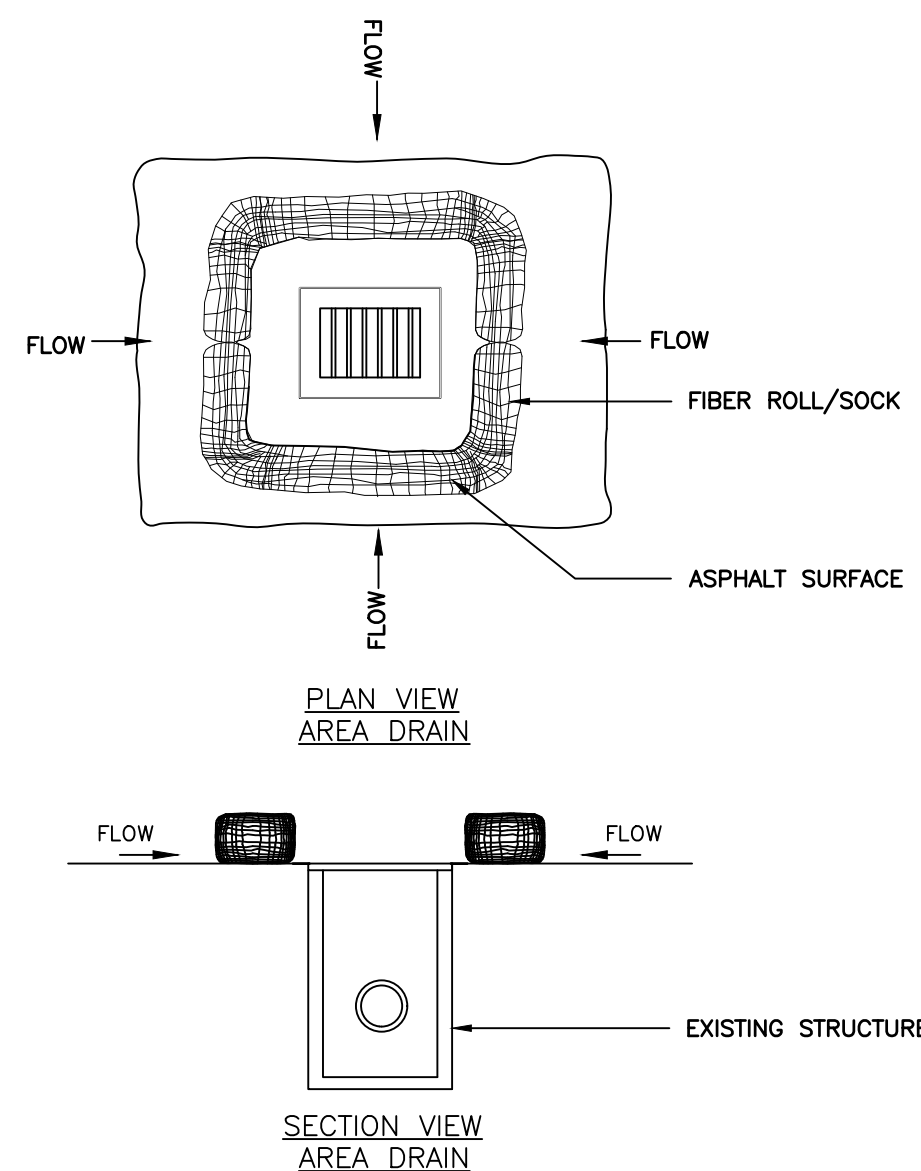

9 DROP INLET PROTECTION

C-9 SCALE: NTS

- FABRIC SHALL HAVE AN EOS OF 40-85. BURLAP MAY BE USED FOR SHORT TERM APPLICATIONS.
- CUT FABRIC FROM A CONTINUOUS ROLL TO ELIMINATE JOINTS. IF JOINTS ARE NEEDED THEY WILL BE OVERLAPPED TO THE NEXT STAKE.
- STAKE MATERIALS WILL BE STANDARD 2" x 4" WOOD OR EQUIVALENT. METAL WITH A MINIMUM LENGTH OF 3 FEET.
- SPACE STAKES EVENLY AROUND INLET 3 FEET APART AND DRIVE A MINIMUM 18 INCHES DEEP. SPANS GREATER THAN 3 FEET MAY BE BRIDGED WITH THE USE OF WIRE MESH BEHIND THE FILTER FABRIC FOR SUPPORT.
- FABRIC SHALL BE EMBEDDED 1 FOOT MINIMUM BELOW GROUND AND BACKFILLED. IT SHALL BE SECURELY FASTENED TO THE STAKES AND FRAME.
- A 2" x 4" WOOD FRAME SHALL BE COMPLETED AROUND THE CREST OF THE FABRIC FOR OVER FLOW STABILITY.

PROJECT TITLE: **PROPOSED MEDICAL OFFICE**

TOWN OF GREECE

MONROE CO., NY

PREPARED FOR: **WHELAN & CURRY CONSTRUCTION SERVICES, INC**

4103 NEW COURT ACE
SYRACUSE, NY 13206

SHEET TITLE: **DETAILS**

NO.	REVISION/ISSUE	DATE

PREPARED BY: **NAPIERALA CONSULTING**

PROFESSIONAL ENGINEER, P.E.

STATE OF NEW YORK

110 FAYETTE STREET
MANHATTAN, NEW YORK 10014

email: MNA1P@NAPCON.COM
PH: (315) 682-5580 FAX: (315) 682-5544

PLANNING REVIEW ONLY NOT FOR CONSTRUCTION

PROJECT NO. **22-2055**

DATE **11 FEB 2022**

SCALE **AS NOTED**

COPYRIGHT © 2022 NAPIERALA CONSULTING

IT IS A VIOLATION OF LAW FOR ANY PROFESSIONAL ENGINEER OR ARCHITECT TO REPRODUCE OR TRANSMIT IN ANY MANNER OR BY ANY MEANS, ELECTRONIC OR MECHANICAL, INCLUDING PHOTOCOPYING, RECORDING, OR BY ANY INFORMATION STORAGE AND RETRIEVAL SYSTEM, WITHOUT THE WRITTEN PERMISSION OF NAPIERALA CONSULTING.

ANY LICENSEE WHO ALTERS THIS DOCUMENT IS REQUIRED BY LAW TO NOTATION "ALTERED BY" FOLLOWED BY THE NAME OF THE LICENSEE AND THE DATE OF ALTERATION.

SHEET **C-9**