

CEDAR POINT, in Silverstone Park

2078 S. SILVERSTONE WAY, MERIDIAN, ID 83642



PROPERTY FEATURES

BLDG TYPE: Office
BLDG SIZE: 47,097 Square Feet
FLOORS: Single Story
PARKING: 5/1,000 SF Leased
LEASE TYPE: Full Service, Less Tenant Janitorial
ZONING: CC

BUILDING HIGHLIGHTS

- Centrally located in the Boise Valley, I-84 (Exit 46) less than one mile
- Professional Silverstone Park, provides service and food amenities
- Private entry into tenant space
- Excellent building signage available
- Generous parking included
- Proportionate use of Silverstone Amenity Center five (5) meeting and board rooms

AVAILABLE SPACES

Entire Building 47,097 SF

Divisible to approximately 6,000 RSF
call to discuss options

LOCATED



Call: 208-322-7300

WWW.SUNDANCECO.COM



CEDAR POINT, in Silverstone Park

2078 S. SILVERSTONE WAY, MERIDIAN, ID 83642



Call: 208-322-7300

WWW.SUNDANCECO.COM



CEDAR POINT, in Silverstone Park

2078 S. SILVERSTONE WAY, MERIDIAN, ID 83642

Silverstone Park provides abundant access points which substantially affects ease of access to and from your business. This development is nearly completely built out and you will find excellent internal traffic flow for employees and guests.

SILVERSTONE PARK

Twelve (12) Traffic Outlets

Two (2) Traffic Light Controlled



Call: 208-322-7300

WWW.SUNDANCECO.COM



CEDAR POINT, in Silverstone Park

2078 S. SILVERSTONE WAY, MERIDIAN, ID 83642

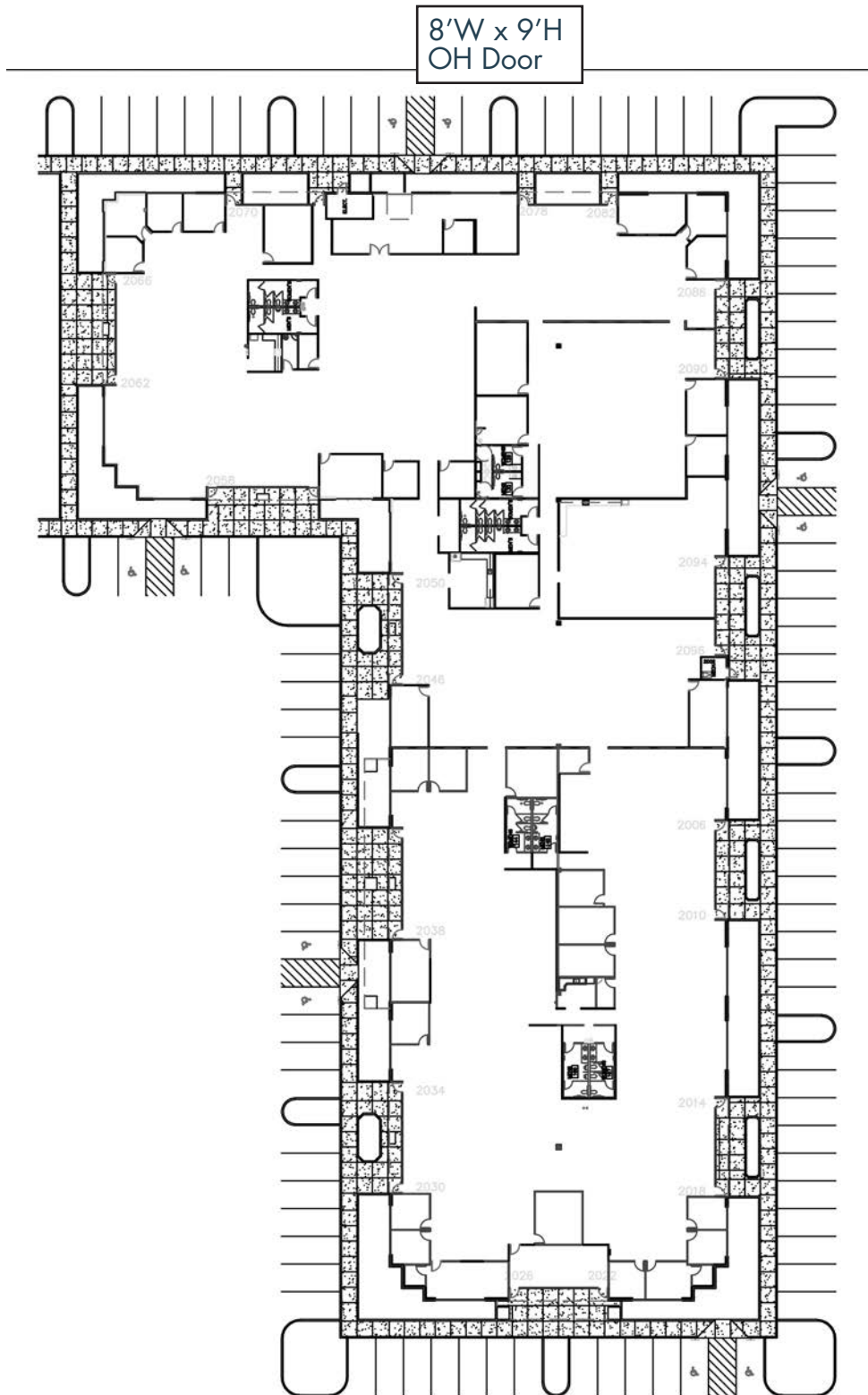

Call: 208-322-7300

WWW.SUNDANCECO.COM

